

NEW MEXICO OIL CONSERVATION COMMISSION
Santa Fe, New Mexico

DUPLICATE
NOTICE

OF INTENTION TO DRILL OR RECOMPLETE

Notice must be given to the District Office of the Oil Conservation Commission and approval obtained before drilling or recompletion begins. If changes in the proposed plan are considered advisable, a copy of this notice showing such changes will be returned to the sender. Submit this notice in **QUINTUPLICATE**. One copy will be returned following approval. See additional instructions in Rules and Regulations of the Commission.

Hobbs, New Mexico

(Place)

January 14, 1957

(Date)

OIL CONSERVATION COMMISSION
SANTA FE, NEW MEXICO

Gentlemen:

You are hereby notified that it is our intention to commence the (Drilling) (Recompletion) of a well to be known as

Stanolind Oil and Gas Company

(Company or Operator)

State "NM"

(Lease)

Well No. **2**

F

(Unit)

The well is

located **1657** feet from the **North** line and **2272** feet from the

~~East~~ **Section 6**, T. **19-S**, R. **36-E**, NMPM.

(GIVE LOCATION FROM SECTION LINE) **Hobbs** Pool, **Lea** County

If State Land the Oil and Gas Lease is No. **40974**

If patented land the owner is

Address

We propose to drill well with drilling equipment as follows: **Rotary tools from surface to total depth.**

The status of plugging bond is **Blanket Bond on file with commission**

Drilling Contractor **Gackle Drilling Corporation**
Fort Worth, Texas

We intend to complete this well in the **Grayburg - San Andres**

formation at an approximate depth of **4350** feet.

CASING PROGRAM

We propose to use the following strings of Casing and to cement them as indicated:

Size of Hole	Size of Casing	Weight per Foot	New or Second Hand	Depth	Sacks Cement
11"	8-5/8	22.7 & 24	New	300	250 to cir.
7-7/8"	5-1/2	14 1/2	New	4300	495 sack 6% gel
					plus 2 1/2 tuf plug
					per sack plus 50
					sx neat.

If changes in the above plans become advisable we will notify you immediately.

ADDITIONAL INFORMATION (If recompletion give full details of proposed plan of work.)

Approved **JAN 18 1957**, 19.....
Except as follows:

OIL CONSERVATION COMMISSION

By **E. J. Fischer**

Title **Engineer District**

Sincerely yours,

Stanolind Oil and Gas Company

(Company or Operator)

By **R. L. Hendrickson**

Position **Field Superintendent**

Send Communications regarding well to

Name **R. L. Hendrickson**

Address **Box 68**

Hobbs, New Mexico

NEW MEXICO
OIL CONSERVATION COMMISSION

Form C-128

Well Location and/or Gas Proration Plat

Date 3-17-56

Operator Stanolind Oil & Gas Co. Lease State II

Well No. 2 Section 6 Township 19 S Range 38 E NMPM

Located 1656.6 Feet From North Line, 2271.6 Feet From West Line,

Lea County, New Mexico. G. L. Elevation _____

Name of Producing Formation _____ Pool _____ Dedicated Acreage _____

(Note: All distances must be from outer boundaries of Section)

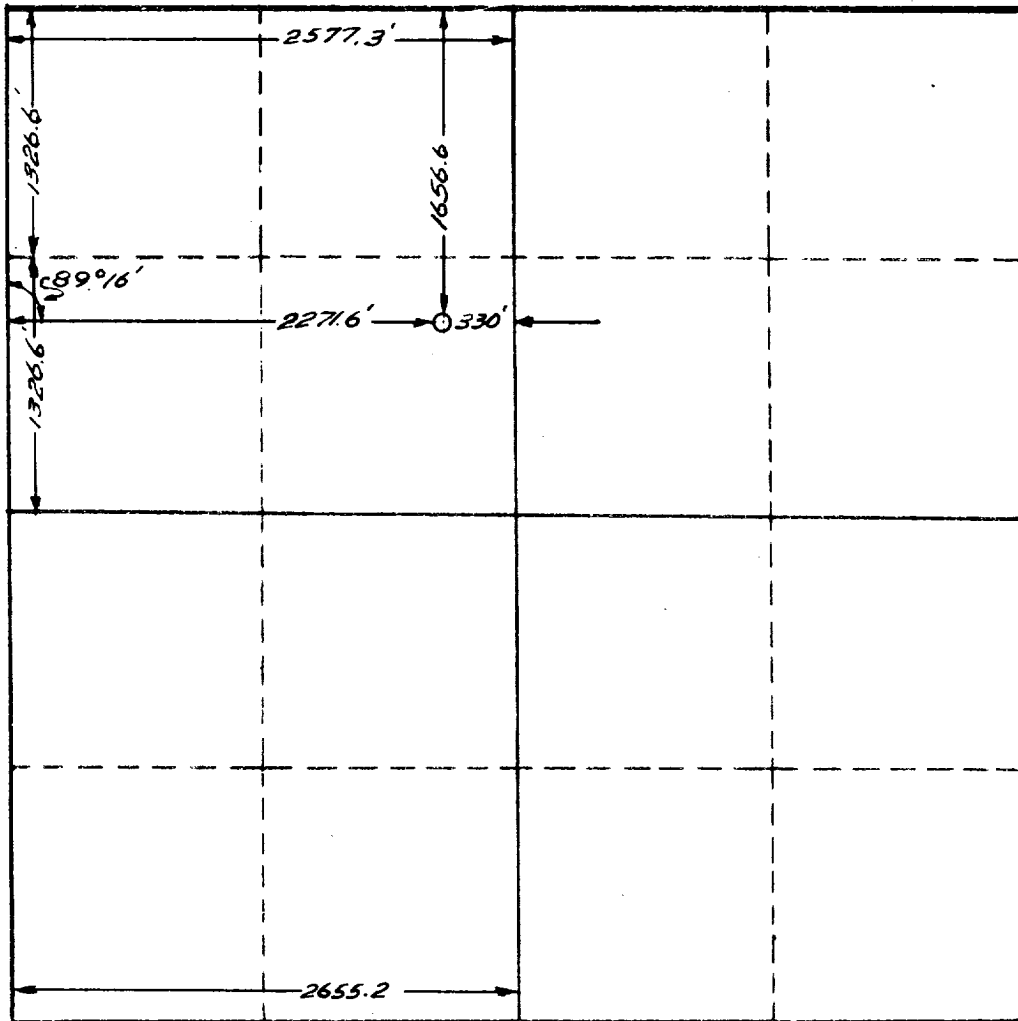

1. Is this Well a Dual Comp. ? Yes ___ No ___
2. If the answer to Question 1 is yes, are there any other dually completed wells within the dedicated acreage? Yes ___ No ___

This is to certify that the above plat was prepared from field notes of actual surveys made by me or under my supervision and that the same are true and correct to the best of my knowledge and belief.

Name _____
Position _____
Representing _____
Address _____

Date Surveyed 8-15-56
John A. West
Registered Professional Engineer and/or
Land Surveyor

JOHN W. WEST ENGINEERING COMPANY

412 NORTH DAL PASO

HOBBS, NEW MEXICO

September 17, 1956

Stanolind Oil & Gas Company
Hobbs, New Mexico

Gentlemen:

September 15, 1956, a survey was made to locate your State "H" Lease, well No. 2 at a point 330 feet from the north and 330 feet from the east lines of SE $\frac{1}{4}$ NW $\frac{1}{4}$ Sec. 6, Twp. 19 South, Range 38 East, N.M.P.M.

The survey was started at the west quarter corner of section 6, thence N0°44'E 996.6 feet along the west boundary of said section 6, thence East parallel with the north boundary line of the section a distance of 2271.6 feet to the location. Then to check we went N0°44'E 1656.6 feet, thence West 2577.3 feet. We were 0.4 feet west and 0.2 feet south of the section corner which is a close check of this work.

I hereby certify that the foregoing survey was made in the field under my supervision and that the same is true and correct to the best of my knowledge and belief.

Respectfully submitted,

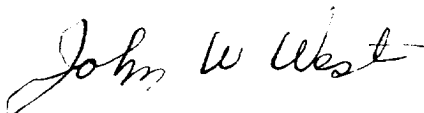

John W. West