

NEW MEXICO OIL CONSERVATION COMMISSION
WELL LOCATION AND ACREAGE DEDICATION PLAT

FORM C-128
 Revised 5/1/57

SEE INSTRUCTIONS FOR COMPLETING THIS FORM ON THE REVERSE SIDE.

SECTION A

Operator UNITED STATES SMELTING, REFINING AND MINING COMPANY			Lease BORDAGES		Well No. 1
Unit Letter C	Section 22	Township 19 SOUTH	Range 38 EAST	County LEA COUNTY	
Actual Footage Location of Well: 990 feet from the NORTH line and 2310 feet from the WEST line					
Ground Level Elev. 3587.80	Producing Formation Devonian		Pool Wildcat	Dedicated Acreage: 40 Acres	

1. Is the Operator the only owner in the dedicated acreage outlined on the plat below? YES ☒ NO ____ . ("Owner" means the person who has the right to drill into and to produce from any pool and to appropriate the production either for himself or for himself and another. (65-3-29 (e) NMSA 1935 Comp.)
2. If the answer to question one is "no," have the interests of all the owners been consolidated by communization agreement or otherwise? YES ____ NO ____ . If answer is "yes," Type of Consolidation ____
3. If the answer to question two is "no," list all the owners and their respective interests below:

Owner	Land Description

SECTION B

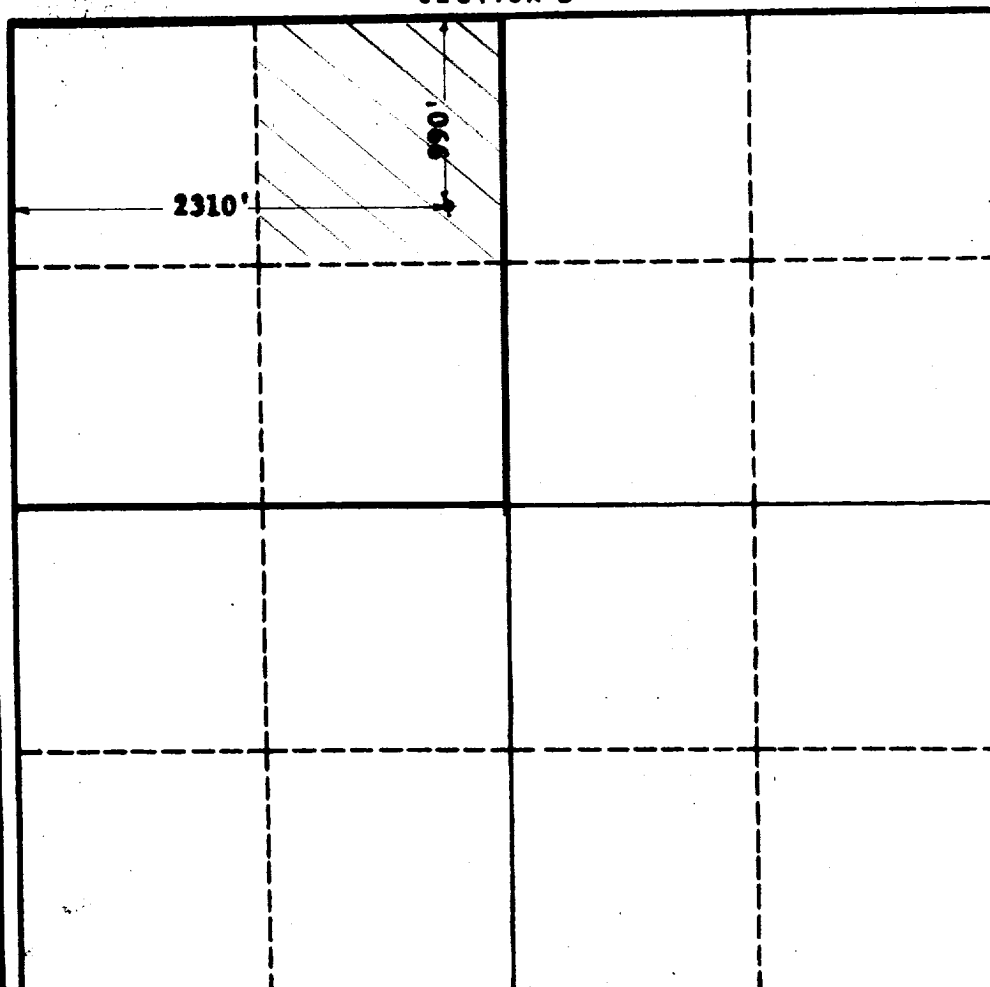

CERTIFICATION

I hereby certify that the information in SECTION A above is true and complete to the best of my knowledge and belief.

Name **W. H. Dougherty**
 Position **Manager of Production**
 Company **United States Smelting Refining and Mining Company**
 Date **February 26, 1962**

I hereby certify that the well location shown on the plat in SECTION B was plotted from field notes of actual surveys made by me or under my supervision, and that the same is true and correct to the best of my knowledge and belief.

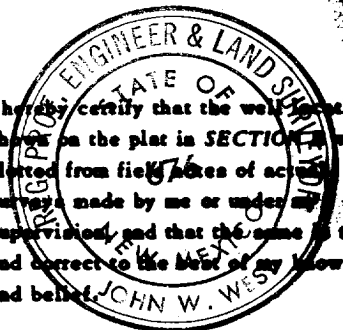

Date Surveyed **FEBRUARY 24, 1962**
 Registered Professional Engineer and/or Land Surveyor, **JOHN W. WEST**
 Certificate No. **John W. West**
 N.M. - P.E. & L.S. NO. 676

