

COPY TO O.C.C.  
HOBBS

NEW MEXICO OIL CONSERVATION COMMISSION

Form C-128  
Revised 5/1/57

Well Location and Acreage Dedication Plat

HOBBS OFFICE OCC

Section A.

Date 9-5-57

Operator Gulf Oil Corp. Lease 1957 OCT 4 Recon PHA 3:41 NM-08822  
Well No. 1 Unit Letter O Section 27 Township 20 S Range 34 E NMPM  
Located 330 Feet From South Line, 1650 Feet From East Line  
County Lea G. L. Elevation \_\_\_\_\_ Dedicated Acreage 4.2 Acres  
Name of Producing Formation \_\_\_\_\_ Pool \_\_\_\_\_

1. Is the Operator the only owner\* in the dedicated acreage outlined on the plat below?  
Yes ☒ No \_\_\_\_\_.
2. If the answer to question one is "no," have the interests of all the owners been consolidated by communitization agreement or otherwise? Yes \_\_\_\_\_ No \_\_\_\_\_. If answer is "yes," Type of Consolidation \_\_\_\_\_
3. If the answer to question two is "no," list all the owners and their respective interests below:

Owner

Land Description

RECEIVED

SEP 11 1957

U.S. GEOLOGICAL SURVEY

HOBBS, NEW MEXICO

Section B

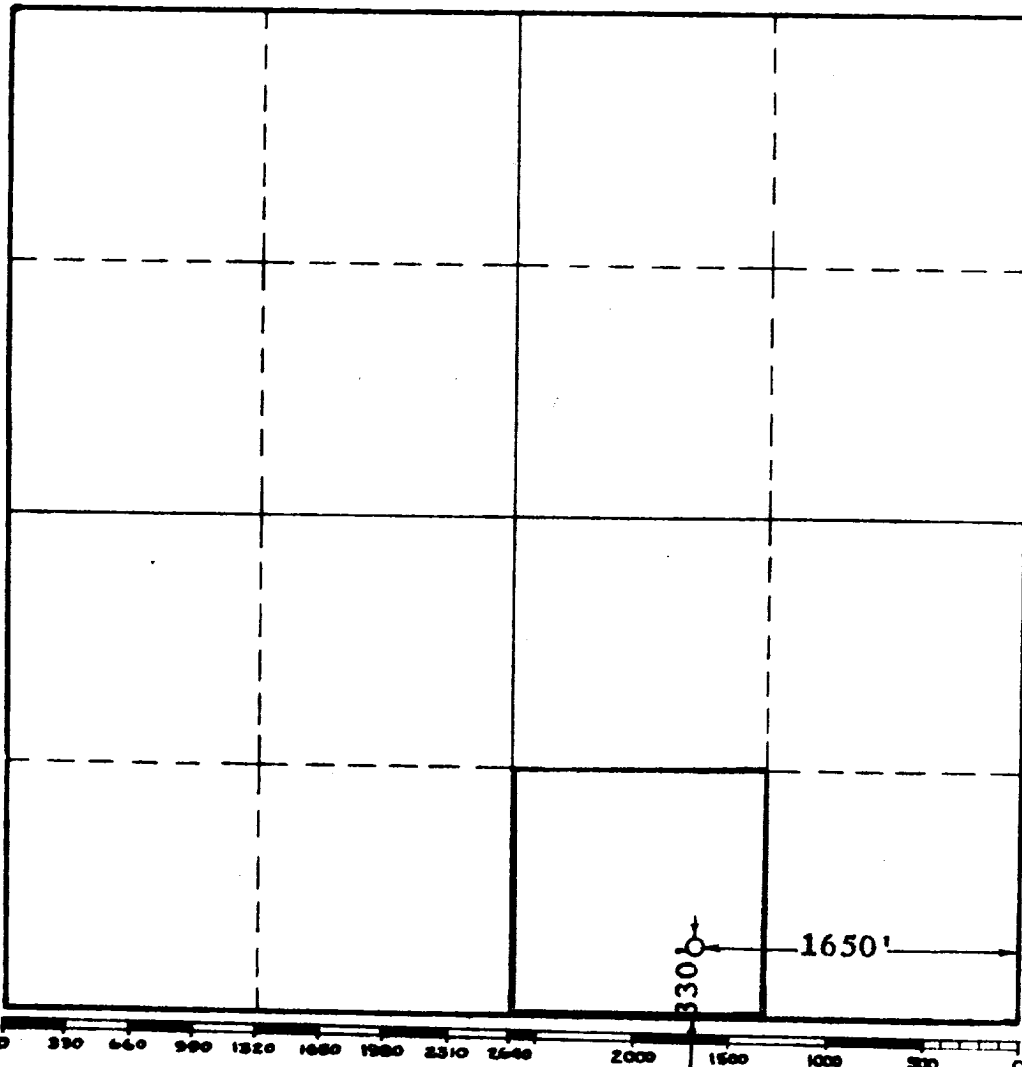

This is to certify that the information in Section A above is true and complete to the best of my knowledge and belief.

Gulf Oil Corporation  
(Operator)

G. Z. Taylor  
(Representative)  
Area Supt. of Prod.  
Box 2167, Hobbs, New Mexico  
Address

This is to certify that the well location shown on the plat in Section B was plotted from field notes of actual surveys made by me or under my supervision and that the same is true and correct to the best of my knowledge and belief.

Date Surveyed 9-4-57

John W. West  
Registered Professional  
Engineer and/or Land Surveyor.

Certificate No. 676

(See instructions for completion of this plat)