

Submit to Appropriate
District Office
State Lease - 6 copies
Fee Lease - 5 copies

State of New Mexico
Energy, Minerals and Natural Resources Department

Form C-101
Revised 1-1-89

OIL CONSERVATION DIVISION

DISTRICT I
P.O. Box 1980, Hobbs, NM 88240

P.O. Box 2088
Santa Fe, New Mexico 87504-2088

DISTRICT II
P.O. Drawer DD, Artesia, NM 88210

DISTRICT III
1000 Rio Brazos Rd., Aztec, NM 87410

API NO. (assigned by OCD on New Wells)

30-025-12473

5. Indicate Type of Lease

STATE ☒

FEE ☐

6. State Oil & Gas Lease No.

B 869

APPLICATION FOR PERMIT TO DRILL, DEEPEN, OR PLUG BACK

1a. Type of Work:

DRILL ☐

RE-ENTER ☐

DEEPEN ☐

PLUG BACK ☐

b. Type of Well:

OIL
WELL ☒

GAS
WELL ☐

OTHER ☐

SINGLE
ZONE ☒

MULTIPLE
ZONE ☐

7. Lease Name or Unit Agreement Name

STATE "F"

2. Name of Operator

AMERADA HESS CORPORATION

8. Well No.

5

3. Address of Operator

DRAWER D, MONUMENT, NEW MEXICO 88265

9. Pool name or Wildcat

MONUMENT ABO

4. Well Location

Unit Letter N : 785 Feet From The SOUTH Line and 1980 Feet From The WEST Line

Section 36 Township 19S Range 36E NMPM LEA County

10. Proposed Depth

11. Formation

ABO

12. Rotary or C.T.

13. Elevations (Show whether DF, RT, GR, etc.)

3590' DF

14. Kind & Status Plug. Bond

15. Drilling Contractor

16. Approx. Date Work will start

17. PROPOSED CASING AND CEMENT PROGRAM

| SIZE OF HOLE | SIZE OF CASING | WEIGHT PER FOOT | SETTING DEPTH | SACKS OF CEMENT | EST. TOP |
|--------------|----------------|-----------------|---------------|-----------------|----------|
| 17-1/2" | 13-3/8" | 48# | 187' | PREVIOUSLY | RAN |
| 11" | 8-5/8" | 28# | 2400' | " | " |
| 7-3/4" | 5-1/2" | 17# | 9978' | " | " |

PLAN TO MIRU PULLING UNIT, INSTALL BOP & TIH W/CEMENT RETAINER. CEMENT SQUEEZE EUNICE - MONUMENT G/SA ZONE 5-1/2" CSG. PERF. FR. 3579'-3756' W/200 SX. CLASS "C" NEAT CEMENT. WOC. TIH W/BIT & DRILL OUT RETAINER & CEMENT. TEST SQUEEZE TO 500# FOR 15 MIN. DRILL CEMENT FR. 7135'-7170', CIBP AT 7170' & RUN BIT TO 7700'. PERF. ABO ZONE 5-1/2" CSG. FR. 6910'-7201' W/2 SPF USING 4" HOLLOW CARRIER CSG. GUN. RUN RBP SET AT 7210' & ACIDIZE NEW PERFS. W/2000 GALS. 15% 80% QUALITY FOAM UTILIZING CO2. SWAB TEST. PULL RBP, RUN PROD. EQUIP. & RETURN TO PROD. OIL WELL.

IN ABOVE SPACE DESCRIBE PROPOSED PROGRAM: IF PROPOSAL IS TO DEEPEN OR PLUG BACK, GIVE DATA ON PRESENT PRODUCTIVE ZONE AND PROPOSED NEW PRODUCTIVE ZONE. GIVE BLOWOUT PREVENTER PROGRAM, IF ANY.

I hereby certify that the information above is true and complete to the best of my knowledge and belief.

SIGNATURE

R. L. Wheeler, Jr.

TITLE

SUPV. ADM. SVC.

DATE

4/25/91

TYPE OR PRINT NAME

R. L. WHEELER, JR.

TELEPHONE NO. 393-2144

(This space for State Use)

ORIGINAL SIGNED BY JEPHY SEXTON

DISTRICT I SUPERVISOR

APPROVED BY

TITLE

DATE

APR 25 1991

CONDITIONS OF APPROVAL, IF ANY:

Submit to Appropriate
District Office
State Lease - 4 copies
Fee Lease - 3 copies

State of New Mexico
Energy, Minerals and Natural Resources Department

Form C-102
Revised 1-1-89

OIL CONSERVATION DIVISION

DISTRICT I
P.O. Box 1980, Hobbs, NM 88240

P.O. Box 2088

Santa Fe, New Mexico 87504-2088

DISTRICT II
P.O. Drawer DD, Artesia, NM 88210

DISTRICT III
1000 Rio Brazos Rd., Aztec, NM 87410

WELL LOCATION AND ACREAGE DEDICATION PLAT

All Distances must be from the outer boundaries of the section

| | | | | | |
|---|---------------|----------------------------|--------------------|--------------------------------|---------------|
| Operator AMERADA HESS CORPORATION | | | Lease STATE "F" | | Well No. 5 |
| Unit Letter N | Section 36 | Township 19S | Range 36E | County LEA | |
| Actual Footage Location of Well: 785 feet from the SOUTH line and 1980 feet from the WEST line | | | | | |
| Ground level Elev. 3590' DF | | Producing Formation ABO | | Pool MONUMENT ABO | |
| | | | | Dedicated Acreage: 40 Acres | |

1. Outline the acreage dedicated to the subject well by colored pencil or hatchure marks on the plat below.

2. If more than one lease is dedicated to the well, outline each and identify the ownership thereof (both as to working interest and royalty).

3. If more than one lease of different ownership is dedicated to the well, have the interest of all owners been consolidated by communitization, unitization, force-pooling, etc.?

☐ Yes ☐ No If answer is "yes" type of consolidation _____

If answer is "no" list the owners and tract descriptions which have actually been consolidated. (Use reverse side of this form if necessary.) _____

No allowable will be assigned to the well until all interests have been consolidated (by communitization, unitization, forced-pooling, or otherwise) or until a non-standard unit, eliminating such interest, has been approved by the Division.

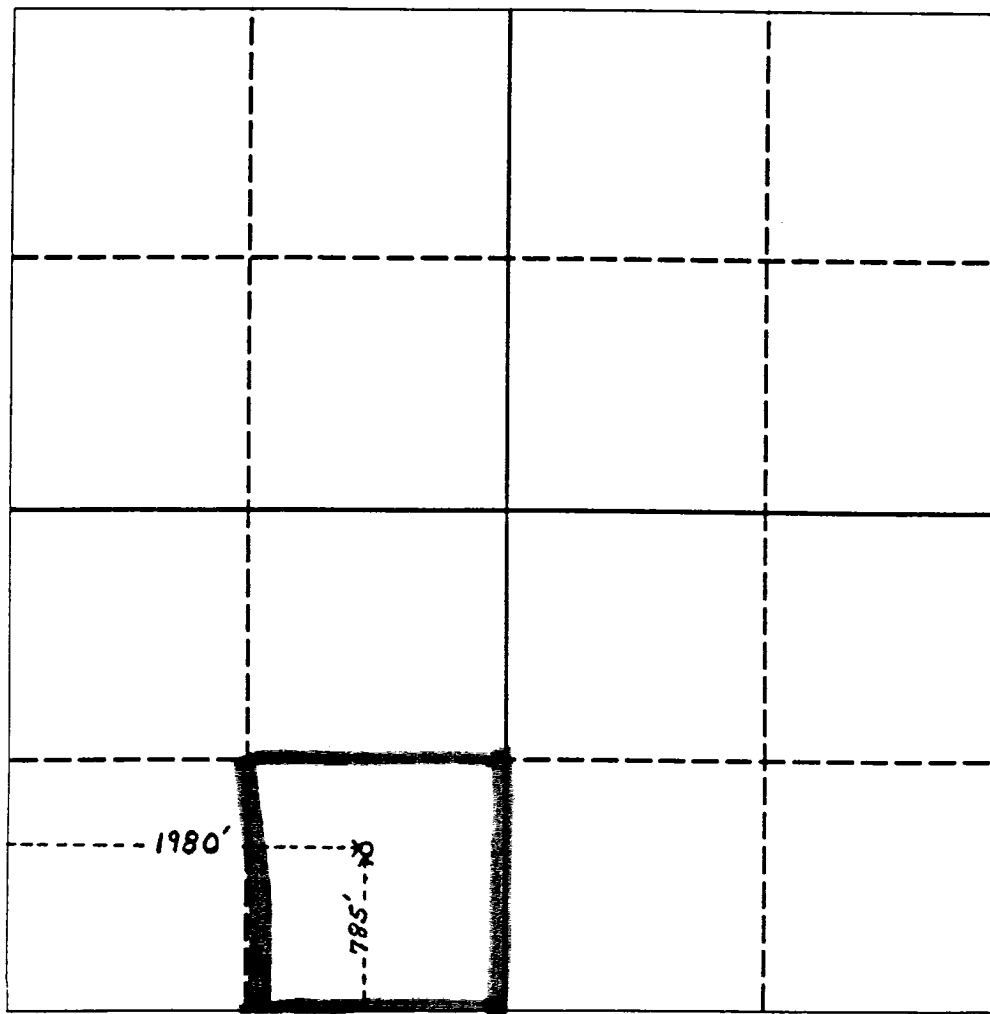

0 330 660 990 1320 1650 1980 2310 2640 2000 1500 1000 500 0

OPERATOR CERTIFICATION

I hereby certify that the information contained herein is true and complete to the best of my knowledge and belief.

Signature

Printed Name

R. L. WHEELER, JR.

Position

SUPV. ADM. SVC.

Company

AMERADA HESS CORPORATION

Date

4/25/91

SURVEYOR CERTIFICATION

I hereby certify that the well location shown on this plat was plotted from field notes of actual surveys made by me or under my supervision, and that the same is true and correct to the best of my knowledge and belief.

Date Surveyed

Signature & Seal of
Professional Surveyor

Certificate No.