

NEW MEXICO OIL CONSERVATION COMMISSION
Santa Fe, New Mexico

Form C-101
Revised (12/1/55)

NOTICE OF INTENTION TO DRILL

Notice must be given to the District Office of the Oil Conservation Commission and approval obtained before drilling or recompletion begins. If changes in the proposed plan are considered advisable, a copy of this notice showing such changes will be returned to the sender. Submit this notice in **QUINTUPPLICATE**. One copy will be returned following approval. See additional instructions in Rules and Regulations of the Commission. If State Land submit 6 Copies Attach Form C-128 in triplicate to first 3 copies of form C-101

Hobbs, New Mexico

(Place)

July 30, 1963

(Date)

OIL CONSERVATION COMMISSION
SANTA FE, NEW MEXICO

Gentlemen:

You are hereby notified that it is our intention to commence the Drilling of a well to be known as

Pan American Petroleum Corporation

(Company or Operator)

B. L. Thorp

(Lease)

Well No **27**

in **H**

(Unit)

The well is

located **1980** feet from the **North** line and **990** feet from the

East line of Section **10**, T **10-S**, R **38-E**, NMPM.

(GIVE LOCATION FROM SECTION LINE) **Hobbs** Pool, **Lea** County

D	C	B	A
E	F	G	* H
L	K	J	I
M	N	O	P

If State Land the Oil and Gas Lease is No

If patented land the owner is **B. L. Thorp**

Address **Hobbs, New Mexico**

We propose to drill well with drilling equipment as follows: **0 - TD with rotary tools.**

The status of plugging bond is **blanket bond on file with Commission**

Drilling Contractor **Cactus Drilling Company**
San Angelo, Texas

We intend to complete this well in the **Grayburg**

formation at an approximate depth of **4300'** feet.

CASING PROGRAM

We propose to use the following strings of Casing and to cement them as indicated:

Size of Hole	Size of Casing	Weight per Foot	New or Second Hand	Depth	Sacks Cement
11"	8-5/8"	24#	New	400	Circulate
7-7/8"	4-1/2"	9-5#	New	4200	Sufficient to fill to base of salt.

If changes in the above plans become advisable we will notify you immediately.

ADDITIONAL INFORMATION (If recompletion give full details of proposed plan of work.)

Approved....., 19.....
Except as follows:

OIL CONSERVATION COMMISSION

By.....

Sincerely yours,

Pan American Petroleum Corporation

(Company or Operator)

By.....
V. R. SPALLEY

Position.....**Area Foreman**

Send Communications regarding well to

Name.....**J. J. Fletcher**

Address.....**Box 68 - Hobbs, New Mexico**

NEW MEXICO OIL CONSERVATION COMMISSION
WELL LOCATION AND ACREAGE DEDICATION PLAT

FORM C-128
Revised 5/1/57

SEE INSTRUCTIONS FOR COMPLETING THIS FORM ON THE REVERSE SIDE

SECTION A

Operator PAN AMERICAN PETROLEUM CORP.		Lease B. L. THORP		1903 JUL 1		M 10:00 Well No. 27	
Unit Letter H	Section 10	Township 19 SOUTH	Range 38 EAST	County LEA			
Actual Footage Location of Well: 1980 feet from the NORTH line and 990 feet from the EAST line							
Ground Level Elev. NXA	Producing Formation Grayburg		Pool Hobbs		Dedicated Acreage: 40 Acres		

1. Is the Operator the only owner in the dedicated acreage outlined on the plat below? YES ☒ NO ☐ ("Owner" means the person who has the right to drill into and to produce from any pool and to appropriate the production either for himself or for himself and another. (65-3-29 (e) NMSA 1935 Comp.)
2. If the answer to question one is "no," have the interests of all the owners been consolidated by communitization agreement or otherwise? YES ☐ NO ☐ If answer is "yes," Type of Consolidation _____
3. If the answer to question two is "no," list all the owners and their respective interests below:

Owner	Land Description

SECTION B

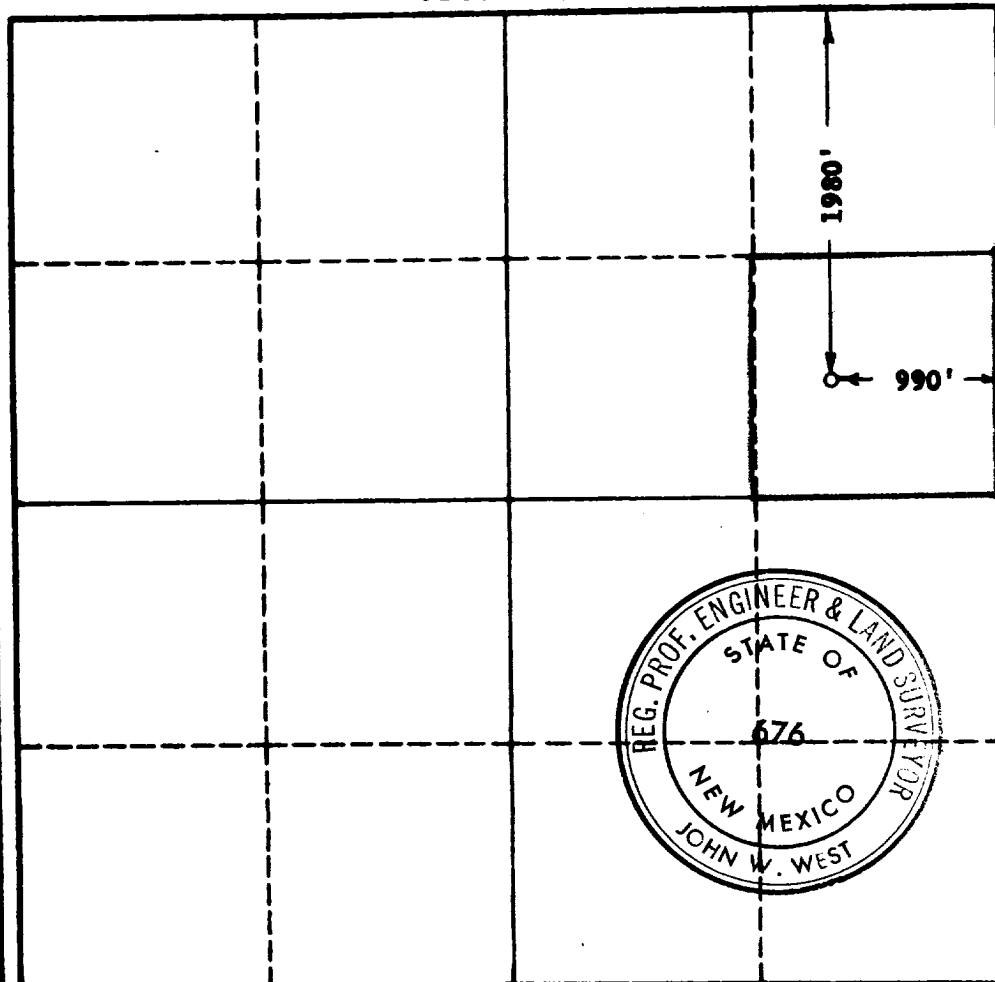

CERTIFICATION

I hereby certify that the information in SECTION A above is true and complete to the best of my knowledge and belief.

Original Signed By **J. L. Fletcher, Jr.**
Name **Original signed by: J. L. Fletcher, Jr.**

Position
Area Foreman
Company
Pan American Petroleum Corp.
Date
July 30, 1963

I hereby certify that the well location shown on the plat in SECTION B was plotted from field notes of actual surveys made by me or under my supervision, and that the same is true and correct to the best of my knowledge and belief.

Date Surveyed
7-26-1963
Registered Professional Engineer and/or Land Surveyor, **JOHN W. WEST**
John W. West
Certificate No.
N.M. - P.E. & L.S. NO. 676