

NEW MEXICO OIL CONSERVATION COMMISSION  
WELL LOCATION AND ACREAGE DEDICATION

HOBBS OFFICE O. C. C. C-120  
Revised 3/1/57

NOV 25 2 04 PM '63

SEE INSTRUCTIONS FOR COMPLETING THIS FORM ON THE REVERSE SIDE

SECTION A

Operator <b>SKELLY OIL COMPANY</b>			Lease <b>L. VAN ETEN</b>		Well No. <b>11</b>
Unit Letter <b>1</b>	Section <b>9</b>	Township <b>20 SOUTH</b>	Range <b>37 EAST</b>	County <b>LEA</b>	
Actual Footage Location of Well: <b>1980</b> feet from the <b>SOUTH</b> line and <b>660</b> feet from the <b>EAST</b> line					
Ground Level Elev. <b>3832</b>	Producing Formation <b>Tubb</b>		Pool <b>Monument Tubb</b>		Dedicated Acreage: <b>40</b> Acres

1. Is the Operator the only owner in the dedicated acreage outlined on the plat below? YES ☒ NO ☐ ("Owner" means the person who has the right to drill into and to produce from any pool and to appropriate the production either for himself or for himself and another. (63-3-29 (a) NMSA 1935 Comp.)
2. If the answer to question one is "no," have the interests of all the owners been consolidated by communitization agreement or otherwise? YES ☐ NO ☐ If answer is "yes," Type of Consolidation \_\_\_\_\_
3. If the answer to question two is "no," list all the owners and their respective interests below:

Owner	Land Description

SECTION B

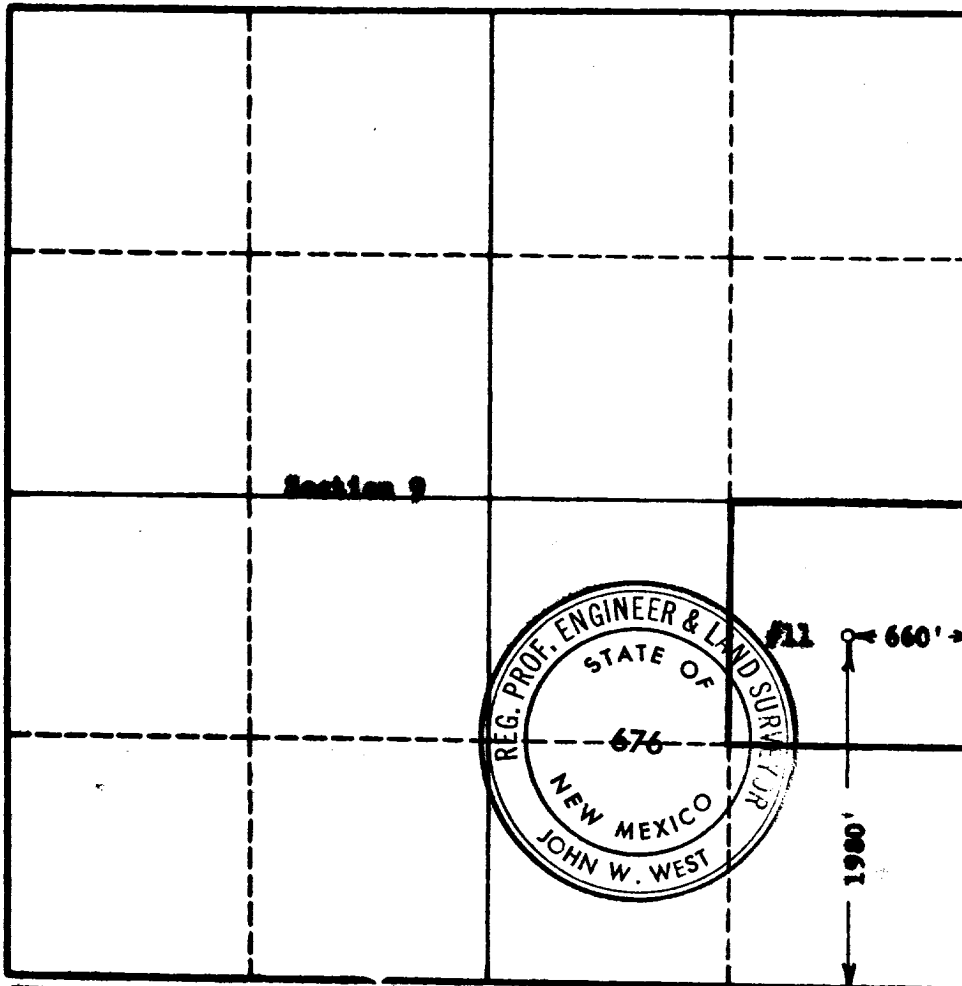

CERTIFICATION

I hereby certify that the information in SECTION A above is true and complete to the best of my knowledge and belief.

Name (ORIGINAL) (signed) <b>H. E. Aab</b>
Position <b>Dist. Supt.</b>
Company <b>Skelly Oil Company</b>
Date <b>November 21, 1963</b>

I hereby certify that the well location shown on the plat in SECTION B was plotted from field notes of actual surveys made by me or under my supervision, and that the same is true and correct to the best of my knowledge and belief.

Date Surveyed <b>11-19-1963</b>
Registered Professional Engineer and/or Land Surveyor, <b>JOHN W. WEST</b>
Signature <i>John W. West</i>
Certificate No. <b>A.M. - P.E. &amp; L.S. NO. 676</b>

0 300 600 900 1200 1500 1800 2100 2400 2700 3000 3300 3600 3900 4200 4500 4800 5100 5400 5700 6000