

Form 9-231a
(Feb. 1961)

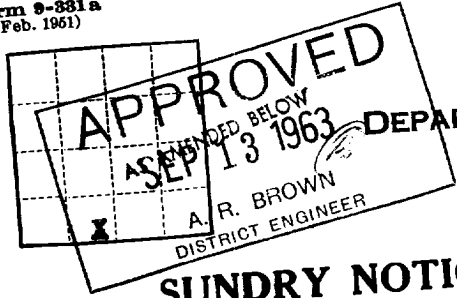

(SUBMIT IN TRIPLICATE)

UNITED STATES
DEPARTMENT OF THE INTERIOR
GEOLOGICAL SURVEY

Land Office _____
Lease No. **LC-066126**
Unit _____

SEP 13 1963

U. S. GEOLOGICAL SURVEY
BOBBE NEW MEXICO

SUNDRY NOTICES AND REPORTS ON WELLS

NOTICE OF INTENTION TO DRILL	<input checked="" type="checkbox"/>	SUBSEQUENT REPORT OF WATER SHUT-OFF	
NOTICE OF INTENTION TO CHANGE PLANS		SUBSEQUENT REPORT OF SHOOTING OR ACIDIZING	
NOTICE OF INTENTION TO TEST WATER SHUT-OFF		SUBSEQUENT REPORT OF ALTERING CASING	
NOTICE OF INTENTION TO RE-DRILL OR REPAIR WELL		SUBSEQUENT REPORT OF RE-DRILLING OR REPAIR	
NOTICE OF INTENTION TO SHOOT OR ACIDIZE		SUBSEQUENT REPORT OF ABANDONMENT	
NOTICE OF INTENTION TO PULL OR ALTER CASING		SUPPLEMENTARY WELL HISTORY	
NOTICE OF INTENTION TO ABANDON WELL			

(INDICATE ABOVE BY CHECK MARK NATURE OF REPORT, NOTICE, OR OTHER DATA)

September 13, 1963

Well No. **Hanson "C"** is located **330** ft. from **NE** line and **1650** ft. from **EW** line of sec. **23**

SE 1/4, SW 1/4 Sec. 23 (1/4 Sec. and Sec. No.)
20 S (Twp.) **34 E** (Range) **NMPM** (Meridian)
Undesignated (Lynch) (Field) **Lee** (County or Subdivision) **New Mexico** (State or Territory)

The elevation of the derrick floor above sea level is _____ ft.

DETAILS OF WORK

(State names of and expected depths to objective sands; show sizes, weights, and lengths of proposed casings; indicate mudding jobs, cementing points, and all other important proposed work)

It is proposed to drill with rotary tools to an approximate depth of 3800' for a Yates-Seven Rivers test.

Proposed casing program:
Surface: 8 5/8" 20# set & 220' circulated.
Oil String: 5 1/2" 14# set & TD circulated.

NOTIFY USGS IN SUFFICIENT TIME TO
WITNESS CEMENTING THE 5 1/2" CASING.

I understand that this plan of work must receive approval in writing by the Geological Survey before operations may be commenced.

Company **Bark Royalty Company**
Address **c/o Oil Reports & Gas Services**
Box 763
Hobbs, New Mexico

By H. L. Smith
Title **Agent**

NEW MEXICO OIL CONSERVATION COMMISSION
WELL LOCATION AND ACREAGE DEDICATION PLAT

FORM C-128
Revised 5/1/57

SEE INSTRUCTIONS FOR COMPLETING THIS FORM ON THE REVERSE SIDE

SECTION A

Operator BURK ROYALTY CO.		Lease HANSON "C"		Well No. 3
Unit Letter N	Section 23	Township 20 SOUTH	Range 34 EAST	County LEA
Actual Footage Location of Well: 330 feet from the SOUTH line and 1650 feet from the WEST line				
Ground Level Elev.	Producing Formation Tater-Seven Rivers	Pool Undesignated (Lynch)	Dedicated Acreage: 10 Acres	

1. Is the Operator the only owner in the dedicated acreage outlined on the plat below? YES ☒ NO ____ . ("Owner" means the person who has the right to drill into and to produce from any pool and to appropriate the production either for himself or for himself and another. (65-3-29 (c) NMSA 1955 Comp.)
2. If the answer to question one is "no," have the interests of all the owners been consolidated by communitization agreement or otherwise? YES ____ NO ____ . If answer is "yes," Type of Consolidation ____
3. If the answer to question two is "no," list all the owners and their respective interests below:

Owner	Land Description

SECTION B

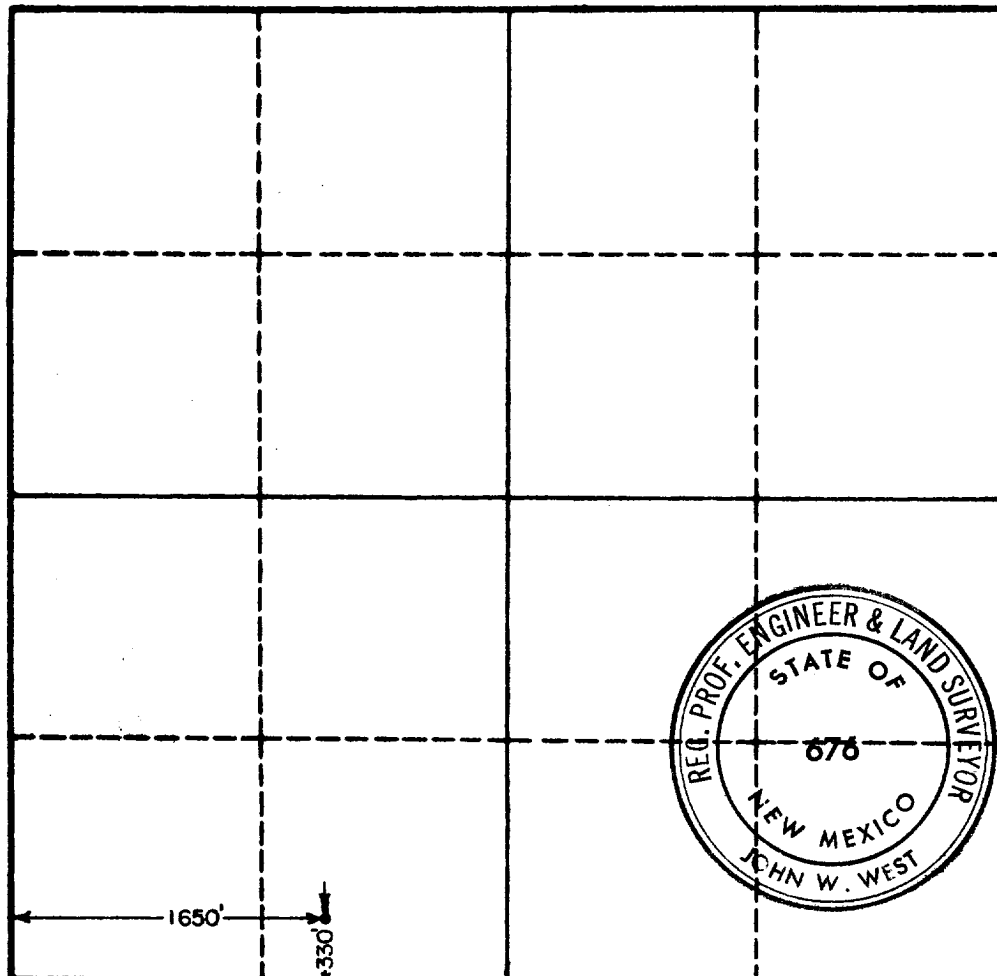

CERTIFICATION

I hereby certify that the information in SECTION A above is true and complete to the best of my knowledge and belief.

Name **W. L. Smith**
Position **Agent**
Company **Burk Royalty Company**
Date **September 13, 1963**

I hereby certify that the well location shown on the plat in SECTION B was plotted from field notes of actual surveys made by me or under my supervision, and that the same is true and correct to the best of my knowledge and belief.

Date Surveyed **9-13-63**
Registered Professional Engineer and/or Land Surveyor, **JOHN W. WEST**

Certificate No. **N. M. - P. E. & L. S. NO. 676**