

(SUBMIT IN TRIPLICATE)

 UNITED STATES  
 DEPARTMENT OF THE INTERIOR  
 GEOLOGICAL SURVEY

 Get Bureau No. 42-R358.4.  
 Approved.

 Land Office **Hobbs**  
 Lease No. **NM 0631**  
 Unit **R**

DEC 12 1963

 U. S. GEOLOGICAL SURVEY  
 ALBUQUERQUE, NEW MEXICO

## SUNDRY NOTICES AND REPORTS ON WELLS

NOTICE OF INTENTION TO DRILL.....	<input checked="" type="checkbox"/>	SUBSEQUENT REPORT OF WATER SHUT-OFF.....	
NOTICE OF INTENTION TO CHANGE PLANS.....		SUBSEQUENT REPORT OF SHOOTING OR ACIDIZING.....	
NOTICE OF INTENTION TO TEST WATER SHUT-OFF.....		SUBSEQUENT REPORT OF ALTERING CASING.....	
NOTICE OF INTENTION TO RE-DRILL OR REPAIR WELL.....		SUBSEQUENT REPORT OF RE-DRILLING OR REPAIR.....	
NOTICE OF INTENTION TO SHOOT OR ACIDIZE.....		SUBSEQUENT REPORT OF ABANDONMENT.....	
NOTICE OF INTENTION TO PULL OR ALTER CASING.....		SUPPLEMENTARY WELL HISTORY.....	
NOTICE OF INTENTION TO ABANDON WELL.....			

(INDICATE ABOVE BY CHECK MARK NATURE OF REPORT, NOTICE, OR OTHER DATA)

December 10, 1963

Federal-Les

Well No. **1** is located **1900** ft. from **N** line and **2060** ft. from **W** line of sec. **11**

**SW/4 Section 11**      **20-S**      **34-E**      **NM PM**

( $\frac{3}{4}$  Sec. and Sec. No.)      (Twp.)      (Range)      (Meridian)

**Las Bona Springs**      **Les**      **New Mexico**

(Field)      (County or Subdivision)      (State or Territory)

The elevation of the derrick floor above sea level is **3640** ft. **GR**

## DETAILS OF WORK

(State names of and expected depths to objective sands; show sizes, weights, and lengths of proposed casings; indicate mudding jobs, cementing points, and all other important proposed work)

1. Drill a 10,300' Bone Springs test.
2. Drill a 17-1/2" hole to approximately 450'.
3. Set 13-3/8" casing at 450'. Cement with 450 sacks. Cement to circulate. WOC 24 hours. Test casing with 500 psi for 30 minutes.
4. Drill an 11" hole to approximately 5500'.
5. Set 8-5/8" casing at 5500', cement with 700 sacks in two stages bringing cement back to base of salt at approximately 3250'. WOC 24 hours. Test casing with 1500 psi for 30 minutes.
6. Drill a 7-7/8" hole to approximately 10,300'.
7. If productive, set 4-1/2" casing on bottom at approximately 10,300'. Cement with 300 sacks.
8. Will take Drill Stem Tests and Cores whenever good drilling practices dictates.

I understand that this plan of work must receive approval in writing by the Geological Survey before operations may be commenced.

Company **Edwin Foster Blair**Address **Post Office Box 1877****Midland, Texas**
 By *McDonough*  
 Title **Agent**

**NEW MEXICO OIL CONSERVATION COMMISSION**  
**WELL LOCATION AND ACREAGE DEDICATION PLAT**

FORM C-128  
 Revised 3/1/57

SEE INSTRUCTIONS FOR COMPLETING THIS FORM ON THE REVERSE SIDE

**SECTION A**

Operator <b>EDWIN FOSTER BLAIR</b>			Lease <b>FEDERAL LEA</b>		Well No. <b>1</b>
Unit Letter <b>K</b>	Section <b>11</b>	Township <b>20 SOUTH</b>	Range <b>34 EAST</b>	County <b>LEA</b>	
Actual Footage Location of Well: <b>2060</b> feet from the <b>WEST</b> line and <b>1900</b> feet from the <b>SOUTH</b> line					
Ground Level Elev. <b>3640.5</b>	Producing Formation <b>Bone Spring</b>	Pool <b>Los Bone Spring</b>		Dedicated Acreage: <b>80</b> Acres	

1. Is the Operator the only owner in the dedicated acreage outlined on the plat below? YES ☒ NO \_\_\_\_ . ("Owner" means the person who has the right to drill into and to produce from any pool and to appropriate the production either for himself or for himself and another. (65-3-29 (a) NMSA 1935 Comp.)
2. If the answer to question one is "no," have the interests of all the owners been consolidated by communitization agreement or otherwise? YES \_\_\_\_ NO \_\_\_\_ . If answer is "yes," Type of Consolidation \_\_\_\_\_
3. If the answer to question two is "no," list all the owners and their respective interests below:

Owner	Land Description

**SECTION B**

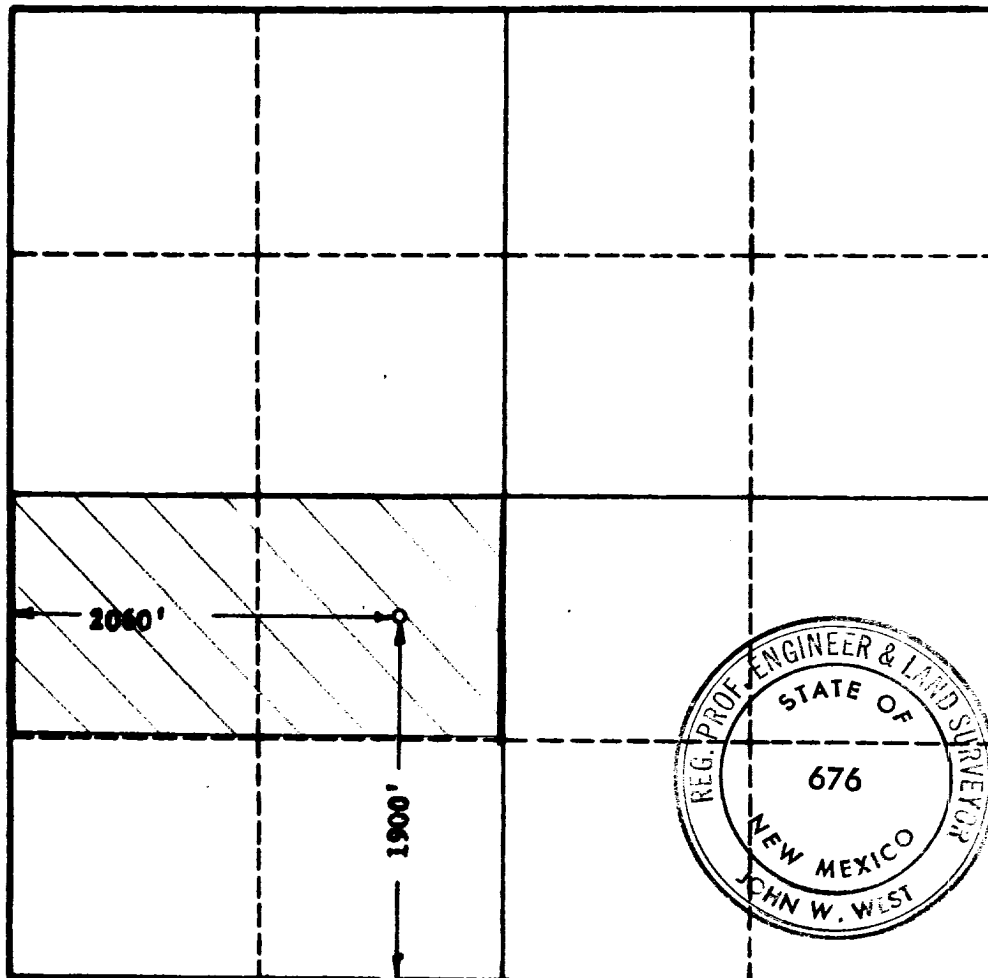

**CERTIFICATION**

I hereby certify that the information in SECTION A above is true and complete to the best of my knowledge and belief.

Name *Edwin Foster Blair*  
 Agent  
 Position  
**Edwin Foster Blair**  
 Company  
**December 10, 1963**  
 Date

I hereby certify that the well location shown on the plat in SECTION B was plotted from field notes of actual surveys made by me or under my supervision, and that the same is true and correct to the best of my knowledge and belief.

Date Surveyed  
**12-6-1963**  
 Registered Professional Engineer and/or Land Surveyor, **JOHN W. WEST**  
*John W. West*  
 Certificate No.  
**N. M. - P. E. & L. S. NO. 676**

0 300 600 900 1200 1500 1800 2100 2400 2700 3000 3300 3600