

Form 9-31a
(Feb. 1951)

(SUBMIT IN TRIPLICATE) OFFICE O. C. C. Land Office
UNITED STATES
DEPARTMENT OF THE INTERIOR
GEOLOGICAL SURVEY
Case No. **03178**
Unit

APPROVED
JUN 11 1964
A. R. BROWN
DISTRICT ENGINEER

SUNDRY NOTICES AND REPORTS ON WELLS

NOTICE OF INTENTION TO DRILL	<input checked="" type="checkbox"/>	SUBSEQUENT REPORT OF WATER SHUT-OFF	
NOTICE OF INTENTION TO CHANGE PLANS		SUBSEQUENT REPORT OF SHOOTING OR ACIDIZING	
NOTICE OF INTENTION TO TEST WATER SHUT-OFF		SUBSEQUENT REPORT OF ALTERING CASING	
NOTICE OF INTENTION TO RE-DRILL OR REPAIR WELL		SUBSEQUENT REPORT OF RE-DRILLING OR REPAIR	
NOTICE OF INTENTION TO SHOOT OR ACIDIZE		SUBSEQUENT REPORT OF ABANDONMENT	
NOTICE OF INTENTION TO PULL OR ALTER CASING		SUPPLEMENTARY WELL HISTORY	
NOTICE OF INTENTION TO ABANDON WELL			

(INDICATE ABOVE BY CHECK MARK NATURE OF REPORT, NOTICE, OR OTHER DATA)

June 9, 19**64**

Well No. **1-3** is located **660** ft. from **S** line and **1980** ft. from **E** line of sec. **3**
SW/4 of Section 30-3 **200** **34E** **T. 4 N. R. 4 E.**
(1/4 Sec. and Sec. No.) (Twp.) (Range) (Meridian)
Wilcox **Lee County** **New Mexico**
(Field) (County or Subdivision) (State or Territory)

The elevation of the derrick floor above sea level is **3760** ft.

DETAILS OF WORK

(State names of and expected depths to objective sands; show sizes, weights, and lengths of proposed casings; indicate mudding jobs, cementing points, and all other important proposed work)

Proposed depths: **12500'**, Sand formation.
300' 13-3/8 surface casing, 100 sac cement or cement sufficient to circulate.
3000' 9-5/8" intermediate casing, 400 sac cement.

SALT SECTION MUST BE ISOLATED FROM
CIRCULATION BY CEMENT

NOTIFY LAND OFFICE AND TO
9 5/8" CASING and oil string

I understand that this plan of work must receive approval in writing by the Geological Survey before operations may be commenced.

Company **GREATHOUSE, PIERCE & DAVIS and J. C. HANSEN OIL COMPANY**
Address **609 Midland National Bank Bldg., Midland, Texas**
By **J. C. Hansen Jr**
Title **Partner**
GREATHOUSE, PIERCE & DAVIS

NEW MEXICO OIL CONSERVATION COMMISSION
WELL LOCATION AND ACREAGE DEDICATION PLAT

FORM C-128
Revised 5/1/57
HOBBS OFFICE D. C. C.
JUN 16 8 12 AM '64

SEE INSTRUCTIONS FOR COMPLETING THIS FORM ON THE REVERSE SIDE

SECTION A

Operator GREATHOUSE, PIERCE & DAVIS			Lease FEDERAL		Well No. 1-3
Unit Letter N	Section 3	Township 20 SOUTH	Range 34 EAST	County LEA	
Actual Footage Location of Well: 660 feet from the SOUTH line and 1980 feet from the WEST line					
Ground Level Elev. 3742	Producing Formation Sand		Pool Wildcat		Dedicated Acreage: 80 Acres

1. Is the Operator the only owner in the dedicated acreage outlined on the plat below? YES ☒ NO ____ ("Owner" means the person who has the right to drill into and to produce from any pool and to appropriate the production either for himself or for himself and another. (65-3-29 (e) NMSA 1935 Comp.)
2. If the answer to question one is "no," have the interests of all the owners been consolidated by communitization agreement or otherwise? YES ____ NO ____ . If answer is "yes," Type of Consolidation ____
3. If the answer to question two is "no," list all the owners and their respective interests below:

Owner	Land Description

SECTION B

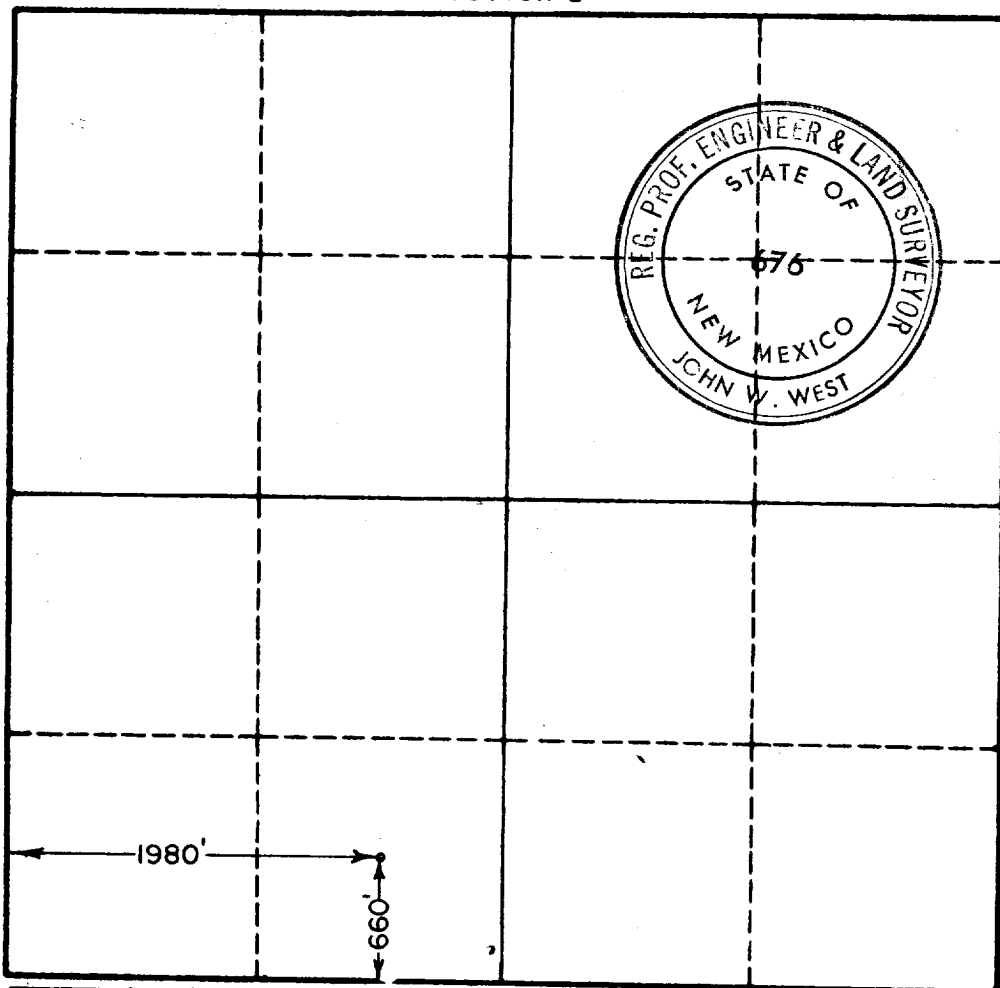

CERTIFICATION

I hereby certify that the information in SECTION A above is true and complete to the best of my knowledge and belief.

Name	<i>J. P. Davis Jr</i>
Position	partner
Company	GREATHOUSE, PIERCE & DAVIS
Date	June 9, 1964

I hereby certify that the well location shown on the plat in SECTION B was plotted from field notes of actual surveys made by me or under my supervision, and that the same is true and correct to the best of my knowledge and belief.

Date Surveyed	MAY 14, 1964
Registered Professional Engineer and/or Land Surveyor,	JOHN W. WEST
Certificate No.	<i>John W. West</i>
N. M. - P. E. & L. S. NO. 676	