

All distances must be from the outer boundaries of the Section.

Operator Ladd Petroleum Corporation			Lease Laughlin			Well No. 1		
Unit Letter H	Section 9	Township 20-S	Range 37-#	County Lea				
Actual Footage Location of Well: 2310 feet from the north line and 330 feet from the east line								
Ground Level Elev. 3541'		Producing Formation Blinebry		Pool UNDESIGNATED		Dedicated Acreage 80 40 Acres		

1. Outline the acreage dedicated to the subject well by colored pencil or hatchure marks on the plat below.
2. If more than one lease is dedicated to the well, outline each and identify the ownership thereof (both as to working interest and royalty).
3. If more than one lease of different ownership is dedicated to the well, have the interests of all owners been consolidated by communitization, unitization, force-pooling, etc?

☐ Yes ☐ No If answer is "yes," type of consolidation \_\_\_\_\_

If answer is "no," list the owners and tract descriptions which have actually been consolidated. (Use reverse side of this form if necessary.) \_\_\_\_\_

No allowable will be assigned to the well until all interests have been consolidated (by communitization, unitization, forced-pooling, or otherwise) or until a non-standard unit, eliminating such interests, has been approved by the Division.

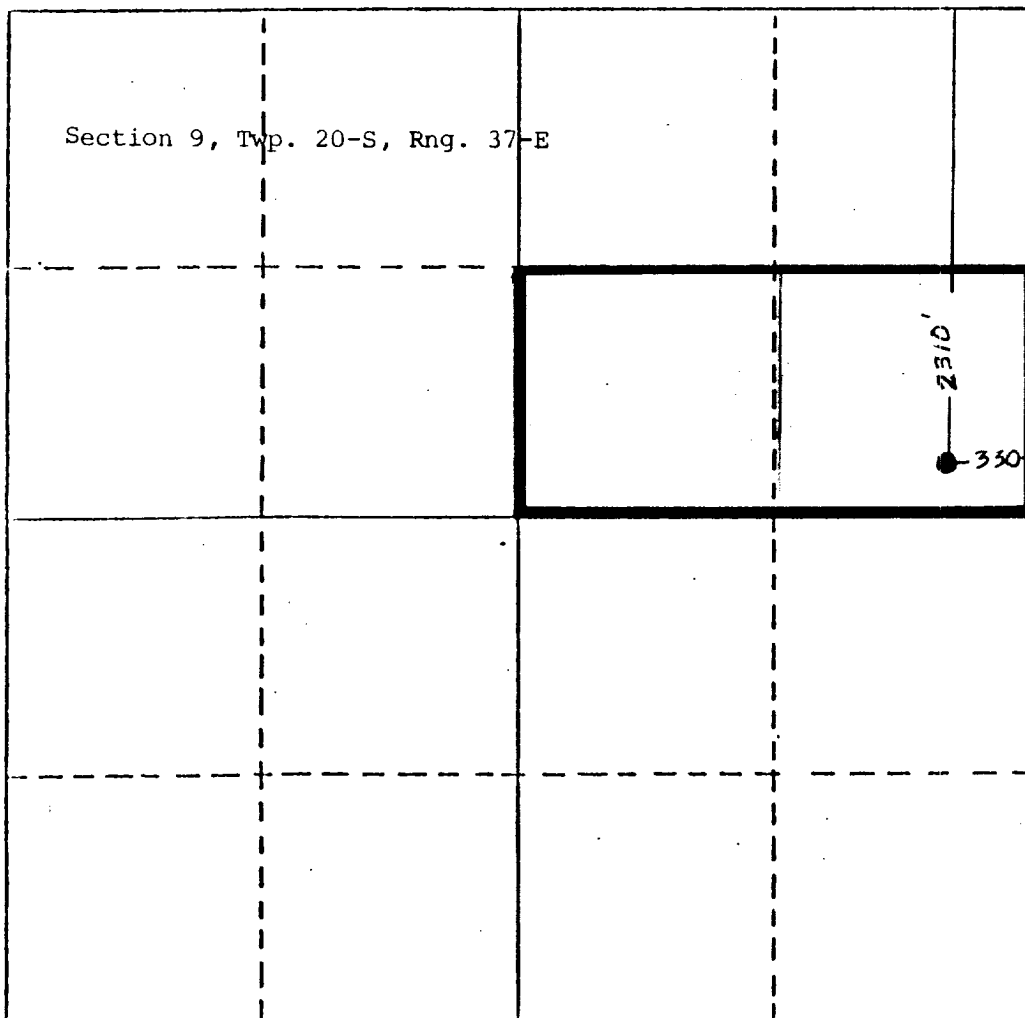

#### CERTIFICATION

I hereby certify that the information contained herein is true and complete to the best of my knowledge and belief.

*Michael G. Zachry*  
Name

Michael G. Zachry

Position

Midland District Engineer

Company

Ladd Petroleum Corp.

Date

1-26-83

I hereby certify that the well location shown on this plat was plotted from field notes of actual surveys made by me or under my supervision, and that the same is true and correct to the best of my knowledge and belief.

Date Surveyed

Registered Professional Engineer  
and/or Land Surveyor

Certificate No.

