

NEW MEX. OIL CONSERVATION COMMISSION
WELL LOCATION AND ACREAGE DEDICATION PLAT O. C. C.

Form C-102
Supersedes C-128
Effective 1-1-65

All distances must be from the outer boundaries of the section.

AUG 19 11 45 AM '66 AUG 18 11 29 AM '66

Operator SHENANDOAH OIL CORP.		RUTH TERRY FURNEAUX		Well No. 1
---	--	----------------------------	--	----------------------

Unit Letter D	Section 26	Township 19 SOUTH	Range 38 EAST	County LEA
-------------------------	----------------------	-----------------------------	-------------------------	----------------------

Actual Footage Location of Well: 660 feet from the NORTH line and 660 feet from the WEST line				
Ground Level Elev: 3597.8	Producing Formation Drinkard	Pool Nadine	Dedicated Acreage: 40 Acres	

1. Outline the acreage dedicated to the subject well by colored pencil or hatchure marks on the plat below.
2. If more than one lease is dedicated to the well, outline each and identify the ownership thereof (both as to working interest and royalty).
3. If more than one lease of different ownership is dedicated to the well, have the interests of all owners been consolidated by communitization, unitization, force-pooling, etc?

☐ Yes ☐ No If answer is "yes," type of consolidation _____

If answer is "no," list the owners and tract descriptions which have actually been consolidated. (Use reverse side of this form if necessary.) _____

No allowable will be assigned to the well until all interests have been consolidated (by communitization, unitization, forced-pooling, or otherwise) or until a non-standard unit, eliminating such interests, has been approved by the Commission.

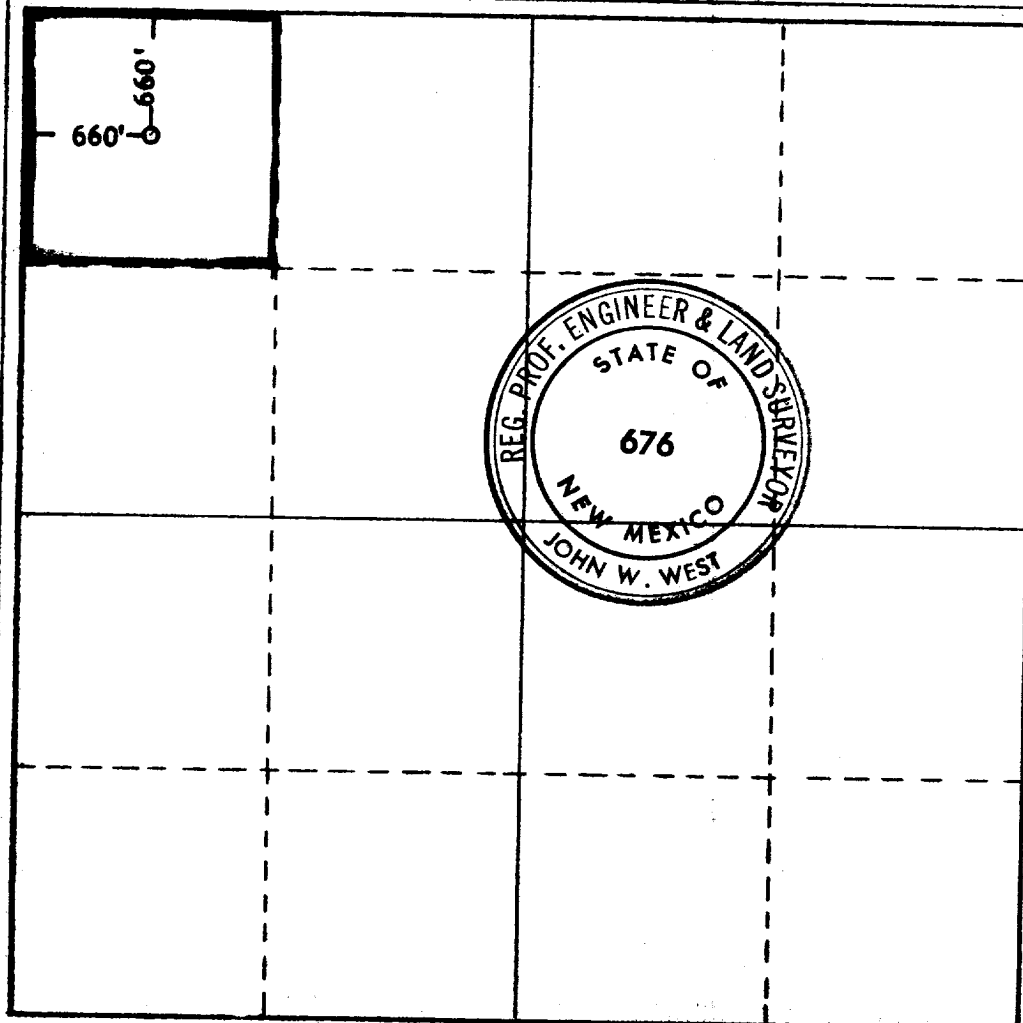

CERTIFICATION

I hereby certify that the information contained herein is true and complete to the best of my knowledge and belief.

Name
Harold E. Burke

Position
Production Supt.

Company
Shenandoah Oil Corp.

Date
August 15, 1966

I hereby certify that the well location shown on this plat was plotted from field notes of actual surveys made by me or under my supervision, and that the same is true and correct to the best of my knowledge and belief.

Date Surveyed
AUGUST 11, 1966

Registered Professional Engineer and/or Land Surveyor

John W. West
Certificate No.

676

173