

UNITED STATES
DEPARTMENT OF THE INTERIOR
GEOLOGICAL SURVEY

APPLICATION FOR PERMIT TO DRILL, DEEPEN, OR PLUG BACK

1a. TYPE OF WORK

DRILL ☒DEEPEN ☐PLUG BACK ☐

b. TYPE OF WELL

OIL
WELL ☒GAS
WELL ☐

OTHER

SINGLE
ZONE ☒MULTIPLE
ZONE ☐

2. NAME OF OPERATOR

Walter W. Krug dba Wallen Production Company

3. ADDRESS OF OPERATOR

Midland, Texas 79701

4. LOCATION OF WELL (Report location clearly and in accordance with any State requirements.)*

At surface

330' FNL & 330" FEL

At proposed prod. zone

same 3600'

14. DISTANCE IN MILES AND DIRECTION FROM NEAREST TOWN OR POST OFFICE*

28 miles WNW of Eunice N.M.

15. DISTANCE FROM PROPOSED*
LOCATION TO NEAREST
PROPERTY OR LEASE LINE, FT.
(Also to nearest drlg. line, if any)

330'

18. DISTANCE FROM PROPOSED LOCATION*
TO NEAREST WELL, DRILLING, COMPLETED,
OR APPLIED FOR, ON THIS LEASE, FT.

none

21. ELEVATIONS (Show whether DF, RT, GR, etc.)

GR 3633 feet

23.

PROPOSED CASING AND CEMENTING PROGRAM

SIZE OF HOLE	SIZE OF CASING	WEIGHT PER FOOT	SETTING DEPTH	QUANTITY OF CEMENT
15"	13 3/8"	48#	100'	cemented w/57 sxs
12 1/2"	10 3/4"	32.75#	700'	" " " " " "
10"	8 5/8"	24#	1300'	" " " " " "
8"	7"	23#	3150'	cemented w/100 sxs of class C neat and 363 sxs of Lodens
6 1/2"	4 1/2"	9.5#	3600'	cemented w/125 sxs class c neat cement

* 363 sxs of class C w/3% Gel and
Gilsonite, salt saturatedNOTIFY USGS IN SUFFICIENT TIME TO
WITNESS CEMENTING THE 7" CASING.

IN ABOVE SPACE DESCRIBE PROPOSED PROGRAM: If proposal is to deepen or plug back, give data on present productive zone and proposed new productive zone. If proposal is to drill or deepen directionally, give pertinent data on subsurface locations and measured and true vertical depths. Give blowout preventer program, if any.

24.

SIGNED

Walter W. Krug

TITLE partner

DATE 4-24-72

(This space for Federal or State office use)

PERMIT NO.

APPROVAL DATE

APPROVED BY

TITLE

DATE

CONDITIONS OF APPROVAL, IF ANY:

APPROVED
MAY 18 1972
ARTHUR R. BROWN
DISTRICT ENGINEER

*See Instructions On Reverse Side

RECEIVED

MAY 16 1972

**OIL CONSERVATION COMM.
HOBBS, N. M.**

NEW MEXICO OIL CONSERVATION COMMISSION
WELL LOCATION AND ACREAGE DEDICATION PLAT

Form C-102
Supersedes C-128
Effective 1-1-65

All distances must be from the outer boundaries of the Section.

Operator WALLEN PRODUCTION COMPANY		Lease FEDERAL		Well No. 3
Unit Letter "A"	Section 19	Township 20-S	Range 34-E	County LEA
Actual Footage Location of Well: 330 feet from the NORTH line and 330 feet from the EAST line				
Ground Level Elev. 3633	Producing Formation SEVEN RIVERS	Pool UNDESIGNATED LYNCH, NORTH		Dedicated Acreage: 40 Acres

1. Outline the acreage dedicated to the subject well by colored pencil or hachure marks on the plat below.
2. If more than one lease is dedicated to the well, outline each and identify the ownership thereof (both as to working interest and royalty).
3. If more than one lease of different ownership is dedicated to the well, have the interests of all owners been consolidated by communitization, unitization, force-pooling, etc?

☐ Yes ☒ No If answer is "yes," type of consolidation _____

If answer is "no," list the owners and tract descriptions which have actually been consolidated. (Use reverse side of this form if necessary.) None

No allowable will be assigned to the well until all interests have been consolidated (by communitization, unitization, forced-pooling, or otherwise) or until a non-standard unit, eliminating such interests, has been approved by the Commission.

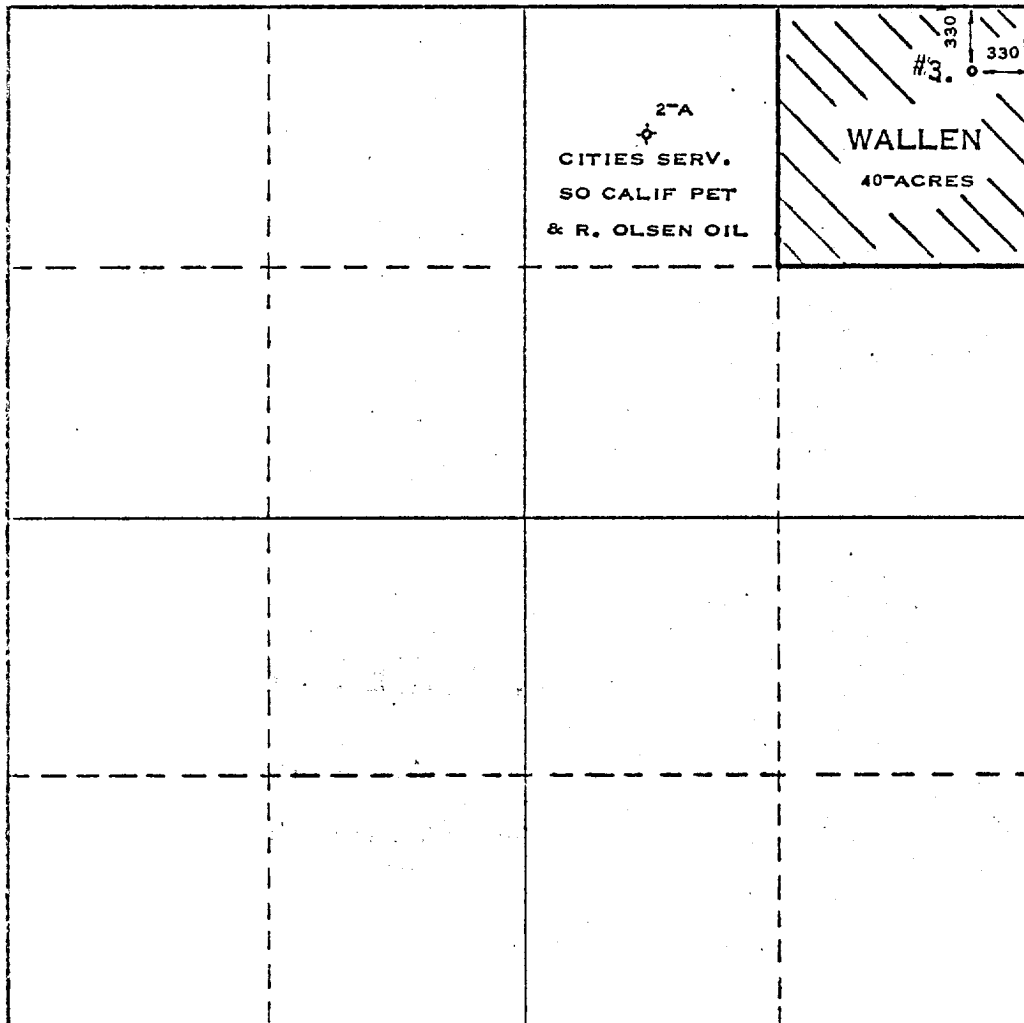

CERTIFICATION

I hereby certify that the information contained herein is true and complete to the best of my knowledge and belief.

Walter H. King
Name
Partner
Position
Wallen Prod Co.
Company
4/18/72
Date

I hereby certify that the well location shown on this plat was plotted from field notes of actual surveys made by me or under my supervision, and that the same is true and correct to the best of my knowledge and belief.

Date Surveyed
APRIL 15, 1972

Registered Professional Engineer and/or Land Surveyor

Max A. Schumann Jr.
MAX A. SCHUMANN JR.

Certificate No. **1510**

0 330 660 990 1320 1650 1980 2310 2640 2000 1500 1000 500 0

RECEIVED

MAY 15 1972

**OIL CONSERVATION COMM.
HOBBS, N. M.**