

COUNTY LEA FIELD Osudo, N. STATE NM
OPR ALPHA TWENTY-ONE PRODUCTION CO. API 30-025-24153
NO 1 LEASE State "JD" Com. MAP
Sec 29, T20S, R36E 8-3-36 NM
1650 FSL, 1980 FWL of Sec
7 mi NW/Oil Center RESPD 6-13-80 RECME 2-13-80

CSC

13 3/8-275-200 sx
9 5/8-5190-350 sx
5 1/2-11,425-525 sx
2 3/8-10,860

WELL CLASS: INIT DX FIN DG LSE. CODE			
FORMATION	DATUM	FORMATION	DATUM
TD 12,640 (DVNN)		PBD	11,380

IP (Morrow) Perfs 10,905-11,283 CAOF 396 MCFGPD. GOR Dry;
gty (Gas) .504; SIWHP 2277; SIBHP 3106

PLC: El Paso Natural Gas Co.

CONTR OPRSELEV 3639 GL sub-s

8-16-82 F.R.C. 8-21-82 OWWO
PD 11,380 WO (Morrow)
(Orig. Western Oil Producers, #1 State "J",
D&A 7-21-72, OTD 12,640)
TD 12,640; PBD 11,380; Complete
DO to 11,425
Ran 5 1/2 csg
Perf (Morrow) 10,905-11,283 w/36 shots
Acid (10,095-11,283) 6000 gals + 2000 gals CO2
(Morrow) FOUR POINT GAUGES:
Flwd 134 MCFGPD, chk (NR), 60 mins, TP 2015
Flwd 189 MCFGPD, chk (NR), 60 mins, TP 1815
Flwd 240 MCFGPD, chk (NR), 60 mins, TP 1581
Flwd 283 MCFGPD, chk (NR), 60 mins, TP 1351
BHT 176 deg @ 10,815
8-21-82 COMPLETION ISSUED

8-3-36 NM
IC 30-025-70673-82

CLASS										GL	
SPD		CMP		FORMATION		DATUM		FORMATION		DATUM	
5-28-72		7-21-72									
CSG & SX											
13 3/8" at 275' w/200 sx											
9 5/8" at 5190' w/350 sx											
LOGS EL GR RA IND HC A				TD 12,640'				PBD			
PLUGGED & ABANDONED											

CONTR	Moran	OPRS ELEV 3653 KB PD	12,800'	TYPE RI
-------	-------	----------------------	---------	---------

FR 6-5-72
(Devonian)
6-5-72 Drlg. 4439'
6-12-72 Drlg. 5220'
6-20-72 Drlg. 9300'
6-26-72 Drlg. 11,000'
7-11-72 Drlg. 12,200'
DST 11,070-11,92' "Tight" (Non Commercial)
7-17-72 Drlg. 12,620'
7-25-72 TD 12,640'; P&A
Attempted two DST's @ 12,640'
8-1-72 TD 12,640'; P&A
1-8-73 TD 12,640'; PLUGGED & ABANDONED
Well Drilled "Tight"
LOG TOPS: Third Bone Spring Sand 10,000',
Wolfcamp Lime 10,140', Strawn 10,569',

1-8-73

Continued

Atoka 10,776', Morrow 10,900', Barnett
11,560', Mississippian Lime 11,760',
Woodford 12,390', Devonian 12,579'

1-13-73

COMPLETION REPORTED

NEW MEXICO OIL CONSERVATION COMMISSION
WELL LOCATION AND ACREAGE DEDICATION PLAT

Form No. 102
C-126
Effective 1-1-65

All distances must be from the outer boundaries of the Section.

Operator Alpha Twenty-One Production Company			Lease State "J"		Well No. 1
Unit Letter K	Section 29	Township 20S	Range 36E	County Lea	
Actual Footage Location of Well: 1980 feet from the West line and 1650 feet from the South line					
Ground Level Elev. 3639'	Producing Formation Morrow		Pool North Osudo		Dedicated Acreage: 320 Acres

1. Outline the acreage dedicated to the subject well by colored pencil or hachure marks on the plat below.
2. If more than one lease is dedicated to the well, outline each and identify the ownership thereof (both as to working interest and royalty). Leases E1639 and L06434 - State Royalty
3. If more than one lease of different ownership is dedicated to the well, have the interests of all owners been consolidated by communitization, unitization, force-pooling, etc?

☐ Yes ☒ No If answer is "yes," type of consolidation _____

If answer is "no," list the owners and tract descriptions which have actually been consolidated. (Use reverse side of this form if necessary.) Communitization in process and applied for.

No allowable will be assigned to the well until all interests have been consolidated (by communitization, unitization, forced-pooling, or otherwise) or until a non-standard unit, eliminating such interests, has been approved by the Commission.

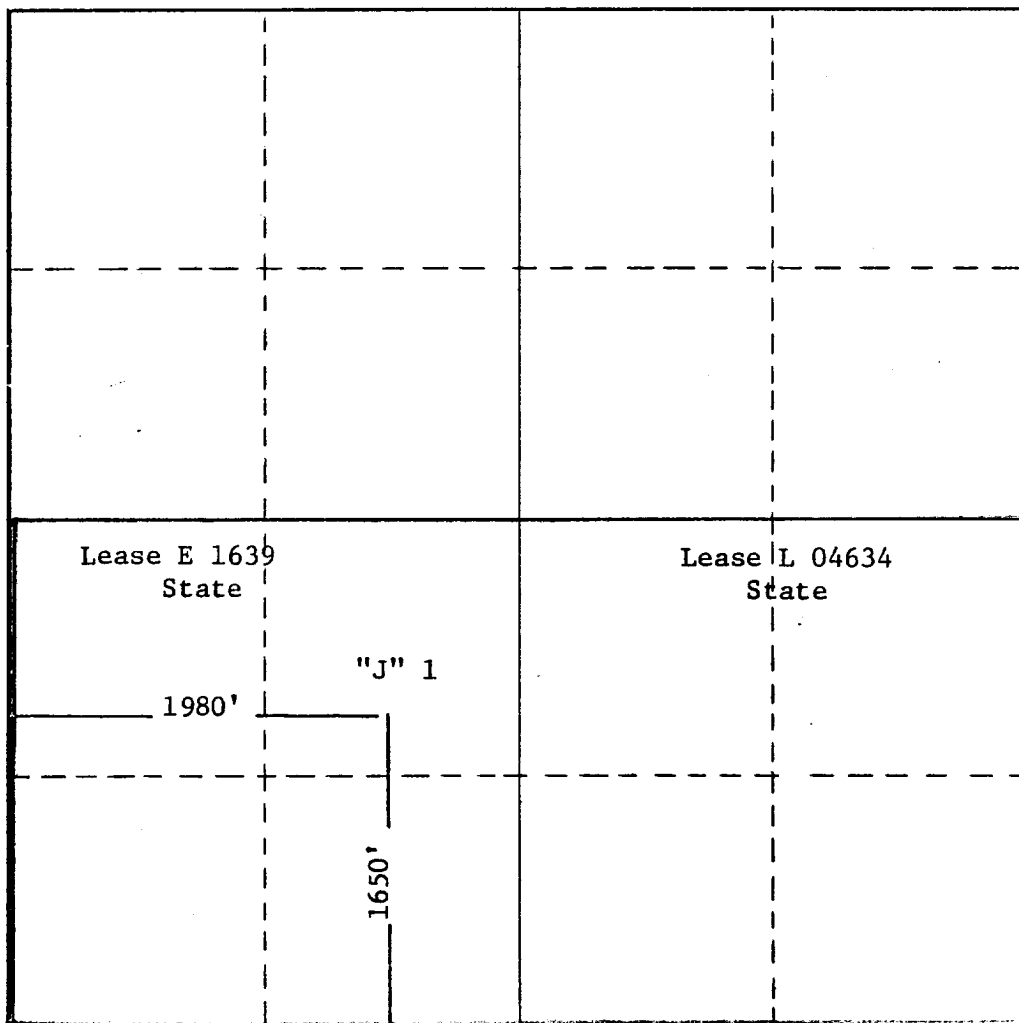

CERTIFICATION

I hereby certify that the information contained herein is true and complete to the best of my knowledge and belief.

[Signature]

Name
Tommy Phipps

Position
Executive Vice President

Company
Alpha Twenty-One Production Co.

Date
6-10-80

I hereby certify that the well location shown on this plat was plotted from field notes of actual surveys made by me or under my supervision, and that the same is true and correct to the best of my knowledge and belief.

Date Surveyed

Registered Professional Engineer and/or Land Surveyor

Certificate No.

