

Submit to Appropriate
District Office
State Lease - 6 copies
Fee Lease - 5 copies

State of New Mexico
Energy, Minerals and Natural Resources Department

Form C-101
Revised 1-1-89

OIL CONSERVATION DIVISION

P.O. Box 2088

Santa Fe, New Mexico 87504-2088

DISTRICT I
P.O. Box 1980, Hobbs, NM 88240

DISTRICT II
P.O. Drawer DD, Artesia, NM 88210

DISTRICT III
1000 Rio Brazos Rd., Aztec, NM 87410

API NO. (assigned by OCD on New Wells)

30-025-24494

5. Indicate Type of Lease

STATE ☐

FEE ☒

6. State Oil & Gas Lease No.

APPLICATION FOR PERMIT TO DRILL, DEEPEN, OR PLUG BACK

1a. Type of Work:

DRILL ☐

RE-ENTER ☒

DEEPEN ☐

PLUG BACK ☐

b. Type of Well:

OIL
WELL ☐

GAS
WELL ☒

OTHER

SINGLE
ZONE ☐

MULTIPLE
ZONE ☐

7. Lease Name or Unit Agreement Name

Perla

2. Name of Operator

Nearburg Producing Company

8. Well No.

1

3. Address of Operator

P. O. Box 823085, Dallas, Texas 75382-3085

9. Pool name or Wildcat

Wildcat

4. Well Location

Unit Letter J : 2,310 Feet From The south Line and 1,980 Feet From The east Line

Section 19

Township 19S

Range 36E

NMPM

Lea

County

10. Proposed Depth

13,104'

11. Formation

Morrow

12. Rotary or C.T.

Rotary

13. Elevations (Show whether DF, RT, GR, etc.)

3,691' GR

14. Kind & Status Plug. Bond

Blanket

15. Drilling Contractor

Cobra Well Service

16. Approx. Date Work will start

2/27/91

17.

PROPOSED CASING AND CEMENT PROGRAM

SIZE OF HOLE	SIZE OF CASING	WEIGHT PER FOOT	SETTING DEPTH	SACKS OF CEMENT	EST. TOP
17-1/2"	13-3/8" existing	42#	400'	400 sx	circulated
12-1/4"	9-5/8" existing	40#	5,345'	2,400 sx	circulated
8-1/2"	7-5/8" existing	26.40 & 29.70#	5,046'-11,230'	1,300 sx	
6-1/2"	5-1/2" existing	23#	10,891'-13,063'	270 sx	

This well was drilled and plugged December 13, 1973 by Clayton W. Williams, Jr., operator. The well was drilled to a total depth of 13,104'. The well was then re-entered by MGF corporation in September, 1974 to test the Bone Spring formation.

Nearburg Producing Company proposes re-entry to test the Morrow formation.

BOP program attached.

Gas is not dedicated.

IN ABOVE SPACE DESCRIBE PROPOSED PROGRAM: IF PROPOSAL IS TO DEEPEN OR PLUG BACK, GIVE DATA ON PRESENT PRODUCTIVE ZONE AND PROPOSED NEW PRODUCTIVE ZONE. GIVE BLOWOUT PREVENTER PROGRAM, IF ANY.

I hereby certify that the information above is true and complete to the best of my knowledge and belief.

SIGNATURE Mildred Simpkins TITLE Production Analyst DATE 2/19/91

TYPE OR PRINT NAME Mildred Simpkins TELEPHONE NO. 214/739-1778

(This space for State Use)

APPROVED BY [Signature] TITLE [Signature] DATE FEB 22 1991

CONDITIONS OF APPROVAL, IF ANY:

Permit Expires 6 Months From Approval
Date Unless Drilling Underway.

Submit to Appropriate
District Office
State Lease - 4 copies
Fee Lease - 3 copies

State of New Mexico
Energy, Minerals and Natural Resources Department

Form C-102
Revised 1-1-89

OIL CONSERVATION DIVISION

P.O. Box 2088

Santa Fe, New Mexico 87504-2088

DISTRICT I
P.O. Box 1980, Hobbs, NM 88240

DISTRICT II
P.O. Drawer DD, Artesia, NM 88210

DISTRICT III
1000 Rio Brazos Rd., Aztec, NM 87410

WELL LOCATION AND ACREAGE DEDICATION PLAT

All Distances must be from the outer boundaries of the section

Operator Nearburg Producing Company			Lease Perla		Well No. 1
Unit Letter J	Section 19	Township 19 South	Range 36 East	County Lea	
Actual Footage Location of Well: 2310 feet from the South line and 1980 feet from the East line					
Ground level Elev. 3691	Producing Formation Morrow		Pool Wildcat	Dedicated Acreage: 320 640.00 Acres	

- Outline the acreage dedicated to the subject well by colored pencil or hatchure marks on the plat below.
- If more than one lease is dedicated to the well, outline each and identify the ownership thereof (both as to working interest and royalty).
- If more than one lease of different ownership is dedicated to the well, have the interest of all owners been consolidated by communitization, unitization, force-pooling, etc.?
☒ Yes ☐ No If answer is "yes" type of consolidation Communitization Agreement
If answer is "no" list the owners and tract descriptions which have actually been consolidated. (Use reverse side of this form if necessary.)
No allowable will be assigned to the well until all interests have been consolidated (by communitization, unitization, forced-pooling, or otherwise) or until a non-standard unit, eliminating such interest, has been approved by the Division.

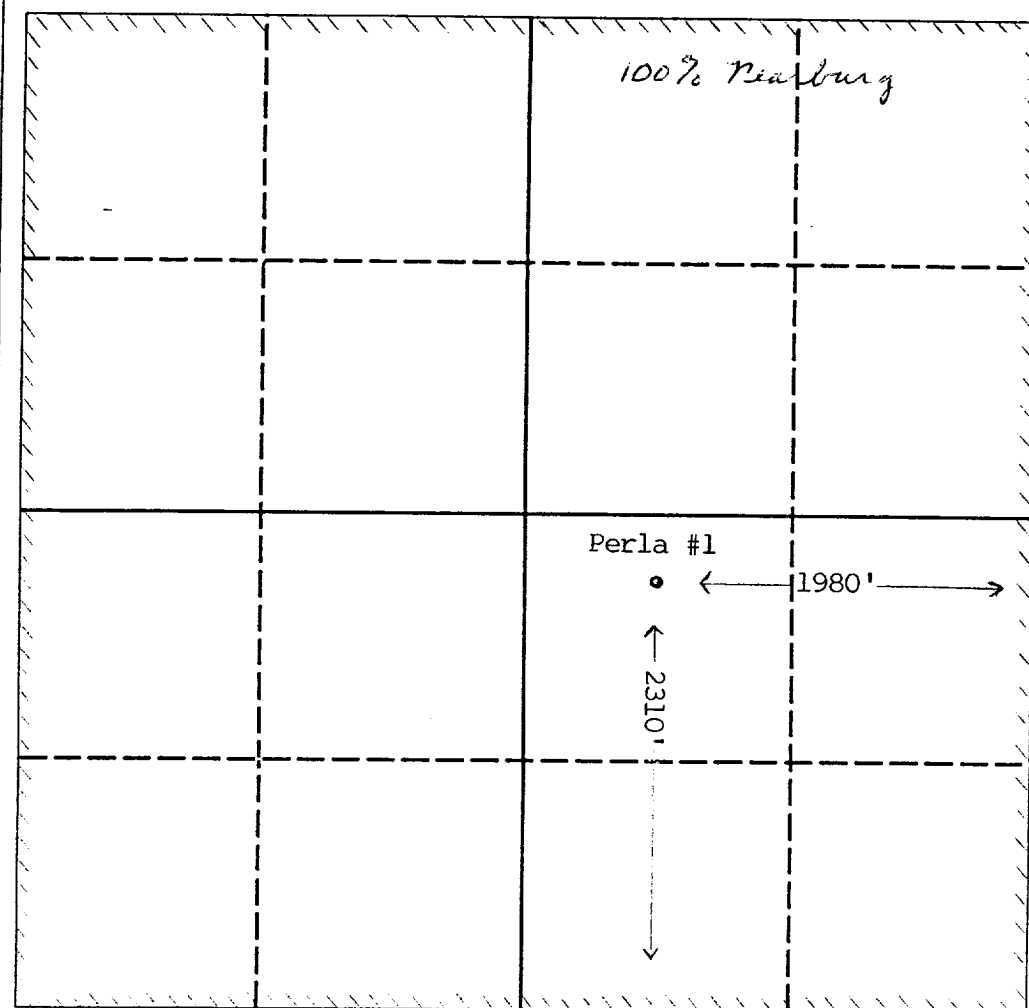

OPERATOR CERTIFICATION

I hereby certify that the information contained herein is true and complete to the best of my knowledge and belief.

Signature
Kathie Craft
Printed Name
Kathie Craft
Position
Land Administrator
Company
Nearburg Producing Co.
Date
February 19, 1991

SURVEYOR CERTIFICATION

I hereby certify that the well location shown on this plat was plotted from field notes of actual surveys made by me or under my supervision, and that the same is true and correct to the best of my knowledge and belief.

Date Surveyed
Signature & Seal of Professional Surveyor
Official Surveyor's Plat
On File In OCD Office For
Perla #1 Originally Drilled
By Clayton W. Williams, Jr.
Certificate No.

