

UNITED STATES
DEPARTMENT OF THE INTERIOR
GEOLOGICAL SURVEY

APPLICATION FOR PERMIT TO DRILL, DEEPEN, OR PLUG BACK

1a. TYPE OF WORK

DRILL ☒DEEPEN ☐PLUG BACK ☐

b. TYPE OF WELL

OIL
WELL ☒GAS
WELL ☐

OTHER

SINGLE
ZONE ☒MULTIPLE
ZONE ☐

2. NAME OF OPERATOR

Anadarko Production Company

3. ADDRESS OF OPERATOR

P. O. Box 247, Hobbs, New Mexico 88240

4. LOCATION OF WELL (Report location clearly and in accordance with any State requirements.*)

At surface

990' FNL & 990' FWL

At proposed prod. zone

Same as above

14. DISTANCE IN MILES AND DIRECTION FROM NEAREST TOWN OR POST OFFICE*

30 miles SW Hobbs, New Mexico

15. DISTANCE FROM PROPOSED*

LOCATION TO NEAREST

PROPERTY OR LEASE LINE, FT.

(Also to nearest drlg. unit line, if any)

1300'

18. DISTANCE FROM PROPOSED LOCATION*
TO NEAREST WELL, DRILLING, COMPLETED,
OR APPLIED FOR, ON THIS LEASE, FT.

850'

16. NO. OF ACRES IN LEASE

1160

19. PROPOSED DEPTH

3400'

17. NO. OF ACRES ASSIGNED
TO THIS WELL

40

20. ROTARY OR CABLE TOOLS

Rotary

21. ELEVATIONS (Show whether DF, RT, GR, etc.)

22. APPROX. DATE WORK WILL START*

5/15/74

5. LEASE DESIGNATION AND SERIAL NO.

LC 065658

6. IF INDIAN, ALLOTTEE OR TRIBE NAME

7. UNIT AGREEMENT NAME

Teas Yates Unit

8. FARM OR LEASE NAME

Tract No. 5

9. WELL NO.

5

10. FIELD AND POOL, OR WILDCAT

Teas Yates

11. SEC., T., R., M., OR BLK.
AND SURVEY OR AREA

14-T20S-R33E

12. COUNTY OR PARISH

Lea

13. STATE

N. Mex.

23.

PROPOSED CASING AND CEMENTING PROGRAM

SIZE OF HOLE	SIZE OF CASING	WEIGHT PER FOOT	SETTING DEPTH	QUANTITY OF CEMENT
12 1/4"	9-5/8"	36#	1400'	740 sks-circulate to surface
8-3/4"	7"	23#	3100'	650 sks-circulate to surface
6 1/4"	5 1/2"	17#	3400'	50 sks

See Attached Prognosis

IN ABOVE SPACE DESCRIBE PROPOSED PROGRAM: If proposal is to deepen or plug back, give data on present productive zone and proposed new productive zone. If proposal is to drill or deepen directionally, give pertinent data on subsurface locations and measured and true vertical depths. Give blowout preventer program, if any.

24.

SIGNED

TITLE

Division Evaluation Eng.

DATE

4-18-74

(This space for Federal or State office use)

PERMIT NO.

APPROVAL DATE

APPROVED BY

TITLE

DATE

CONDITIONS OF APPROVAL, IF ANY:

Instructions

General: This form is designed for submitting proposals to perform certain well operations, as indicated, on all types of lands and leases for appropriate action by either a Federal or a State agency, or both, pursuant to applicable Federal and/or State laws and regulations. Any necessary special instructions concerning the use of this form and the number of copies to be submitted, particularly with regard to local, area, or regional procedures and practices, either are shown below or will be issued by, or may be obtained from, the local Federal and/or State office.

Item 1: If the proposal is to redrill to the same reservoir at a different subsurface location or to a new reservoir, use this form with appropriate notations. Consult applicable State or Federal regulations concerning subsequent work proposals or reports on the well.

Item 4: If there are no applicable State requirements, locations on Federal or Indian land should be described in accordance with Federal requirements. Consult local State or Federal office for specific instructions.

Item 14: Needed only when location of well cannot readily be found by road from the land or lease description. A plat, or plats, separate or on this reverse side, showing the roads to, and the surveyed location of, the well, and any other required information, should be furnished when required by Federal or State agency offices.

Items 15 and 18: If well is to be, or has been directionally drilled, give distances for subsurface location of hole in any present or objective production zone.

Item 22: Consult applicable Federal or State regulations, or appropriate officials, concerning approval of the proposal before operations are started.

ANADARKO PRODUCTION COMPANY
DRILLING PROGNOSIS

HOUSTON DIVISION

SOUTHERN REGION

Lease: Teas Yates Unit

Well No. 5-5

Field: Teas Yates

State: New Mexico

Location: 990 FN & 990 FW Section 14-T20S-R33E, Lea County, New Mexico

DRILLING, CASING AND CEMENTING PROGRAM:

1. Drill 12 $\frac{1}{4}$ " hole to 1400'.
2. Set 9-5/8", 36# J-55 ST&C casing on bottom. Cement with 750 sacks regular cement with 2% CaCl. OCC requires cement to circulate. OCC Rule No. 111 requires surface casing to be set in the anhydrite on top of the salt. Cement will be allowed to stand a minimum of 12 hours under pressure and a total of twenty-four (24) hours before drilling the plug or initiating tests.
3. Install and nipple up double ram BOP before drilling plug on surface casing. Test BOP to 1500 psi.
4. Casing and water-shut-off tests shall be made with fresh water before and after drilling the plug and below the casing seat as follows: A hydraulic pressure of 600 psi shall be applied. If a drop of 100 psi or more should occur within 30 minutes, corrective measures shall be applied.
5. Drill 8-3/4" hole to top of Yates, approximately 3100'. **(SALT SATURATED MUD)**
6. Set 7" OD, 23# J-55 ST&C casing on bottom at 3100' & cement with 650 sacks regular neat cement mixed with brine water and minimum of 1% CaCl to circulate to surface. Cement will be allowed to stand a minimum of 12 hours under pressure and 24 hours before drilling the plug or initiating tests.
7. Casing tests shall be made with fresh water before and after drilling the plug and below the casing seat, as follows: A hydraulic pressure of 1000 psi shall be applied. If a drop of 100 psi or more should occur within 30 minutes, corrective measures shall be applied.
8. Drill out after 24 hrs setting time. Drill 6 $\frac{1}{4}$ " hole to TD 3400'.
9. No drill stem tests will be conducted.
10. Logs will consist of Gamma Ray-Neutron, Compensated Neutron & Laterolog.

11. Release drilling rig.
12. Rig up well service unit and run 400' string of 5½", 17# K-55 flush joint liner. Liner will be sand blasted and bond coated. Set liner on Baker Liner Hanger in 7" OD casing.
13. Cement liner with 50 sacks Class C cement. Cement will be allowed to stand a minimum of 12 hours under pressure and a total of 24 hours before initiating tests.
14. Liner test shall be made with fresh water as follows: A hydraulic pressure of 1000 psi shall be applied. If a drop of 100 psi or more should occur within 30 minutes, corrective measures shall be applied.

MUD PROGRAM

0-3000'	Native mud
3001-3100'	Gel and starch to raise viscosity to 35 sec., weight to 10 ppg and water loss to 12 cc.
3101-3400'	Maintain the above to TD.

BLOWOUT PREVENTORS:

1. Use series 900 double ram hydraulic blowout preventors, or equivalent.
2. When nipping up, test blowout preventor and choke manifold to 1500 psi.

CORING:

No cores are recommended.

DRILL STEM TESTING:

No drill stem testing is recommended.

LOGGING

At TD open hole Gamma Ray-Neutron, Compensated Neutron, Laterolog will be run. Detail section logs to 2400'. Run regular interval to surface.

SAMPLES

No samples, 0-2400' or the bottom of salt section. 2400' - 3400' 10' samples.

DRILLING TIME:

A mechanical recorder with Time, Rate of Penetration and Hook Load.

FORMATION TOPS:

Anhydrite	1380'
Salt	1510'
B/Salt	2990'
Yates	3170'

DRILL PIPE MEASUREMENT:

1. Drill pipe will be tallied at all casing points and logging.

HOLE DEVIATION:

1. Deviation surveys shall be taken every 500' or each trip, whichever occurs first, and at other times as directed by Company representatives.
2. Maximum deviation to be 5°.
3. Maximum rate of change: 1° per 100'.

MISCELLANEOUS:

1. Daily drilling reports will be completely filled out each 8 hour tour. Two copies will be furnished to Anadarko.
2. An accurate accounting of mud materials used each tour will be recorded on daily drilling report.
3. Company representative to be contacted in the event of any question will be:

Farris Nelson - Office - Eunice	394-3184
Home - Hobbs	397-1184

Fred Risenhoover - Office-Eunice	394-3184
Home - Eunice	394-2262

R-33-E

R-34-E

T
20
S

T
20
S

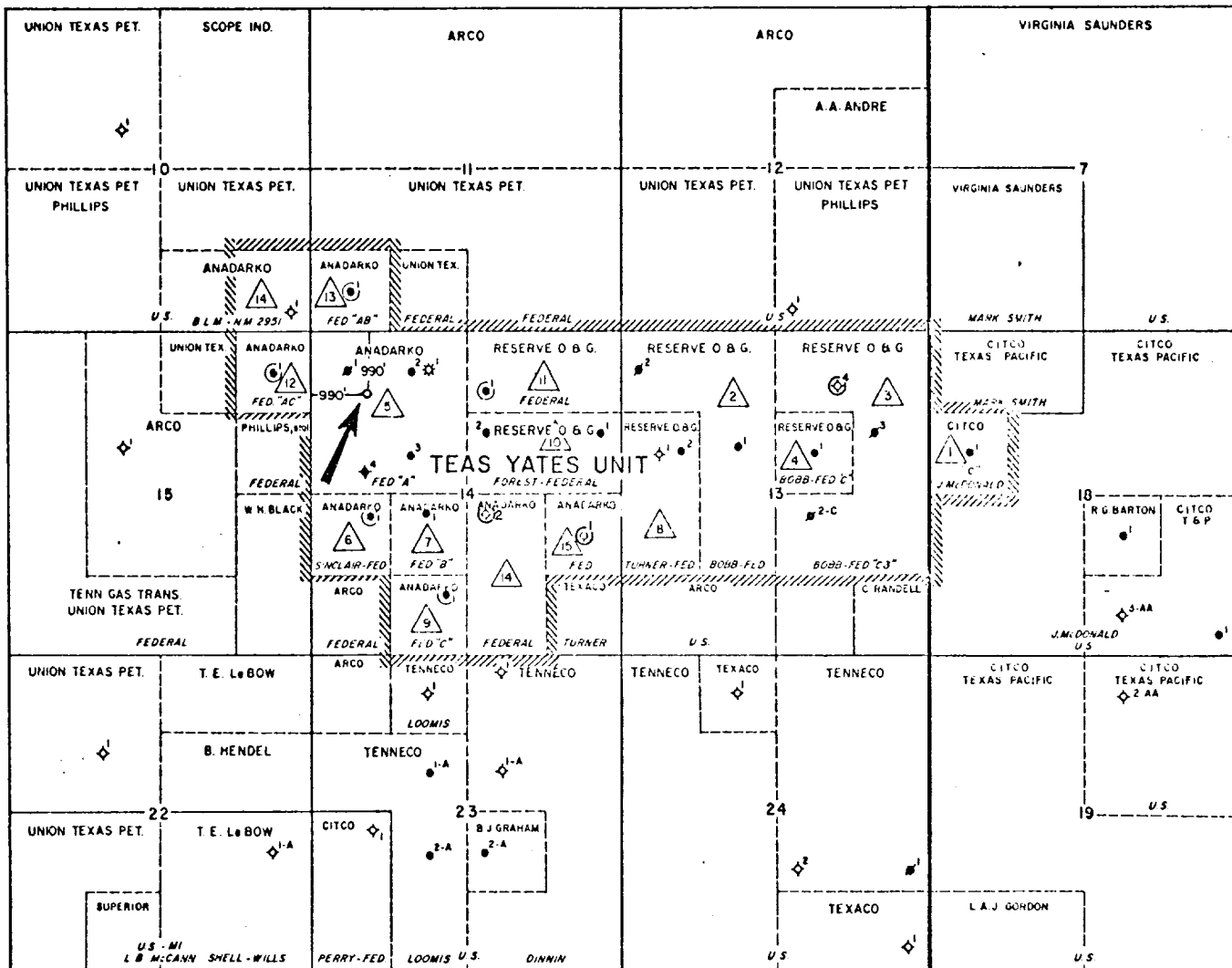

NEW MEXICO OIL CONSERVATION COMMISSION
WELL LOCATION AND ACREAGE DEDICATION PLAT

File No.
Superintendent's
Office

ANADARKO PRODUCTION CO.

TEAS YATES UNIT TR. 5

5

D

14

20 SOUTH

33 EAST

LEA

990

NORTH

990

WEST

3569.7

Yates

Teas Yates

40

Date of the acreage dedication to the subject well be _____ and the location of the well be _____

If more than one lease is dedicated to the well, outline each and identify the ownership therefor, the interest and royalty.

If more than one lease of different ownership is dedicated to the well, have the interests of all owners dated by community unitization or pooling agreement.

☒ Yes ☐ No If answer is "Yes" type in owners' names _____

If answer is "No" list the owners and the dates of interests if they have actually been interests dated in some manner on this form if necessary _____

No owner will be assigned to the well and all interests have been interests dated by community unitization or pooling agreement or otherwise or until a non-standard amount of interests has been approved by the Commission.

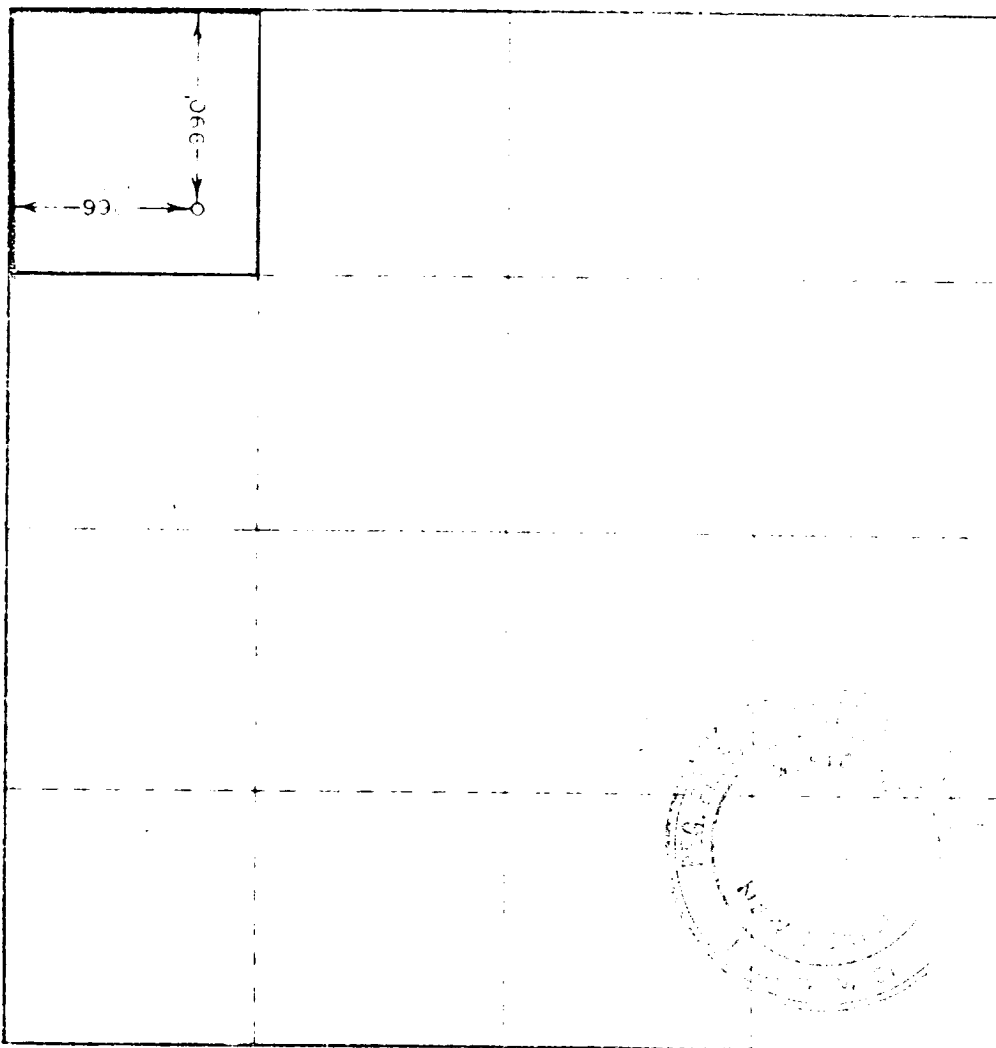

I hereby certify that the well shown hereon is true and correct to the best of my knowledge and belief.

Area Supervisor

Anadarko Production Co.

10-1-73

I hereby certify that the well shown on this plat was plotted by the notes of actual surveys made to the land under the supervision and that the same is true and correct to the best of my knowledge and belief.

SEPTEMBER 28, 1973

John W. West

676

GENERAL OFFICE
P. O. BOX 9317
FORT WORTH, TEXAS 76107



ANADARKO PRODUCTION COMPANY
TWO GREENWAY PLAZA EAST, SUITE 410, HOUSTON, TEXAS 77046, (713) 626-7610

April 18, 1974

United States Geological Survey
P. O. Box 1157
Hobbs, New Mexico 88240

Gentlemen:

Following is the "Plan of Development" for the drilling of the Anadarko Production Company Teas Yates Unit Tract No. 5 Well No. 5 located 990' FNL and 990' FWL of Section 14, Township 20 South, Range 33 East, Lea County, New Mexico.

1. Existing Roads - The existing lease roads and U.S. Highway No. 180 are indicated on the attached plat. Points of entrance to the lease from U.S. No. 180 are also indicated.
2. Planned Access Roads - Only approximately 650' of additional lease road is proposed. This will be 16' wide and it will be capped with 6" compacted caliche. This road is indicated on the plat as a dashed red line.
3. Well Locations - All well locations are indicated on the attached plat.
4. Lateral Roads to Location - Road information is covered in No. 1 and 2 above.
5. Tank Battery and Flow Lines - The tank battery is already installed. The flow line will intersect a trunk flow line approximately 650' east of the proposed location. The flow line will be 2" steel line pipe.
6. Location and Type of Water Supply - All water necessary for the drilling operations will be hauled to the location by truck transport.
7. Method of Handling Waste Disposal - Trash and junk should be buried in a separate trash pit including cuttings, garbage and trash will be disposed of in the drilling pits and be covered when the pits are cleaned up.

TRASH AND JUNK SHOULD BE
BURIED IN A SEPARATE TRASH PIT

8. Location of Camps - No camps are planned.
9. Location of Airstrips - No airstrips are planned.
10. Drilling Rig Layout - Attached plat gives the position of the rig, mud tanks, reserve pits, pipe racks, and access road location on the drilling pad.
11. Plans for Restoration of Surface - The surface included in the reserve pit and mud pits will be leveled. Other requirements of U.S.G.S. and N.M.O.C.C. will be complied with.
12. Other Information - The proposed well is in a developed oil field. Other wells in this area are responding to an active waterflood. The proposed location is in an area of very sandy grazing land.

Your approval of this application will serve to help provide additional oil for energy at a time when our energy supply is short.

Your very truly,

M. F. Nelson
Area Supervisor.

MFN/kp

R-33-E

R-34-E

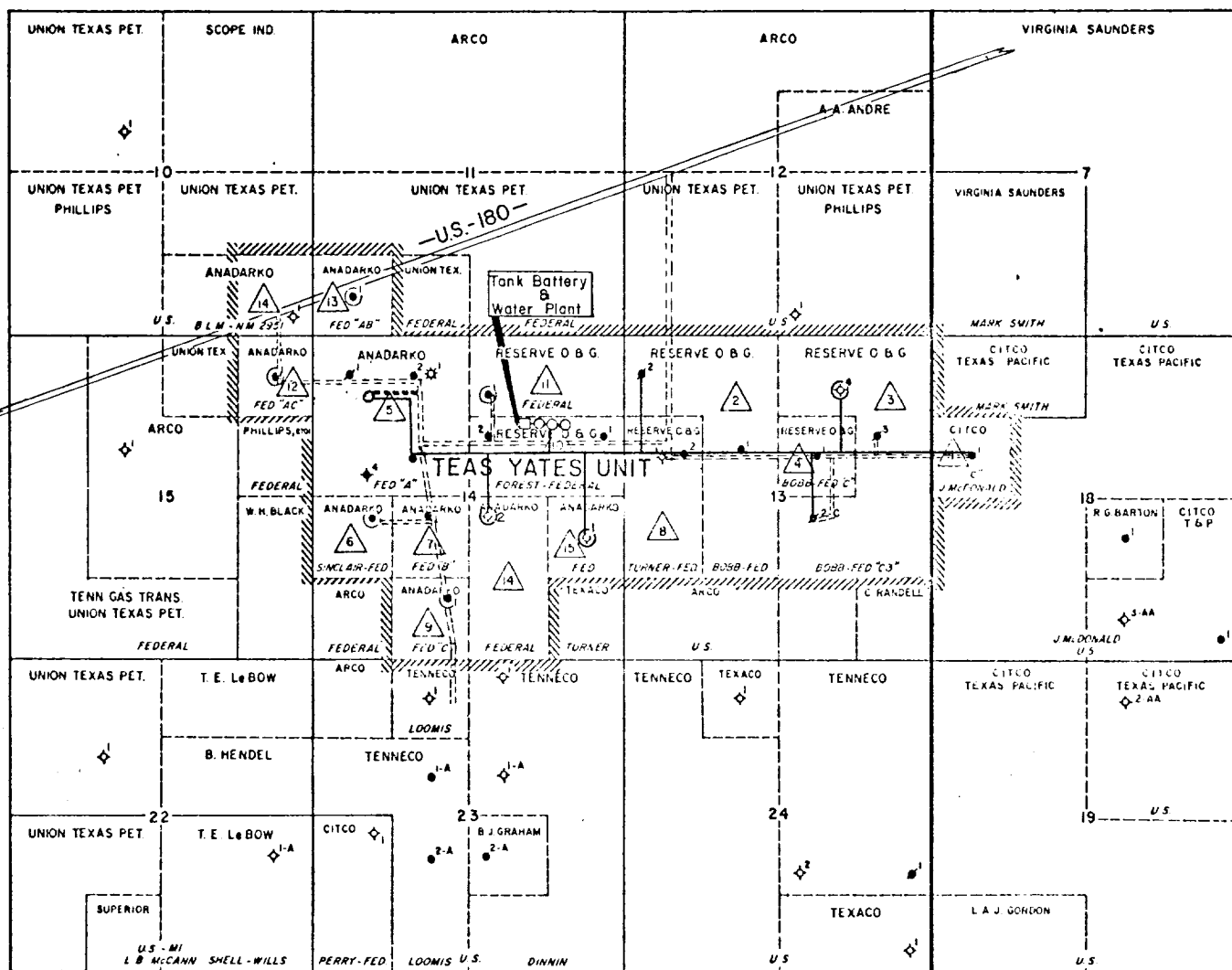
T
20
ST
20
S

LEGEND

- Oil Well
- ◆ Plugged & Abandoned
- ⊕ Temporarily Abandoned
- ◇ Dry & Abandoned
- ⊙ Water Injection Well
- Proposed Boundary
- △ Tract Number
- Proposed Location
- ⊕ Proposed Re-entry
- Proposed Lease Road
- ===== Existing Lease Roads
- Flow Line & W.I. System



**ANADARKO
PRODUCTION COMPANY**

TEAS YATES UNIT
LEA COUNTY, NEW MEXICO
FLOOD NO. 54

0 1500 3000 4500 6000
SCALE FEET

ANADARKO PRODUCTION COMPANY

Teas Yates Unit No. 5-5

Location & Rig Layout

