

NO. OF COPIES RECEIVED	
DISTRIBUTION	
DATE	
FILE	
U.S.G.S.	
LAND OFFICE	
OPERATOR	

NEW MEXICO OIL CONSERVATION COMMISSION

Form C-101
Revised 1-1-65

5A. Indicate Type of Lease	
STATE <input type="checkbox"/>	FEE <input checked="" type="checkbox"/>
5. State Oil & Gas Lease No.	

APPLICATION FOR PERMIT TO DRILL, DEEPEN, OR PLUG BACK

1a. Type of Work		7. Unit Agreement Name	
b. Type of Well OIL WELL <input type="checkbox"/> GAS WELL <input type="checkbox"/> OTHER <input checked="" type="checkbox"/> Wildcat DEEPEN <input type="checkbox"/> PLUG BACK <input type="checkbox"/>		8. Farm or Lease Name Bilbrey	
2. Name of Operator Mark Production Company		9. Well No. 1	
3. Address of Operator 330 Citizens Bank Building, Tyler, Texas 75701		10. Field and Pool, or Wildcat Wildcat	
4. Location of Well UNIT LETTER <u>A</u> LOCATED <u>330</u> FEET FROM THE <u>N</u> LINE AND <u>660</u> FEET FROM THE <u>E</u> LINE OF SEC. <u>19</u> TWP. <u>19</u> S RGE. <u>38</u> E NMPM		12. County Lea	
19. Proposed Depth 7800'		19A. Formation Abo	
20. Rotary or C.T. Rotary		21. Elevations (Show whether DF, RT, etc.) 3596 GL	
21A. Kind & Status Plug. Bond \$10,000 Blanket		21B. Drilling Contractor N/A	
22R Approx. Date Work will start January 7, 1976			

23.

PROPOSED CASING AND CEMENT PROGRAM

SIZE OF HOLE	SIZE OF CASING	WEIGHT PER FOOT	SETTING DEPTH	SACKS OF CEMENT	EST. TOP
17-1/2"	12-3/4"	48#	300	Circulate	Circulate
11"	8-5/8"	24#	1600	300 Sacks	700'
7-7/8"	5-1/2"	15.5# & 17.0#	7800'	1000 Sacks	2800'

Shaffer Model 39 - 3000# Hydraulic Blowout Preventer

Mud Program:

0 - 300 Spud Mud
300 - 1600 Native Mud
1600 - 4500 Water
4500 - 7800/9.0 - 9.5 MW, Vis 34 - 40, WL 10 - 20cc
Mud up

Expires 2/11/76

IN ABOVE SPACE DESCRIBE PROPOSED PROGRAM: IF PROPOSAL IS TO DEEPEN OR PLUG BACK, GIVE DATA ON PRESENT PRODUCTIVE ZONE AND PROPOSED NEW PRODUCTIVE ZONE. GIVE BLOWOUT PREVENTER PROGRAM, IF ANY.

I hereby certify that the information above is true and complete to the best of my knowledge and belief.

Signed Margerie Lotz Title Production Clerk Date 12/8/75
(This space for State Use)

APPROVED BY Jerry Carter TITLE State Engineer DATE _____
CONDITIONS OF APPROVAL, IF ANY:

MARK PRODUCTION COMPANY			BILBREY		Well No. 1
Unit Letter "A"	Section 19	Township 19 S.	Range 38 E.	County Lea	
Actual Footage Location of Well:					
330 feet from the North line and		660 feet from the East line			
Ground Level Elev. 3596	Producing Formation Abo	Pool Wildcat	Dedicated Acreage: 40 Acres		

1. Outline the acreage dedicated to the subject well by colored pencil or hachure marks on the plat below.
2. If more than one lease is dedicated to the well, outline each and identify the ownership thereof (both as to working interest and royalty).
3. If more than one lease of different ownership is dedicated to the well, have the interests of all owners been consolidated by communitization, unitization, force-pooling, etc?

☐ Yes ☐ No If answer is "yes," type of consolidation _____

If answer is "no," list the owners and tract descriptions which have actually been consolidated. (Use reverse side of this form if necessary.) _____

No allowable will be assigned to the well until all interests have been consolidated (by communitization, unitization, forced-pooling, or otherwise) or until a non-standard unit, eliminating such interests, has been approved by the Commission.

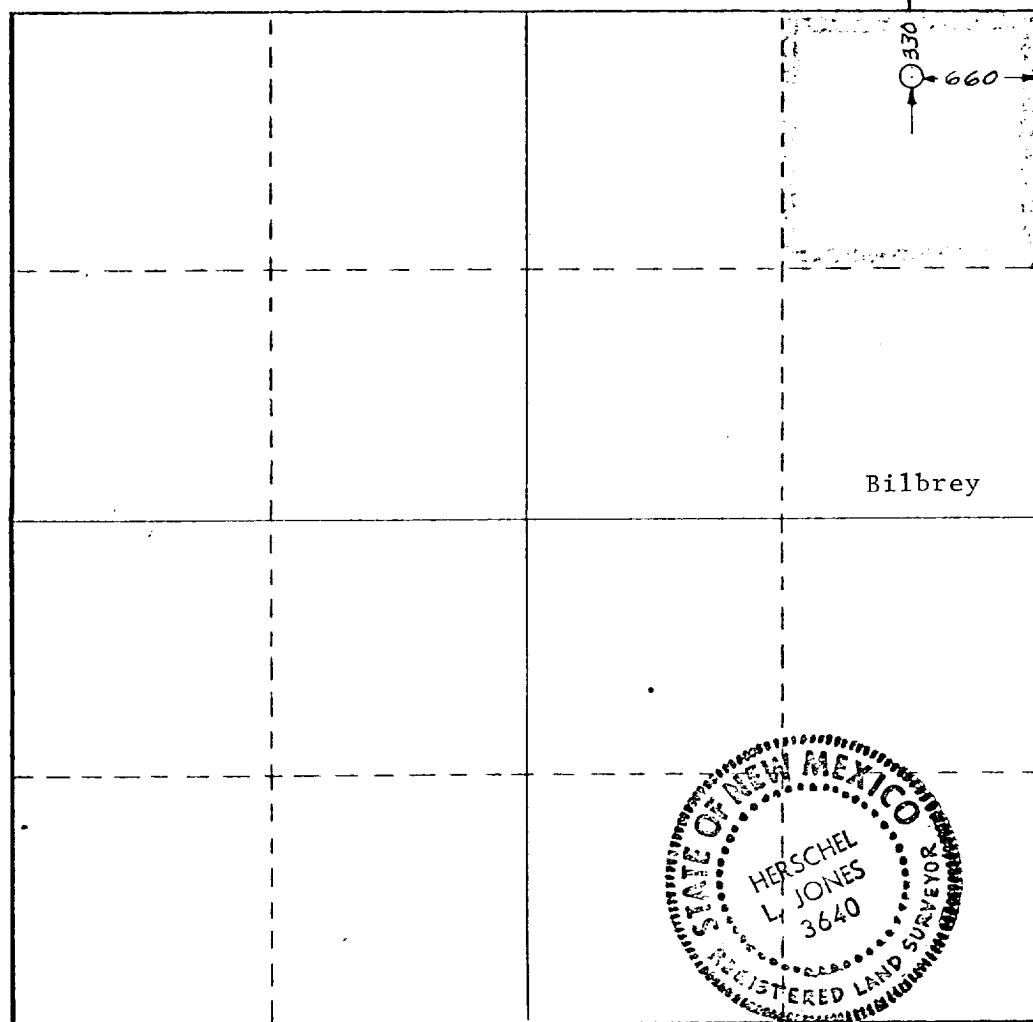

CERTIFICATION

I hereby certify that the information contained herein is true and complete to the best of my knowledge and belief.

Name Majara Lotz
 Position Production Clerk
 Company Mark Production Company
 Date December 8, 1975

I hereby certify that the well location shown on this plat was plotted from field notes of actual surveys made by me or under my supervision, and that the same is true and correct to the best of my knowledge and belief.

Date Surveyed November 26, 1975

Registered Professional Engineer and/or Land Surveyor

Herschel L. Jones
 Certificate No. 3640

0 330 660 990 1320 1650 1980 2310 2640 2000 1500 1000 500 0

RECEIVED

DEC 11 1975

THE CONSERVATION OF AN

173