

UNITED STATES
DEPARTMENT OF THE INTERIOR
GEOLOGICAL SURVEY

APPLICATION FOR PERMIT TO DRILL, DEEPEN, OR PLUG BACK

5. LEASE DESIGNATION AND SERIAL NO.

LC 070315

6. IF INDIAN, ALLOTTEE OR TRIBE NAME

7. UNIT AGREEMENT NAME

8. FARM OR LEASE NAME

WALLEN BASS

9. WELL NO.

1

10. FIELD AND POOL, OR WILDCAT

MIDDLE LYNCH YATES-7 RIVERS

11. SEC., T., R., M., OR BLK.
AND SURVEY OR AREA

SEC. 21, T. 20 S., R. 34 E.

12. COUNTY OR PARISH

LEA

13. STATE

NEW MEXICO

1a. TYPE OF WORK

~~DRILL~~ ☒ RE-ENTERDEEPEN ☐PLUG BACK ☐

b. TYPE OF WELL

OIL
WELL ☒GAS
WELL ☐OTHER ☐SINGLE
ZONE ☒MULTIPLE
ZONE ☐

2. NAME OF OPERATOR

WALTER W. KRUG dba WALLEN PRODUCTION COMPANY

3. ADDRESS OF OPERATOR

P. O. BOX 1960, MIDLAND, TEXAS 79702

4. LOCATION OF WELL (Report location clearly and in accordance with any State requirements.)*

At surface

330' FSL AND 990' FWL OF SECTION 21

At proposed prod. zone

14. DISTANCE IN MILES AND DIRECTION FROM NEAREST TOWN OR POST OFFICE*

25 MILES WEST-NORTHWEST OF EUNICE, NEW MEXICO

15. DISTANCE FROM PROPOSED*

LOCATION TO NEAREST
PROPERTY OR LEASE LINE, FT.
(Also to nearest drlg. unit line, if any)

330'

16. NO. OF ACRES IN LEASE

640

17. NO. OF ACRES ASSIGNED
TO THIS WELL

40

18. DISTANCE FROM PROPOSED LOCATION*
TO NEAREST WELL, DRILLING, COMPLETED,
OR APPLIED FOR, ON THIS LEASE, FT.

19. PROPOSED DEPTH

3650'

20. ROTARY OR CABLE TOOLS

CABLE TOOLS

21. ELEVATIONS (Show whether DF, RT, GR, etc.)

3672 GR

22. APPROX. DATE WORK WILL START*

UPON APPROVAL

23.

PROPOSED CASING AND CEMENTING PROGRAM

SIZE OF HOLE	SIZE OF CASING	WEIGHT PER FOOT	SETTING DEPTH	QUANTITY OF CEMENT
15-1/2"	13-3/8"	72#	225'	300 sacks - CIRCULATE
12-1/2"	10-3/4"	48#	750'	Mudded in
10"	8-5/8"	32#	1200'	Mudded in
8"	7"	23#	3300'	1000 sacks - CIRCULATE
6-1/4"	4-1/2" Liner	10.5#	3650'	50 sacks - CIRCULATE

Above 13-3/8" casing was set and cemented to surface when hole was originally drilled.

This well was originally drilled by Wallen Production Company during the period 8-24-78 to 10-4-78 to a total depth of 3550' and plugged and abandoned 10-7-78. Plans are to re-enter and deepen approximately 100' to attempt completion as an oil well. Same road, pad and pit area used for original well will be used so there will be no new surface disturbed.

Well is in OCD's R-111-A area. Noranda Exploration, the only potash lessee in the area has previously waived objection to the well.

Gamma Ray Neutron log was run when this well was originally drilled.

RECEIVED
MAY 19 1980
U. S. GEOLOGICAL SURVEY
HOBBS, NEW MEXICO

IN ABOVE SPACE DESCRIBE PROPOSED PROGRAM: If proposal is to deepen or plug back, give data on present productive zone and proposed new productive zone. If proposal is to drill or deepen directionally, give pertinent data on subsurface locations and measured and true vertical depths. Give blowout preventer program, if any.

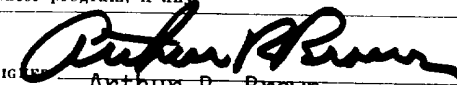
24.  Agent for
SIGNATURE Arthur R. Brown TITLE Wallen Production Company DATE May 15, 1980
(This space for Federal or State office use)

PERMIT NO. _____

APPROVAL DATE _____

APPROVED BY _____

CONDITIONS OF APPROVAL, IF ANY: _____

APPROVED

MAY 30 1980

ACTING DISTRICT ENGINEER

NEW MEXICO OIL CONSERVATION COMMISSION
WELL LOCATION AND ACREAGE DEDICATION PLAT

Form O-101
Supersedes C-128
Effective 1-1-65

All distances must be from the outer boundaries of the Section.

Operator WALLEN PRODUCTION CO.		Lease Bass		Well No. #1	
Unit Letter "M"	Section 21	Township -20-S	Range -34-E	County LEA	
Actual Footage Location of Well: 330 feet from the SOUTH line and 990 feet from the WEST line					
Ground Level Elev. 3672	Producing Formation YATES & SEVEN RIVERS		Pool MIDDLE LYNCH - YATES SEVEN RIVERS		Dedicated Acreage: 40 Acres

1. Outline the acreage dedicated to the subject well by colored pencil or hatchure marks on the plat below.
2. If more than one lease is dedicated to the well, outline each and identify the ownership thereof (both as to working interest and royalty).
3. If more than one lease of different ownership is dedicated to the well, have the interests of all owners been consolidated by communitization, unitization, force-pooling, etc?

☐ Yes ☐ No If answer is "yes" type of consolidation _____

If answer is "no," list the owners and tract descriptions which have actually been consolidated. (Use reverse side of this form if necessary.) _____

No allowable will be assigned to the well until all interests have been consolidated (by communitization, unitization, forced-pooling, or otherwise) or until a non-standard unit, eliminating such interests, has been approved by the Commission.

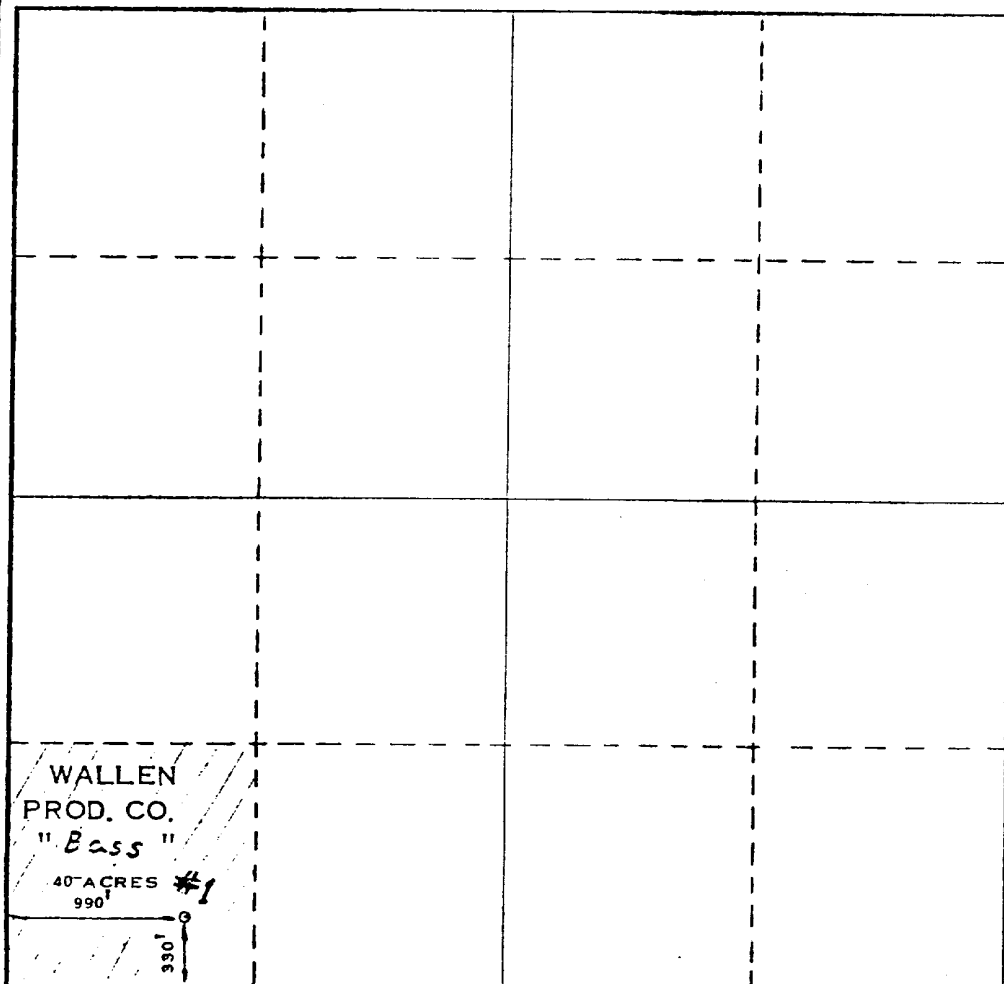

CERTIFICATION

I hereby certify that the information contained herein is true and complete to the best of my knowledge and belief.

Halter J. King
Name

Engineer
Profession

Waller Prod Co.
Company

5/1/80
Date

I hereby certify that the well location shown on this plat was plotted from field notes of actual surveys made by me or under my supervision, and that the same is true and correct to the best of my knowledge and belief.

Date Surveyed
MARCH 7, 1978

Registered Professional Engineer and Land Surveyor

Max A. Schumann Jr.
MAX A. SCHUMANN, JR.

Certificate No.

1510

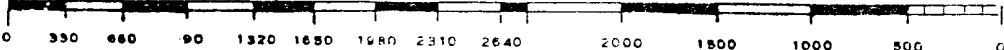

REQUIREMENTS OF N T L -6

1. Geologic name of the surface where the Bass #1 is located is the Quarternary (Alluvium and sand).
2. The estimated tops of the geologic markers are:
 - A. Rustler (Anhydrite) = 1350'
 - B. Top Salt = 1473'
 - C. Base of Salt = 3155'
 - D. Lime = 3182'
 - E. Yates = 3450'
 - F. Reef (Seven Rivers) = 3675'
3.
 - a. Surface Water = 195'
 - b. Santa Rosa Water = 835'
 - c. Yates Sand Oil = 3450'
 - d. Seven River Reef Oil = 3675'
4. Control equipment is a 1500# W.P. control head with double oil saver (if needed) (this will be a cabletool rig).
5. Drilling fluid is fresh water.
6. Logging program: Gamma Ray-Neutron with CCL. was run when well was originally drilled.
7. Estimated drilling duration is 60 days.

3607
548
3059

SURFACE USE AND OPERATIONS PLAN

TO

RE-ENTER AND DEEPEN 100 FEET

WALTER W. KRUG dba WALLEN PRODUCTION COMPANY

WELL NO. 1 WALLEN BASS

330' FSL & 990' FWL SEC. 21, T. 20 S., R. 34 E.

LEA COUNTY, NM

LEASE NO. LC-070315

This well was originally drilled by Wallen Production during the period 8-24-78 to 10-4-78 to a total depth of 3550 feet and plugged and abandoned 10-7-78. Plans are to re-enter this well, drill out plugs, and deepen approximately 100' to attempt completion as an oil well. The same road, pad and pit area used to drill the well originally will be used for re-entry operations, so there will be no new surface disturbance.

The following discussion answers the items 1 through 12, concerning the above subject well.

1. AERIAL MAP

Plat # 1 is a portion of a USGS topographic map, Lea County, New Mexico, showing existing roads. The location is approximately 26½ miles from Hobbs. The location is along the county road.
2. LOCATION OF EXISTING
WELLS

Plat # 2 shows all of the wells and dry holes within a one (1) mile radius of the proposed location.
3. PROPOSED WELL
LOCATION

Plat # 3 shows the rig location with North orientation marker.
 - a. Mat size is 140' x 180'.
 - b. Surfaced with 8" of compacted, watered and leveled caliche from BLM quarry.

Mat built to drill the well originally will be used. There will be no new surface disturbance.

- c. Pit is 40' x 60' x 8' deep.
- d. Cut and fill isn't necessary, here the location is nearly level and only requires caliche.
- e. Entrance road is 380' long and comes off of the county maintained road. Road is already built. No. new surface disturbance.
- f. SETTING AND ENVIRONMENT
 - 1. Terrain is gently rolling sand (see Plat # 1).
 - 2. Soil is a very sandy clay.
 - 3. Vegetation is scrub oak, mesquite, gramma grass, spanish dagger, general desert weeds and sand burrs.
 - 4. Surface use is for grazing.
 - 5. Other the area is nearly flat semi-arid desert country and is probably considered a low environmental risk area, There should be very little (if any) environmental effect of drilling and producing in this vicinity.

g. Distances to

- 1. Ponds and streams - there are none within 6 miles.
- 2. Water wells - none within one mile.
- 3. Residences and buildings - none within 6 miles.
- 4. Arroyos, Canyons, etc none within 1½ miles.
- h. Well sign there will be a well sign at the entrance of the road.
- i. Open Pit will be guarded while drilling, fenced while we are completing the well and then closed in.

4. ROADS

Plat # 1 shows all roads within 3 miles or more. Planned entrance is staked and road will be 380' long and 15' wide and will be caliched with 8" mat note Plat # 3. There are no fences, gates or cattle guard. Road built to drill this well originally will be used. No new surface disturbance.

5. TANK BATTERY

Plat # 4 shows the existing tank battery in NW/4 of NW/4, Section 21, T 20 S, R 34 E.

6. LEASE PIPELINES

Plat # 4 shows all existing oil pipelines and salt water line and disposal well. This plat also shows the proposed oil flow line from this well if oil is established.

7. WASTE DISPOSAL

Well cuttings will be disposed of in slush pit. Barrel trash containers are on location and contents will be burned or buried with a minimum of 23" of dirt cover. Produced water will be disposed of by injecting in our own salt water disposal well.

8. WATER SUPPLY

Our water is hauled by commercial haulers.

9. ARCHAEOLOGICAL RESOURCES

None in the surrounding area.

10. RESTORATION OF SURFACE

Should the well be productive the pit will be back filled as soon as practical.

11. OPERATORS REPRESENTATIVE

Walter W. Krug

P. O. Box 1960

Midland, Texas 79701

office phone ac 915- 683-2600

ac 915- 683-6526

home phone ac 915- 563-0048

12. CERTIFICATION

I hereby certify that I have inspected the proposed drillsite and access route; that I am familiar with the conditions as they exist. The statements made in this plan are, to the best of my knowledge, true and correct and that the proposed work performed by Wallen Production Company its contractors and sub-contractors will conform to this plan.

May 7 , 1980

Walter W. Krug

Walter W. Krug

Engineer and authorized agent

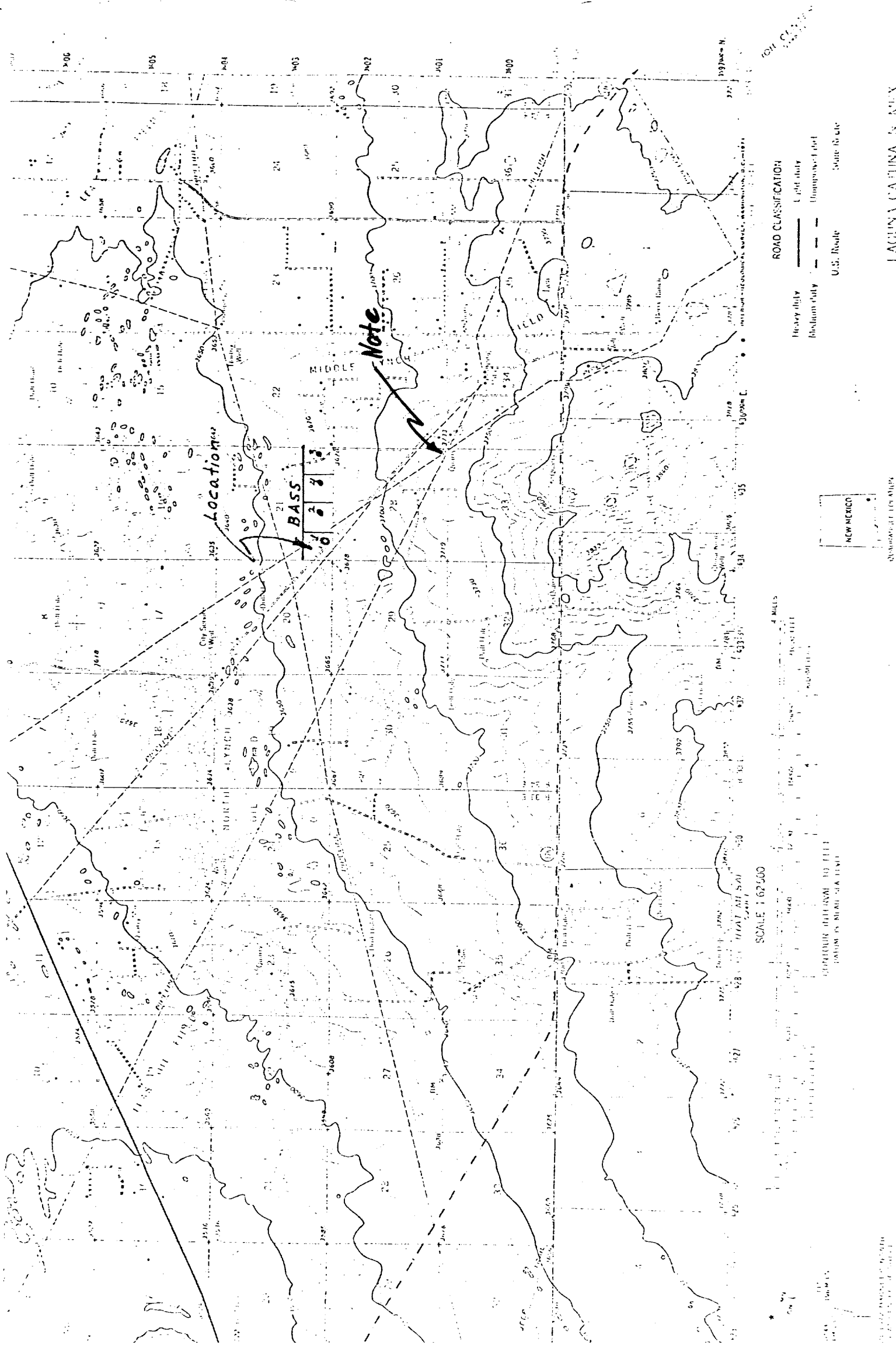

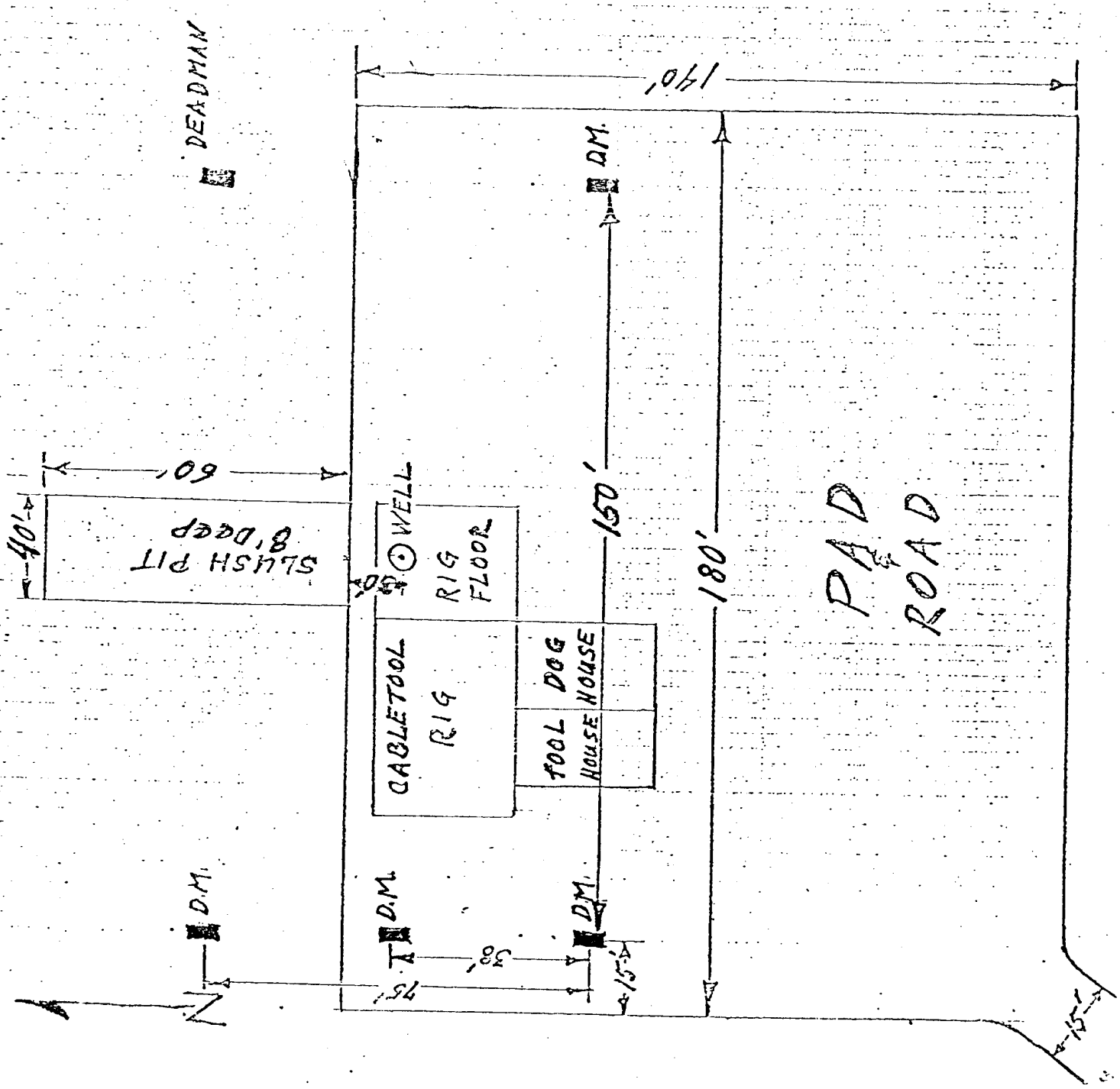

CALICHE PAD ROAD
8" Mat Compacted

DEADMEN

7" Pipe, 6' Long &

6' Deep (or Umbrella 1 1/4" anchors 8' deep)

1" = 30'

UNITED STATES
DEPARTMENT OF THE INTERIOR
GEOLOGICAL SURVEY

SUBMIT IN TRIPL
(Other instructions
verse 555)

DATE
10/10/78

Form approved,
Budget Bureau No. 42 R1424,
U. S. GOVERNMENT PRINTING OFFICE

N.M. 070315
G. DE INDIAN, ALLOTTEE OR TRIBE NAME

SUNDRY NOTICES AND REPORTS ON WELLS

(Do not use this form for proposals to drill or to deepen or plug back to a different reservoir.
Use "APPLICATION FOR PERMIT—" for such proposals.)

1. NAME OF OPERATOR
Walter W. Krug DBA Wallen Production Company

2. ADDRESS OF OPERATOR
Box 1960 Midland, Texas 79702

3. LOCATION OF WELL (Report location clearly and in accordance with any State requirements.*
See also space 17 below.)
At surface

990 FWL & 330 FSL

4. PERMIT NO. 15. ELEVATIONS (Show whether DF, RT, GR, etc.)
GR 3672

7. UNIT AGREEMENT NAME
8. FARM OR LEASE NAME
Bass
9. WELL NO.
1
10. FIELD AND POOL, OR WILDCAT River:
Middle Lynch, Yates. 7
11. SEC., T., R., E., M., OR BLK. AND
SURVEY OR AREA
Sec 21, T 20 S, R 34 E
12. COUNTY OR PARISH
Lea
13. STATE
New Mexico

16. Check Appropriate Box To Indicate Nature of Notice, Report, or Other Data

NOTICE OF INTENTION TO:

TEST WATER SHUT-OFF

FRACTURE TREAT

SHOOT OR ACIDIZE

REPAIR WELL

(Other)

PULL OR ALTER CASING

MULTIPLE COMPLETE

ABANDON*

CHANGE PLANS

SUBSEQUENT REPORT OF:

WATER SHUT-OFF

FRACTURE TREATMENT

SHOOTING OR ACIDIZING

(Other)

REPAIRING WELL

ALTERING CASING

ABANDONMENT*

(NOTE: Report results of multiple completion on Well
Completion or Recompletion Report and Log form.)

17. DESCRIBE PROPOSED OR COMPLETED OPERATIONS (Clearly state all pertinent details, and give pertinent dates, including estimated date of starting any proposed work. If well is directionally drilled, give subsurface locations and measured and true vertical depths for all markers and zones pertinent to this work.)*

On 10/6 & 7 we plugged this well back with 3½ yds of sand & gravel mix from 3550' to 3421' (in lime) and sealed with 60# of lead wool tamped solid with grilling tools (2500#). On top we placed a 120' cement plug (35 sxss class H neat) through 2 3/8 tubing. We pulled 21 jts and waited overnight. Checked the plug the next morning and it was there so we filled the hole to 1100' with 120 bbls water & 24 sxs gel. and pulled 8 5/8 water pipe; we ran 35 jts of tubing and placed 25 sxs of class "H" neat cement here and filled the hole with 120 v bbls of water and 24 sxs of gel. Then we pulled the 10 3/4 casing out ran 7 jts of tubing placed 25 sxs class H neat at 215 feet and then ran 10 sxs class H neat in top of 13 3/8 with well monument.

18. I hereby certify that the foregoing is true and correct

SIGNED

TITLE Engineer

DATE 10/10/78

(This space for Federal or State office use)

APPROVED BY

TITLE

CONDITIONS OF APPROVAL, IF ANY:

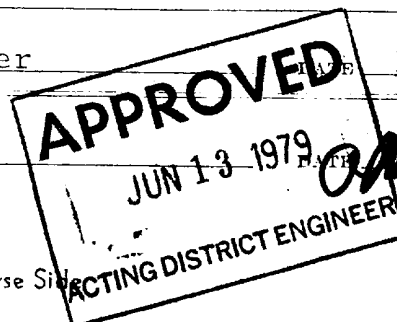

*See Instructions on Reverse Side

RECEIVED

JUN 19 1979

CL OFFICE
HONOLULU, H. I.

APPROVED
JUN 19 1979
HONOLULU, H. I.