

NO. OF COPIES RECEIVED		
DISTRIBUTION		
SANTA FE		
FILE		
U.S.G.S.		
LAND OFFICE		
OPERATOR		

# NEW MEXICO OIL CONSERVATION COMMISSION

Form C-101  
Revised 1-1-65

5A. Indicate Type of Lease	
STATE <input type="checkbox"/>	FEE <input checked="" type="checkbox"/>

5. State Oil & Gas Lease No.

## APPLICATION FOR PERMIT TO DRILL, DEEPEN, OR PLUG BACK

1a. Type of Work

DRILL ☒

DEEPEN ☐

PLUG BACK ☐

b. Type of Well

OIL WELL ☒

GAS WELL ☐

OTHER

SINGLE ZONE ☒

MULTIPLE ZONE ☐

2. Name of Operator

AMOCO PRODUCTION COMPANY

3. Address of Operator

P.O. DRAWER A LEVELLAND, TEXAS 79336

4. Location of Well

UNIT LETTER E

LOCATED 1450

FEET FROM THE North

LINE

150

West

4

19-S 38-E

AND FEET FROM THE

LINE OF SEC.

TWP.

RGE.

SEPM

1. County  
Lea

12. Proposed Depth

4260

13A. Formation

San Andres

13B. Rotary or C.I.T.

Rotary

21. Elevations (show whether Dr., RI, etc.)

3613.9 GR

21A. Kind & Status Prop. Bond

Blanket on file

21B. Drilling Contractor

ND

22. Approx. Date Work will start

11-15-78

23.

## PROPOSED CASING AND CEMENT PROGRAM

SIZE OF HOLE	SIZE OF CASING	WEIGHT PER FOOT	SETTING DEPTH	SACKS OF CEMENT	EST. TOP
17½"	13-3/8"	48#	400'	Circulate to surface	
12¼"	8-5/8"	24#	3860'	Circulate to surface	
7-7/8"	5½" (liner)	14#	3660'-4260'	Tie back to 8-5/8"	

After drilling well, logs will be run and evaluation made. Perforating and/or stimulating as necessary in attempting commercial production.

Mud program: 0-400' Native mud and water  
400'-3860' Commercial mud and brine to maintain good hole condition  
3860'-4260' Will core 400' with lease crude

BOP program attached

Unorthodox location has been approved by hearing on 9/13/78. Order No.R-5833

IN ABOVE SPACE DESCRIBE PROPOSED PROGRAM: IF PROPOSAL IS TO DEEPEN OR PLUG BACK, GIVE DATA ON PRESENT PRODUCTIVE ZONE AND PROPOSED NEW PRODUCTIVE ZONE. GIVE BLOWOUT PREVENTER PROGRAM, IF ANY.

I hereby certify that the information above is true and complete to the best of my knowledge and belief.

Signed Dennis Evans Title Asst. Admin. Analyst Date 10/13/78

(This space for State Use)

APPROVED BY [Signature] TITLE

CONDITIONS OF APPROVAL, IF ANY:

0+4 - NMOCC-H 1 - SUSP  
1 - REG 1 - DE

SUPERVISOR DISTRICT 1

NOV 6 1978

NEW MEXICO OIL CONSERVATION COMMISSION  
WELL LOCATION AND ACREAGE DEDICATION

Form C-122  
Supersedes C-120  
Effective 1-1-65

All distances must be from the outer boundaries of the Section

Operator <b>Amoco Production Co.</b>			Lessee <b>South Hobbs GSAU</b>		Well No. <b>121</b>
Unit Letter <b>E</b>	Section <b>4</b>	Township <b>19 South</b>	Range <b>38 East</b>	County <b>Lea</b>	
Actual Location of Well:					
<b>1450</b> feet from the <b>North</b> line and		<b>150</b> feet from the <b>West</b> line			
Ground Level Elev. <b>3613.9</b>	Producing Formation <b>SAN Andres</b>	Pool <b>Und.</b>	Dedicated Acreage <b>40</b> Acres		

1. Outline the acreage dedicated to the subject well by colored pencil or hatchure marks on the plat below.
2. If more than one lease is dedicated to the well, outline each and identify the ownership thereof (both as to working interest and royalty).
3. If more than one lease of different ownership is dedicated to the well, have the interests of all owners been consolidated by communitization, unitization, force-pooling, etc?

☐ Yes ☐ No If answer is "yes," type of consolidation \_\_\_\_\_

If answer is "no," list the owners and tract descriptions which have actually been consolidated. (Use reverse side of this form if necessary.) \_\_\_\_\_

No allowable will be assigned to the well until all interests have been consolidated (by communitization, unitization, forced-pooling, or otherwise) or until a non-standard unit, eliminating such interests, has been approved by the Commission.

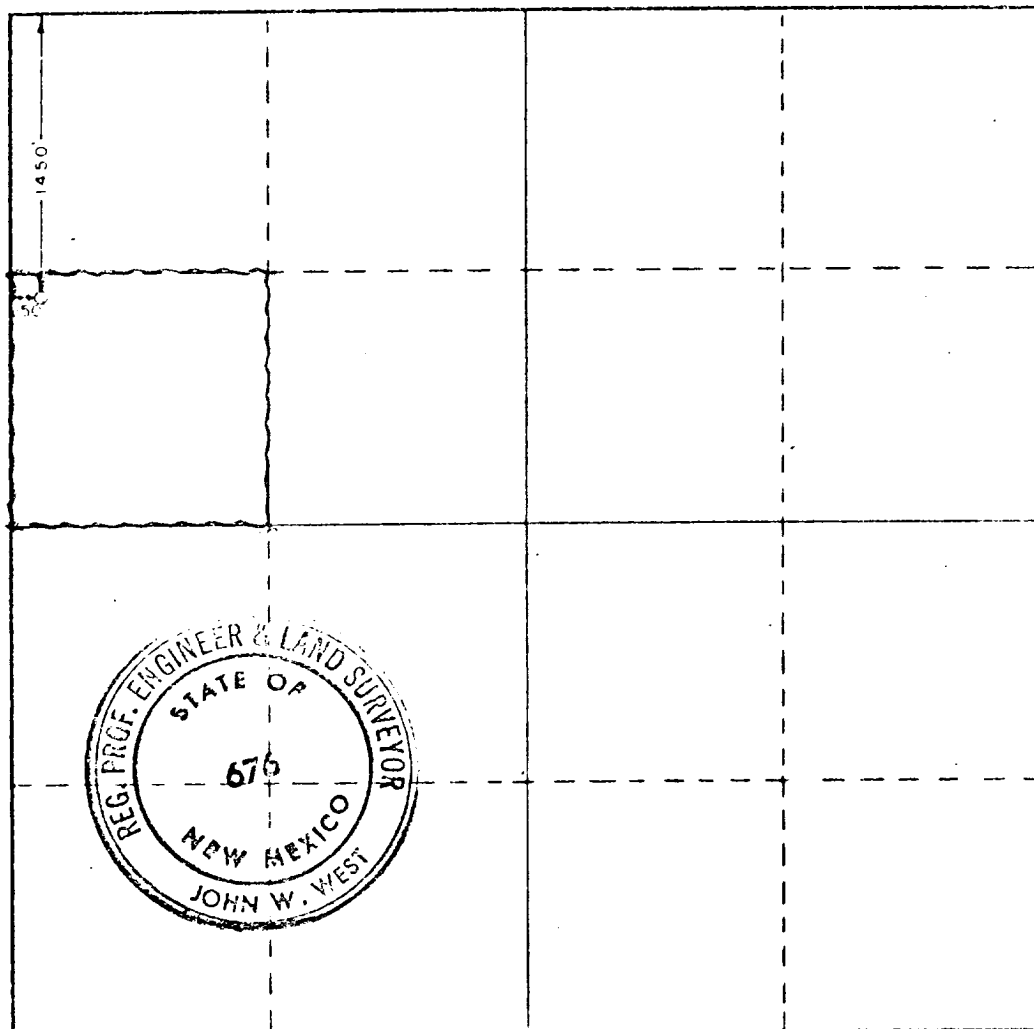

CERTIFICATION

I hereby certify that the information contained herein is true and complete to the best of my knowledge and belief

Name **Dennis Evans**  
Position **Asst. Adm. Analyst**  
Company **AMOCO Prod. Co**  
Date **10-13-78**

I hereby certify that the well location shown on this plat was plotted from field notes of actual surveys made by me or under my supervision, and that the same is true and correct to the best of my knowledge and belief.

Date Surveyed **July 21, 1978**  
Registered Professional Engineer and/or Land Surveyor **John W. West**  
Certificate No. **John W. West 676**  
**Ronald J. Eidson** **5239**

120 100 80 60 40 20 0 20 40 60 80 100 120 1400 1600 1800 2000 2200 2400 2600 2800 3000 3200 3400 3600

**ATTACHMENT "B"**  
**NOTES**

1. Blow-out preventers and master valve to be fluid operated and oil fittings must be in good condition, 3,000# W.P. (6,000 p.s.i. test), minimum.
2. Equipment through which bit must pass shall be as large as the inside diameter of the casing that is being drilled through.
3. Nipple above blow-out preventer shall be same size as casing being drilled through.
4. Kelly cock required, 3,000# W.P. (6,000 p.s.i. test) minimum.
5. OMSCO or comparable safety valve must be available on rig floor at all times with proper connection or sub, 3,000# W.P. (6,000 p.s.i. test), minimum.
6. Blow-out preventers and master valve while drilling intermediate hole to 6000' may be 2,000# W.P. (4,000 p.s.i. test), minimum.
7. Choke assembly, beyond second valve from cross, may be positioned (Optional) outside of derrick foundation.
8. Spool or cross may be eliminated if connections are available in the lower part of the blow-out preventer body.
9. Plug valves - gate valves are optional. Valves shown as 2" are minimum size.
10. Casing head and casing head spool, including attached valves, to be furnished by Amoco.
11. Rams in preventers will be installed as follows:  

When drilling, use:	When running casing, use:
Top Preventer - Drill pipe rams	Top Preventer - Casing rams
Bottom Preventer - Blind rams or master valve	Bottom Preventer - Blind rams or master valve

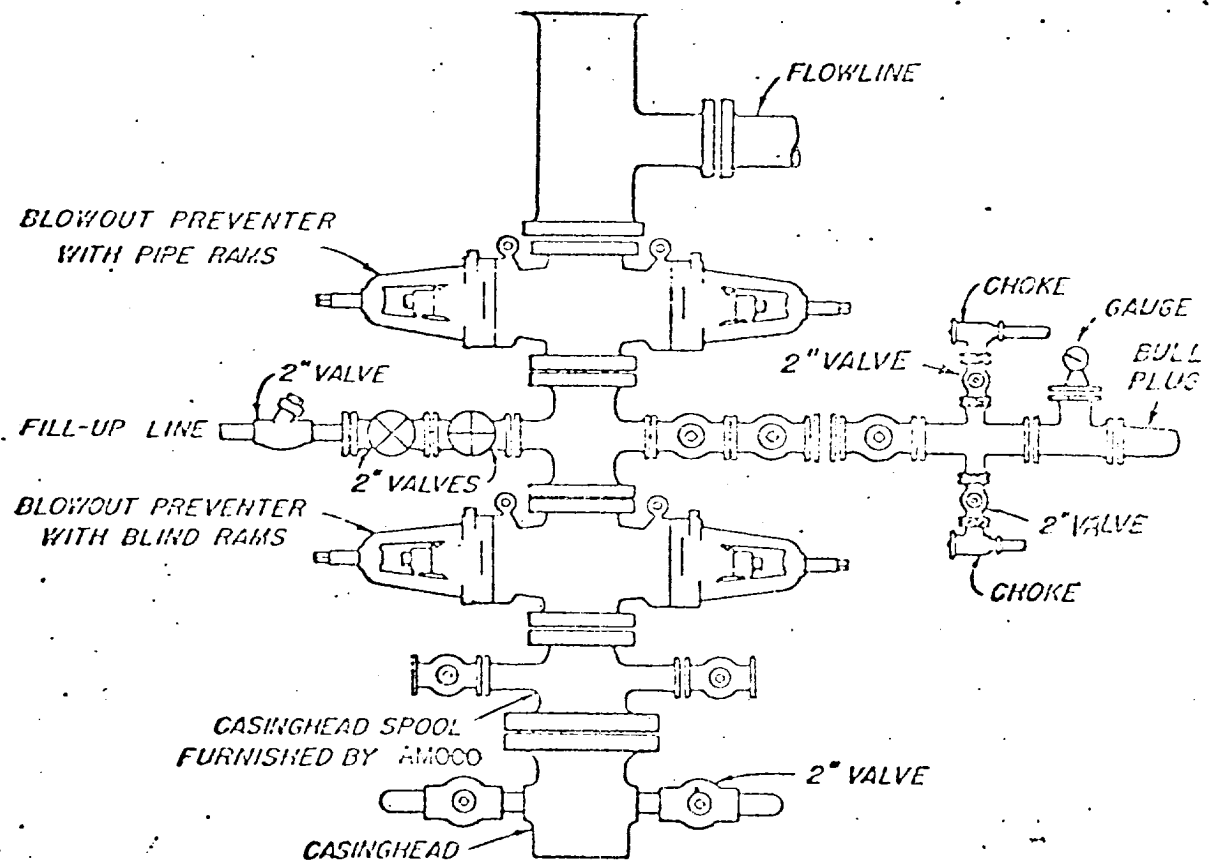

**BLOWOUT PREVENTER HOOK-UP**

AMOCO PRODUCTION COMPANY

**EXHIBIT D-1 MODIFIED**

JUNE 1, 1962