

NO. OF COPIES RECEIVED	
DISTRIBUTION	
SANTA FE	
FILE	
U.S.G.S.	
LAND OFFICE	
OPERATOR	

NEW MEXICO OIL CONSERVATION COMMISSION

Form C-101
Revised 1-1-65

5A. Indicate Type of Lease	
STATE <input type="checkbox"/>	FEE <input checked="" type="checkbox"/>
5. State Oil & Gas Lease No.	

APPLICATION FOR PERMIT TO DRILL, DEEPEN, OR PLUG BACK

1a. Type of Work		7. Unit Agreement Name	
b. Type of Well DRILL <input checked="" type="checkbox"/> DEEPEN <input type="checkbox"/> PLUG BACK <input type="checkbox"/> OIL WELL <input checked="" type="checkbox"/> GAS WELL <input type="checkbox"/> OTHER <input type="checkbox"/> SINGLE ZONE <input checked="" type="checkbox"/> MULTIPLE ZONE <input type="checkbox"/>		8. Term or Lease Time South Hobbs (GSA) Unit	
2. Name of Operator AMOCO PRODUCTION COMPANY		9. Well No. 126	
3. Address of Operator P.O. DRAWER A LEVELLAND, TEXAS 79336		10. Field and Pool or Unit Und. San Andres	
4. Location of Well UNIT LETTER <u>N</u> LOCATED <u>1295</u> FEET FROM THE <u>South</u> LINE <u>1365</u> West LINE OF SEC. <u>10</u> TWP. <u>19-S</u> RGE. <u>38-E</u> NADEN		11. County Lea	
12. Elevation (Show whether DT, RL, etc.) 3594.4 GR		13. Top hole Depth 4235'	14A. Formation San Andres
21A. Kind & Status Plug, Bend Blanket on file		21B. Drilling Contractor ND	22. Approx. Date work will start 12-27-78

23.

PROPOSED CASING AND CEMENT PROGRAM

SIZE OF HOLE	SIZE OF CASING	WEIGHT PER FOOT	SETTING DEPTH	SACKS OF CEMENT	EST. TOP
17½"	13-3/8"	48#	400'	Circulate to surface	
12¼"	8-5/8"	24#	3960'	Circulate to surface	
7-7/8"	5½" (liner)	14#	3760'-4235'	Tie back to 8-5/8"	

After drilling well, logs will be run and evaluation made. Perforating and/or stimulating as necessary in attemptin commercial production.

Mud program: 0-400' Native mud and water
 400'-3960' Commercial mud brine to maintain good hole condition
 3960'-4235' Will core 275' with lease crude

BOP program attached

Unorthodox location has been approved by hearing on 9/13/78. Order No. R-5833

IN ABOVE SPACE DESCRIBE PROPOSED PROGRAM: IF PROPOSAL IS TO DEEPEN OR PLUG BACK, GIVE DATA ON PRESENT PROTECTIVE ZONE AND PROPOSED NEW PRODUCTIVE ZONE. GIVE BLOWOUT PREVENTER PROGRAM, IF ANY.

I hereby certify that the information above is true and complete to the best of my knowledge and belief.

Signed Dennis Evans Title Asst. Admn. Analyst Date 10-13-78

(This space for State Use)

APPROVED BY [Signature] TITLE SUPERVISOR DISTRICT I DATE NOV 6 1978

CONDITIONS OF APPROVAL, IF ANY:

0+4 - NMOCC-H 1 - SUSP
 1 - REG 1 - DE

NEW MEXICO OIL CONSERVATION COMMISSION
WELL LOCATION AND ACREAGE DEDICATION PLAT

Form O-102
Supersedes O-128
Effective 1-1-65

All distances must be from the outer boundaries of the Section

Operator Amoco Production Co.		Lease South Hobbs GSAU		Well No. 126
Unit Letter N	Section 10	Township 19 South	Range 38 East	County Lea
Actual Footage Location of Well: 1295 feet from the South line and 1365 feet from the West line				
Ground Level Elev. 3594.4	Producing Formation SAN Andres	Pool THD	Dedicated Acreage: 40 Acres	

1. Outline the acreage dedicated to the subject well by colored pencil or hatchure marks on the plat below.
2. If more than one lease is dedicated to the well, outline each and identify the ownership thereof (both as to working interest and royalty).
3. If more than one lease of different ownership is dedicated to the well, have the interests of all owners been consolidated by communitization, unitization, force-pooling, etc?

☐ Yes ☐ No If answer is "yes," type of consolidation _____

If answer is "no," list the owners and tract descriptions which have actually been consolidated. (Use reverse side of this form if necessary.) _____

No allowable will be assigned to the well until all interests have been consolidated (by communitization, unitization, forced-pooling, or otherwise) or until a non-standard unit, eliminating such interests, has been approved by the Commission.

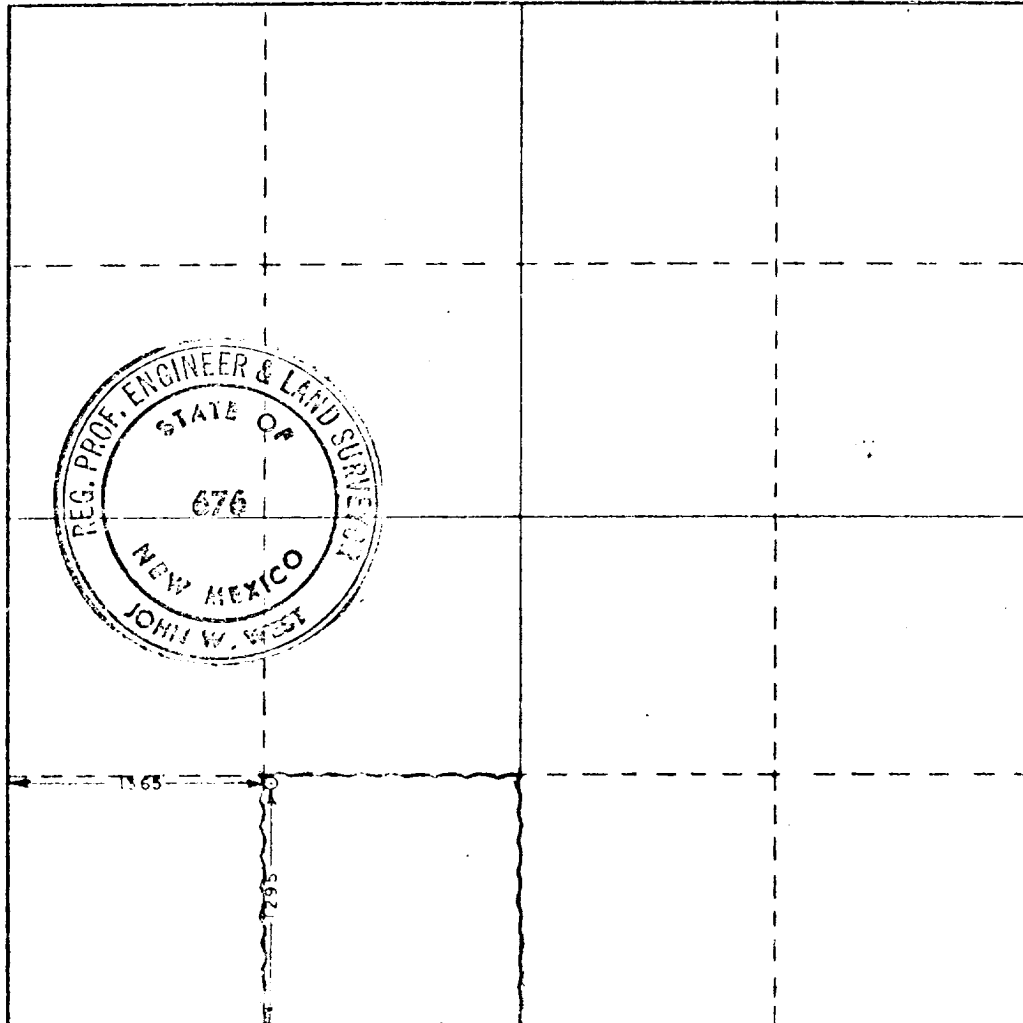

CERTIFICATION

I hereby certify that the information contained herein is true and complete to the best of my knowledge and belief.

Name Dennis Evans
Position Asst. Admin. Analyst
Company AMOCO Prod. Co
Date 10-13-78

I hereby certify that the well location shown on this plat was plotted from field notes of actual surveys made by me or under my supervision, and that the same is true and correct to the best of my knowledge and belief.

Date Surveyed
July 26, 1978

Registered Professional Engineer and/or Land Surveyor

John W. West
Certificate No. John W. West 676
Ronald J. Eidson 3239

ATTACHMENT "B"
NOTES

1. Blow-out preventers and master valve to be fluid operated and oil fittings must be in good condition, 3,000# W.P. (6,000 p.s.i. test), minimum.
2. Equipment through which bit must pass shall be as large as the inside diameter of the casing that is being drilled through.
3. Nipple above blow-out preventer shall be same size as casing being drilled through.
4. Kelly cock required, 3,000# W.P. (6,000 p.s.i. test) minimum.
5. OMSCO or comparable safety valve must be available on rig floor at all times with proper connection or sub, 3,000# W.P. (6,000 p.s.i. test), minimum.
6. Blow-out preventers and master valve while drilling intermediate hole to 6000' may be 2,000# W.P. (4,000 p.s.i. test), minimum.
7. Choke assembly, beyond second valve from cross, may be positioned (Optional) outside of derrick foundation.
8. Spool or cross may be eliminated if connections are available in the lower part of the blow-out preventer body.
9. Plug valves - gate valves are optional. Valves shown as 2" are minimum size.
10. Casing head and casing head spool, including attached valves, to be furnished by Amoco.
11. Rams in preventers will be installed as follows:

When drilling, use:	When running casing, use:
Top Preventer - Drill pipe rams	Top Preventer - Casing rams
Bottom Preventer - Blind rams or master valve	Bottom Preventer - Blind rams or master valve

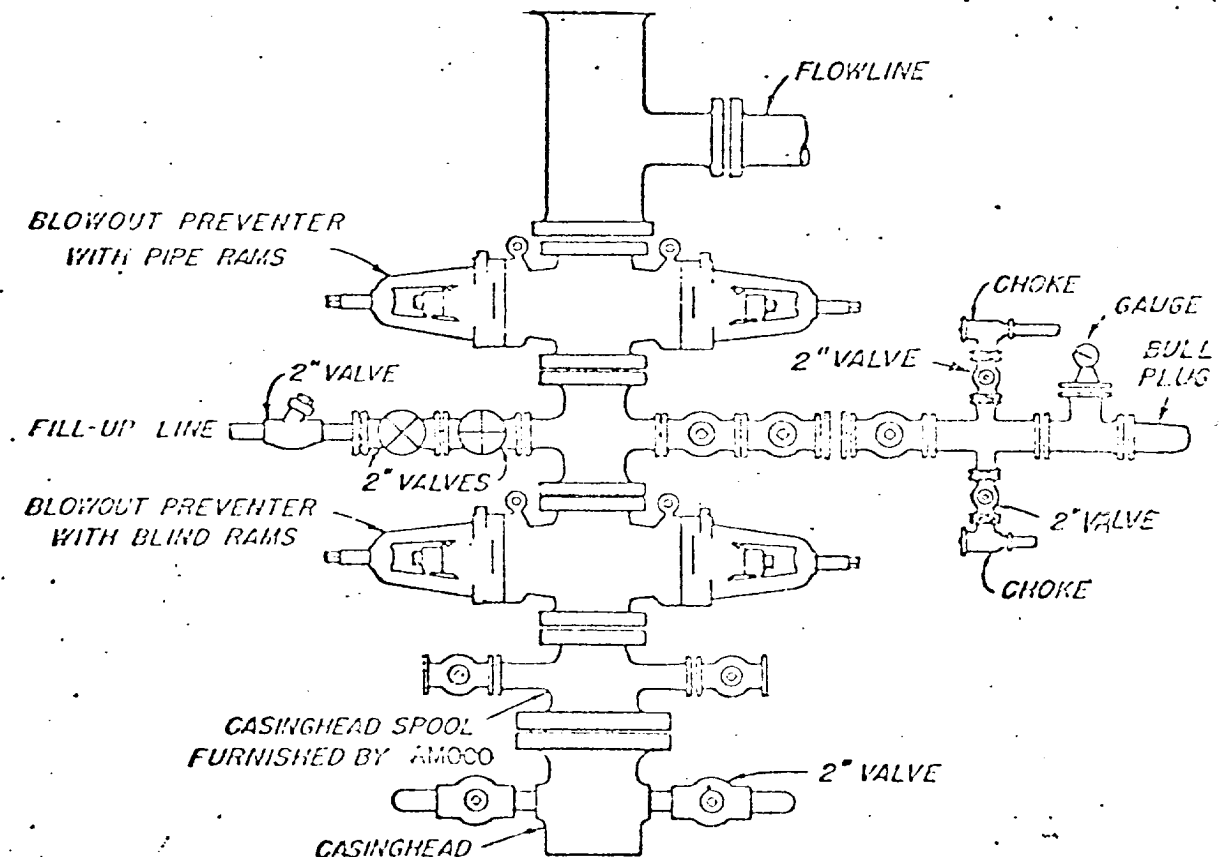

BLOWOUT PREVENTER HOOK-UP

AMOCO PRODUCTION COMPANY

EXHIBIT D-1 MODIFIED

JUNE 1, 1962