

OIL CONSERVATION DIVISION

P.O. Box 2088

Santa Fe, New Mexico 87504-2088

DISTRICT I

P.O. Box 1980, Hobbs, NM 88240

DISTRICT II

P.O. Drawer DD, Artesia, NM 88210

DISTRICT III

1000 Rio Grande Rd., Aztec, NM 87410

WELL LOCATION AND ACREAGE DEDICATION PLAT

All Distances must be from the outer boundaries of the section

Operator Amerada Hess Corporation			Lease State 0		Well No. 5 44
Unit Letter H	Section 30	Township 19S	Range 37E	County NMPM	Lea
Actual Footage Location of Well: 1980 feet from the North line and 990 feet from the East line					
Ground level Elev. 3618' GR	Producing Formation Eumont Yates 7RQ		Pool Eumont Proration	Dedicated Acreage: 160 Acres	

- Outline the acreage dedicated to the subject well by colored pencil or inkline marks on the plat below.
- If more than one lease is dedicated to the well, outline each and identify the ownership thereof (both as to working interest and royalty).
- If more than one lease of different ownership is dedicated to the well, have the interest of all owners been consolidated by communitization, unitization, force-pooling, etc.?
☐ Yes ☐ No If answer is "yes" type of consolidation _____
If answer is "no" list the owners and tract descriptions which have actually been consolidated. (Use reverse side of this form if necessary). _____
No allowable will be assigned to the well until all interests have been consolidated (by communitization, unitization, force-pooling, or otherwise) or until a non-standard unit, eliminating such interest, has been approved by the Division.

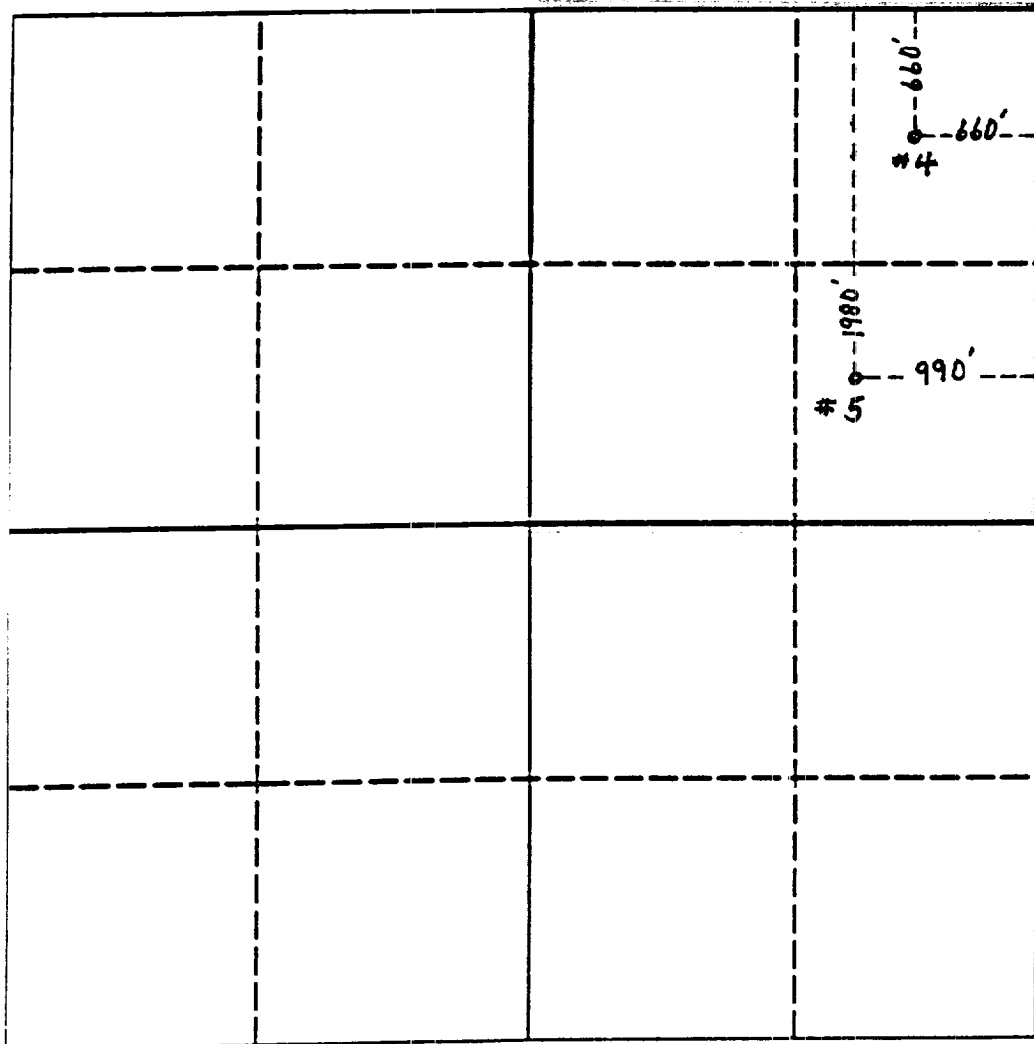

OPERATOR CERTIFICATION

I hereby certify that the information contained herein is true and complete to the best of my knowledge and belief.

Signature
R.L. Wheeler, Jr.

Printed Name
Supv. Adm. Svc.

Position
Amerada Hess Corporation

Company
10/19/92

Date

SURVEYOR CERTIFICATION

I hereby certify that the well location shown on this plat was plotted from field notes of actual surveys made by me or under my supervision, and that the same is true and correct to the best of my knowledge and belief.

Date Surveyed

Signature & Seal of
Professional Surveyor

Certificate No.

0 330 660 990 1320 1650 1980 2310 2640 2000 1500 1000 500 0

NEW MEXICO OIL CONSERVATION COMMISSION
WELL LOCATION AND ACREAGE DEDICATION PLAT

Form C-122
Supersedes C-128
Effective 1-1-65

All distances must be from the outer boundaries of the Section

Operator Amerada Hess Corporation		Lease State "0"		Well No. 5	
Well Letter H	Section 30	Township 19-S	Range 37-E	County Lea	
Actual Footage Location of Well:					
1980 feet from the North line and		990 feet from the East line			
Ground Level Elev. 3618'	Indurating Formation Eumont Queen	Pool Eumont	Dedicated Acreage: 160 Acres		

1. Outline the acreage dedicated to the subject well by colored pencil or hachure marks on the plat below.
2. If more than one lease is dedicated to the well, outline each and identify the ownership thereof (both as to working interest and royalty).
3. If more than one lease of different ownership is dedicated to the well, have the interests of all owners been consolidated by communitization, unitization, force-pooling, etc?

☐ Yes ☐ No If answer is "yes," type of consolidation N/A

If answer is "no," list the owners and tract descriptions which have actually been consolidated. (Use reverse side of this form if necessary.) _____

No allowable will be assigned to the well until all interests have been consolidated (by communitization, unitization, forced-pooling, or otherwise) or until a non-standard unit, eliminating such interests, has been approved by the Commission.

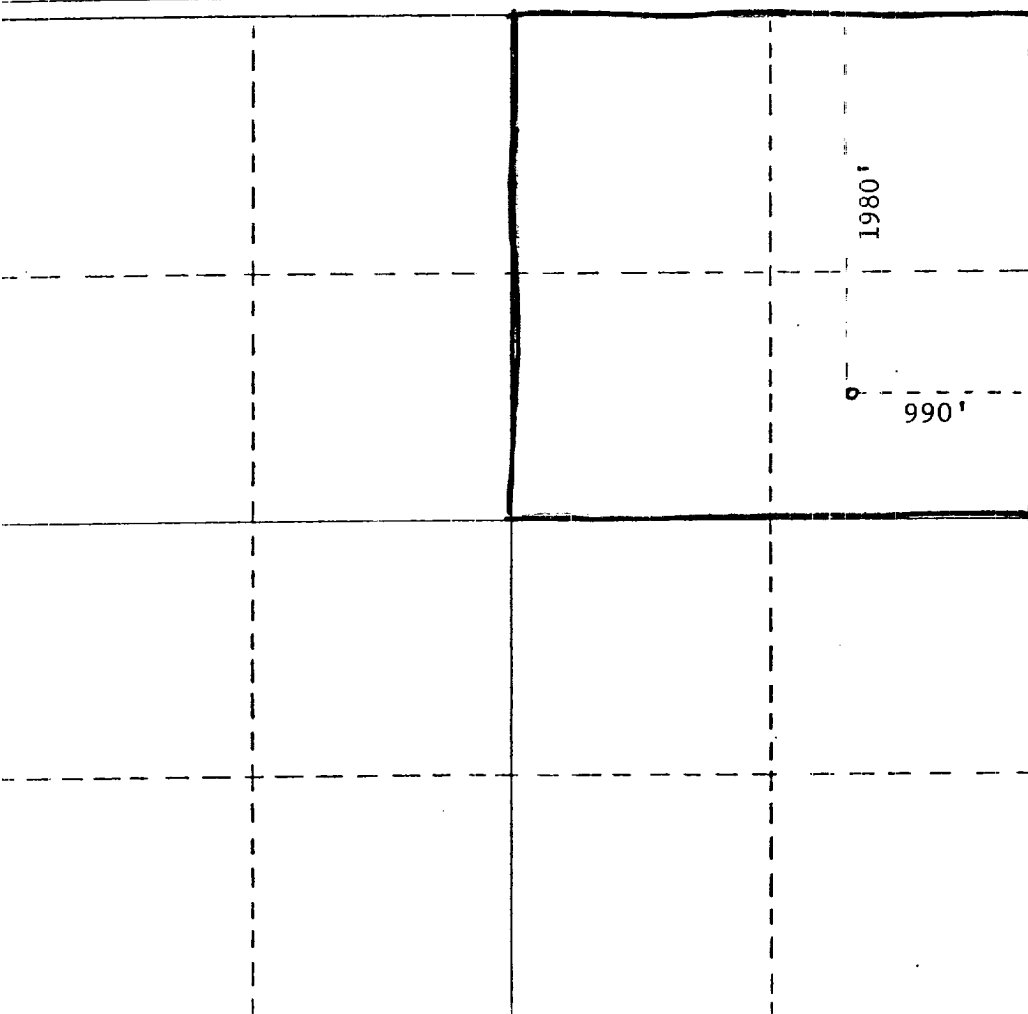

CERTIFICATION

I hereby certify that the information contained herein is true and complete to the best of my knowledge and belief.

Name
E. B. Fisher
Position
Supv. Adm. Ser.
Company
Amerada Hess Corporation
Date
8-21-79

I hereby certify that the well location shown on this plat was plotted from field notes of actual surveys made by me or under my supervision, and that the same is true and correct to the best of my knowledge and belief.

Date Surveyed

Registered Professional Engineer and/or Land Surveyor

Certificate No.

330 660 990 1320 1650 1980 2310 2640 2970 3300 3630 3960 4290 4620 4950 5280 5610 5940 6270 6600

COUNTY **LEA** FIELD **Eumont** STATE **NM**
 OPR **AMERADA HESS CORP.** API **30-025-26170**
 NO **5** LEASE **State "O"** MAP
Sec 30, T19S, R37E CO-ORD
1980' FNL, 990' FEL of Sec **8-1-10 NM**
1 mi NW/Monument SPD **6-7-79** CMP **6-26-79**

CNG 8 5/8" at 345' w/250 sx 5 1/2" at 3290' w/1250 sx	WELL CLASS: INIT D FIN DG ELEV L & S			
	FORMATION	DATUM	FORMATION	DATUM
	TD	3570' (QUEN)		PBD

IP (Queen) OH 3290-3570' F 241 MCFGPD. Pot based on 24 hr test thru 3/4" chk. GOR (NR); gty (NR); CP Pkr; TP 166#

CONTR **Cactus #66** OPRSELEV **3617' GL** PD **3650' RT**

F.R. 12-18-78
 (Queen)
 6-11-79 Drlg 1215'
 6-19-79 TD 3290'; WOCU
 7-2-79 TD 3570'; SI WO Sales Contract
 DOC to 3570'
 Natural
 Flwd @ 241 MCFGPD in 24 hrs, TP 166# (3290-3570')
 7-16-79 TD 3570'; SI/WO Contract
 7-30-79 TD 3570'; Complete
 LOGS RUN: CNL, FDC, CALP, GRL, DILL
 8-4-79 COMPLETION ISSUED

8-1-10 NM
 IC 30-025-70430-78