

NO. OF COPIES RECEIVED	
DISTRIBUTION	
SANTA FE	
FILE	
U.S.G.S.	
LAND OFFICE	
OPERATOR	

# NEW MEXICO OIL CONSERVATION COMMISSION

Form C-101  
Revised 1-1-65

5A. Indicate Type of Lease	
STATE <input checked="" type="checkbox"/>	FEE <input type="checkbox"/>
5. State Oil & Gas Lease No.	
B-10233	

## APPLICATION FOR PERMIT TO DRILL, DEEPEN, OR PLUG BACK

1a. Type of Work		7. Unit Agreement Name	
b. Type of Well OIL WELL <input checked="" type="checkbox"/> GAS WELL <input type="checkbox"/> OTHER <input type="checkbox"/>		8. Farm or Lease Name	
DRILL <input checked="" type="checkbox"/> DEEPEN <input type="checkbox"/> PLUG BACK <input type="checkbox"/>		Stall KN-12	
2. Name of Operator		9. Well No.	
Continental Oil Company		6	
3. Address of Operator		10. Field and Pool, or Wildcat	
P.O. Box 460, Hobbs, N.M. 88240		Eumont Gates 7 Area	
4. Location of Well		12. County	
UNIT LETTER <u>L</u> LOCATED <u>1980</u> FEET FROM THE <u>South</u> LINE		Lea	
AND <u>660</u> FEET FROM THE <u>West</u> LINE OF SEC. <u>12</u> TWP. <u>19S</u> RGE. <u>36E</u> NMPM			
19. Proposed Depth		19A. Formation	20. Rotary or C.T.
4100		Eumont Queen	rotary
21. Elevations (Show whether DF, RT, etc.)	21A. Kind & Status Plug. Bond	21B. Drilling Contractor	22. Approx. Date Work will start
3737.0' GL			12-29-78

23.

## PROPOSED CASING AND CEMENT PROGRAM

SIZE OF HOLE	SIZE OF CASING	WEIGHT PER FOOT	SETTING DEPTH	SACKS OF CEMENT	EST. TOP
12 1/4	8 3/8	24#	1500'	750SW	CIRC
7 7/8	5 1/2	17#	4080'	1075 3X	CIRC

It is proposed to drill a straight hole to a TD of approx. 4100' and complete as a single Eumont Queen oil well.

B.O.P. program is attached.

IN ABOVE SPACE DESCRIBE PROPOSED PROGRAM: IF PROPOSAL IS TO DEEPEN OR PLUG BACK, GIVE DATA ON PRESENT PRODUCTIVE ZONE AND PROPOSED NEW PRODUCTIVE ZONE. GIVE BLOWOUT PREVENTER PROGRAM, IF ANY.

I hereby certify that the information above is true and complete to the best of my knowledge and belief.

Signed W. A. Butterfield Title Administrative Supervisor Date 12-28-78

(This space for State Use)

Orig. Signed by  
Les Clements

APPROVED BY \_\_\_\_\_ TITLE \_\_\_\_\_ DATE DEC 26 1978

CONDITIONS OF APPROVAL, IF ANY, Oil & Gas Insp.

NMOCID  
FILE

RECEIVED

DEC 6 1973

OIL POLLUTION COM. (1)  
P. 178, 8-11

NEW MEXICO OIL CONSERVATION COMMISSION  
WELL LOCATION AND ACREAGE DEDICATION PLAT

Form C-102  
Supersedes C-128  
Effective 1-1-65

All distances must be from the outer boundaries of the Section

Operator <b>Continental Oil Co.</b>			Lease <b>State K N "12"</b>		Well No. <b>6</b>
Section <b>L</b>	Section <b>12</b>	Township <b>19 South</b>	Range <b>36 East</b>	County <b>Lea</b>	
Approximate Location of Well: <b>1980</b> feet from the <b>South</b> line and <b>660</b> feet from the <b>West</b> line					
Ground Level Elev. <b>3737.0</b>	Producing Formation <b>EUMONT QUEEN</b>		Pool <b>EUMONT YATES TOWNS ON</b>	Dedicated Acreage: <b>40</b> Acres	

- Outline the acreage dedicated to the subject well by colored pencil or hachure marks on the plat below.
- If more than one lease is dedicated to the well, outline each and identify the ownership thereof (both as to working interest and royalty).
- If more than one lease of different ownership is dedicated to the well, have the interests of all owners been consolidated by communitization, unitization, force-pooling, etc?

☐ Yes ☐ No If answer is "yes," type of consolidation \_\_\_\_\_

If answer is "no," list the owners and tract descriptions which have actually been consolidated. (Use reverse side of this form if necessary.) \_\_\_\_\_

No allowable will be assigned to the well until all interests have been consolidated (by communitization, unitization, forced-pooling, or otherwise) or until a non-standard unit, eliminating such interests, has been approved by the Commission.

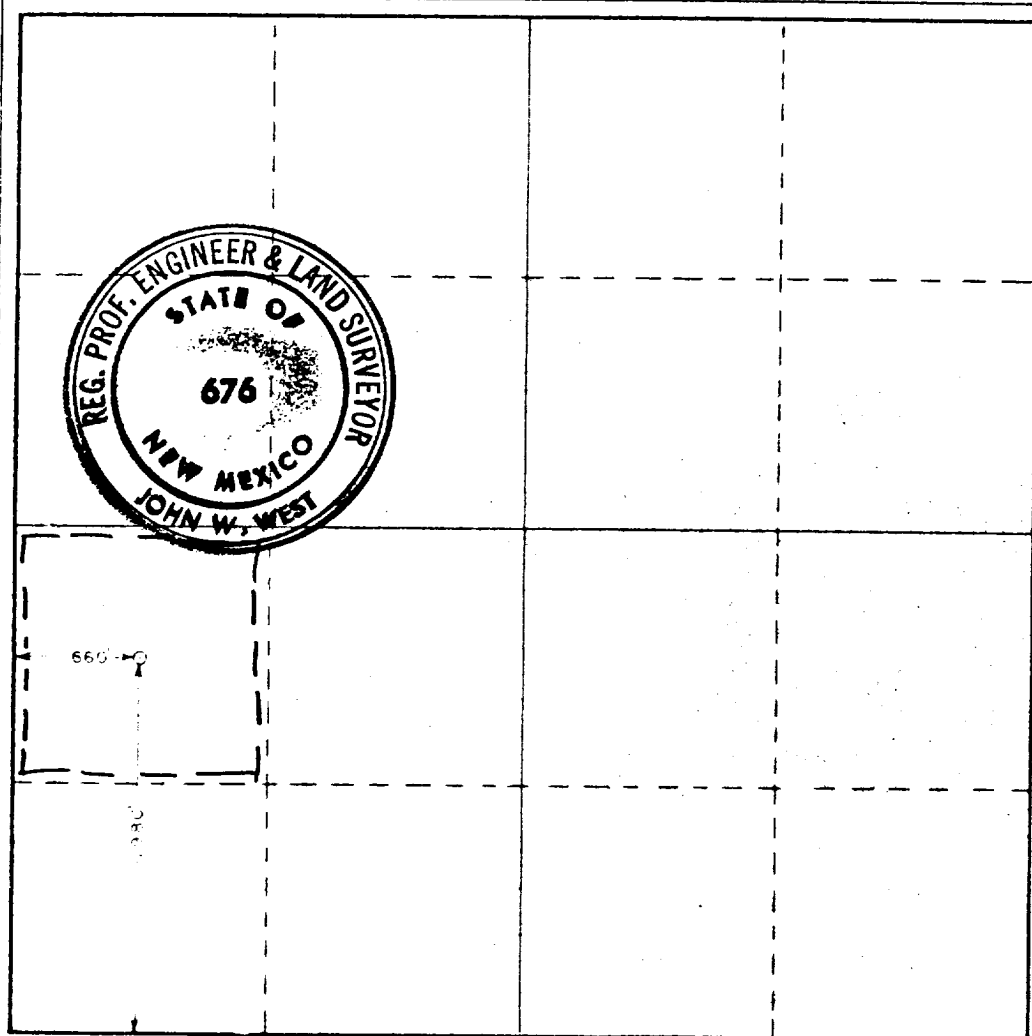

CERTIFICATION

I hereby certify that the information contained herein is true and complete to the best of my knowledge and belief.

Name  
**John A. Butterfield**  
Position  
**Administrative Supervisor**  
Company  
**Continental Oil Company**  
Date  
**December 22, 1978**

I hereby certify that the well location shown on this plat was plotted from field notes of actual surveys made by me or under my supervision, and that the same is true and correct to the best of my knowledge and belief.

Date Surveyed  
**October 21, 1978**

Registered Professional Engineer and/or Land Surveyor

**John W. West**  
Certificate No. **John W. West 676**  
**Ronald J. Eidson 3239**

RECEIVED

REC'D G-173

OIL CONSERVATION COMPA  
FEDERAL BUREAU OF INVESTIGATION

CONTINENTAL OIL COMPANY  
Blow-out Preventer Specifications

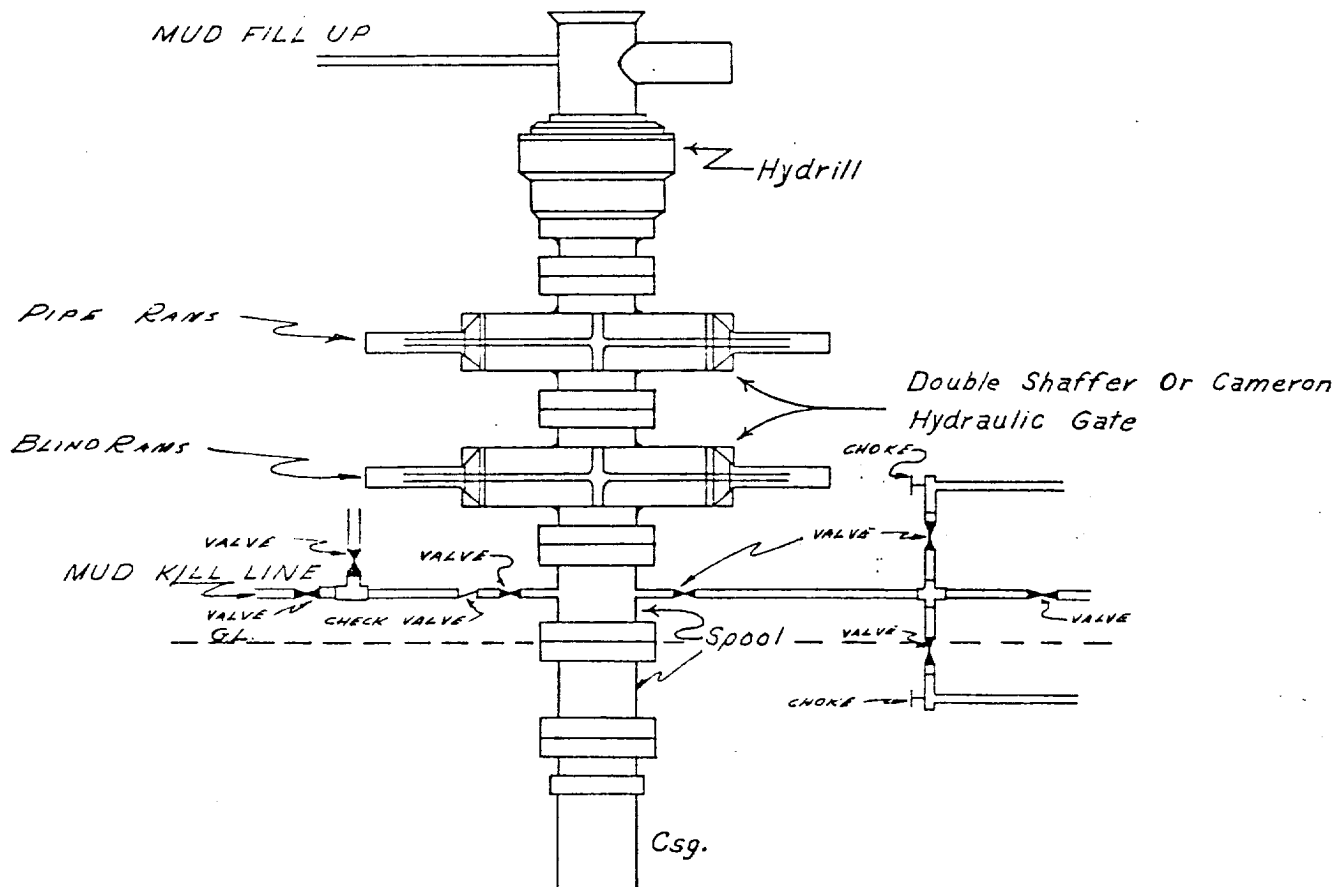

NOTE:

API SERIES 900

Manual and Hydraulic controls with closing unit no less than 75' from well head.  
Remote controls on rig floor.

DUE TO SUBSTRUCTURE CLEARANCE,  
HYDRILL MAY OR MAY NOT BE USED.

RECEIVED

NOV 1976

AIR OBSERVATION COMMA  
NOV 1976

117