

Submit to Appropriate
District Office
State Lease - 6 copies
Fee Lease - 5 copies

State of New Mexico
Energy, Minerals and Natural Resources Department

Form C-101
Revised 1-1-89

OIL CONSERVATION DIVISION

DISTRICT I
P.O. Box 1980, Hobbs, NM 88240

P.O. Box 2088
Santa Fe, New Mexico 87504-2088

DISTRICT II
P.O. Drawer DD, Artesia, NM 88210

DISTRICT III
1000 Rio Brazos Rd., Aztec, NM 87410

| |
|---|
| API NO. (assigned by OCD on New Wells) |
| 30-025-26481 |
| 5. Indicate Type of Lease STATE <input type="checkbox"/> FEE <input checked="" type="checkbox"/> |
| 6. State Oil & Gas Lease No. |

APPLICATION FOR PERMIT TO DRILL, DEEPEN, OR PLUG BACK

| | | | | | |
|---|----------------|---|---------------|-----------------|----------|
| 1a. Type of Work: DRILL <input type="checkbox"/> RE-ENTER <input type="checkbox"/> DEEPEN <input type="checkbox"/> PLUG BACK <input checked="" type="checkbox"/> | | 7. Lease Name or Unit Agreement Name Byers "A" | | | |
| b. Type of Well: OIL WELL <input checked="" type="checkbox"/> GAS WELL <input type="checkbox"/> OTHER <input type="checkbox"/> | | 8. Well No. 31 | | | |
| 2. Name of Operator Amoco Production Company | | 9. Pool name or Wildcat Hobbs Paddock | | | |
| 3. Address of Operator P. O. Box 3092 Houston, TX 77253 | | | | | |
| 4. Well Location Unit Letter D : 660 Feet From The North Line and 735 Feet From The West Line Section 3 Township 19-S Range 38-E NMPM Lea County | | | | | |
| 10. Reported Depth 7350' | | 11. Formation Paddock | | | |
| 12. Rotary or C.T. Rotary | | | | | |
| 13. Elevations (Show whether DF, RT, GR, etc.) 3614, 6 GL | | 14. Kind & Status Plug, Bond Blanket on File | | | |
| 15. Drilling Contractor N.A. | | 16. Approx. Date Work will start 1-24-90 | | | |
| 17. PROPOSED CASING AND CEMENT PROGRAM | | | | | |
| SIZE OF HOLE | SIZE OF CASING | WEIGHT PER FOOT | SETTING DEPTH | SACKS OF CEMENT | EST. TOP |
| 17 1/2" | 13 3/8" | 48# | 398' | 450 SX | Surface |
| 12 1/4" | 9 5/8" | 32.3, 36# | 4305' | 875 SX | 125' |
| 8 3/4" | 7" | 20, 23, 26# | 7350' | 700 SX | 4285' |

1. Move in and rig up service unit. Pull out of hole with production equipment.
2. Run in hole with 7" cast iron bridge plug and set at 6200 feet. Cap with 50 feet of cement.
3. Perforate interval 5494'-5520'.
4. Acidize with 50 gallons NEFE HCL per one foot setting. (1300 gallons of acid total.)
5. Pump 1000 gallons of 15% NEFE HCL with 2 gallons per 1000 clay stabilizer. Pump at 2 barrels per minute with a maximum pressure of 2000 psi. Flush with 24 barrels 9# brine and 2% KCL water.
6. Return well to production and test.

IN ABOVE SPACE DESCRIBE PROPOSED PROGRAM: IF PROPOSAL IS TO DEEPEN OR PLUG BACK, GIVE DATA ON PRESENT PRODUCTIVE ZONE AND PROPOSED NEW PRODUCTIVE ZONE. GIVE BLOWOUT PREVENTER PROGRAM, IF ANY.

I hereby certify that the information above is true and complete to the best of my knowledge and belief.

SIGNATURE H. I. Black TITLE Staff Administrative Analyst DATE 1-12-90
TYPE OR PRINT NAME H. I. Black - Room 20.164 TELEPHONE NO. 713/584-721

(This space for State Use)

ORIGINAL SIGNED BY JERRY SEXTON
APPROVED BY DISTRICT I SUPERVISOR TITLE _____ DATE _____
CONDITIONS OF APPROVAL, IF ANY:

Permit Expires 6 Months From Approval
Date Unless Drilling Underway.
workover

JAN 19 1990

NEW MEXICO OIL CONSERVATION COMMISSION
WELL LOCATION AND ACREAGE DEDICATION PLAT

Form O-132
Supersedes O-128
Effective 1-1-65

All distances must be from the outer boundaries of the Section

| | | | | | |
|---|---------------------------------------|---------------------------------|-------------------------|----------------------|--|
| Location AMOCO PRODUCTION COMPANY | | Lease Byers "A" | | Acres 31 | |
| Section D | Section 3 | Range 19 South | Range 38 East | County Lea | |
| Actual Well Location of Well: | | | | | |
| 660 feet from the North | | line and 735 feet from the West | | 660 | |
| Surface Elevation 3614.6 | Producing Formation Paddock | Acres 40 | Hobbs Paddock | | |

1. Outline the acreage dedicated to the subject well by colored pencil or hatchure marks on the plat below.
2. If more than one lease is dedicated to the well, outline each and identify the ownership thereof (both as to working interest and royalty).
3. If more than one lease of different ownership is dedicated to the well, have the interests of all owners been consolidated by communitization, unitization, force-pooling, etc?

☐ Yes ☐ No If answer is "yes," type of consolidation _____

If answer is "no," list the owners and tract descriptions which have actually been consolidated (use reverse side of this form if necessary.) _____

No allowable will be assigned to the well until all interests have been consolidated (by communitization, unitization, forced-pooling, or otherwise) or until a non-standard unit, eliminating such interests, has been approved by the Commission.

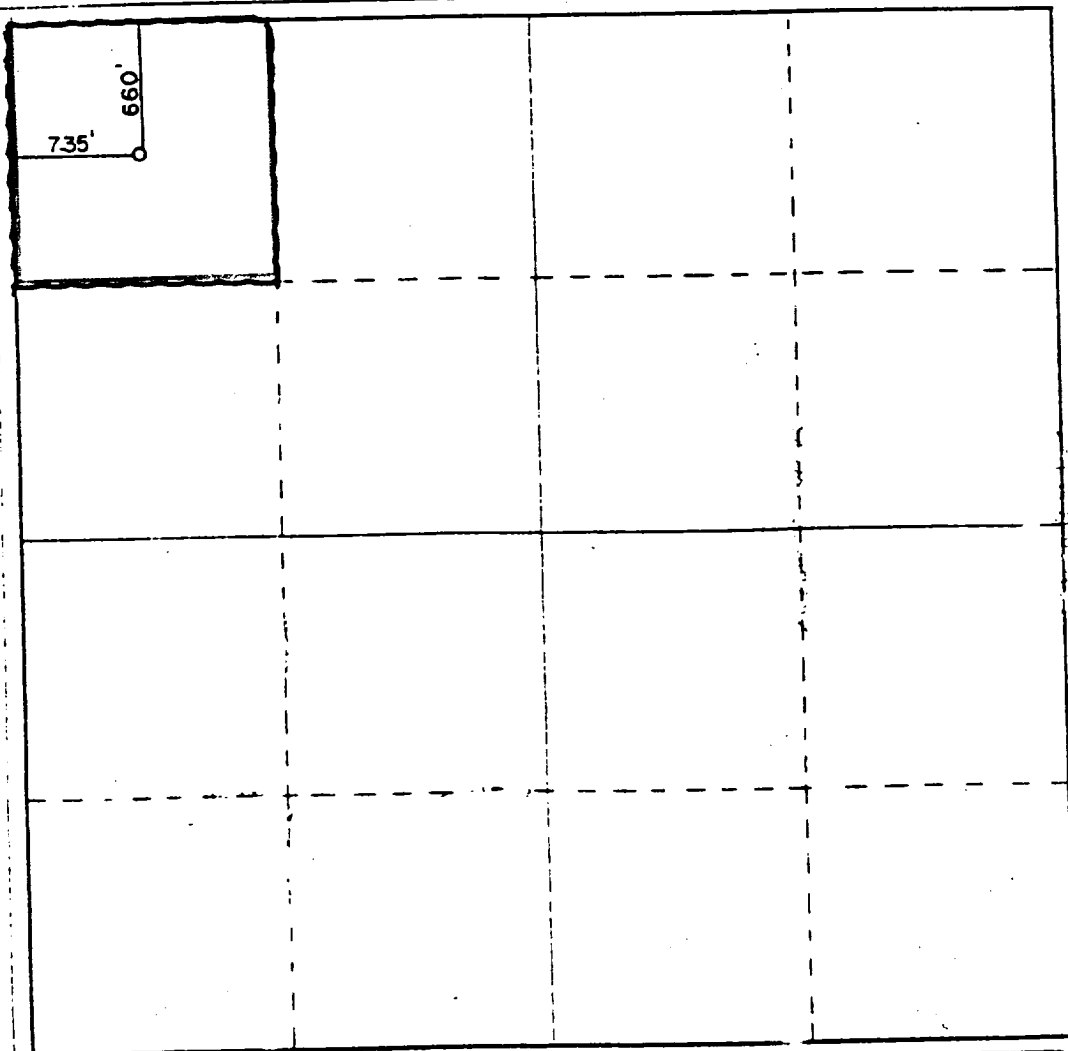

CERTIFICATION

I hereby certify that the information contained herein is true and complete to the best of my knowledge and belief

H. J. Blum

Stf. Admin. Analyst

Amoco Production Company

1 - 12 - 1990

I hereby certify that the well location shown on this plat was plotted from field notes of actual surveys made by me or under my supervision, and that the same is true and correct to the best of my knowledge and belief

By the Surveyor

Registered Professional Surveyor
and State License No.

Certificate No. John W. West 676
Ronald J. Eidson 1239

330 660 1320 1980 2640 3300 3960 4620 5280 5940 6600

STANDARD 2000 PSI W.P. BOP STACK

1. Blow-out preventers may be manually operated.
2. All equipment must be in good condition, 2,000 psi W.P. (4,000 psi test) minimum.
3. Bell nipple above blow-out preventer shall be same size as casing being drilled through.
4. Kelly cock to be installed on kelly.
5. Full opening safety valve 2,000 psi w.p. (4,000 psi test) minimum must be available on rig floor at all times with proper connection or subs to fit any tool joint in string.
6. Spool or cross may be eliminated if connections are available in the lower part of the blow-out preventer body.
7. Double or space saver type preventers may be used in lieu of two single preventers.
8. BOP rams to be installed as follows:
 - Top preventer - Drill pipe or casing rams
 - Bottom preventer - Blind rams

*Amoco District Superintendent may reverse location of rams.
9. Extensions and hand wheels to be installed and braced at all times.
10. Manifold valves may be gate or plug metal to metal seal 2" minimum.

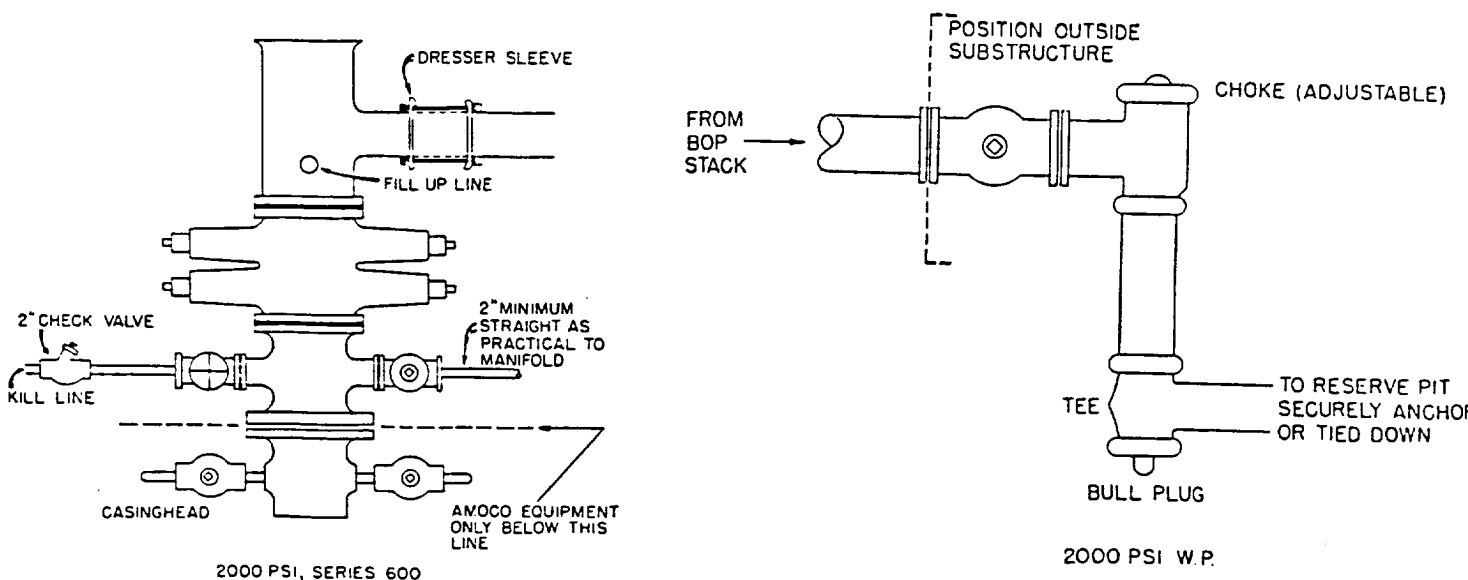

RECEIVED

JAN 18 1990

OCD
HOBBS OFFICE