

NEW MEXICO OIL CONSERVATION COMMISSION
WELL LOCATION AND ACREAGE DEDICATION PLAT

Form C-112
Supersedes C-12H
Effective 1-1-65

All distances must be from the outer boundaries of the Section

Lessee AMERADA HESS CORP.			Lease STATE L. GAS COM. 3		Well No. 3
Section 20	Township 19 South	Range 37 East	County Lea		
Well Location of Well:					
1930	feet from the	North	line and	960	feet from the
					West
Well Elev. 3653.1	Producing Formation 7-Rivers Queen		Pool Eumont		Dedicated Acreage: 160
					Acres

- Outline the acreage dedicated to the subject well by colored pencil or hatchure marks on the plat below.
- If more than one lease is dedicated to the well, outline each and identify the ownership thereof (both as to working interest and royalty).
- If more than one lease of different ownership is dedicated to the well, have the interests of all owners been consolidated by communitization, unitization, force-pooling, etc?

☒ Yes ☐ No If answer is "yes," type of consolidation _____

If answer is "no," list the owners and tract descriptions which have actually been consolidated. (Use reverse side of this form if necessary.) _____

No allowable will be assigned to the well until all interests have been consolidated (by communitization, unitization, force-pooling, or otherwise) or until a non-standard unit, eliminating such interests, has been approved by the Commission.

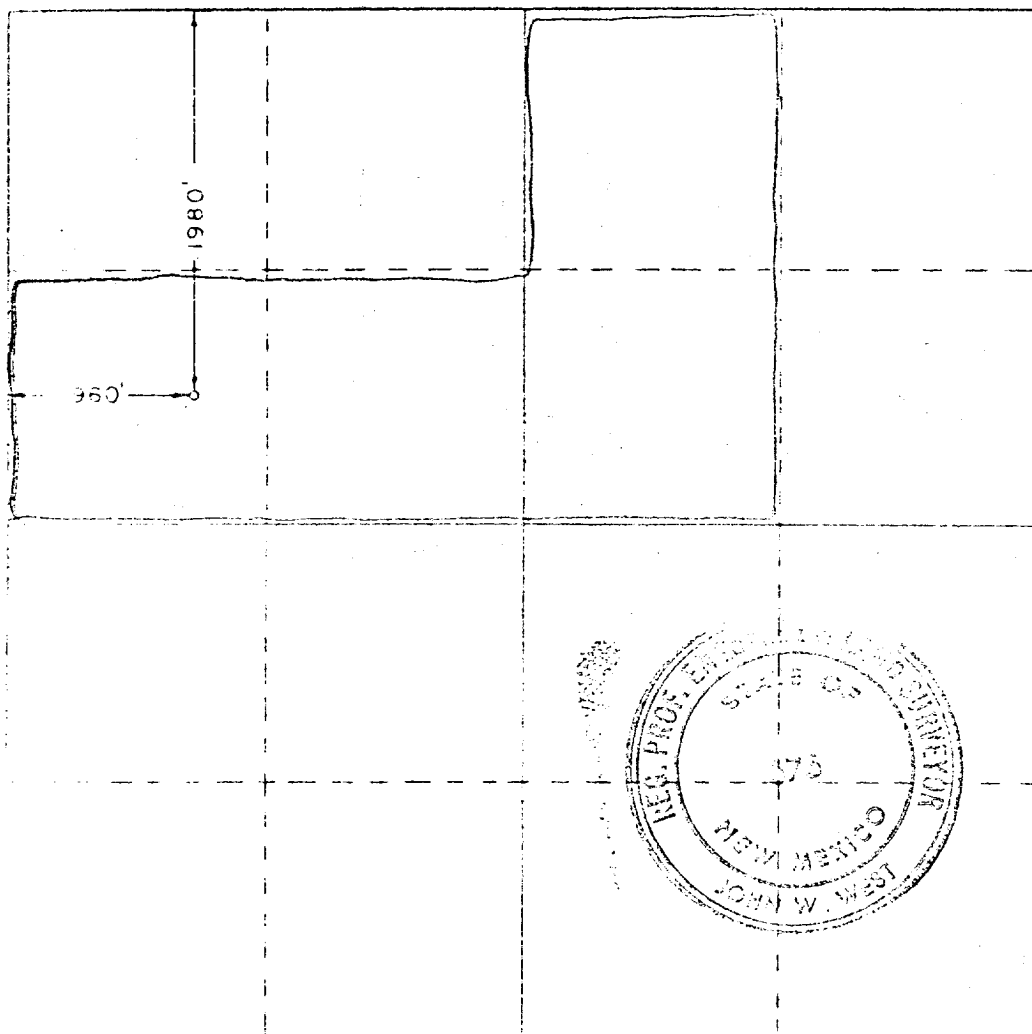

CERTIFICATION

I hereby certify that the information contained herein is true and complete to the best of my knowledge and belief.

Name

E. B. Fisher

Position

Supv. Adm. Ser.

Company

Amerada Hess Corp.

Date

April 25, 1980

I hereby certify that the well location shown on this plat was plotted from field notes of actual surveys made by me or under my supervision, and that the same is true and correct to the best of my knowledge and belief.

Date Surveyed

October 30, 1979

Registered Professional Engineer and Land Surveyor

John W. West

Certified by

John W. West

676

Revised J. E. Fisk 7-2-79