



# United States Department of the Interior

GEOLOGICAL SURVEY  
South Central Region  
P. O. Box 26124  
Albuquerque, New Mexico 87125

RECEIVED

FEB 26 1981

MAR 5 1981

U.S. GEOLOGICAL SURVEY  
HOBBS, NEW MEXICO

Anadarko Production Company  
P. O. Box 806  
Eunice, New Mexico 88231

Gentlemen:

Your Application for Permit to Drill oil well No. 1 Federal "W" in the SE $\frac{1}{4}$ NW $\frac{1}{4}$  sec. 14, T. 20 S., R. 33 E., Lea County, New Mexico, lease Las Cruces 065658, to a depth of 3700 feet in the Capitan Reef formation in the Oil Potash area is hereby approved, as amended by stipulations attached to the application.

Please note that this approval applies only to the drilling and completion of this well for oil and gas production. Your lease instrument does not entitle you to use of any water encountered. Use of such water may be subject to applicable state regulation.

One copy of the application is returned herewith. Please notify the District Supervisor, Geological Survey, Hobbs, New Mexico, in sufficient time for a representative to witness all cementing operations.

Sincerely yours,

Gene F. Daniel  
Deputy Conservation Manager  
Oil and Gas

Enclosure

cc:  
NMOCD, Hobbs (2) (w/enclosures) ✓  
BLM (w/enclosure)

UNITED STATES  
DEPARTMENT OF THE INTERIOR  
GEOLOGICAL SURVEY

## APPLICATION FOR PERMIT TO DRILL, DEEPEN, OR PLUG BACK

1a. TYPE OF WORK  
DRILL ☒ DEEPEN ☐ PLUG BACK ☐

b. TYPE OF WELL  
OIL WELL ☐ GAS WELL ☐ OTHER ☐ MULTIPLE ZONE ☐

2. NAME OF OPERATOR  
Anadarko Production Company

3. ADDRESS OF OPERATOR  
P.O. Box 806 Eunice, New Mexico 88231

4. LOCATION OF WELL (Report location clearly and in accordance with any State requirements.)  
At surface  
1330' FN & W Line Section 14 TWP 20S Rge 33E  
At proposed prod. zone  
Same

14. DISTANCE IN MILES AND DIRECTION FROM NEAREST TOWN OR POST OFFICE\*  
35 Miles West of Hobbs, New Mexico

10. DISTANCE FROM PROPOSED\* LOCATION TO NEAREST PROPERTY OR LEASE LINE, FT. (Also to nearest drg. unit line, if any)  
1330'

16. NO. OF ACRES IN LEASE  
1160

17. NO. OF ACRES ASSIGNED TO THIS WELL  
N.A.

18. DISTANCE FROM PROPOSED LOCATION\* TO NEAREST WELL, DRILLING, COMPLETED, OR APPLIED FOR, ON THIS LEASE, FT.  
481'

19. PROPOSED DEPTH  
3700'

20. ROTARY OR CABLE TOOLS  
RT

21. ELEVATIONS (Show whether DF, RT, GR, etc.)  
3590.3 GR

22. APPROX. DATE WORK WILL START\*  
2-21-81

## PROPOSED CASING AND CEMENTING PROGRAM

SIZE OF HOLE	SIZE OF CASING	WEIGHT PER FOOT	SETTING DEPTH	QUANTITY OF CEMENT
15½"	10-3/4"	40.5#	1300'	1060 sx to circulate
9-7/8"	7-5/8"	26.4#	3700'	770 sx to circulate

1. Rig up rotary tools, drill 15½" hole to 1300'.
2. Run 1300' of 10-3.4" csg. Circulate cement.
3. Nipple up, set BOP.
4. Drill 9-7/8" hole to 3700'.
5. Run 3700' of 7-5/8" csg. Circulate cement.
6. Complete as water supply well.
7. POP

RECEIVED

JAN 29 1981

U.S. GEOLOGICAL SURVEY

IN ABOVE SPACE DESCRIBE PROPOSED PROGRAM: If proposal is to deepen or plug back, give data on present productive zone and proposed new productive zone. If proposal is to drill or deepen directionally, give pertinent data on subsurface locations and measured and true vertical depths. Give blowout preventer program, if any.

24. Original by: John C. English TITLE Area-Supervisor DATE 1-28-81  
SIGNED (This space for Federal or State office use)

PERMIT NO. \_\_\_\_\_ APPROVAL DATE \_\_\_\_\_  
APPROVED BY Gene Daniel TITLE Deputy, Conn Mgr DATE 2-26-81  
CONDITIONS OF APPROVAL, IF ANY:

RECEIVED

MAR 10 1981

OIL CONSERVATION UNIT

W MEXICO OIL CONSERVATION COMMISSION  
WELL LOCATION AND ACREAGE DEDICATION PLAT

Form O-10,  
Supersedes O-128  
Effective 1-1-65

All distances must be from the outer boundaries of the Section

Operator <b>Anadarko Production Co.</b>		Lease <b>Teas Yates Unit Water Supply</b>		Section <b>1</b>	
Tract <b>F</b>	Section <b>14</b>	Range <b>20 South</b>	Meridian <b>13 East</b>	County <b>Lee County, New Mexico</b>	
Distance from North <b>1330</b>		Distance from West <b>1330</b>		Distance from East <b>None</b>	
Distance from South <b>3590.3</b>		Distance from North <b>Capitan Reef</b>		Distance from West <b>Teas Yates</b>	

1. Outline the acreage dedicated to the subject well by colored pencil or hatchure marks on the plat below.
2. If more than one lease is dedicated to the well, outline each and identify the ownership thereof, both as to working interest and royalty.
3. If more than one lease of different ownership is dedicated to the well, have the interests of all owners been consolidated by communitization, unitization, force-pooling, etc?

☒ Yes ☐ No If answer is "yes," type of consolidation **Unitization**

If answer is "no," list the owners and tract descriptions which have actually been consolidated. Use reverse side of this form if necessary.

No allowable will be assigned to the well until all interests have been consolidated by communitization, unitization, force-pooling, or otherwise or until a non-standard unit, eliminating such interests, has been approved by the Commission.

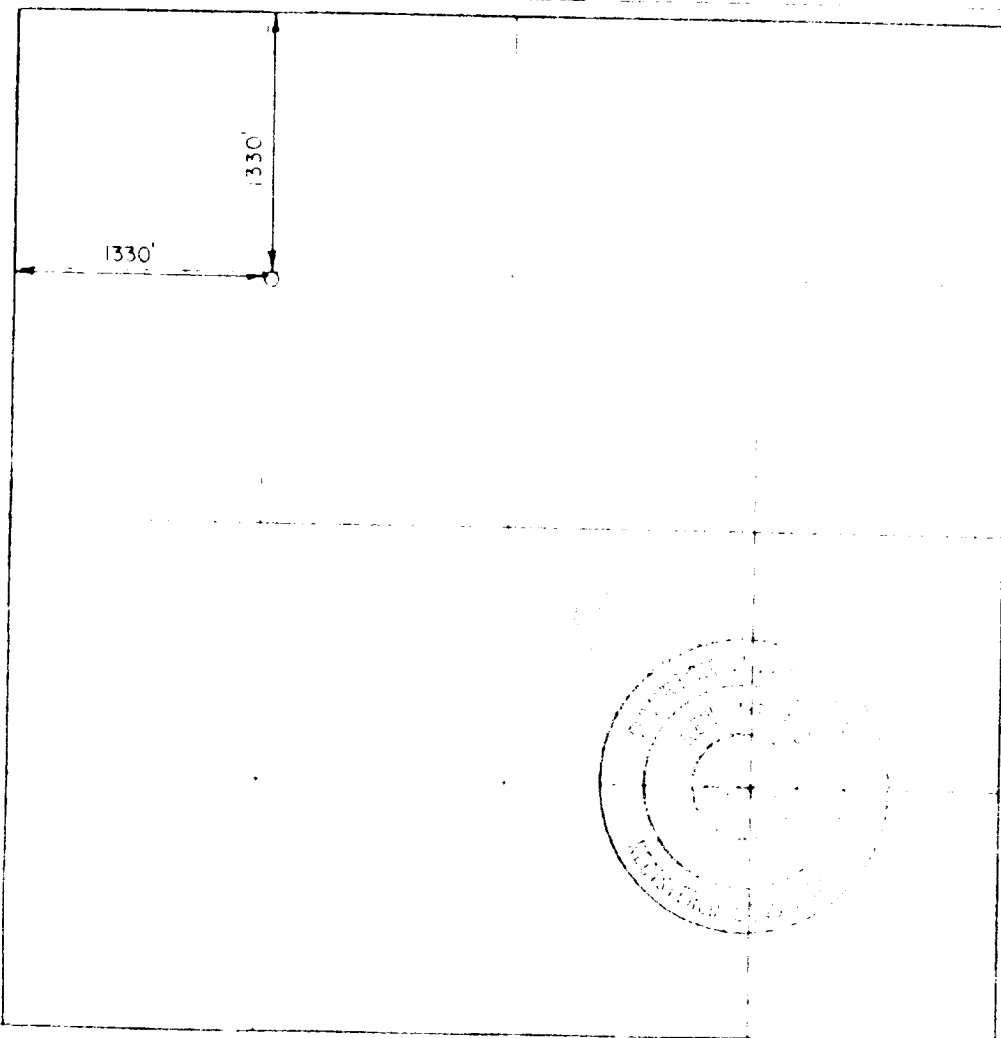

CERTIFICATION

I hereby certify that the information furnished herein is true and complete to the best of my knowledge and belief.

**John C. English**

**Area-Supervisor**

**Anadarko Production Co.**

**January 28, 1981**

*John C. English*

I hereby certify that the well location shown on this plat was plotted from field notes of actual surveys made by me or under my supervision, and that the same is true and correct to the best of my knowledge and belief.

**1-10-81**

Signature of Registered Professional Surveyor

*Patrick A. Romero*

Certificate No. **JOHN W. WEST 676**  
**PATRICK A. ROMERO 6863**

RECEIVED

MAR 10 1981

THE COLLEGE OF HUMANITIES

# Anadarko

PRODUCTION COMPANY

P. O. Box 806 • Eunice, New Mexico 88231 • (505) 394-3184

A  
Panhandle  
Eastern  
Company

January 28, 1981

Mr. Jim Gillam  
United States Geological Survey  
P.O. Box 1157  
Hobbs, New Mexico 88240

Dear Sir:

This data sheet is provided in reference to an application for permit to drill the Anadarko Production Company's Teas Yates Unit WSW #1.

1. Location- 1330' FNL and 1330' FWL, Sec-14, T-20S, R-33E, Lea County, NEW MEXICO.
2. Elevation- 3590.3'.
3. Geological Name of Surface Formation-Triassic-Doakum (Santa Rosa).
4. Type of Drilling Tools- Rotary Tools.
5. Proposed Drilling Depth- 3700'.
6. Top of Important Geological Markers:
  - A. Salt- 1400'.
  - B. Yates-3200'.
  - C. Seven Rivers- 3500'.
  - D. Capitan Reef- 3600'.
7. Estimated Depth of Anticipated Water, Oil or Gas:
  - A. Yates- 3200'.
  - B. Seven Rivers- 3500'.
  - C. Capitan Reef- 3600'.
8. Casing Program:

10-3/4"	40.5#	@ 1300'	(New)
7-5/8"	26.4#	@ 3700'	(New)
9. Setting Depth of Casings and Amount and Type of Cement:

Size	Depth	Amount & Type of Cement
10-3/4"	1300'	310 sx Class C w/2% CaCl
		750 sx Halliburton Light or more if necessary to circulate.
7-5/8"	3700'	770 sx Class H, additional cementing through DV tool if necessary to circulate.

RECEIVED

MAR 10 1981

CONSERVATION DIV.





10. Specifications for Pressure Control Equipment:  
(see attached schematic)  
11" Shaffer Type B Hydraulic BOP  
When nippleing up, test BOP @1000# psi.  
Operate Bop equipment once each day.
11. Mud System:  
0'-1300'- Native fresh water mud.  
1300'-3700'- Cut brine to control hole size in salt section.
12. Testing, Logging and Coring Programs:  
No DST's planned.  
No Coring planned.  
Logging (wireline)- Cased hole GR Compensated Neutron from TD 3700' back to surface.
13. Potential Hazards- None- No abnormal high pressure or low pressure zones will be encountered at this depth.
14. Anticipated Starting Date and Duration:  
With approval of this application, drilling operations will begin on or about February 21, 1981. Drilling and completion operations will be about 15 days.
15. Other Facets:  
Mr. John Burleson, Federal Mine Supervisor at Carlsbad was contacted by telephone, December 1, 1980. Received his approval for location of well by telephone the same day.

Yours very truly,  
Anadarko Production Co.

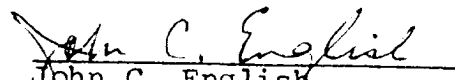
  
John C. English  
Area-Supervisor

JCE/bn

3000 lb. WP BOP  
11" Shaffer Type B Hydraulic BOT 3000 PST  
80 Gallon- 5 Station Kookey Accumulator

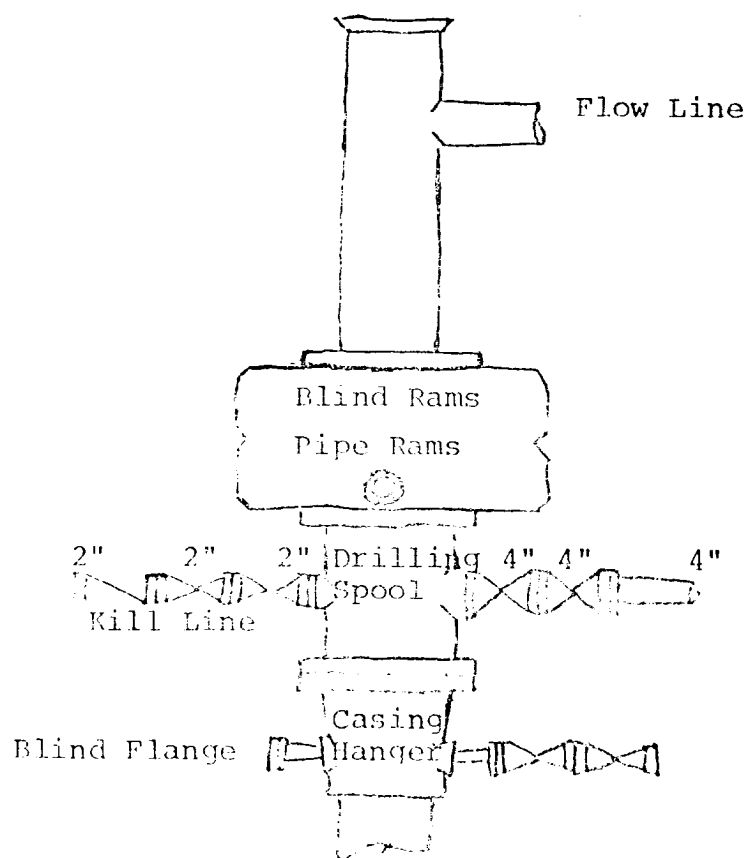

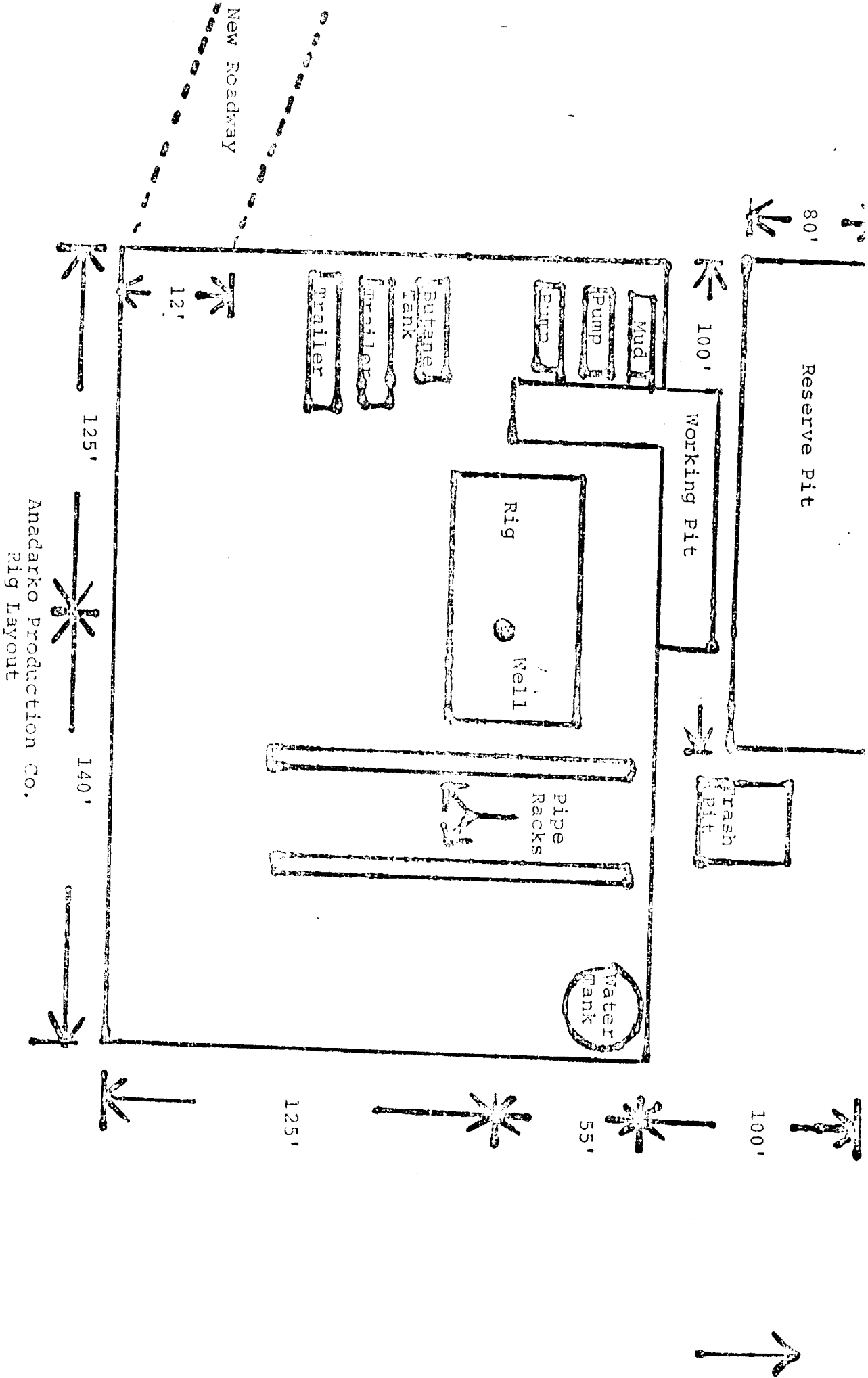

Anadarko Production Co.  
Rig Layout