

NO. OF COPIES RECEIVED	
DISTRIBUTION	
SANTA FE	
FILE	
U.S.G.S.	
LAND OFFICE	
OPERATOR	

# NEW MEXICO OIL CONSERVATION COMMISSION

NMOCD (0+5)  
 1-DW Engineer  
 1-HS Foreman  
 1-File  
 1-BB

Form C-101  
 Revised 1-1-65

5A. Indicate Type of Lease STATE <input checked="" type="checkbox"/> FEE <input type="checkbox"/>
5. State Oil & Gas Lease No. L-6726
7. Unit Agreement Name
8. Farm or Lease Name Lynch 36 State
9. Well No. 1
10. Field and Pool, or Wildcat Lynch Seven Rivers Yates
12. County Lea

APPLICATION FOR PERMIT TO DRILL, DEEPEN, OR PLUG BACK	
1a. Type of Work b. Type of Well DRILL <input checked="" type="checkbox"/> DEEPEN <input type="checkbox"/> PLUG BACK <input type="checkbox"/> OIL WELL <input checked="" type="checkbox"/> GAS WELL <input type="checkbox"/> OTHER <input type="checkbox"/> SINGLE ZONE <input checked="" type="checkbox"/> MULTIPLE ZONE <input type="checkbox"/>	2. Name of Operator Getty Oil Company
3. Address of Operator PO Box 730, Hobbs, New Mexico 88240	4. Location of Well UNIT LETTER E LOCATED 1980 FEET FROM THE North LINE 660 FEET FROM THE West LINE OF SEC. 36 TWP. 20S RGE. 34E NMPN.
17. Proposed Depth 3800	19A. Formation 7 Rivers-Yates
20. Rotary or C.T. Rotary	21. Elevation (Show whether DR, KI, etc.) 3746.6 GL
21A. Kind & Status Plug Bond Blanket	21B. Drilling Contractor N.A.
22. Approx. Date Work will start October, 1981	

## PROPOSED CASING AND CEMENT PROGRAM

SIZE OF HOLE	SIZE OF CASING	WEIGHT PER FOOT	SETTING DEPTH	SACKS OF CEMENT	EST. TOP
12 1/4	8 5/8	24	1100	580	Surface
7 7/8	5 1/2	15.5	3800	500	Surface

The proposed well will be drilled from the surface to a total depth of 3800' with rotary tools. The pump and plug process will be used in cementing all strings of casing and cement will be circulated to the surface on the 8 5/8" and 5 1/2" casing. The 5 1/2" casing will be perforated as indicated by electric logs opposite the Yates-Seven Rivers formation.

The drilling fluid will be brine water and mud of sufficient weight to condition the hole for logging and running casing. Blowout preventers will be installed and tested to 5000 psi. See attached BOP schematic.

APPROVAL VALID FOR 180 DAYS  
 PERMIT EXPIRES 1/16/82  
 UNLESS DRILLING UNDERWAY

ABOVE SPACE DESCRIBE PROPOSED PROGRAM; IF PROPOSAL IS TO DEEPEN OR PLUG BACK, GIVE DATA ON PRESENT PRODUCTIVE ZONE AND PROPOSED NEW PRODU-  
 VE ZONE. GIVE BLOWOUT PREVENTER PROGRAM, IF ANY.

I hereby certify that the information above is true and complete to the best of my knowledge and belief.

Signed Dale R. Crockett Title Area Superintendent Date 7-8-81

(This space for State Use)

APPROVED BY [Signature] TITLE SUPERVISOR DISTRICT 3 DATE JUL 16 1981  
 CONDITIONS OF APPROVAL, IF ANY:

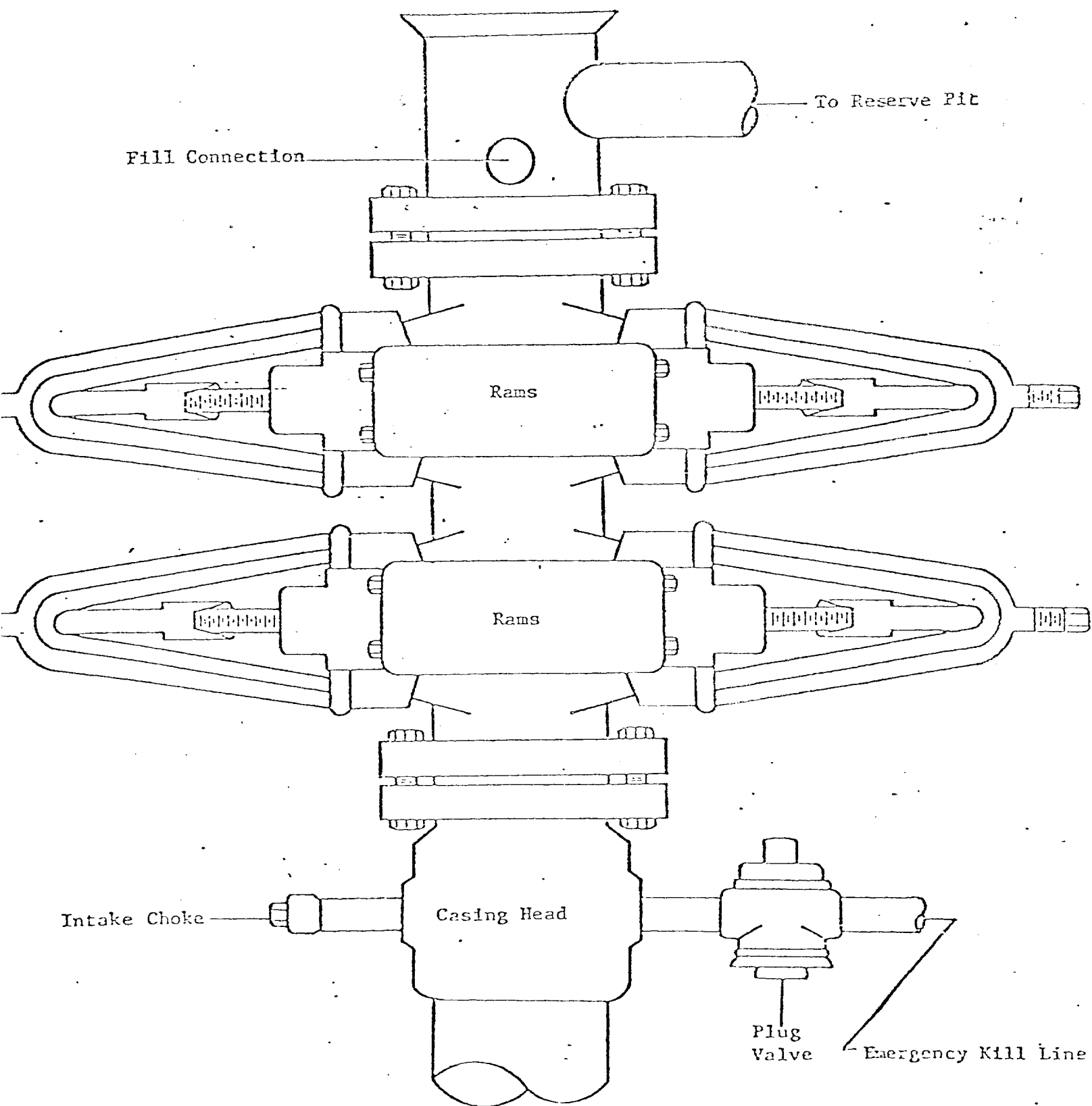

FIGURE I  
GETTY OIL COMPANY

5000 PSI WORKING PRESSURE  
DRILLING CONTROL HOOK-UP

NEW MEXICO OIL CONSERVATION COMMISSION  
WELL LOCATION AND ACREAGE DEDICATION PLAT

Form C-102  
Supersedes C-128  
Effective 1-1-65

All distances must be from the outer boundaries of the Section

Operator Getty Oil Company		Lease Lynch 36 State			Well No. 1
Tract Letter "1"	Section 36	Township 20 South	Range 34 East	County Lea	
Actual Footage Location of Well: 1950 feet from the North line and 660 feet from the West line					
Ground Level Elev. 3746.5	Producing Formation Seven Rivers-Yates		Pool Lynch Seven Rivers Yates		Dedicated Acreage: 40 Acres

1. Outline the acreage dedicated to the subject well by colored pencil or hatchure marks on the plat below.
2. If more than one lease is dedicated to the well, outline each and identify the ownership thereof (both as to working interest and royalty).
3. If more than one lease of different ownership is dedicated to the well, have the interests of all owners been consolidated by communitization, unitization, force-pooling, etc?

☐ Yes ☐ No If answer is "yes," type of consolidation \_\_\_\_\_

If answer is "no," list the owners and tract descriptions which have actually been consolidated. (Use reverse side of this form if necessary.) \_\_\_\_\_

No allowable will be assigned to the well until all interests have been consolidated (by communitization, unitization, forced-pooling, or otherwise) or until a non-standard unit, eliminating such interests, has been approved by the Commission.

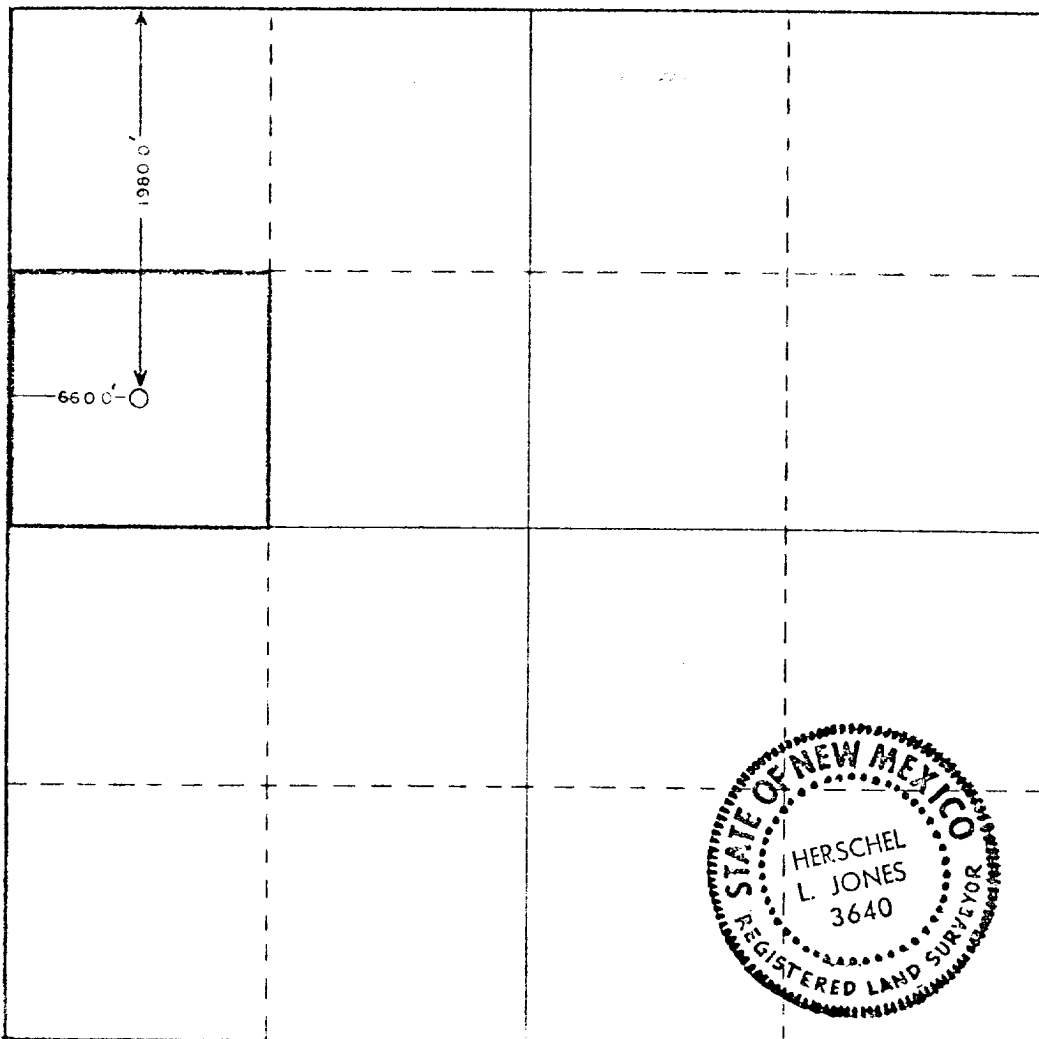

CERTIFICATION

I hereby certify that the information contained herein is true and complete to the best of my knowledge and belief.

*Dale R. Crockett*

Name

Dale R. Crockett

Position

Area Superintendent

Company

Getty Oil Company

Date

7-8-81

I hereby certify that the well location shown on this plat was plotted from field notes of actual surveys made by me or under my supervision, and that the same is true and correct to the best of my knowledge and belief.

Date Surveyed

June 24, 1981

Registered Professional Engineer and/or Land Surveyor

*Herbert A. Jones*

Certificate No.

3640

330 660 990 1320 1650 1980 2310 2640 2970 3300 3630 3960 4290 4620 4950 5280 5610 5940 6270 6600 6930 7260 7590 7920 8250 8580 8910 9240 9570 9900

Comment: Ben's Reg  
3/2/72

116