

NO. OF COPIES RECEIVED		
DISTRIBUTION		
SANTA FE		
FILE		
U.S.G.S.		
LAND OFFICE		
OPERATOR		

NEW MEXICO OIL CONSERVATION COMMISSION

Form C-101
Revised 1-1-65

5A. Indicate Type of Lease	
STATE <input type="checkbox"/>	FEE <input checked="" type="checkbox"/>
5. State Oil & Gas Lease No.	

APPLICATION FOR PERMIT TO DRILL, DEEPEN, OR PLUG BACK

1a. Type of Work		7. Unit Agreement Name	
b. Type of Well DRILL <input type="checkbox"/> DEEPEN <input type="checkbox"/> PLUG BACK <input checked="" type="checkbox"/> OIL WELL <input type="checkbox"/> GAS WELL <input checked="" type="checkbox"/> OTHER <input type="checkbox"/> SINGLE ZONE <input type="checkbox"/> MULTIPLE ZONE <input type="checkbox"/>		8. Farm or Lease Name McKinley	
2. Name of Operator Amoco Production Company		9. Well No. 20	
3. Address of Operator P. O. Box 68, Hobbs, New Mexico 88240		10. Field and Pool, or Wildcat UNDESIGNATED	
4. Location of Well UNIT LETTER F LOCATED 1785 FEET FROM THE North LINE AND 1810 FEET FROM THE West LINE OF SEC. 5 TWP. 19-S RGE. 38-E NMPM		12. County Lea	
19. Proposed Depth		19A. Formation Yates	
20. History or C.F.		21. Elevations (Show whether LI, RT, etc.) 3621.1 GL	
21A. Kind & Status Plug. Bond Blanket-on-file		21B. Drilling Contractor	
22. Approx. Date Work will start			

23. PROPOSED CASING AND CEMENT PROGRAM					
SIZE OF HOLE	SIZE OF CASING	WEIGHT PER FOOT	SETTING DEPTH	SACKS OF CEMENT	EST. TOP
12-1/4	9-5/8	32.3	402	250 C1 C	Circ.
8-3/4	7	23	3402	700 lite, 700 C1C	Circ.

Propose to abandon the Bowers Seven Rivers and test the Yates.
Move in-service unit. Pull rods, pump, and tubing. Run in hole with 72 hrs. pressure bomb. Run test. Pull bomb. Run in hole with CIBP and 2-3/8" tubing. Set CIBP at 3080'. Test to 500 PSI and cap with 35' of cement. Pull tubing to 2752'. Spot 200 gallons 10% Acetic acid across interval 2682'-2752'. Perforate Yates intervals 2682'-94', 2712'-18', and 2740'-52' with 4 JSPF. Run in hole with 2-3/8" tubing and treating packer with 1 joint of tailpipe. Set packer at 2630'. Run logs. Acidize Yates with 3600 gallons 15% NE HCL acid. Flow test well. Run 72 hr. bottom hole pressure test.

O+4-NMOCD,H 1-HOU 1-W. Stafford, HOU 1-DMF

IN ABOVE SPACE DESCRIBE PROPOSED PROGRAM: IF PROPOSAL IS TO DEEPEN OR PLUG BACK, GIVE DATA ON PRESENT PRODUCTIVE ZONE AND PROPOSED NEW PRODUCTIVE ZONE, GIVE BLOWOUT PREVENTER PROGRAM, IF ANY.

I hereby certify that the information above is true and complete to the best of my knowledge and belief.

Signed Mark Freeman Title Assist. Admin. Analyst Date 9-24-82
(This space for State Use)

APPROVED BY Eddie W. S. TITLE OIL & GAS INSPECTOR DATE OCT 5 1982
CONDITIONS OF APPROVAL, IF ANY:

NEW MEXICO OIL CONSERVATION COMMISSION
WELL LOCATION AND ACREAGE DEDICATION PLAT

Form C-102
Supersedes C-128
Effective 1-1-65

All distances must be from the outer boundaries of the Section.

Operator Amoco Production Company		Lease McKinley		Well No. 20
Unit Letter F	Section 5	Township 19-S	Range 38-E	County Lea

Actual Footage Location of Well: 1785 feet from the North line and 1810 feet from the West line				
Ground Level Elev. 3621.1	Producing Formation Yates	Pool UNDESIGNATED	Dedicated Acreage: 160 Acres	

1. Outline the acreage dedicated to the subject well by colored pencil or hachure marks on the plat below.
2. If more than one lease is dedicated to the well, outline each and identify the ownership thereof (both as to working interest and royalty).
3. If more than one lease of different ownership is dedicated to the well, have the interests of all owners been consolidated by communitization, unitization, force-pooling, etc?

☐ Yes ☐ No If answer is "yes," type of consolidation _____

If answer is "no," list the owners and tract descriptions which have actually been consolidated. (Use reverse side of this form if necessary.) _____

No allowable will be assigned to the well until all interests have been consolidated (by communitization, unitization, forced-pooling, or otherwise) or until a non-standard unit, eliminating such interests, has been approved by the Commission.

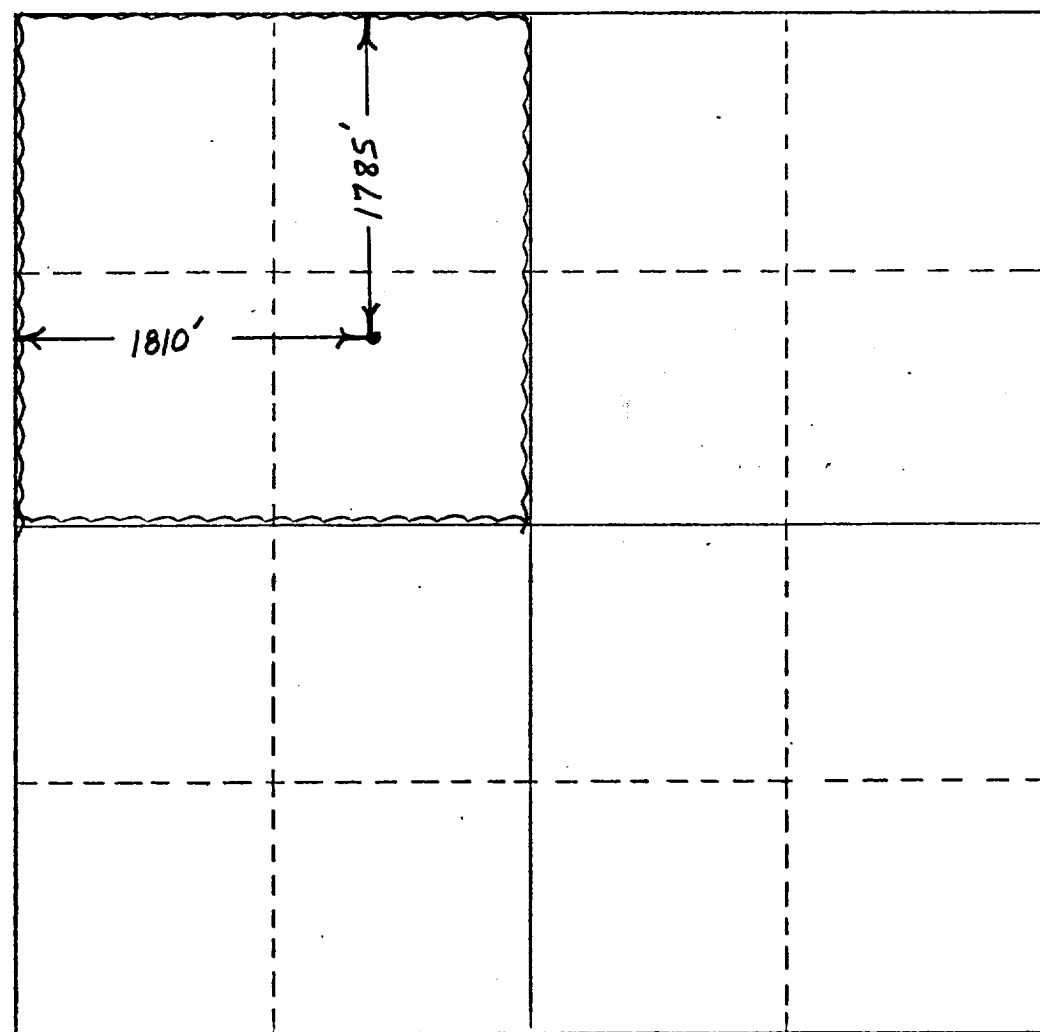

CERTIFICATION

I hereby certify that the information contained herein is true and complete to the best of my knowledge and belief.

Name *Mark Freeman*

Position
Assist. Admin. Analyst

Company
Amoco Production Company

Date
September 29, 1982

I hereby certify that the well location shown on this plat was plotted from field notes of actual surveys made by me or under my supervision, and that the same is true and correct to the best of my knowledge and belief.

Date Surveyed

Registered Professional Engineer and/or Land Surveyor

Certificate No.

