

STATE OF NEW MEXICO
ENERGY AND MINERALS DEPARTMENT

LAND CONSERVATION DIVISION
P. O. BOX 2088
SANTA FE, NEW MEXICO 87501

30-025-28864

Form C-101
Revised 10-1-78

NO. OF COPIES RECEIVED	
DISTRIBUTION	
SANTA FE	
FILE	
U.S.G.S.	
LAND OFFICE	
OPERATOR	

5A. Indicate Type of Lease	
STATE <input checked="" type="checkbox"/>	FEE <input type="checkbox"/>
5. State Oil & Gas Lease No.	
A-1212-1	

APPLICATION FOR PERMIT TO DRILL, DEEPEN, OR PLUG BACK

1a. Type of Work				7. Unit Agreement Name	
b. Type of Well DRILL <input checked="" type="checkbox"/> DEEPEN <input type="checkbox"/> PLUG BACK <input type="checkbox"/> OIL WELL <input checked="" type="checkbox"/> GAS WELL <input type="checkbox"/> OTHER <input type="checkbox"/> SINGLE ZONE <input checked="" type="checkbox"/> MULTIPLE ZONE <input type="checkbox"/>				8. Farm or Lease Name	
2. Name of Operator				9. Well No.	
Amoco Production Company				161	
3. Address of Operator				10. Field and Pool, or Wildcat	
P. O. Box 68, Hobbs, New Mexico 88240				Hobbs GSA	
4. Location of Well UNIT LETTER <u>G</u> LOCATED <u>2630</u> FEET FROM THE <u>North</u> LINE AND <u>1331</u> FEET FROM THE <u>East</u> LINE OF SEC. <u>9</u> TWP. <u>19-S</u> RGE. <u>38-E</u> NMPM				12. County	
				Lea	
19. Proposed Depth		19A. Formation		20. Rotary or C.T.	
4500'		San Andres		Rotary	
21. Elevations (show whether DF, RT, etc.)		21A. Kind & Status Plug. Bond		22. Approx. Date Work will start	
3594.0' GL		Blanket-on-file			

PROPOSED CASING AND CEMENT PROGRAM

SIZE OF HOLE	SIZE OF CASING	WEIGHT PER FOOT	SETTING DEPTH	SACKS OF CEMENT	EST. TOP
11" or 12-1/4"	8-5/8"	24#	1600'	Circulate	Surface
7-7/8"	5-1/2"	15.5#	4500'	Circulate	Surface

Propose to drill and equip well in the San Andres formation. After reaching TD, logs will be run and evaluated. Perforate and/or stimulate as necessary in attempting commercial production.

BOP Diagram attached.
NMOCD Order No. R-4934-B

Mud Program: 0 - 1600'
1600' - 4300'

Fresh water and native muds.
Brine-with minimum properties for safe hole conditions.

0+5-NMOCD, H 1-HOU R.E. Ogden, Rm 21.150 1-F. J. Nash, HOU Rm. 4.206 1-CMH
1-Texaco 1-Sun 1-Petro Lewis 1-Shell

IN ABOVE SPACE DESCRIBE PROPOSED PROGRAM; IF PROPOSAL IS TO DEEPEN OR PLUG BACK, GIVE DATA ON PRESENT PRODUCTIVE ZONE AND PROPOSED NEW PRODUCTIVE ZONE. GIVE BLOWOUT PREVENTER PROGRAM, IF ANY.

I hereby certify that the information above is true and complete to the best of my knowledge and belief.

Signed Charles M. Herring Title Administrative Analyst

Date 8-30-83

(This space for State Use)

APPROVED BY ORIGINAL SIGNED BY JERRY SEXTON
DISTRICT I SUPERVISOR

CONDITIONS OF APPROVAL, IF ANY:

DATE

AUG 31 1983

APPROVAL VALID FOR 180 DAYS
PERMIT EXPIRES 3/1/84
UNLESS DRILLING UNDERWAY

RECEIVED

AUG 30 1983

C.C.D.
HOLDS OFFICE

NEW MEXICO OIL CONSERVATION COMMISSION
WELL LOCATION AND ACREAGE DEDICATION PLAT

Form C-102
Supersedes C-128
Effective 1-1-65

All distances must be from the outer boundaries of the Section

Operator Amoco Production Company			Lease South Hobbs Grayburg San Andres Unit		Well No. 161
Tract Letter G	Section 9	Township 19 South	Range 38 East	County Lea	
Actual Footage Location of Well: 2630 feet from the north line and 1331 feet from the east line					
Ground Level Elev. 3594.0	Producing Formation San Andres		Pool Hobbs GSA	Dedicated Acreage: 40 Acres	

1. Outline the acreage dedicated to the subject well by colored pencil or hatchure marks on the plat below.
2. If more than one lease is dedicated to the well, outline each and identify the ownership thereof (both as to working interest and royalty).
3. If more than one lease of different ownership is dedicated to the well, have the interests of all owners been consolidated by communitization, unitization, force-pooling, etc?

☐ Yes ☐ No If answer is "yes," type of consolidation _____

If answer is "no," list the owners and tract descriptions which have actually been consolidated. (Use reverse side of this form if necessary.) _____

No allowable will be assigned to the well until all interests have been consolidated (by communitization, unitization, forced-pooling, or otherwise) or until a non-standard unit, eliminating such interests, has been approved by the Commission.

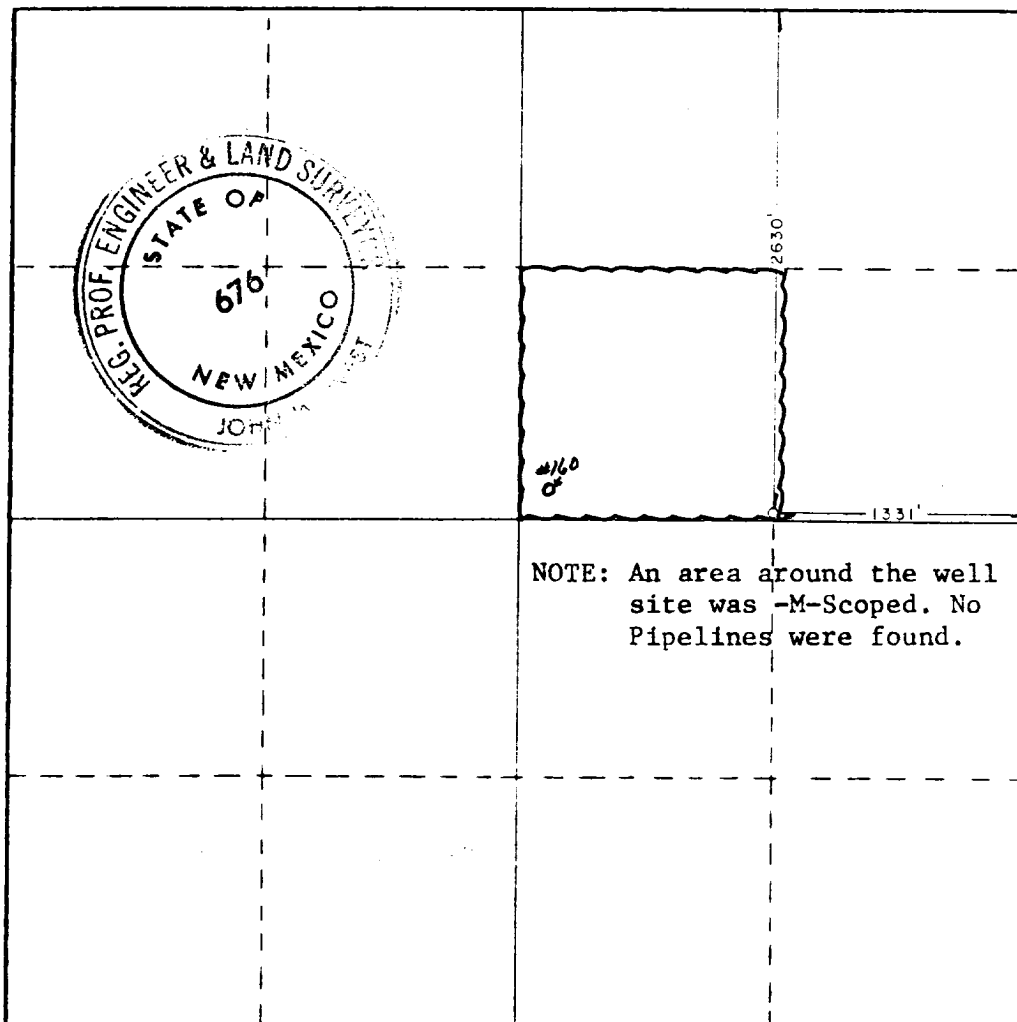

CERTIFICATION

I hereby certify that the information contained herein is true and complete to the best of my knowledge and belief.

Name Charles M. Loring
Position Administrative Analyst
Company Amoco Production Company
Date 8-30-83

I hereby certify that the well location shown on this plat was plotted from field notes of actual surveys made by me or under my supervision, and that the same is true and correct to the best of my knowledge and belief.

Date Surveyed
June 13, 1983

Registered Professional Engineer
and/or Land Surveyor

John W. West

Certificate No. **JOHN W. WEST, 676**
RONALD J. EIDSON, 3239

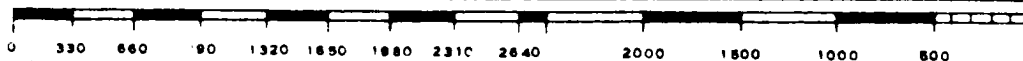

RECEIVED

AUG 30 1983

O.C.D.
HONORS OFFICE

NDARD 2000 PSI W.P. BOP STACK

1. Blow-out preventers may be manually operated.
2. All equipment must be in good condition, 2,000 psi W.P. (4,000 psi test) minimum.
3. Bell nipple above blow-out preventer shall be same size as casing being drilled through.
4. Kelly cock to be installed on kelly.
5. Full opening safety valve 2,000 psi w.p. (4,000 psi test) minimum must be available on rig floor at all times with proper connection or subs to fit any tool joint in string.
6. Spool or cross may be eliminated if connections are available in the lower part of the blow-out preventer body.
7. Double or space saver type preventers may be used in lieu of two single preventers.
8. BOP rams to be installed as follows:
 - Top preventer - Drill pipe or casing rams
 - Bottom preventer - Blind rams

*Amoco District Superintendent may reverse location of rams.
9. Extensions and hand wheels to be installed and braced at all times.
10. Manifold valves may be gate or plug metal to metal seal 2" minimum.

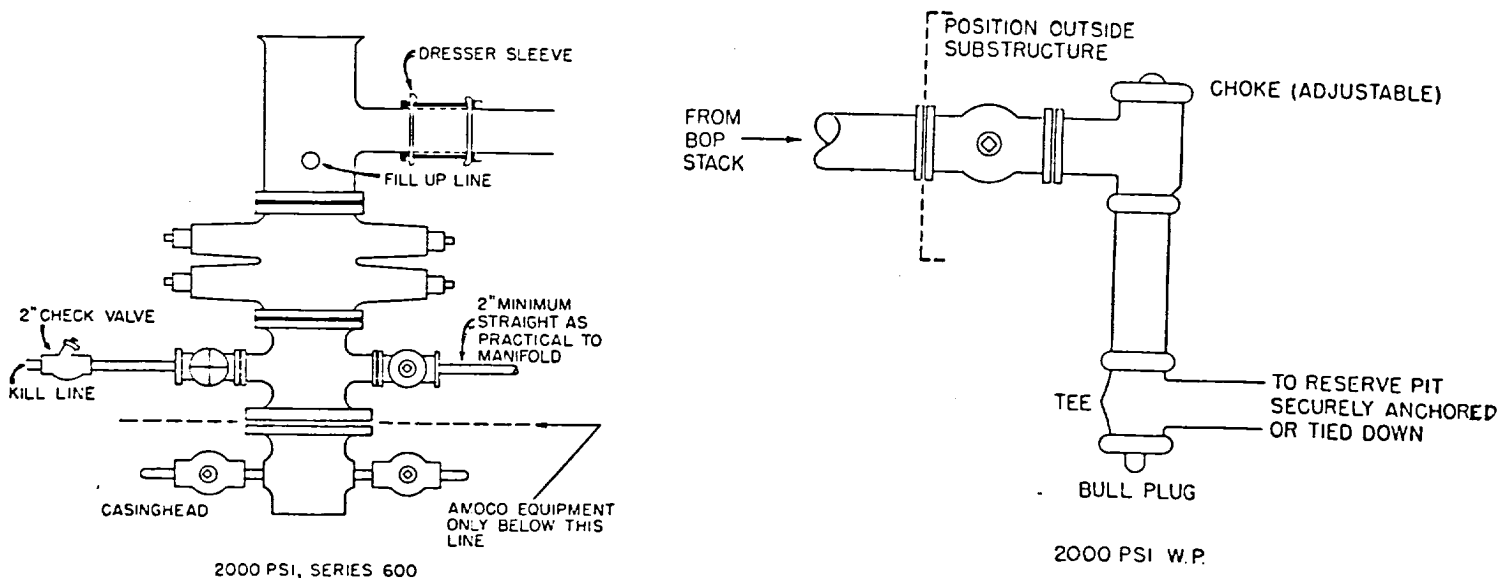

RECEIVED
AUG 30 1983
C.C.D.
POLICE OFFICE

28/18/81
D