

30-025-28435

NO. OF COPIES RECEIVED	
DISTRIBUTION	
SANTA FE	
FILE	
U.S.G.S.	
LAND OFFICE	
OPERATOR	

NEW MEXICO OIL CONSERVATION COMMISSION

Form C-101
Revised 1-1-65

5A. Indicate Type of Lease
STATE <input checked="" type="checkbox"/> FEE <input type="checkbox"/>

5. State Oil & Gas Lease No.
E-5886

APPLICATION FOR PERMIT TO DRILL, DEEPEN, OR PLUG BACK

1a. Type of Work		7. Unit Agreement Name	
b. Type of Well DRILL <input checked="" type="checkbox"/> DEEPEN <input type="checkbox"/> PLUG BACK <input type="checkbox"/> OIL WELL <input checked="" type="checkbox"/> GAS WELL <input type="checkbox"/> OTHER <input type="checkbox"/> SINGLE ZONE <input checked="" type="checkbox"/> MULTIPLE ZONE <input type="checkbox"/>		8. Farm or Lease Name Lea "HQ" State	
2. Name of Operator Gulf Oil Corporation		9. Well No. 3	
3. Address of Operator P.O. Box 670 Hobbs NM 88240		10. Field and Pool, or Wildcat West Pool - San And.	
4. Location of Well UNIT LETTER <u>B</u> LOCATED <u>870</u> FEET FROM THE <u>NORTH</u> LINE AND <u>3310</u> FEET FROM THE <u>East</u> LINE OF SEC. <u>32</u> TWP. <u>19S</u> RGE. <u>35E</u> NMPM		12. County Lea	
19. Proposed Depth 6050		19A. Formation San Andrie	
20. Rotary or C.T. Rotary		21. Elevations (Show whether DF, RT, etc.) 3730.9	
21A. Kind & Status Plug. Bond Blanket		21B. Drilling Contractor UNKNOWN	
22. Approx. Date Work will start Nov 1, 1983		23.	

PROPOSED CASING AND CEMENT PROGRAM

SIZE OF HOLE	SIZE OF CASING	WEIGHT PER FOOT	SETTING DEPTH	SACKS OF CEMENT	EST. TOP
12 1/4"	8 5/8"	24	400'	250	Surface
7 7/8"	5 1/2"	15.50	6050	500	Surface

Mud Program

0-400 Flu spud mud 8.6-lb pp9 32-36 vi's
 400-6050 10 pp9 brine 29-34 vi's

BOP Design #2 3000 psi working pressure

IN ABOVE SPACE DESCRIBE PROPOSED PROGRAM; IF PROPOSAL IS TO DEEPEN OR PLUG BACK, GIVE DATA ON PRESENT PRODUCTIVE ZONE AND PROPOSED NEW PRODUCTIVE ZONE. GIVE BLOWOUT PREVENTER PROGRAM, IF ANY.

I hereby certify that the information above is true and complete to the best of my knowledge and belief.

Signed L. C. Gaudin Title AREA PRODUCTION MGR Date 10-17-83

(This space for State Use)

ORIGINAL SIGNED BY JERRY SEXTON

APPROVED BY DISTRICT 1 SUPERVISOR TITLE DISTRICT 1 SUPERVISOR DATE OCT 20 1983

CONDITIONS OF APPROVAL, IF ANY:

RECEIVED
OCT 19 1983
D.C.P.
HARRIS, BRIAN

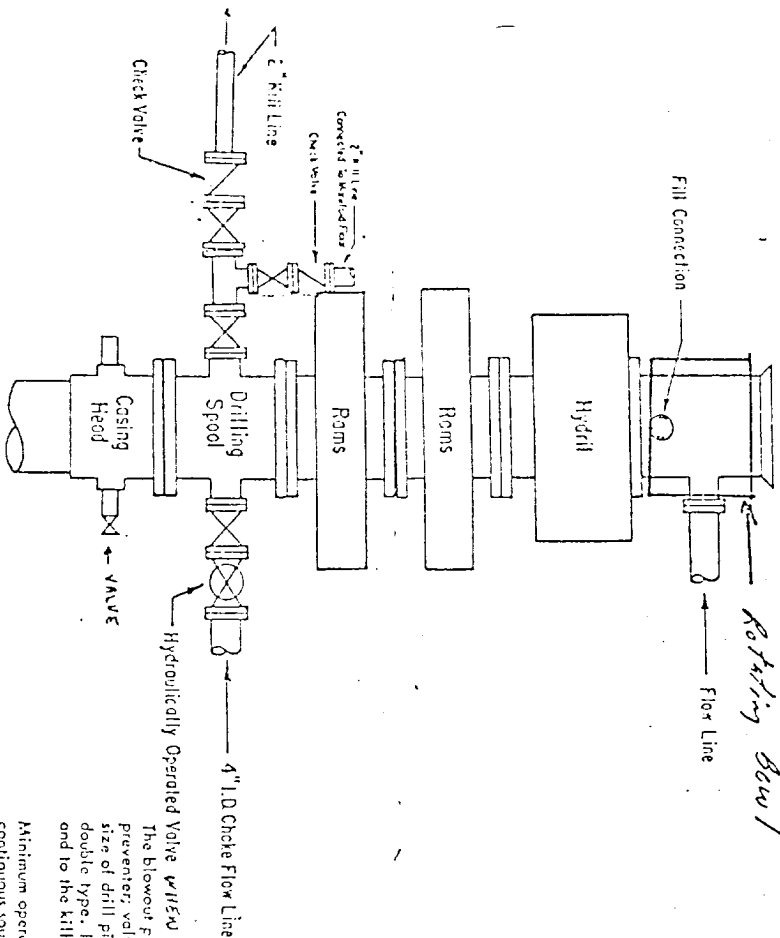

2000-3000 PSI WORKING PRESSURE BOP HOOK - UP FOR LARGE CASINGS

SPECIFY WORKING PRESSURE

The closing manifold and remote closing manifold shall have a separate control for each pressure-operated device. Control one to be labeled, with central handles to indicate open and closed positions. A pressure reducer and regulator must be provided for operating the Hydril preventer. When required, a second pressure reducer shall be available to limit operating fluid pressures to ram preventers. Gulf Legion No. 38 hydraulic oil, an equivalent or better, is to be used as the fluid to operate the hydraulic equipment.

The choke manifold, the choke flow line, the choke lines and the relief lines are to be supported by metal stands and adequately anchored. The choke flow line, relief lines and choke lines shall be constructed as straight as possible and without sharp bends. Easy access shall be maintained to the choke manifold. All valves are to be selected for operation in the presence of oil, gas, and drilling fluids. The choke flow line valves and valves of the relief lines connected to the drilling spool and all ram BOP preventers must be equipped with stem extensions, universal joints if needed, and hand wheels which are to extend beyond the edge of the casing structure. All other valves shall be equipped with handles.

Blowout preventer assembly shall consist of one blind ram preventer and one pipe ram preventer, both hydraulically operated; a Hydril preventer; valves, check and connections, as illustrated. If a tapered drill string is used, a ram preventer shall be provided for each size of drill pipe. Casing and tubing rams to fit the preventers are to be available as needed. The ram preventers may be two strokes or a double type. If correct in size, the flanged outlets of the ram preventer may be used for connecting to the 4-inch I.D. choke flow line and to the kill line. The substructure height shall be sufficient to install a rotating blowout preventer.

Minimum operating equipment for the preventers and hydraulically operated valves shall be as follows: (1) multiple pumps, driven by a continuous source of power, capable of fluid charging the total accumulator volume from the nitrogen precharge pressure to its rated pressure within 2 minutes. Also, the pumps are to be connected to the hydraulic operating system which is to be a closed system. (2) accumulators with a precharge of nitrogen of not less than 750 PSI and connected so as to receive the aforementioned fluid charge. With the charging pumps shut down, the pressurized fluid volume stored in the accumulator shall be sufficient to close all the pressure-operated devices simultaneously within 1/2 seconds after closure, the remaining accumulator pressure shall be not less than 1000 PSI with the remaining accumulator fluid volume at least 50 percent of the original. When required, either an additional source of power, remote and equivalent, is to be available to operate the above pumps or those shall be additional pumps operated by separate power and equal in performance capabilities.

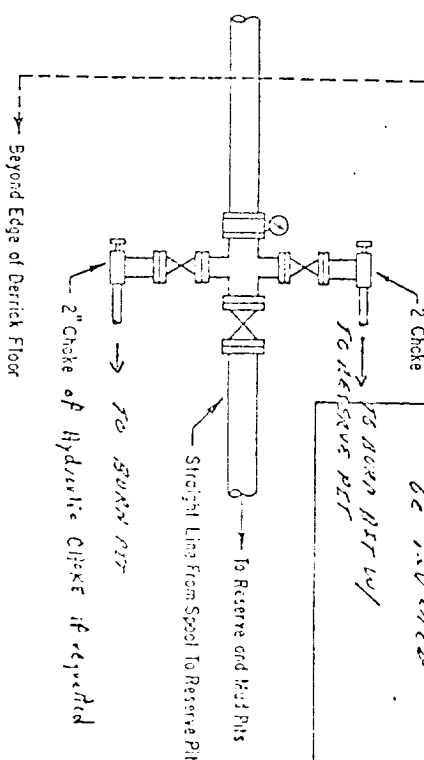

ADDITIONS - DELETIONS - CHANGES
SPECIFY

NOTE: "Under Agreement" means at any time the Gulf Corporation can, may, or will require the equipment to be installed during operations.

Rotating Bowl to be indicated

To DOWN PIT w/ To DOWN PIT

To Reserve and Kill Pits

2" Choke

2" Choke of Hydraulic Choke if required

RECEIVED
OCT 19 1983
O.C.D.
HOBBS C-1123

NEW MEXICO OIL CONSERVATION COMMISSION
WELL LOCATION AND ACREAGE DEDICATION PLAT

Form C-102
Supersedes C-128
Effective 1-1-65

All distances must be from the outer boundaries of the Section

Operator Gulf Oil Corporation			Lease Lea AQ State		Well No. 3
Unit Letter B	Section 32	Township 19 South	Range 35 East	County Lea	
Actual Footage Location of Well: 870 feet from the north line and 2310 feet from the east line					
Ground Level Elev. 3732.7	Producing Formation San Andres		Pool West Pearl San Andres	Dedicated Acreage: 40 Acres	

1. Outline the acreage dedicated to the subject well by colored pencil or hatchure marks on the plat below.
2. If more than one lease is dedicated to the well, outline each and identify the ownership thereof (both as to working interest and royalty).
3. If more than one lease of different ownership is dedicated to the well, have the interests of all owners been consolidated by communitization, unitization, force-pooling, etc?

☐ Yes ☐ No If answer is "yes," type of consolidation _____

If answer is "no," list the owners and tract descriptions which have actually been consolidated. (Use reverse side of this form if necessary.) _____

No allowable will be assigned to the well until all interests have been consolidated (by communitization, unitization, forced-pooling, or otherwise) or until a non-standard unit, eliminating such interests, has been approved by the Commission.

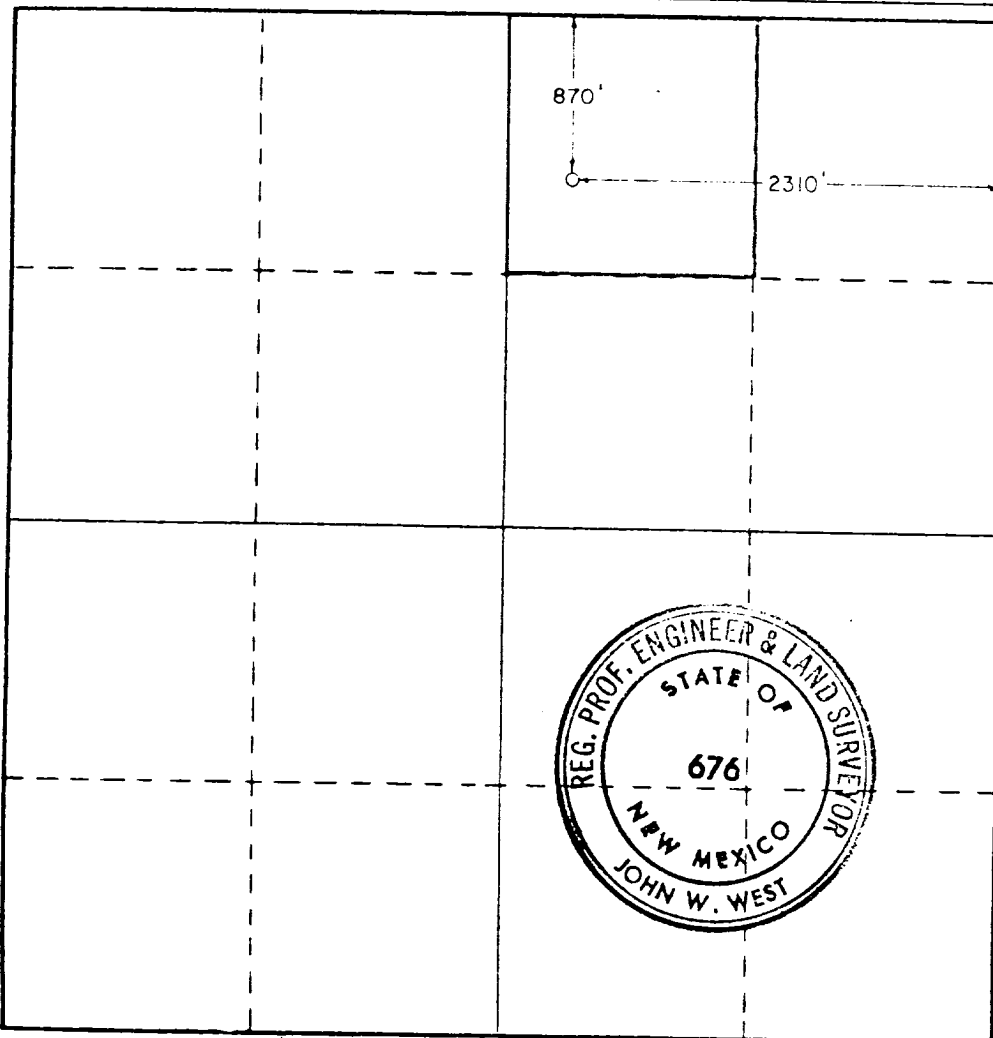

CERTIFICATION

I hereby certify that the information contained herein is true and complete to the best of my knowledge and belief.

R.C. Anderson

Name

R.C. ANDERSON

Position

AREA PRODUCTION MGR

Company

GULF OIL CORP

Date

10-17-83

I hereby certify that the well location shown on this plat was plotted from field notes of actual surveys made by me or under my supervision, and that the same is true and correct to the best of my knowledge and belief.

Date Surveyed

October 14, 1983

Registered Professional Engineer and/or Land Surveyor

John W. West

Certificate No. **JOHN W. WEST,**

676

RONALD J. EIDSON,

3239

0 330 660 990 1320 1650 1980 2310 2640 2970 3300 3630

111

RECEIVED

OCT 19 1983

D.C.D.
HOBBS OFFICE

Don't Bond for
8/15/84
log