

NEW MEXICO OIL CONSERVATION COMMISSION
WELL LOCATION AND ACREAGE DEDICATION PLAT

Form C-102
Supersedes C-178
Effective 1-1-65

All distances must be from the outer boundaries of the Section

Operator READ & STEVENS, INC.			Lease NORTH LEA FEDERAL		Well No. 1Y
Tract Letter 1	Section 10	Township 20S	Range 34E	County LEA	
Actual Footage Location of Well: 1839 feet from the SOUTH line and 680 feet from the EAST line					
Ground Level Elev. 3637.5' GL	Producing Formation Morrow		Pool Lea Penn Gas		Dedicated Acreage: 160 Acres

1. Outline the acreage dedicated to the subject well by colored pencil or hachure marks on the plat below.
2. If more than one lease is dedicated to the well, outline each and identify the ownership thereof (both as to working interest and royalty).
3. If more than one lease of different ownership is dedicated to the well, have the interests of all owners been consolidated by communitization, unitization, force-pooling, etc?

☐ Yes ☐ No If answer is "yes," type of consolidation N/A

If answer is "no," list the owners and tract descriptions which have actually been consolidated. (Use reverse side of this form if necessary.) _____

No allowable will be assigned to the well until all interests have been consolidated (by communitization, unitization, forced-pooling, or otherwise) or until a non-standard unit, eliminating such interests, has been approved by the Commission.

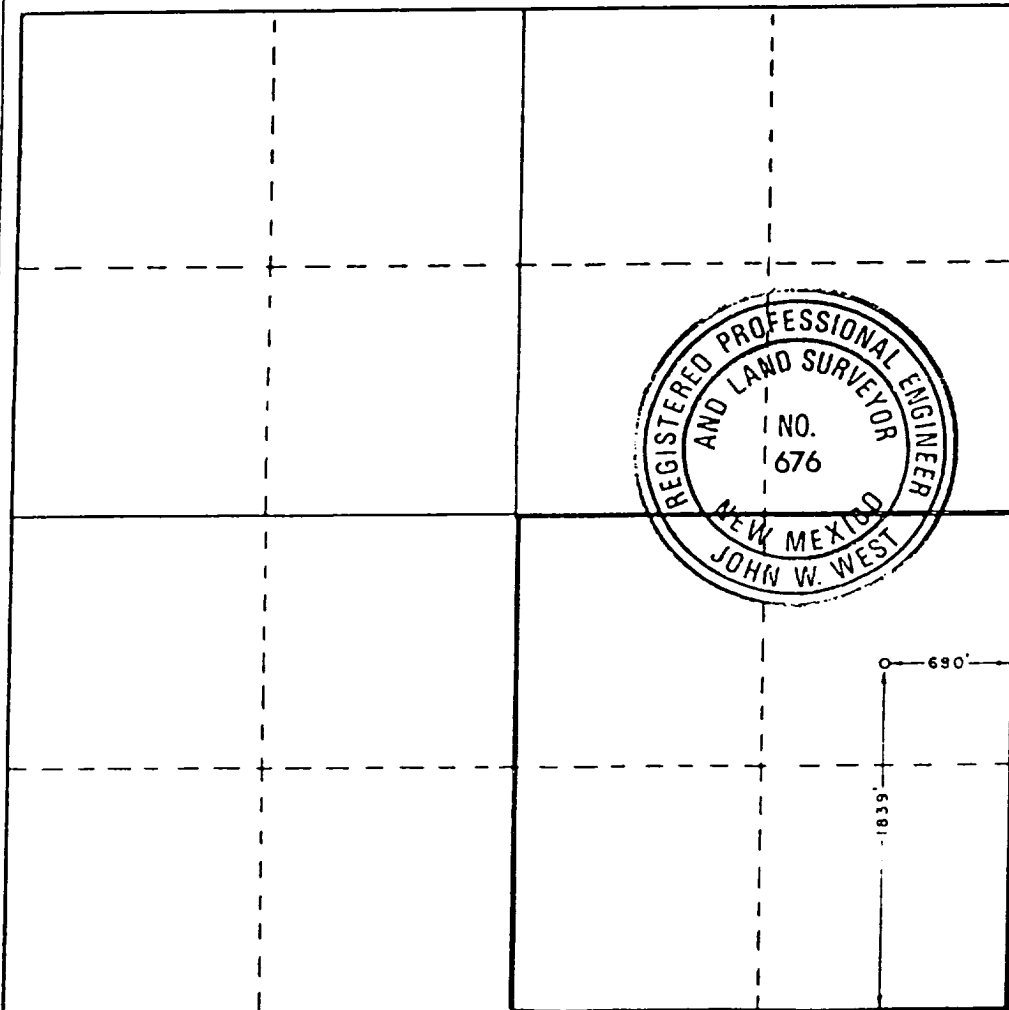

CERTIFICATION

I hereby certify that the information contained herein is true and complete to the best of my knowledge and belief.

Debra L. Butcher

Name

Debra L. Butcher

Position

Authorized Agent

Company

Read & Stevens, Inc.

Date

February 4, 1985

I hereby certify that the well location shown on this plat was plotted from field notes of actual surveys made by me or under my supervision, and that the same is true and correct to the best of my knowledge and belief.

Date Surveyed

2/1/85

Registered Professional Engineer and/or Land Surveyor

John W. West

Certificate No. JOHN W. WEST.

676