

NO. OF COPIES RECEIVED	
DISTRIBUTION	
SANTA FE	
FILE	
U.S.G.S.	
LAND OFFICE	
OPERATOR	

5A. Indicate Type of Lease

STATE ☒ FEE ☐

5. State Oil &amp; Gas Lease No.

A-1646

## APPLICATION FOR PERMIT TO DRILL, DEEPEN, OR PLUG BACK

1a. Type of Work

DRILL ☒DEEPEN ☐PLUG BACK ☐

b. Type of Well

OIL WELL ☒GAS WELL ☐

OTHER

SINGLE ZONE ☒MULTIPLE ZONE ☐

2. Name of Operator

AMOCO PRODUCTION COMPANY

3. Address of Operator

P.O. BOX 68 HOBBS, NEW MEXICO 88240

4. Location of Well

UNIT LETTER G LOCATED 2310 FEET FROM THE North LINEAND 2310 FEET FROM THE East LINE OF SEC. 6 TWP. 19-S RGE. 38-E NMPM

7. Unit Agreement Name

8. Farm or Lease Name

South Hobbs (GSA) Unit

9. Well No.

200

10. Field and Pool, or Wildcat

Hobbs GSA

12. County

Lea

11. Elevations (show whether D<sub>1</sub>, K<sub>1</sub>, etc.)

3632.4' GL

21A. Kind &amp; Status Plug. bond

Blanket on-File

19. Proposed Depth

4200'

19A. Formation

Grayburg-San Andres

20. Rotary or C.T.

Rotary

21B. Drilling Contractor

N/A

22. Approx. Date Work will start

4th Quarter 1985

23.

## PROPOSED CASING AND CEMENT PROGRAM

SIZE OF HOLE	SIZE OF CASING	WEIGHT PER FOOT	SETTING DEPTH	SACKS OF CEMENT	EST. TOP
12 1/4"	8 5/8"	24#	1600'	Circulate to Surface	
7 7/8"	5 1/2"	15.5#	4200'	Circulate to Surface	

Propose to drill and equip well in the Grayburg-San Andres Formation. After reaching TD, logs will be run and evaluated. Perforate and stimulate as necessary in attempting commercial production.

Mud Program: 0-1600' Native spud mud  
1600'-3800' Brine water  
3800'-4200' Salt gel/Starch

Permit Expires 6 Months From Approval  
Date Unless Drilling Underway.

BOP Diagram attached

OTS NMOCD, H 1-JRB 1-FJN 1-CMH 1-Shell 1-ARCO

IN ABOVE SPACE DESCRIBE PROPOSED PROGRAM; IF PROPOSAL IS TO DEEPEN OR PLUG BACK, GIVE DATA ON PRESENT PRODUCTIVE ZONE AND PROPOSED NEW PRODUCTIVE ZONE. GIVE BLOWOUT PREVENTER PROGRAM, IF ANY.

I hereby certify that the information above is true and complete to the best of my knowledge and belief.

Signed

Charles M. Lerring

Title Administrative Analyst (SG)

Date

9-10-85

(This space for State Use)

Eddie W. Seay

SEP 11 1985

APPROVED BY

Oil &amp; Gas Inspector

TITLE

DATE

CONDITIONS OF APPROVAL, IF ANY:

RECEIVED  
SEP 10 1985  
O.C.D.  
HOBBS OFFICE

NEW MEXICO OIL CONSERVATION COMMISSION  
WELL LOCATION AND ACREAGE DEDICATION PLAT

Form C-102  
Supersedes C-128  
Effective 1-1-65

All distances must be from the outer boundaries of the Section

Operator AMOCO PRODUCTION COMPANY		Lease SOUTH HOBBS GRAYBURG SAN ANDRES UNIT		Well No. 200
Unit Letter G	Section 6	Township 19 SOUTH	Range 38 EAST	County LEA
Actual Footage Location of Well: 2310 feet from the NORTH line and 2310 feet from the EAST line				
Ground Level Elev. 3632.4'	Producing Formation Grayburg-San Andres	Pool Hobbs GSA	Dedicated Acreage: 40 Acres	

1. Outline the acreage dedicated to the subject well by colored pencil or hatchure marks on the plat below.
2. If more than one lease is dedicated to the well, outline each and identify the ownership thereof (both as to working interest and royalty).
3. If more than one lease of different ownership is dedicated to the well, have the interests of all owners been consolidated by communitization, unitization, force-pooling, etc?

☐ Yes ☐ No If answer is "yes," type of consolidation \_\_\_\_\_

If answer is "no," list the owners and tract descriptions which have actually been consolidated. (Use reverse side of this form if necessary.) \_\_\_\_\_

No allowable will be assigned to the well until all interests have been consolidated (by communitization, unitization, forced-pooling, or otherwise) or until a non-standard unit, eliminating such interests, has been approved by the Commission.

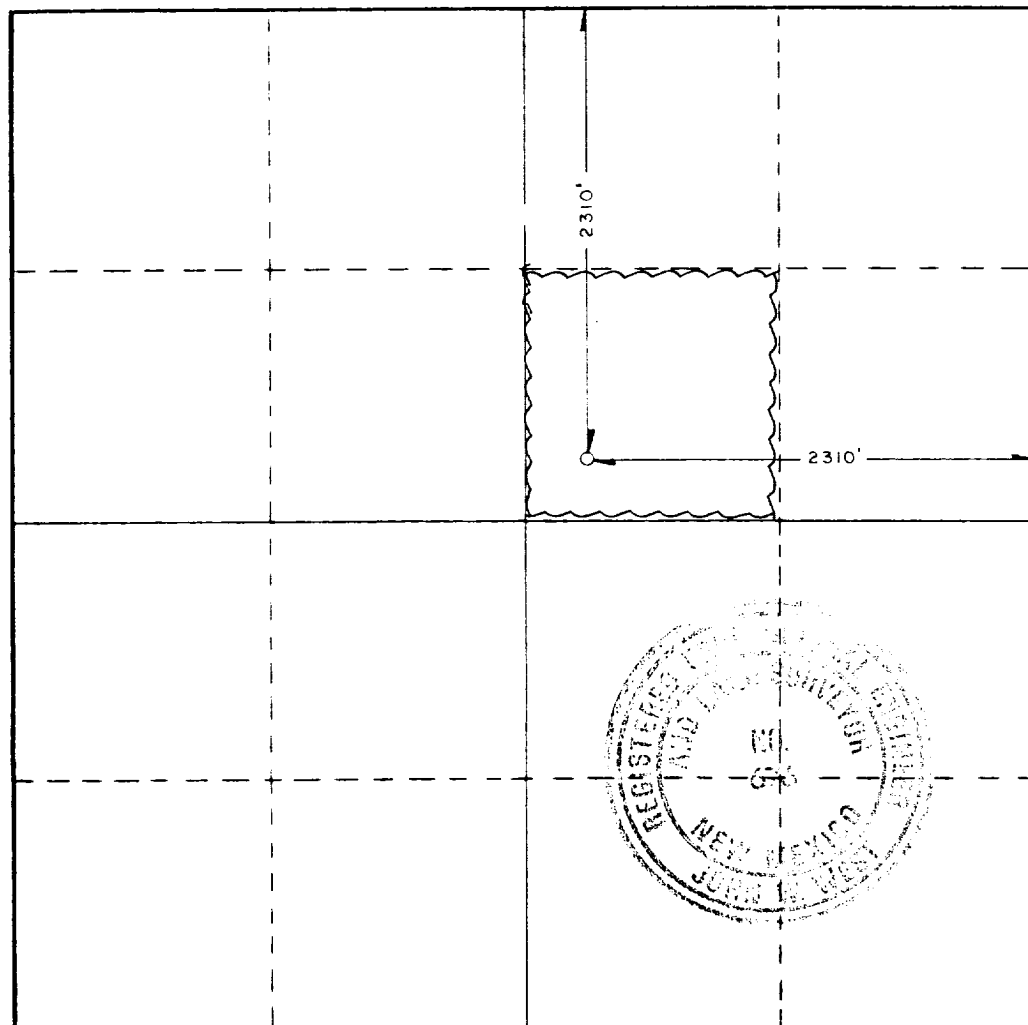

CERTIFICATION

I hereby certify that the information contained herein is true and complete to the best of my knowledge and belief.

Name: *Charles M. Lanning*  
Position: *Admin. Analyst (SG)*  
Company: *Amoco Production Company*  
Date: *9-10-85*

I hereby certify that the well location shown on this plat was plotted from field notes of actual surveys made by me or under my supervision, and that the same is true and correct to the best of my knowledge and belief.

Date Surveyed  
AUGUST 16, 1985

Registered Professional Engineer  
and/or Land Surveyor

*John W. West*  
Certificate No. JOHN W. WEST, 676  
RONALD J. EIDSON, 3239

**RECEIVED**

**SEP 10 1985**

**O.C.D.  
HOBBS OFFICE**

STANDARD 2000 PSI W.P. BOP STACK

1. Blow-out preventers may be manually operated.
2. All equipment must be in good condition, 2,000 psi W.P. (4,000 psi test) minimum.
3. Bell nipple above blow-out preventer shall be same size as casing being drilled through.
4. Kelly cock to be installed on kelly.
5. Full opening safety valve 2,000 psi w.p. (4,000 psi test) minimum must be available on rig floor at all times with proper connection or subs to fit any tool joint in string.
6. Spool or cross may be eliminated if connections are available in the lower part of the blow-out preventer body.
7. Double or space saver type preventers may be used in lieu of two single preventers.
8. BOP rams to be installed as follows:
 

Top preventer	-	Drill pipe or casing rams
Bottom preventer	-	Blind rams

\*Amoco District Superintendent may reverse location of rams.
9. Extensions and hand wheels to be installed and braced at all times.
10. Manifold valves may be gate or plug metal to metal seal 2" minimum.

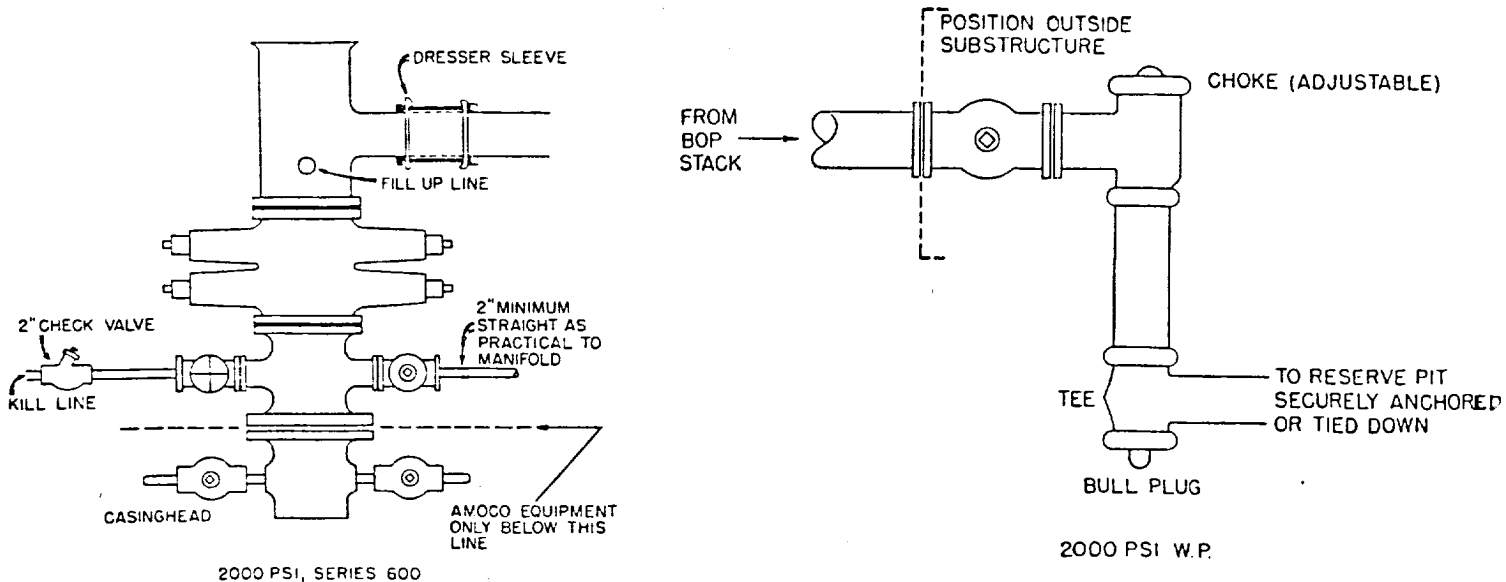

RECEIVED

SEP 10 1985

O.C.D.  
HOBBS OFFICE

173