

STATE OF NEW MEXICO  
ENERGY AND MINERALS DEPARTMENT

JIL CONSERVATION DIVISIO

P. O. BOX 2088  
SANTA FE, NEW MEXICO 87501

Form C-102  
Revised 10-1-79

All distances must be from the outer boundaries of the Section.

Operator Mobil Producing Tx. & New Mex., Inc.			Lease West Pearl State		Well No. 2
Unit Letter H	Section 2	Township 20S	Range 34E	County Lea	
Actual Footage Location of Well: 2300 feet from the North line and 560 feet from the East line					
Ground Level Elev. 3681	Producing Formation Delaware		Pool Wildcat	Dedicated Acreage: 40 Acres	

1. Outline the acreage dedicated to the subject well by colored pencil or hachure marks on the plat below.
2. If more than one lease is dedicated to the well, outline each and identify the ownership thereof (both as to working interest and royalty).
3. If more than one lease of different ownership is dedicated to the well, have the interests of all owners been consolidated by communitization, unitization, force-pooling, etc?

☐ Yes ☐ No If answer is "yes," type of consolidation \_\_\_\_\_

If answer is "no," list the owners and tract descriptions which have actually been consolidated. (Use reverse side of this form if necessary.) \_\_\_\_\_

No allowable will be assigned to the well until all interests have been consolidated (by communitization, unitization, forced-pooling, or otherwise) or until a non-standard unit, eliminating such interests, has been approved by the Division.

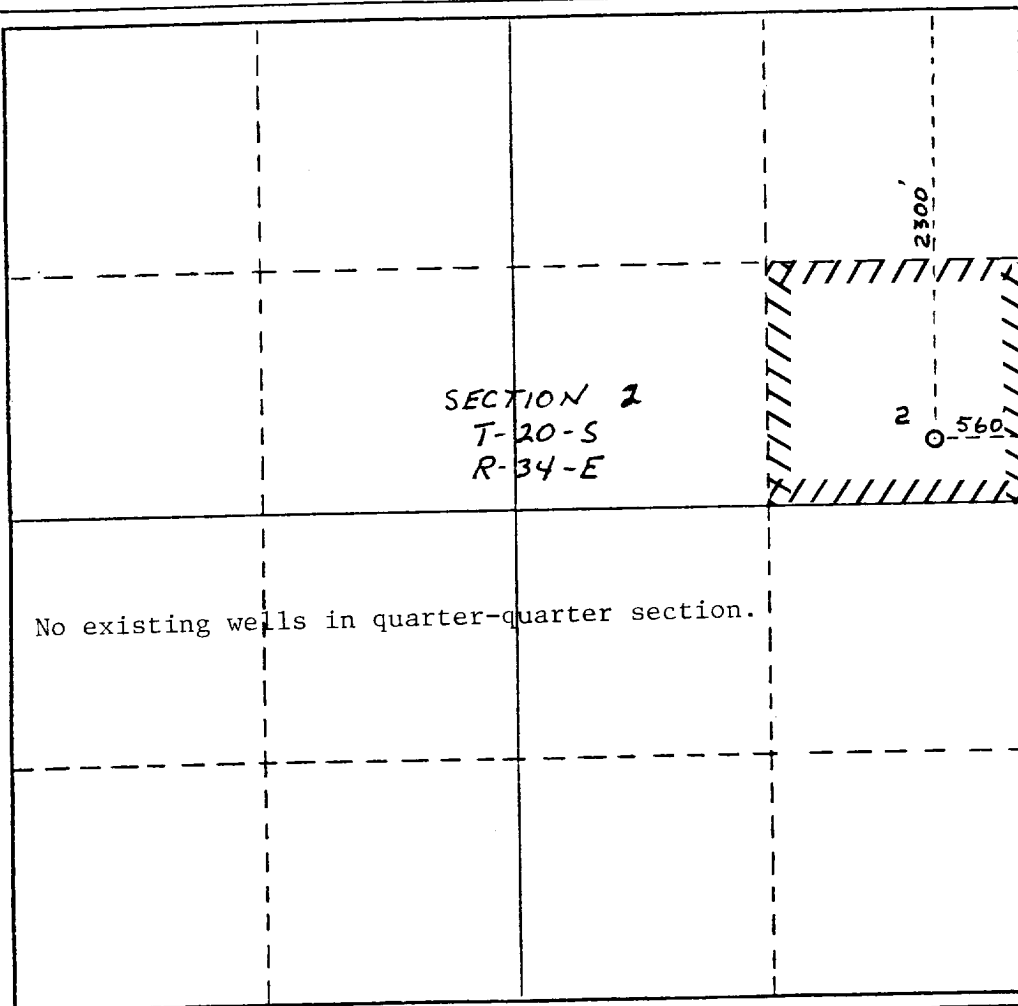

CERTIFICATION

I hereby certify that the information contained herein is true and complete to the best of my knowledge and belief.

Name  
C. C. Smith for G. E. Tate  
Position  
Env. & Reg. Manager  
Company  
Mobil Producing TX & NM, Inc.  
Date  
5-20-86

I hereby certify that the well location shown on this plat was plotted from field notes of actual surveys made by me or under my supervision, and that the same is true and correct to the best of my knowledge and belief.

Date Surveyed  
15 MAY 1986  
Registered Professional Engineer and/or Land Surveyor  
Norman E. Cummes  
Certificate No.  
9669

0 330 660 990 1320 1650 1980 2310 2640 2000 1500 1000 500 0