

STATE OF NEW MEXICO
ENERGY AND MINERALS DEPARTMENT

OIL CONSERVATION DIVISION
P. O. BOX 2088
SANTA FE, NEW MEXICO 87501

30-035-30191

Form C-101
Revised 10-1-78

NO. OF COPIES RECEIVED	
DISTRIBUTION	
SANTA FE	
FILE	
U.S.G.S.	
LAND OFFICE	
OPERATOR	

5A. Indicate Type of Lease	
STATE <input checked="" type="checkbox"/>	FEE <input type="checkbox"/>
5. State Oil & Gas Lease No.	
B-1921	

APPLICATION FOR PERMIT TO DRILL, DEEPEN, OR PLUG BACK

1a. Type of Work		7. Unit Agreement Name	
b. Type of Well DRILL <input checked="" type="checkbox"/> DEEPEN <input type="checkbox"/> PLUG BACK <input type="checkbox"/> OIL WELL <input checked="" type="checkbox"/> GAS WELL <input type="checkbox"/> OTHER <input type="checkbox"/> SINGLE ZONE <input type="checkbox"/> MULTIPLE ZONE <input checked="" type="checkbox"/>		8. Farm or Lease Name	
2. Name of Operator		NJ State	
Sirgo-Collier, Inc.		9. Well No.	
3. Address of Operator		1	
P. O. Box 3531, Midland, Texas 79702		10. Field and Pool, or Wildcat	
4. Location of Well		Wildcat	
UNIT LETTER <u>N</u> LOCATED <u>660</u> FEET FROM THE <u>South</u> LINE			
AND <u>1980</u> FEET FROM THE <u>West</u> LINE OF SEC. <u>16</u> TWP. <u>20S</u> RGE. <u>35E</u> NMPM			
		12. County	
		Lea	
		19. Proposed Depth	
		4200'	
		19A. Formation	
		Yates-Seven Rivers	
		20. Rotary or C.T.	
		Rotary	
21. Elevations (show whether DF, KT, etc.)		21A. Kind & Status Plug. Bond	
3714' GR		Cash Statewide	
		21B. Drilling Contractor	
		CapStar Drilling	
		22. Approx. Date Work will start	
		January 1, 1988	

PROPOSED CASING AND CEMENT PROGRAM

SIZE OF HOLE	SIZE OF CASING	WEIGHT PER FOOT	SETTING DEPTH	SACKS OF CEMENT	EST. TOP
12-1/4"	8-5/8"	24#	400'	250 sx	Surface
7-7/8"	5-1/2"	15.5#	4200'	1200 sx	Surface

The Yates-Seven Rivers zone will be selectively perforated and stimulated as needed for optimum production.

ABOVE SPACE DESCRIBE PROPOSED PROGRAM: IF PROPOSAL IS TO DEEPEN OR PLUG BACK, GIVE DATA ON PRESENT PRODUCTIVE ZONE AND PROPOSED NEW PRODUCTIVE ZONE. GIVE BLOWOUT PREVENTER PROGRAM, IF ANY.

hereby certify that the information above is true and complete to the best of my knowledge and belief.

Signed Amy Whitley Title Agent Date December 23, 1987

(This space for State Use)

ORIGINAL SIGNED BY JERRY SEXTON

DISTRICT I SUPERVISOR

APPROVED BY _____ TITLE _____ DATE DEC 23 1987

CONDITIONS OF APPROVAL, IF ANY:

Permit Expires 6 Months From Approval
Date Unless Drilling Underway.

NE EXICO OIL CONSERVATION COMMISSION
WELL LOCATION AND ACREAGE DEDICATION PLAT

Form O-107
Supersedes O-128
Effective 1-1-87

All distances must be from the outer boundaries of the Section

Operator SIRGO-COLLIER, INC.			Lease NJ State		Well No. 1
Unit Letter N	Section 16	Township 20 South	Range 35 East	County Lea County, N.M.	
Actual Footage Location of Well: 660 feet from the South line and 1980 feet from the West line					
Ground Level Elev. 3714.	Producing Formation Yates-Seven Rivers		Pool Wildcat	Dedicated Acreage 40	

1. Outline the acreage dedicated to the subject well by colored pencil or hatchure marks on the plat below.
2. If more than one lease is dedicated to the well, outline each and identify the ownership thereof (both as to working interest and royalty).
3. If more than one lease of different ownership is dedicated to the well, have the interests of all owners been consolidated by communitization, unitization, force-pooling, etc?

☐ Yes ☒ No If answer is "yes," type of consolidation _____

If answer is "no," list the owners and tract descriptions which have actually been consolidated. (Use reverse side of this form if necessary.) _____

No allowable will be assigned to the well until all interests have been consolidated (by communitization, unitization, forced-pooling, or otherwise) or until a non-standard unit, eliminating such interests, has been approved by the Commission.

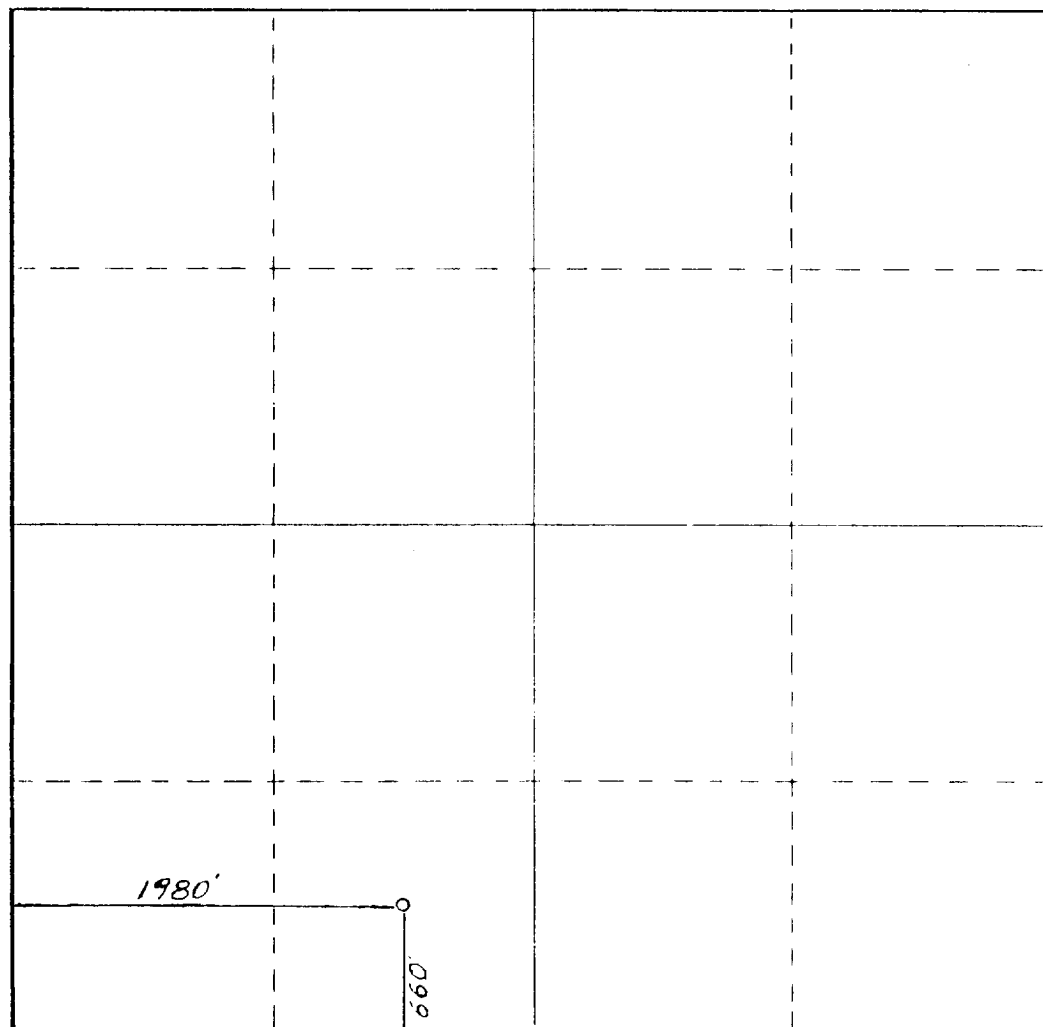

CERTIFICATION

I hereby certify that the information contained herein is true and complete to the best of my knowledge and belief.

Amy L. Whitley
Name

Amy L. Whitley

Position
Agent

Company
Sirgo-Collier, Inc.

Date
December 30, 1987

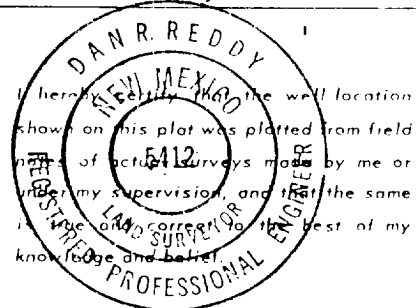

Date Surveyed
December 28, 1987

Registered Professional Engineer
and/or Land Surveyor

Dan R. Reddy
Certificate No.

NM PE&LS NO. 5412

BOP

