



United States Department of the Interior



BUREAU OF LAND MANAGEMENT
ROSWELL DISTRICT OFFICE
P.O. BOX 1397
ROSWELL, NEW MEXICO 88201

LC-064194
3162.41 (065)

JUN 22 1989

Bill Fenn, Inc.
P. O. Drawer 569
Giddings, TX 78942

Gentlemen:

Your application for Permit to Drill the Powell Federal No. 2 well in the NW $\frac{1}{4}$ SE $\frac{1}{4}$ sec. 4, T. 20 S., R. 34 E., Lea County, New Mexico, lease LC-064194, to a depth of 6200 feet to test the Delaware formation in the oil-potash area, is hereby approved as amended by stipulations attached to the application.

One copy of the application is returned herewith. Please notify the Bureau of Land Management office checked on the attached special stipulation, in sufficient time for a representative to witness all cementing operations.

Approval of this application does not warrant or certify that the applicant holds legal or equitable title to those rights in the subject lease which would entitle the applicant to conduct operations thereon.

Sincerely,

Orig. Sgd. David E. Marl

Francis R. Cherry, Jr.
District Manager

FOR

1 Enclosure

cc:
✓ NMOCD - 2 - Hobbs

100

100

JUN 2 1967
WORLD BOOK

UNITED STATES
DEPARTMENT OF THE INTERIOR
BUREAU OF LAND MANAGEMENT

30-025-30633
Form approved.
Budget Bureau No. 1004-0136
Expires August 31, 1985

APPLICATION FOR PERMIT TO DRILL, DEEPEN, OR PLUG BACK

1a. TYPE OF WORK
DRILL ☒ DEEPEN ☐ PLUG BACK ☐
b. TYPE OF WELL
OIL WELL ☒ GAS WELL ☐ OTHER ☐ SINGLE ZONE ☐ MULTIPLE ZONE ☐
2. NAME OF OPERATOR
Bill Fenn, Inc.
3. ADDRESS OF OPERATOR
P. O. Dr. 569 Giddings, TX 78942
4. LOCATION OF WELL (Report location clearly and in accordance with any State requirements.*)
At surface
1650' FSL & 1650' FEL
At proposed prod. zone
same
14. DISTANCE IN MILES AND DIRECTION FROM NEAREST TOWN OR POST OFFICE*
28 miles southwest of Hobbs, NM
10. DISTANCE FROM PROPOSED* LOCATION TO NEAREST PROPERTY OR LEASE LINE, FT. (Also to nearest drlg. unit line, if any) 990'
16. NO. OF ACRES IN LEASE 2,000
17. NO. OF ACRES ASSIGNED TO THIS WELL 40
18. DISTANCE FROM PROPOSED LOCATION* TO NEAREST WELL, DRILLING, COMPLETED, OR APPLIED FOR, ON THIS LEASE, FT. 1400'
19. PROPOSED DEPTH 6,200'
20. ROTARY OR CABLE TOOLS Rotary
21. ELEVATIONS (Show whether DF, RT, GR, etc.) 3631.8 GL
22. APPROX. DATE WORK WILL START* June 10, 1989

5. LEASE DESIGNATION AND SERIAL NO.
LC-064194
6. IF INDIAN, ALLOTTEE OR TRIBE NAME
7. UNIT AGREEMENT NAME
8. FARM OR LEASE NAME
Powell Federal
9. WELL NO.
2
10. FIELD AND POOL, OR WILDCAT
Wildcat Quail Ridge-Delaware
11. SEC., T., R., M., OR BLK. AND SURVEY OR AREA
Sec. 4-T20S-R34E
12. COUNTY OR PARISH
Lea
13. STATE
New Mexico

PROPOSED CASING AND CEMENTING PROGRAM

SIZE OF HOLE	SIZE OF CASING	WEIGHT PER FOOT	SETTING DEPTH	QUANTITY OF CEMENT
14" 12 1/4"	10 3/4"	45.5#	1,600'	650 sx Class "C" circ. to surface
8 3/4"	none		5,000'	DV tool from T.D. to 3200'
7 7/8"	5 1/2"	17 & 23#	6,200'	Stage 1: 730 sc Prem. + Stage 2: 850 sx Prem. +

If loss of circulation occurs prior to the 5,000' depth, will use the following program:
8 3/4" 7" 26# CIRCULATE 5,000' D.V. Tool from 3200'

		Weight	Visc.	W/L
Mud Program:				
0' - 1600'	Fresh water spud mud, gel, lime, native	9.6 - 9.8	33 - 35	N/C
1600' - 5400'	Saturated (10#) brine water.	10.0 - 10.2	27 - 29	N/C
5400' - 6200'	Brine water with starch.	10.0 - 10.2	32 - 34	5 - 7 cc

BOP Program:

A 3000 psi wp 900 Series Shaffer double hydraulic operated BOP will be used and tested daily. See Exhibit "E".

IN ABOVE SPACE DESCRIBE PROPOSED PROGRAM: If proposal is to deepen or plug back, give data on present productive zone and proposed new productive zone. If proposal is to drill or deepen directionally, give pertinent data on subsurface locations and measured and true vertical depths. Give blowout preventer program, if any.

24. SIGNED Charles J. Smith Agent for: Bill Fenn, Inc. DATE May 18, 1989
(This space for Federal or State office use)

PERMIT NO. APPROVAL DATE

APPROVED BY TITLE DATE

CONDITIONS OF APPROVAL, IF ANY:

GENERAL REQUIREMENTS AND
SPECIAL STIPULATIONS

ATTACHED

*See Instructions On Reverse Side

APPLICATION FOR DRILLING

BILL FENN, INC.
Powell Federal, Well No. 2
1650' FSL & 1650' FEL, SEC. 4-T20S-R34E
Lea County, New Mexico
Lease No.: LC-064194
(Development Well)

In conjunction with Form 3160-3, Application for Permit to Drill subject well, Manzano Oil Corporation submits the following items of pertinent information in accordance with BLM requirements:

1. The geologic surface formation is recent Permian with quaternary alluvium and other surficial deposits.

2. The estimated tops of geologic markers are as follows:

Rustler	1538'	Seven Rivers	3832'
Top of salt	1734'	Delaware	5550'
Tansill	3200'	T.D.	6200'
Yates	3414'		

3. The estimated depths at which water, oil or gas formations are anticipated to be encountered:

Water: In the triassic between 80' to 230'.

Oil: Delaware between 5550' and 5800'.

Gas: None expected, except with Delaware production.

4. Proposed Casing Program: See Form 3160-3.

5. Proposed Control Equipment: See Form 3160-3 and Exhibit "E".

6. Mud Program: See Form 3160-3.

7. Auxiliary Equipment: Blowout Preventer, gas detector, Kelly cock, pit level monitor, flow sensors and stabbing valve.

8. Testing, Logging, and Coring Program:

Drill Stem Tests: None planned.

Logging: T.D. to Casing.: CNL/LDT/DLL/MSFL/GR

Coring: None planned.

9. No abnormal pressures or temperatures are anticipated. In the event abnormal pressures are encountered the proposed mud program will be modified to increase the mud weight.

10. Anticipated starting date: June 10, 1989.

Anticipated completion of drilling operations: Approximately 25 days.

Submit to Appropriate
District Office
State Lease - 4 copies
Fee Lease - 3 copies

State of New Mexico
Energy, Minerals and Natural Resources Department

Form C-102
Revised 1-1-89

OIL CONSERVATION DIVISION

P.O. Box 2088

Santa Fe, New Mexico 87504-2088

DISTRICT I

P.O. Box 1980, Hobbs, NM 88240

DISTRICT II

P.O. Drawer DD, Artesia, NM 88210

DISTRICT III

1000 Rio Brazos Rd., Aztec, NM 87410

WELL LOCATION AND ACREAGE DEDICATION PLAT

All Distances must be from the outer boundaries of the section

Operator Bill Fenn, Inc.			Lease Powell Federal		Well No. 2
Unit Letter J	Section 4	Township 20 South	Range 34 East	County NMPM	Lea
Actual Footage Location of Well: 1650 feet from the south line and 1650 feet from the east line					
Ground level Elev. 3631.8'		Producing Formation Delaware	Pool Wildcat	Dedicated Acreage: 40 Acres	

- Outline the acreage dedicated to the subject well by colored pencil or hatchure marks on the plat below.
- If more than one lease is dedicated to the well, outline each and identify the ownership thereof (both as to working interest and royalty).
- If more than one lease of different ownership is dedicated to the well, have the interest of all owners been consolidated by communitization, unitization, force pooling, etc.?
☐ Yes ☐ No If answer is "yes" type of consolidation _____
If answer is "no" list the owners and tract descriptions which have actually been consolidated. (Use reverse side of this form if necessary.)
No allowable will be assigned to the well until all interests have been consolidated (by communitization, unitization, forced pooling, or otherwise) or until a non-standard unit, eliminating such interest, has been approved by the Division.

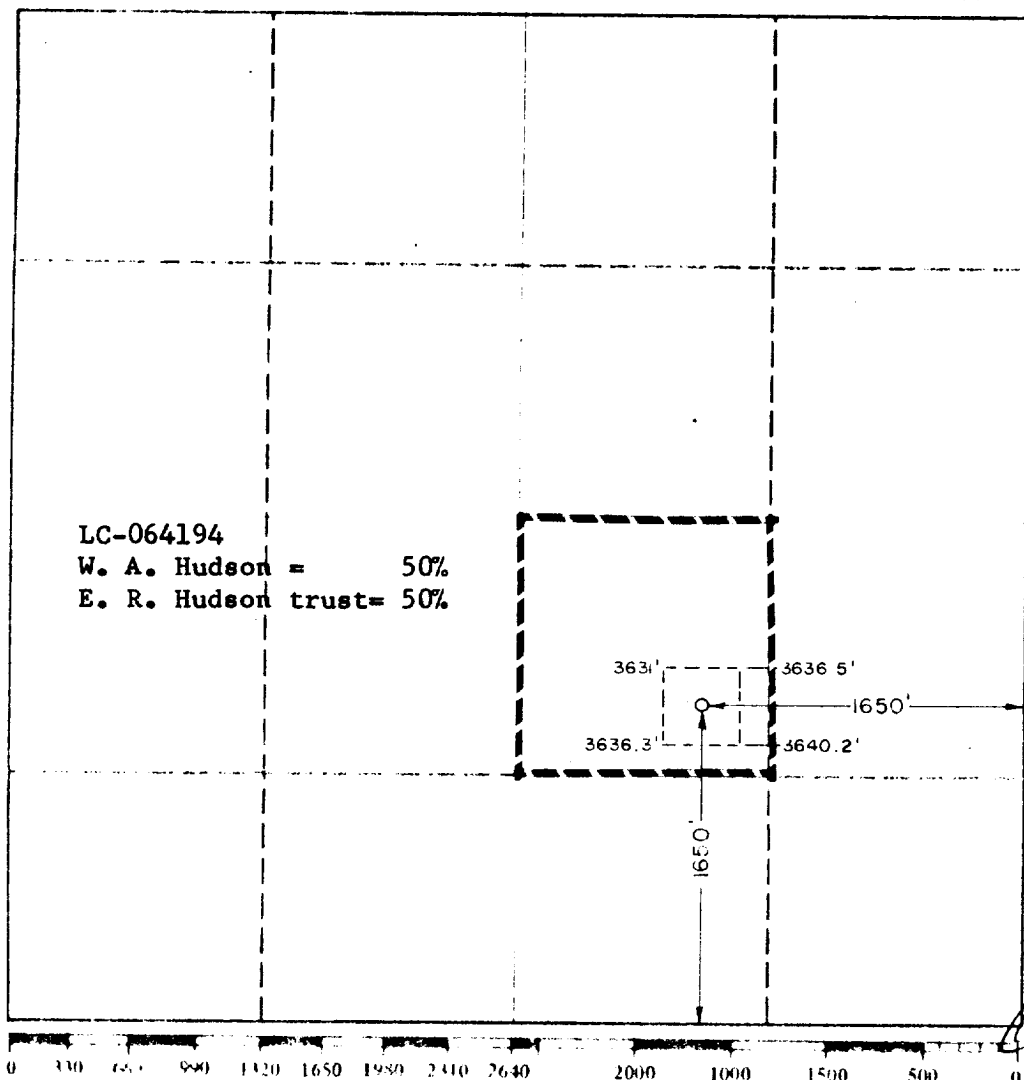

OPERATOR CERTIFICATION

I hereby certify that the information contained herein is true and complete to the best of my knowledge and belief

Signature

Printed Name

George R. Smith

Position

Agent for:

Company

Bill Fenn, Inc.

Date

May 18, 1989

SURVEYOR CERTIFICATION

I hereby certify that the well location shown on this plat was plotted from field notes of actual surveys made by me or under my supervision and that the same is true and correct to the best of my knowledge and belief

Date Surveyed

May 12, 1989

Signature & Seal of
Professional Surveyor



Recd 9-11-89
173

W. S. O'NEILL