

OIL CONSERVATION DIVISION

P.O. Box 2088
Santa Fe, New Mexico 87504-2088

DISTRICT I
P.O. Box 1980, Hobbs, NM 88240

DISTRICT II
P.O. Drawer DD, Artesia, NM 88210

DISTRICT III
1000 Rio Brazos Rd., Aztec, NM 87410

WELL LOCATION AND ACREAGE DEDICATION PLAT

All Distances must be from the outer boundaries of the section

Operator L.B.O. of New Mexico, Inc.		Lease Lia		Well No. 1
Unit Letter L	Section 26	Township 19 South	Range 38 East	County Lea

Actual Footage Location of Well:

1980 feet from the South line and	990 feet from the West line
Ground level Elev. 3600.5	Producing Formation DRINKARD IABO
Pool ADZINKARD IABO	Dedicated Acreage: 40 Acres

- Outline the acreage dedicated to the subject well by colored pencil or hatchure marks on the plat below.
- If more than one lease is dedicated to the well, outline each and identify the ownership thereof (both as to working interest and royalty).
- If more than one lease of different ownership is dedicated to the well, have the interest of all owners been consolidated by communitization, unitization, force-pooling, etc.?
☐ Yes ☐ No If answer is "yes" type of consolidation _____
If answer is "no" list the owners and tract descriptions which have actually been consolidated. (Use reverse side of this form if necessary.) _____
No allowable will be assigned to the well until all interests have been consolidated (by communitization, unitization, forced-pooling, or otherwise) or until a non-standard unit, eliminating such interest, has been approved by the Division.

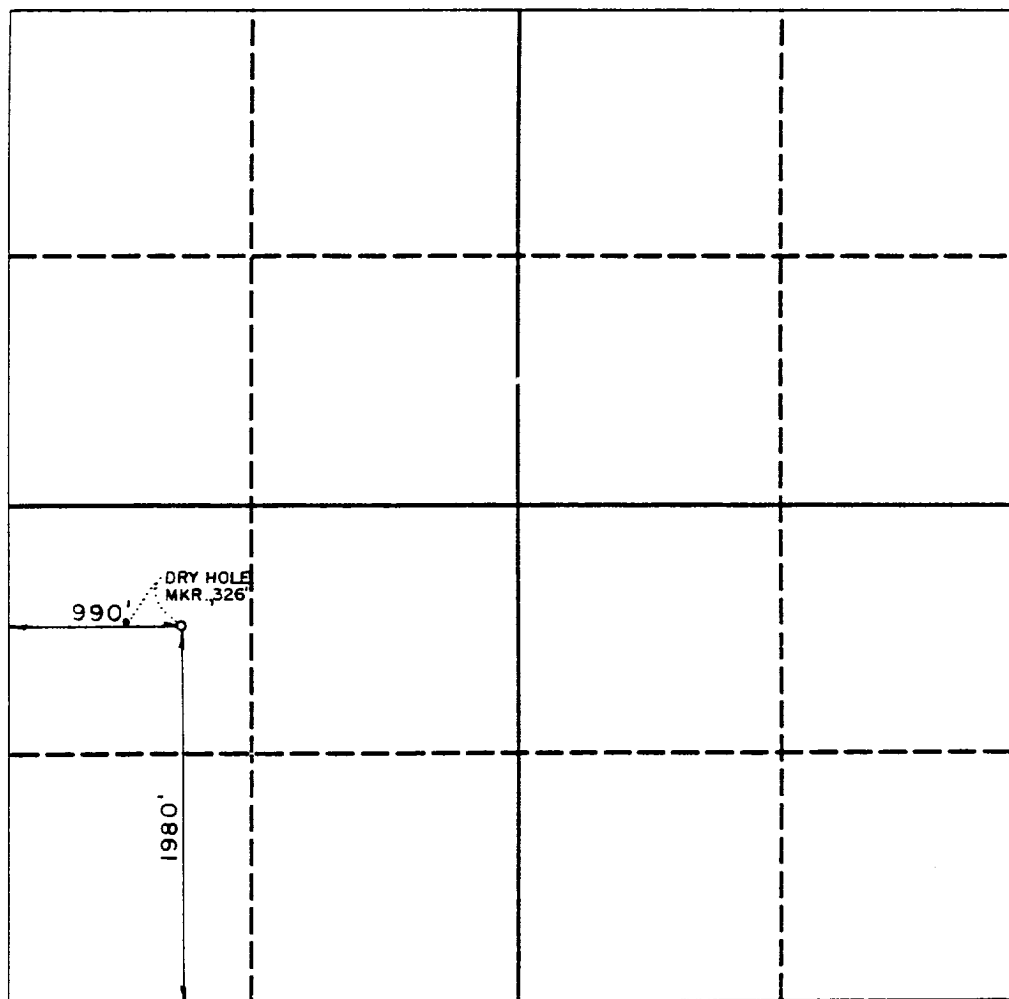

OPERATOR CERTIFICATION

I hereby certify that the information contained herein is true and complete to the best of my knowledge and belief.

Signature
Donald A. Turner
Printed Name
DONALD A. TURNER
Position
GEOLOGIST
Company
LBO NEW MEXICO, INC.
Date
10/25/89

SURVEYOR CERTIFICATION

I hereby certify that the well location shown on this plat was plotted from field notes of actual surveys made by me or under my supervision, and that the same is true and correct to the best of my knowledge and belief.

Date Surveyed
October 23, 1989
Signature & Seal of Professional Surveyor
RONALD D. EIDSON
Certificate No. 676
NEW MEXICO
JOHN W. WEST
676
3239

68-67-11 7074

173

RECEIVED

OCT 24 1989

OCD
HOBBS OFFICE