

NO. OF COPIES RECEIVED	
DISTRIBUTION	
SANTA FE	
FILE	
U.S.G.S.	
LAND OFFICE	
OPERATOR	

5A. Indicate Type of Lease
STATE ☐ FEE ☒

5. State Oil & Gas Lease No.

APPLICATION FOR PERMIT TO DRILL, DEEPEN, OR PLUG BACK

1a. Type of Work b. Type of Well OIL WELL <input checked="" type="checkbox"/> GAS WELL <input type="checkbox"/> OTHER <input type="checkbox"/> SINGLE ZONE <input checked="" type="checkbox"/> MULTIPLE ZONE <input type="checkbox"/>		2. Name of Operator Petroleum Technical Services Company		7. Unit Agreement Name -----	
3. Address of Operator 3000 North Garfield Street, Suite 210, Midland, Texas 79705		8. Farm or Lease Name Carter		9. Well No. 1	
4. Location of Well UNIT LETTER <u>T 1</u> LOCATED <u>660</u> FEET FROM THE <u>East</u> LINE AND <u>1,980</u> FEET FROM THE <u>South</u> LINE OF SEC. <u>30</u> TWP. <u>19-S</u> RGE. <u>39-E</u> NMPM		10. Field and Pool, or Wildcat Wildcat		12. County Lea	
19. Proposed Depth 7,800'		19A. Formation Abo		20. Rotary or C.T. Rotary	
21. Elevations (Show whether D.F., K.I., etc.) 3,592.2' ground level		21A. Kind & Status Plug. Bond Single Well		21B. Drilling Contractor Rod Ric Corporation	
				22. Approx. Date Work will start April 7, 1990	

23. PROPOSED CASING AND CEMENT PROGRAM

SIZE OF HOLE	SIZE OF CASING	WEIGHT PER FOOT	SETTING DEPTH	SACKS OF CEMENT	EST. TOP
12-1/4"	8-5/8" O.D.	24#/ft.	1,720'	850	Circ.
7-7/8"	4-1/2" O.D.	10.5 & 11.6	7,800'	600	5,500'

- 1) Drill 12-1/4" hole to 1,720'. Run & set 8-5/8" casing @1,720' & cement w/550 sxs. HLW + 1/4# flocele/sx., followed by 300 sxs. Class "C" + 1/4# flocele/sx. & 2% Calcium Chloride. WOC - 18 hours.
- 2) Nipple up Blowout preventers, pipe rams, Blank rams & Hydril type annular. Test casing, head, & preventers to 1,000 psi.
- 3) Drill out cement & plug & drill 7-7/8" hole to 7,800' w/brine water & salt water mud. Run open hole logs @T.D.
- 4) Run 4-1/2" O.D. casing, set @7,800' & cement w/600 sxs. of Class "H" cement, 50-50 poz-mix "A" + 2% gel & 0.3% CFR-2 + 5#salt/sx.

IN ABOVE SPACE DESCRIBE PROPOSED PROGRAM; IF PROPOSAL IS TO DEEPEN OR PLUG BACK, GIVE DATA ON PRESENT PRODUCTIVE ZONE AND PROPOSED NEW PRODUCTIVE ZONE. GIVE BLOWOUT PREVENTER PROGRAM, IF ANY.

I hereby certify that the information above is true and complete to the best of my knowledge and belief.
Signed Don Chambers Title Owner/Operator Date 03-27-90

(This space for State Use)

ORIGINAL SIGNED BY JERRY SEXTON

APR 5 1990

APPROVED BY DISTRICT 1 SUPERVISOR TITLE DATE

CONDITIONS OF APPROVAL, IF ANY:

Permit Expires 6 Months From Approval
Date Unless Drilling Underway

OIL CONSERVATION DIVISION

STATE OF NEW MEXICO
ENERGY AND MINERALS DEPARTMENTP. O. BOX 2088
SANTA FE, NEW MEXICO 87501Form C-102
Revised 10-1-78

All distances must be from the outer boundaries of the Section.

VED
1990

Ans.

Operator PETROLEUM TECHNICAL SERVICES COMPANY			Lease Carter		Well No. 1
Unit Letter E I	Section 30	Township 19-S	Range 39-E	County Lea	
Actual Footage Location of Well:					
1980		feet from the South	Line and 660	feet from the East	Line
Ground Level Elev. 3592.2	Producing Formation Abo, Drinkard		Pool Wildcat		Dedicated Acreage: 40 Acres

1. Outline the acreage dedicated to the subject well by colored pencil or hachure marks on the plat below.
2. If more than one lease is dedicated to the well, outline each and identify the ownership thereof (both as to working interest and royalty).
3. If more than one lease of different ownership is dedicated to the well, have the interests of all owners been consolidated by communitization, unitization, force-pooling, etc?

☐ Yes ☐ No If answer is "yes," type of consolidation _____

If answer is "no," list the owners and tract descriptions which have actually been consolidated. (Use reverse side of this form if necessary.) _____

No allowable will be assigned to the well until all interests have been consolidated (by communitization, unitization, forced-pooling, or otherwise) or until a non-standard unit, eliminating such interests, has been approved by the Division

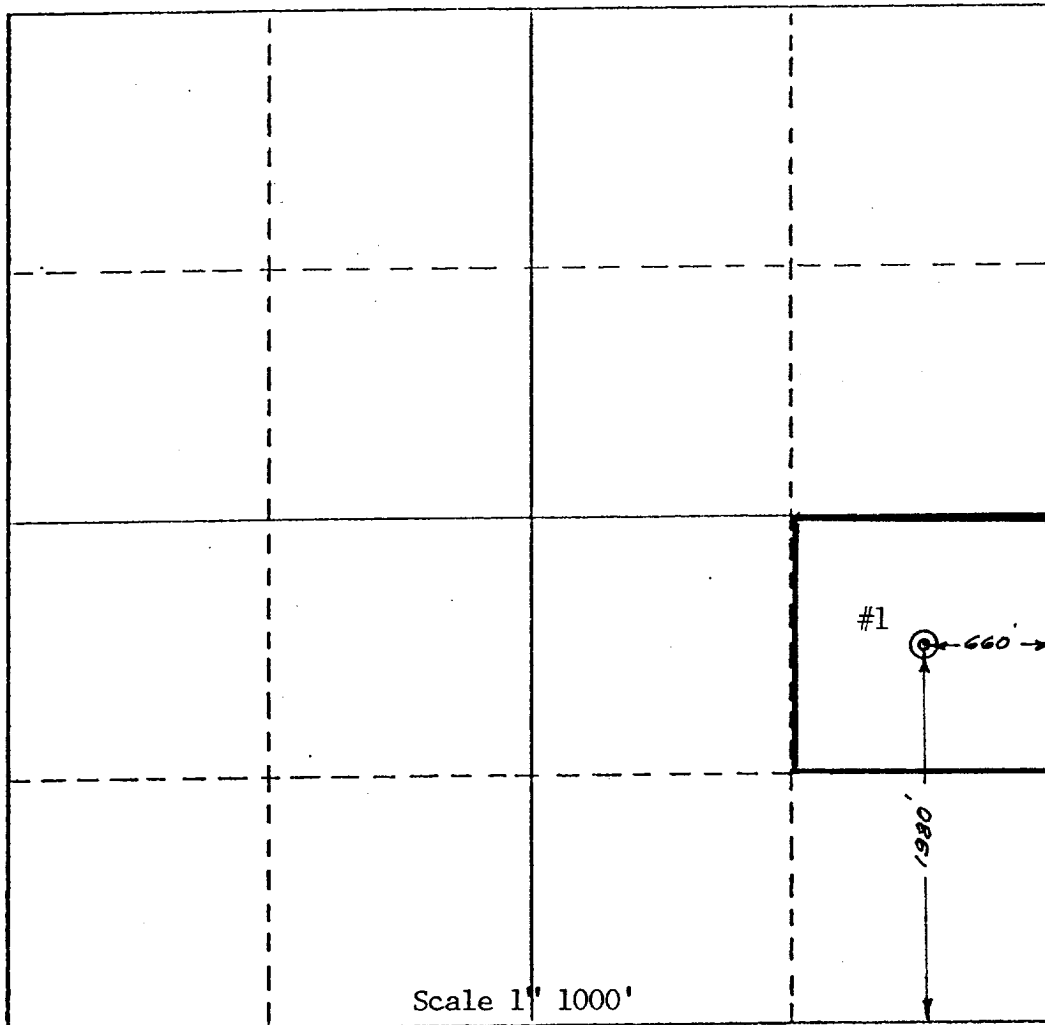

CERTIFICATION

I hereby certify that the information contained herein is true and complete to the best of my knowledge and belief.

Don C. Bennett

Name
Don C. Bennett

Position
Owner/Operator

Company
Petroleum Technical Services

Date
03-27-90 Co.

I hereby certify that the well location shown on this plat was plotted from field notes of actual surveys made by me or under my supervision, and that the same is true and correct to the best of my knowledge and belief.

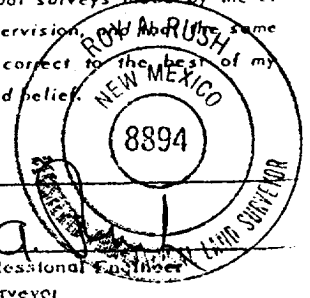

Date Surveyed

Registered Professional Engineer
and/or Land Surveyor

8894

Certificate No.

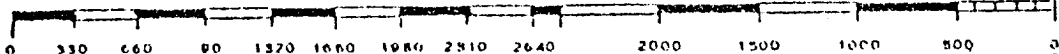

Rec'd 6-21-90
ELF

RECEIVED
APR 2 1990
OCD
HOBBS OFFICE