

Submit to Appropriate  
District Office  
State Lease - 6 copies  
Fee Lease - 5 copies

State of New Mexico  
Energy, Minerals and Natural Resources Department

Form C-101  
Revised 1-1-89

OIL CONSERVATION DIVISION

P.O. Box 2088  
Santa Fe, New Mexico 87504-2088

DISTRICT I  
P.O. Box 1980, Hobbs, NM 88240

DISTRICT II  
P.O. Drawer DD, Artesia, NM 88210

DISTRICT III  
1000 Rio Brazos Rd., Aztec, NM 87410

API NO. (assigned by OCD on New Wells)

30-025-30911

5. Indicate Type of Lease

STATE ☒ FEE ☐

6. State Oil & Gas Lease No.

V-2199

APPLICATION FOR PERMIT TO DRILL, DEEPEN, OR PLUG BACK

1a. Type of Work:

DRILL ☒ RE-ENTER ☐ DEEPEN ☐ PLUG BACK ☐

b. Type of Well:

OIL WELL ☒ GAS WELL ☒ OTHER ☐ SINGLE ZONE ☐ MULTIPLE ZONE ☒

2. Name of Operator

BTA Oil Producers

3. Address of Operator

104 South Pecos, Midland, TX 79701

7. Lease Name or Unit Agreement Name

Gem, 8705 JV-P

8. Well No.

3

9. Pool name or Wildcat

Gem, East (Morrow) & Teas (Bone Spring)

4. Well Location

Unit Letter 0 : 660 Feet From The South Line and 1980 Feet From The East Line

Section 2 Township 20S Range 33E NMPM Lea County

10. Proposed Depth

13,700

11. Formation

Morrow & Bone Spring Rotary

12. Rotary or C.T.

13. Elevations (Show whether DF, RT, GR, etc.)

3579' GR

14. Kind & Status Plug. Bond

Blanket

15. Drilling Contractor

Hondo Drilling Co.

16. Approx. Date Work will start

8/27/90

17. PROPOSED CASING AND CEMENT PROGRAM

SIZE OF HOLE	SIZE OF CASING	WEIGHT PER FOOT	SETTING DEPTH	SACKS OF CEMENT	EST. TOP
26"	20"	94	1350	2200	Surface
17-1/2"	13-3/8"	61 & 68	3100	2100	Surface
12-1/4"	9-5/8"	36	5500	2000	3000
8-3/4"	7"	26	12600	2500	5000
6-1/8"	5" Liner	18	12200-13700	300	12200

BOP sketch attached

Potash area maps attached

Lessee of state potash lease in Sec. 2 - Mississippi Chemical Corp.

Wells #1 & #2 producers from Teas-Bone Spring Pool

IN ABOVE SPACE DESCRIBE PROPOSED PROGRAM: IF PROPOSAL IS TO DEEPEN OR PLUG BACK, GIVE DATA ON PRESENT PRODUCTIVE ZONE AND PROPOSED NEW PRODUCTIVE ZONE. GIVE BLOWOUT PREVENTER PROGRAM, IF ANY.

I hereby certify that the information above is true and complete to the best of my knowledge and belief.

SIGNATURE Dorothy Houghton TITLE Regulatory Administrator DATE 8-16-90

TYPE OR PRINT NAME Dorothy Houghton TELEPHONE NO. 915-682-3753

(This space for State Use)

Orig. Signer  
Paul Kautz  
Geologist

APPROVED BY \_\_\_\_\_ TITLE \_\_\_\_\_ DATE \_\_\_\_\_

CONDITIONS OF APPROVAL, IF ANY:

Permit Expires 6 Months From Approval  
Date Unless Drilling Underway.

SEP 04 1990

Submit to Appropriate  
District Office  
State Lease - 4 copies  
Fee Lease - 3 copies

State of New Mexico  
Energy, Minerals and Natural Resources Department

Form C-102  
Revised 1-1-89

OIL CONSERVATION DIVISION

DISTRICT I  
P.O. Box 1980, Hobbs, NM 88240

P.O. Box 2088  
Santa Fe, New Mexico 87504-2088

DISTRICT II  
P.O. Drawer DD, Artesia, NM 88210

DISTRICT III  
1000 Rio Brazos Rd., Aztec, NM 87410

WELL LOCATION AND ACREAGE DEDICATION PLAT

All Distances must be from the outer boundaries of the section

Operator <b>BTA OIL PRODUCERS</b>			Lease <b>8705 JV-P GEM</b>		Well No. <b>3</b>
Unit Letter <b>"O"</b>	Section <b>2</b>	Township <b>-20-S</b>	Range <b>-33-E</b>	County <b>LEA</b>	
Actual Footage Location of Well: <b>660</b> feet from the <b>SOUTH</b> line and <b>1980</b> feet from the <b>EAST</b> line					
Ground level Elev. <b>3579</b>	Producing Formation <b>Morrow</b>		Pool <b>Gem, East</b>		Dedicated Acreage: <b>320</b> Acres

1. Outline the acreage dedicated to the subject well by colored pencil or hatchure marks on the plat below.

2. If more than one lease is dedicated to the well, outline each and identify the ownership thereof (both as to working interest and royalty).

3. If more than one lease of different ownership is dedicated to the well, have the interest of all owners been consolidated by communitization, unitization, force-pooling, etc.?

☐ Yes

☐ No

If answer is "yes" type of consolidation

If answer is "no" list the owners and tract descriptions which have actually been consolidated. (Use reverse side of this form if necessary.)

No allowable will be assigned to the well until all interests have been consolidated (by communitization, unitization, forced-pooling, or otherwise) or until a non-standard unit, eliminating such interest, has been approved by the Division.

OPERATOR CERTIFICATION

I hereby certify that the information contained herein is true and complete to the best of my knowledge and belief.

Signature

Printed Name

Dorothy Houghton

Position

Regulatory Administrator

Company

BTA Oil Producers

Date

August 16, 1990

SURVEYOR CERTIFICATION

I hereby certify that the well location shown on this plat was plotted from field notes of actual surveys made by me or under my supervision, and that the same is true and correct to the best of my knowledge and belief.

Date Surveyed

AUGUST 9, 1990

Signature & Seal of  
Professional Surveyor

MAX A. SCHMANN, JR.

Certificate No.  
1510

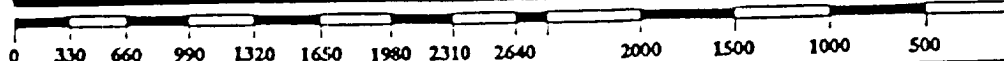
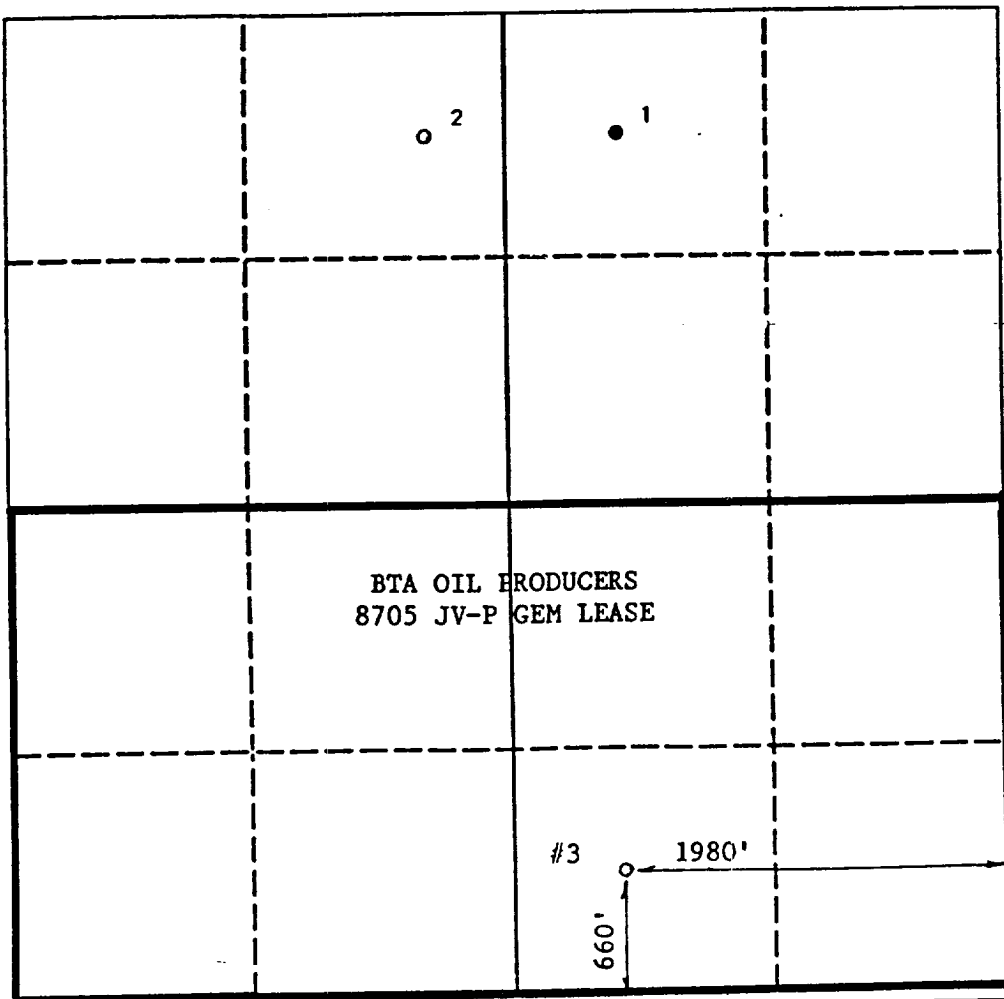

Submit to Appropriate  
District Office  
State Lease - 4 copies  
Fee Lease - 3 copies

State of New Mexico  
Energy, Minerals and Natural Resources Department

Form C-102  
Revised 1-1-89

OIL CONSERVATION DIVISION

P.O. Box 2088  
Santa Fe, New Mexico 87504-2088

DISTRICT I  
P.O. Box 1980, Hobbs, NM 88240

DISTRICT II  
P.O. Drawer DD, Artesia, NM 88210

DISTRICT III  
1000 Rio Brazos Rd., Aztec, NM 87410

WELL LOCATION AND ACREAGE DEDICATION PLAT

All Distances must be from the outer boundaries of the section

Operator <b>BTA OIL PRODUCERS</b>			Lease <b>8705 JV-P GEM</b>		Well No. <b>3</b>
Unit Letter <b>"O"</b>	Section <b>2</b>	Township <b>-20-S</b>	Range <b>-33-E</b>	County <b>LEA</b>	<b>NMPM</b>
Actual Footage Location of Well: <b>660</b> feet from the <b>SOUTH</b> line and <b>1980</b> feet from the <b>EAST</b> line					
Ground level Elev. <b>3579</b>	Producing Formation <b><del>PERMIAN</del> BONE SPRING</b>		Pool <b>TEAS <del>AND BONE SPRING</del> Bone Spring</b>	Dedicated Acreage: <b>40</b> Acres	

1. Outline the acreage dedicated to the subject well by colored pencil or hatchure marks on the plat below.
2. If more than one lease is dedicated to the well, outline each and identify the ownership thereof (both as to working interest and royalty).
3. If more than one lease of different ownership is dedicated to the well, have the interest of all owners been consolidated by communitization, unitization, force-pooling, etc?  
☐ Yes ☐ No If answer is "yes" type of consolidation \_\_\_\_\_  
If answer is "no" list the owners and tract descriptions which have actually been consolidated. (Use reverse side of this form if necessary).  
No allowable will be assigned to the well until all interests have been consolidated (by communitization, unitization, forced-pooling, or otherwise) or until a non-standard unit, eliminating such interest, has been approved by the Division.

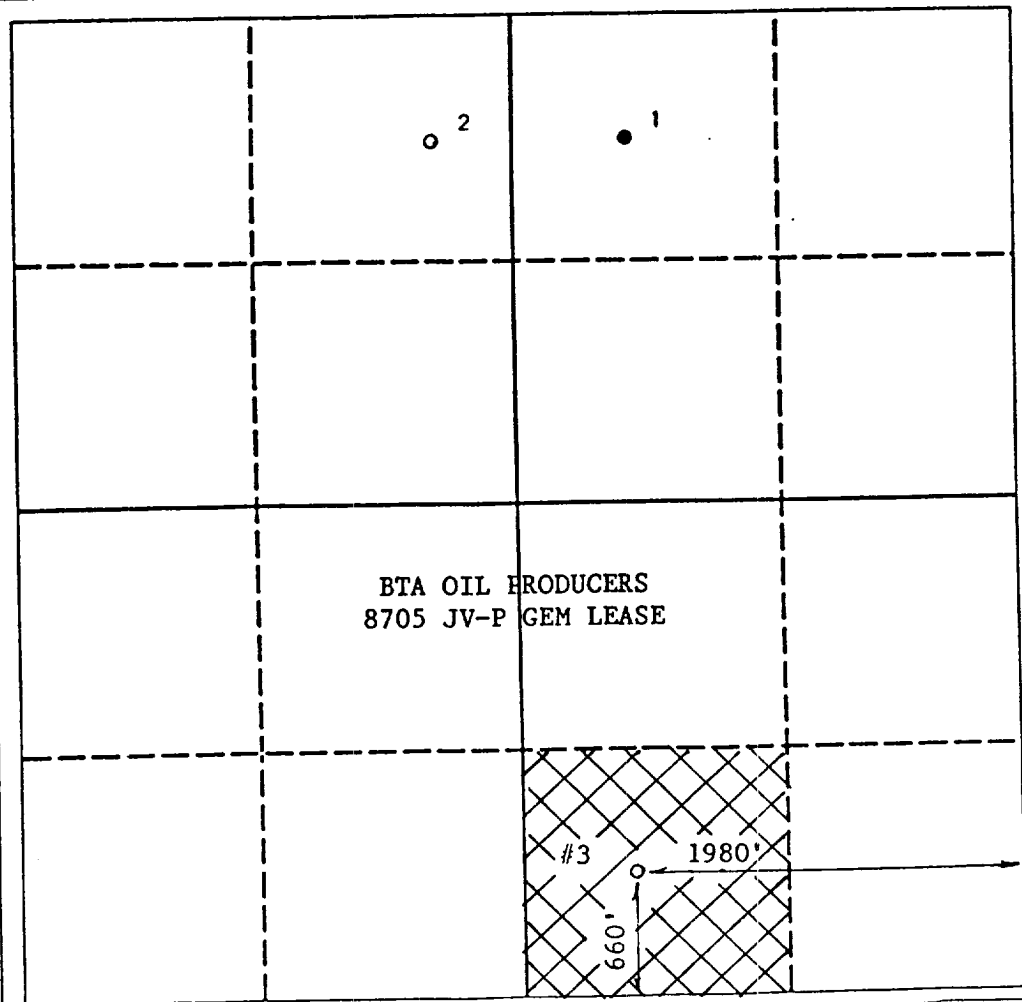

OPERATOR CERTIFICATION

I hereby certify that the information contained herein is true and complete to the best of my knowledge and belief.

Signature

Printed Name

Royce D. Boyce

Position

Production Supervisor

Company

BTA Oil Producers

Date

08-13-90

SURVEYOR CERTIFICATION

I hereby certify that the well location shown on this plat was plotted from field notes of actual surveys made by me or under my supervision, and that the same is true and correct to the best of my knowledge and belief.

Date Surveyed

AUGUST 9, 1990

Signature & Seal of  
Professional Surveyor

MAX A. SCHMANN, JR.

Certificate No.

1510

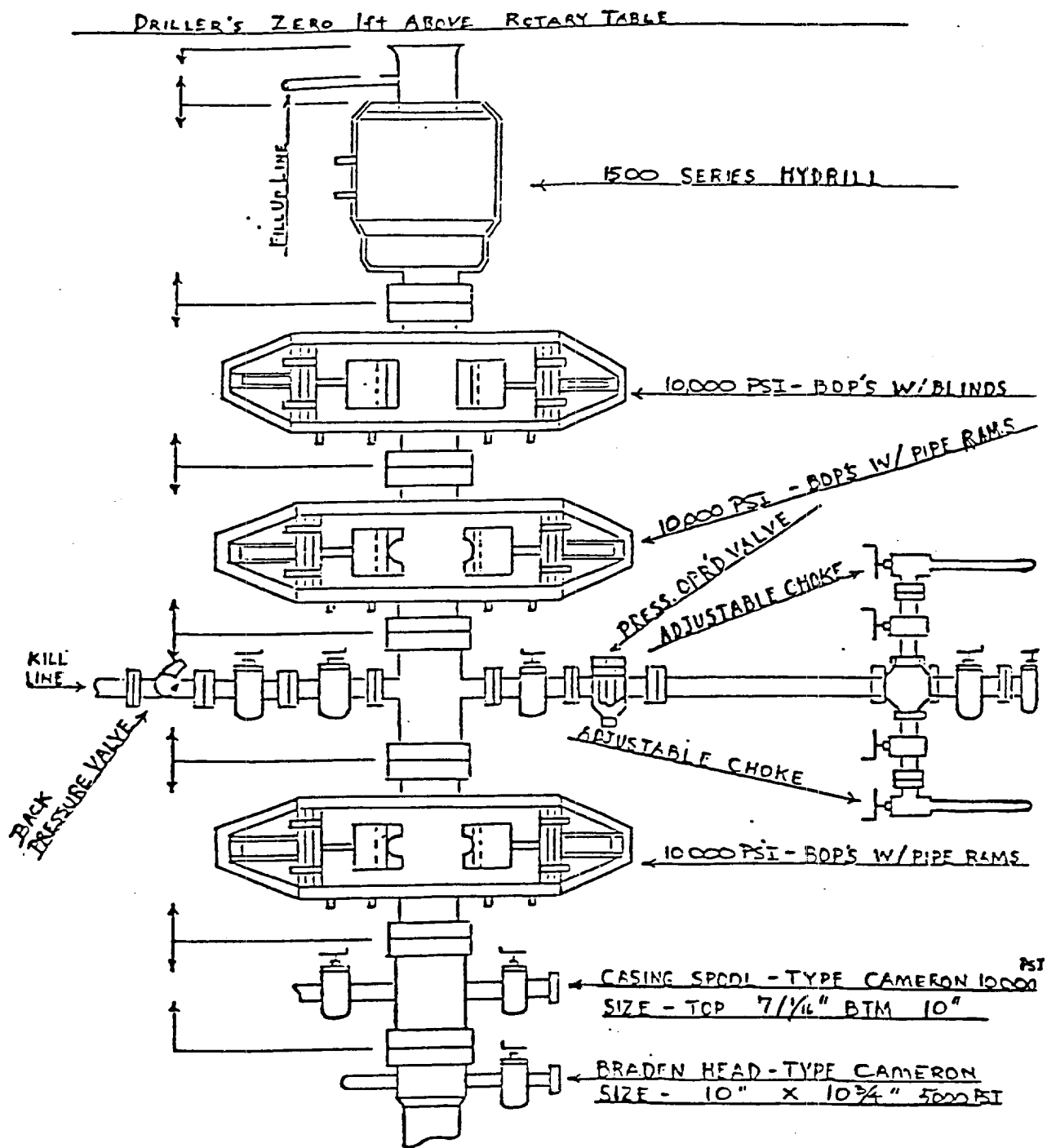

BOP Hook Up After Setting Surface (9-5/8") + Intermediate (7")  
Strings. All Connections From The Spool Up Will Be Tested To 10,000

BTA OIL PRODUCERS  
8705 JV-P Gem, Well #3  
Lea County, N.M.

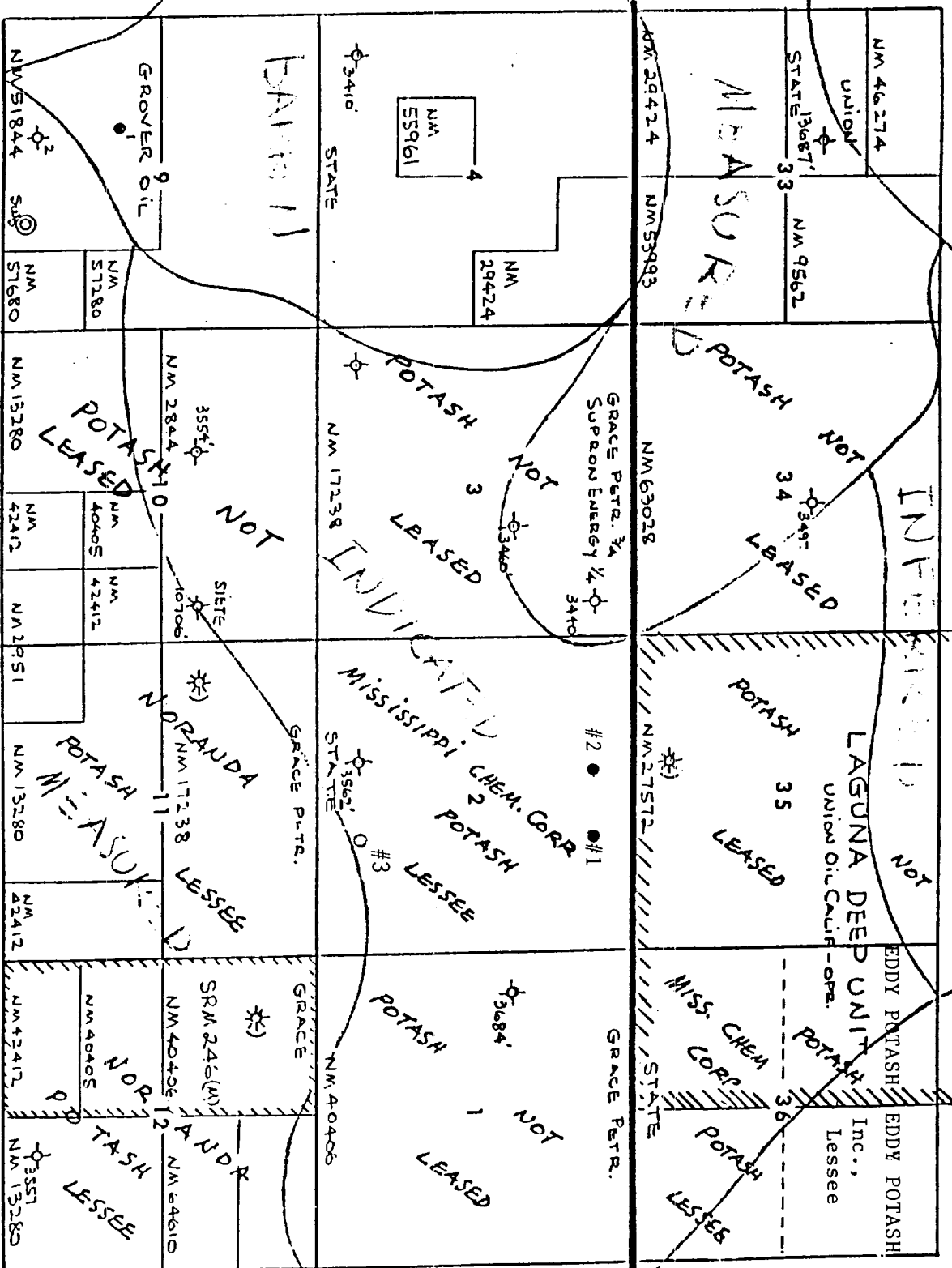

\*) Morrow Producing Well

Distribution of Potash Resources  
from 1984 BLM map

scale: 1mile

R 33 E

BTA OIL PRODUCERS

Proposed Morrow Location  
660' FSL & 1980' FEL, Sec. 2, 120S, R33E  
Lea County, New Mexico



MIDLAND PARTNERS  
CARLTON BEAL  
CARLTON BEAL, JR.  
BARRY BEAL  
SPENCER BEAL  
KELLY BEAL

DENVER PARTNER  
BARRY BEAL, JR.

BTA OIL PRODUCERS  
104 SOUTH PECOS  
MIDLAND, TEXAS 79701  
AC 915-682-3753

ROCKY MOUNTAIN DIVISION  
555-17TH STREET  
SUITE 835  
DENVER, CO 80202  
AC 303-292-9299

August 31, 1990

RE: Gem, 8705 JV-P #3  
-O- Sec. 2, T20S, R33E  
Lea County, New Mexico

---

STATE OF NEW MEXICO  
Oil Conservation Division  
P. O. Box 1980  
Hobbs, New Mexico 88240

Gentlemen:

Attached please find signed waivers from the three Potash lessee's within radius of one mile of our above referenced proposed well.

Please advise if there is any problem with the approval of our drilling permit.

Sincerely,

A handwritten signature in cursive script, reading "Dorothy Houghton", written over a horizontal line.

DOROTHY HOUGHTON  
For BTA Oil Producers

DH/pdi

Attachments



21105 Gem - TRI  
4L

MIDLAND PARTNERS  
CARLTON BEAL  
CARLTON BEAL, JR.  
BARRY BEAL  
SPENCER BEAL  
KELLY BEAL

DENVER PARTNER  
BARRY BEAL, JR.

BTA OIL PRODUCERS  
104 SOUTH PECOS  
MIDLAND, TEXAS 79701  
AC 915-682-3753

August 13, 1990

ROCKY MOUNTAIN DIVISION  
555-17TH STREET  
SUITE 835  
DENVER, CO 80202  
AC 303-292-9299

In re: BTA 8705 JV-P Gem No. 3  
Notice of Intention to Drill  
Lea County, New Mexico

Mississippi Chemical Corporation  
P. O. Box 101  
Carlsbad, NM 88220

RETURN RECEIPT REQUESTED  
CERTIFIED MAIL NO. 546 948 219

Attention: Mr. Bob Dynan

Gentlemen:

In accordance with the State of New Mexico's Oil Conservation Commission Order No. R-111-P, we enclose the following material:

- 1) Copy of the Application for Permit to Drill; and
- 2) Plat of the area.

According to the office of the Commissioner of Public Lands for the State of New Mexico, the Mississippi Chemical Corporation is the lessee of a State of New Mexico potash lease covering the following lands:

All of Section 2, T-20-S, R-33-E, and SW/4, NW/4 SE/4  
and S/2 SE/4 of Section 36, T-19-S, R-33-E, all in Lea  
County, New Mexico.

If you are agreeable that our drilling of the well will not interfere with your potash operations, please execute in the space provided below and return one (1) copy of this letter, in the enclosed envelope, to the undersigned at your earliest convenience.

Should you have any questions or need any additional information, please advise.

Yours truly,



  
WIN J. FARQUHAR  
Manager Land Acquisitions

AGREED TO AND ACCEPTED THIS 23 DAY OF AUGUST, 1990.

MISSISSIPPI CHEMICAL CORPORATION

By:

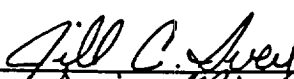
Title:



File  
8705 Gem - I -  
L/L

MIDLAND PARTNERS  
CARLTON BEAL  
CARLTON BEAL, JR.  
BARRY BEAL  
SPENCER BEAL  
KELLY BEAL

DENVER PARTNER  
BARRY BEAL, JR.

BTA OIL PRODUCERS  
104 SOUTH PECOS  
MIDLAND, TEXAS 79701  
AC 915-682-3753

ROCKY MOUNTAIN DIVISION  
555-17TH STREET  
SUITE 835  
DENVER, CO 80202  
AC 303-292-9299

August 13, 1990

In re: BTA 8705 JV-P Gem No. 3  
Notice of Intention to Drill  
Lea County, New Mexico

Eddy Potash Incorporated  
P. O. Box 31  
Carlsbad, NM 88220

RETURN RECEIPT REQUESTED  
CERTIFIED MAIL NO. P 546 948 220

Attention: Mr. Robert Kreul

Gentlemen:

In accordance with the State of New Mexico's Oil Conservation Commission Order No. R-111-P, we enclose the following material:

- 1) Copy of the Application for Permit to Drill; and
- 2) Plat of the area.

According to our information, Eddy Potash Incorporated is the lessee of a State of New Mexico potash lease covering the following lands:

N/2 and NE/4 SE/4 of Section 36, T-19-S, R-33-E, Lea  
County, New Mexico.

If you are agreeable that our drilling of the well will not interfere with your potash operations, please execute in the space provided below and return one (1) copy of this letter, in the enclosed envelope, to the undersigned at your earliest convenience.

Should you have any questions or need any additional information, please advise.

Yours truly,

WIN J. FARQUHAR  
Manager Land Acquisitions

AGREED TO AND ACCEPTED THIS 17 DAY OF AUGUST, 1990.

EDDY POTASH INCORPORATED

By:   
Title: Gen. mgr.





FILE  
9705 Gem  
4L

MIDLAND PARTNERS  
CARLTON BEAL  
CARLTON BEAL, JR.  
BARRY BEAL  
SPENCER BEAL  
KELLY BEAL

DENVER PARTNER  
BARRY BEAL, JR.

# BTA OIL PRODUCERS

104 SOUTH PECOS  
MIDLAND, TEXAS 79701  
AC 915-682-3753

ROCKY MOUNTAIN DIVISION  
555-17TH STREET  
SUITE 835  
DENVER, CO 80202  
AC 303-292-9299

August 13, 1990

In re: BTA 8705 JV-P Gem No. 3  
Notice of Intention to Drill  
Lea County, New Mexico

Noranda Exploration, Inc.  
Suite 1300, Four King Street West  
Toronto, Ontario M5H186

RETURN RECEIPT REQUESTED  
CERTIFIED MAIL NO. P 546 948 221

Attention: Mr. Frank Condon

Gentlemen:

In accordance with the State of New Mexico's Oil Conservation Commission Order No. R-111-P, we enclose the following material:

- 1) Copy of the Application for Permit to Drill; and
- 2) Plat of the area.

According to the office of the Bureau of Land Management, Noranda Exploration, Inc. is the lessee of a Bureau of Land Management potash lease covering the following lands:

All of Sections 11 and 12, T-20-S, R-33-E, Lea County,  
New Mexico.

If you are agreeable that our drilling of the well will not interfere with your potash operations, please execute in the space provided below and return one (1) copy of this letter, in the enclosed envelope, to the undersigned at your earliest convenience.

Should you have any questions or need any additional information, please advise.

Yours truly,

WIN J. FARQUHAR  
Manager Land Acquisitions

AGREED TO AND ACCEPTED THIS 21 DAY OF AUGUST, 1990.

NORANDA EXPLORATION, INC.

By

Title: Director Business Development

06-11-21 20:00  
LIT