

Submit to Appropriate
District Office
State Lease -- 6 copies
Fee Lease -- 5 copies

State of New Mexico
Energy, Minerals and Natural Resources Department

Form C-101
Revised 1-1-89

OIL CONSERVATION DIVISION

DISTRICT I
P.O. Box 1980, Hobbs, NM 88240

DISTRICT II
P.O. Drawer DD, Artesia, NM 88210

DISTRICT III
1000 Rio Brazos Rd., Aztec, NM 87410

P.O. Box 2088
Santa Fe, New Mexico 87504-2088

API NO. (assigned by OCD on New Wells)

30-025-31021

5. Indicate Type of Lease

STATE ☒ FEE ☐

6. State Oil & Gas Lease No.

E-1587

APPLICATION FOR PERMIT TO DRILL, DEEPEN, OR PLUG BACK

1a. Type of Work:

DRILL ☒

RE-ENTER ☐

DEEPEN ☐

PLUG BACK ☐

b. Type of Well:

OIL
WELL ☒

GAS
WELL ☐

OTHER ☐

SINGLE
ZONE ☐

MULTIPLE
ZONE ☐

2. Name of Operator

Pyramid Energy, Inc.

3. Address of Operator

14100 San Pedro, Ste 700 San Antonio, Texas 78232

4. Well Location

Unit Letter 0 : 1340 Feet From The East Line and 100 Feet From The South Line

Section 29

Township

19S

Range

35E

NMPM

Lea

County

10. Proposed Depth
5200'

11. Formation
Queen

12. Rotary or C.T.
Rotary

13. Elevations (Show whether DF, RT, GR, etc.)
3745 GR

14. Kind & Status Plug Bond
Surety Bond-Current

15. Drilling Contractor
Peterson

16. Approx. Date Work will start
Oct. 1990

17.

PROPOSED CASING AND CEMENT PROGRAM

SIZE OF HOLE	SIZE OF CASING	WEIGHT PER FOOT	SETTING DEPTH	SACKS OF CEMENT	EST. TOP
12 1/4"	8 5/8"	24#	400'	250 sx	surface
7 7/8"	5 1/2"	15.50# & 17#	5000'	1000 sx	surface

IN ABOVE SPACE DESCRIBE PROPOSED PROGRAM: IF PROPOSAL IS TO DEEPEN OR PLUG BACK, GIVE DATA ON PRESENT PRODUCTIVE ZONE AND PROPOSED NEW PRODUCTIVE ZONE. GIVE BLOWOUT PREVENTER PROGRAM, IF ANY.

I hereby certify that the information above is true and complete to the best of my knowledge and belief.

SIGNATURE Scott Graef TITLE Production Engineer DATE 9/21/90

TYPE OR PRINT NAME Scott Graef

TELEPHONE NO. (512)490-5000

(This space for State Use)

ORIGINAL NO.

APPROVED BY _____ TITLE _____ DATE _____

CONDITIONS OF APPROVAL, IF ANY:

782-2877

Permit Expires 6 Months From Approval
Date Unless Drilling Underway.

SEP 28 1990

NE MEXICO OIL CONSERVATION COMMISSION
WELL LOCATION AND ACREAGE DEDICATION PLAT

Form C-102
Supersedes C-128
Effective 1-1-65

All distances must be from the outer boundaries of the Section

Operator PYRAMID ENERGY INC.			Lease West Pearl Queen Unit		Well No. 195
Unit Letter O	Section 29	Township 19 South	Range 35 East	County Lea County, N.M.	
Actual Footage Location of Well: 1340 feet from the East line and 100 feet from the South line					
Ground Level Elev. 3745.	Producing Formation Queen		Pool Pearl Queen	Dedicated Acreage 40 Acres	

1. Outline the acreage dedicated to the subject well by colored pencil or hachure marks on the plat below.
2. If more than one lease is dedicated to the well, outline each and identify the ownership thereof (both as to working interest and royalty).
3. If more than one lease of different ownership is dedicated to the well, have the interests of all owners been consolidated by communitization, unitization, force-pooling, etc?

☒ Yes ☐ No If answer is "yes," type of consolidation Unitization, R-2728

If answer is "no," list the owners and tract descriptions which have actually been consolidated. (Use reverse side of this form if necessary.) _____

No allowable will be assigned to the well until all interests have been consolidated (by communitization, unitization, forced-pooling, or otherwise) or until a non-standard unit, eliminating such interests, has been approved by the Commission.

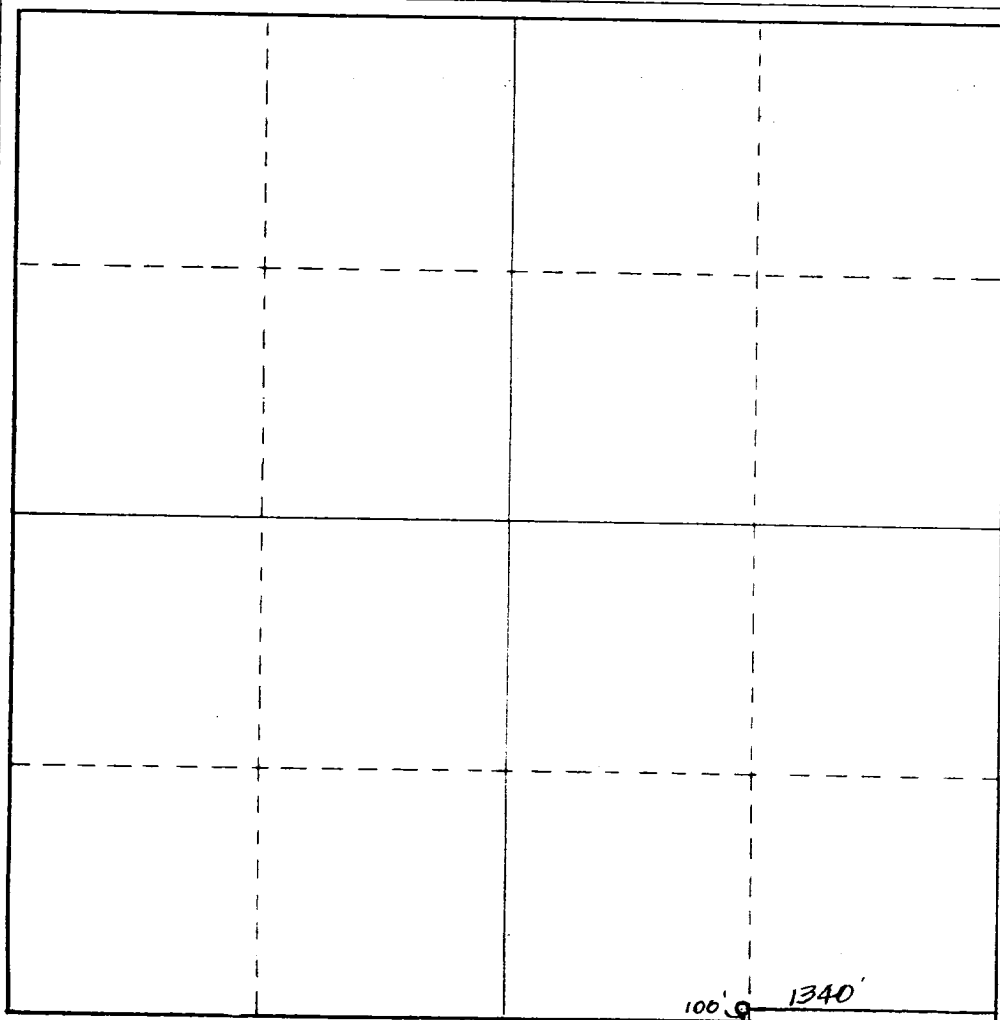

CERTIFICATION

I hereby certify that the information contained herein is true and complete to the best of my knowledge and belief.

Scott Grief
Name

Position
Production Engineer

Company
Pyramid Energy, Inc.

Date
Sept. 21, 1990

DAN R. REDDY
NEW MEXICO
I hereby certify that the well location shown on this plat was plotted from field notes of actual surveys made by me or under my supervision, and that the same is true and correct to the best of my knowledge and belief.
REGISTERED PROFESSIONAL ENGINEER AND SURVEYOR

Date Surveyed
September 18, 1990

Registered Professional Engineer and/or Land Surveyor

Dan R. Reddy
Certificate No.

NM PE&PS NO. 5412

East & West Pearl Queen Units

1000 ft
Leo County
Scale:

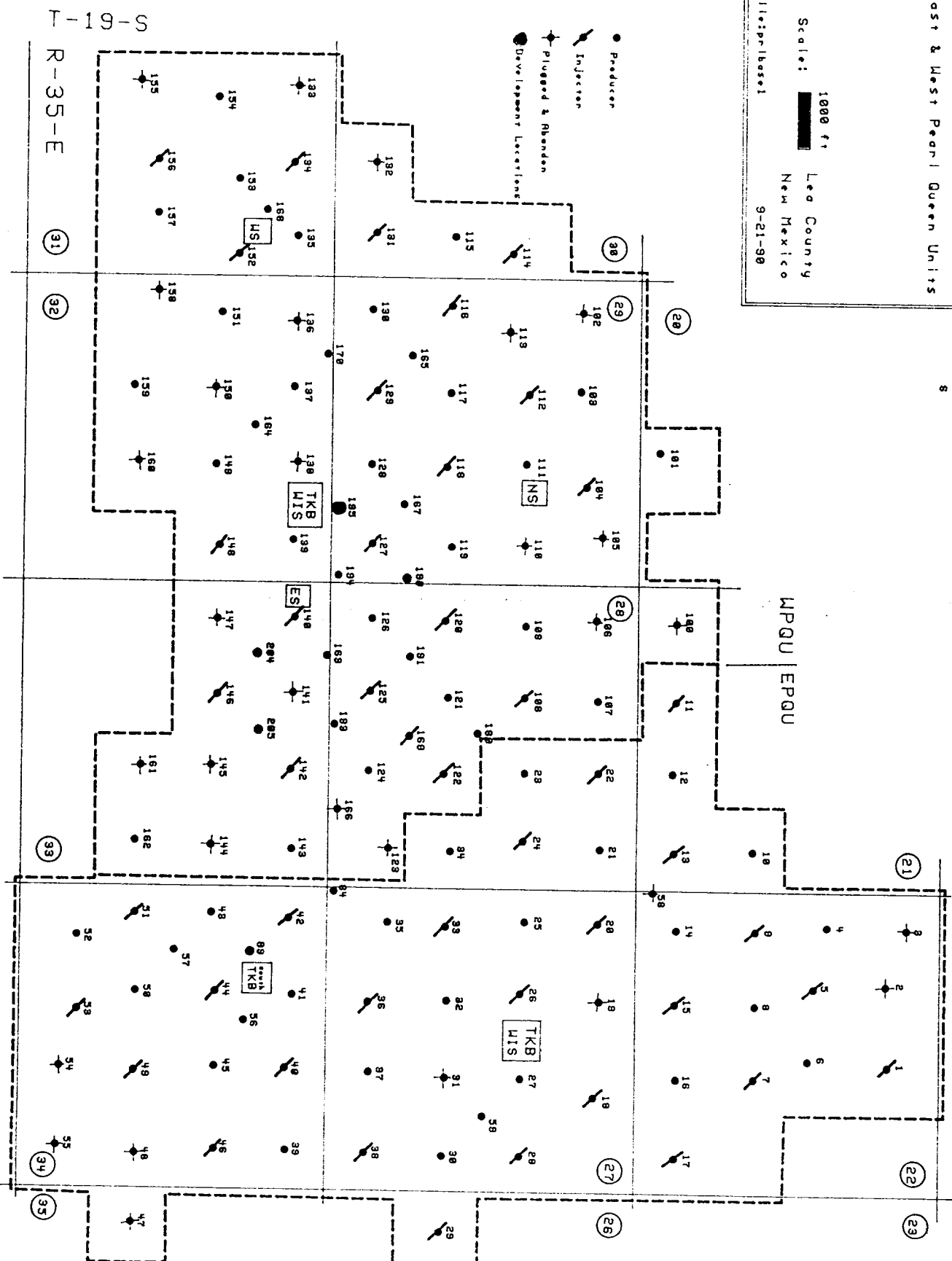
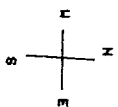

RECEIVED

SEP 24 1990

CCC
HOBBS OFFICE

BOP

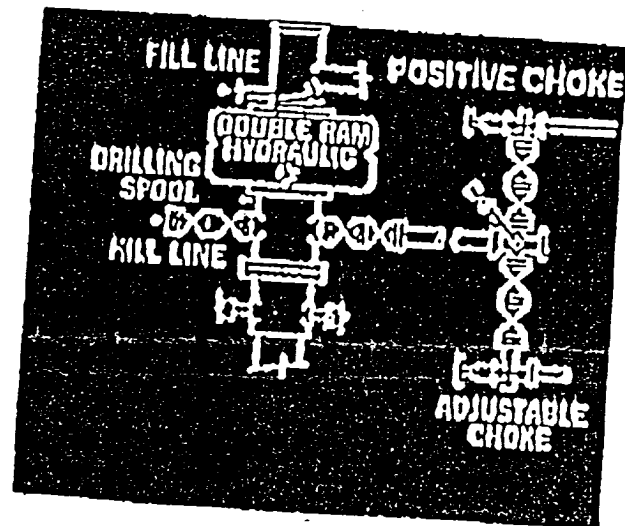



PYRAMID ENERGY, INC.

Pacific Plaza • 14100 San Pedro, Suite 700

San Antonio, Texas 78232 • (512) 490-5000 • FAX: (512) 494-0406

September 21, 1990

Michael E. Stogner
NMOCD
P.O. Box 2088
Santa Fe, New Mexico 87504-2088

Re: Unorthodox Location
West Pearl Queen Unit #195
T19S, R35E
Lea County, New Mexico

Dear Mr. Stogner:

This letter shall serve as our request to have the following unorthodox location approved by your office.

1340' FEL 100' FSL, Sec. 29, Unit 0, T19S, R35E

On the attached plat, you will note our location lies within the unit boundaries of the West Pearl Queen Unit. We offset ourselves on these locations. We are requesting approval of this location because it will allow us to establish a more efficient waterflood pattern within the unit.

Should you have any questions, please call.

Sincerely,

Scott Graef
Production Engineer

attachment

cc: NMOCD - Hobbs