



STATE OF NEW MEXICO  
ENERGY AND MINERALS DEPARTMENT  
OIL CONSERVATION DIVISION  
HOBBS DISTRICT OFFICE

9-25-90

GARREY CARRUTHERS  
GOVERNOR

POST OFFICE BOX 1980  
HOBBS, NEW MEXICO 88241-1980  
(505) 393-6161

OIL CONSERVATION DIVISION  
P. O. BOX 2088  
SANTA FE, NEW MEXICO 87501

nsL-2877

RE: Proposed:

MC \_\_\_\_\_  
DHC \_\_\_\_\_  
NSL X \_\_\_\_\_  
NSP \_\_\_\_\_  
SWD \_\_\_\_\_  
WFX \_\_\_\_\_  
PMX \_\_\_\_\_

Gentlemen:

I have examined the application for the:

Pyramid Energy Inc. West Pearl Queen Unit #204-D 33-19-35  
Operator Lease & Well No. Unit S-T-R

and my recommendations are as follows:

OK

Yours very truly,

Jerry Sexton  
Jerry Sexton  
Supervisor, District 1

/ed



# PYRAMID ENERGY, INC.

Pacific Plaza • 14100 San Pedro, Suite 700

San Antonio, Texas 78232 • (512) 490-5000 • FAX: (512) 494-0406

September 21, 1990

Michael E. Stogner  
NMOCD  
P.O. Box 2088  
Santa Fe, New Mexico 87504-2088

Re: Unorthodox Location  
West Pearl Queen Unit #204  
T19S, R35E  
Lea County, New Mexico

Dear Mr. Stogner:

This letter shall serve as our request to have the following unorthodox location approved by your office.

1310' FNL 1310' FWL, Sec. 33, Unit D, T19S, R35E

On the attached plat, you will note our location lies within the unit boundaries of the West Pearl Queen Unit. We offset ourselves on these locations. We are requesting approval of this location because it will allow us to establish a more efficient waterflood pattern within the unit.

Should you have any questions, please call.

Sincerely,

Scott Graef  
Production Engineer

attachment

cc: NMOCD - Hobbs

# PYRAMID ENERGY, INC. East & West Pearl Queen Units

Scale: 1000 ft  
Leo County  
New Mexico  
9-21-90  
file:prlbaset1

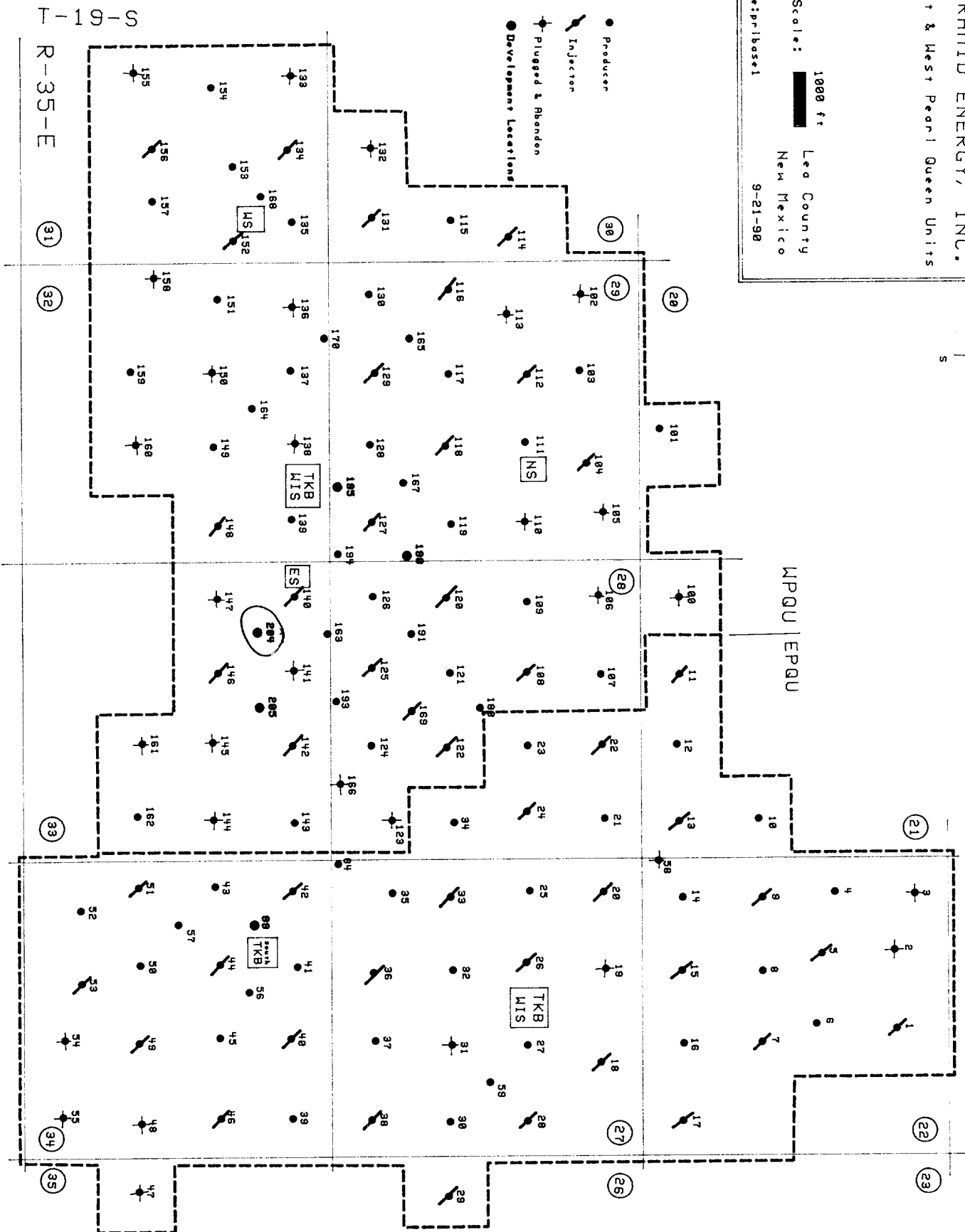
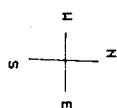

S-19-L  
R-35-E