

District I
PO Box 1980, Hobbs, NM 88241-1980

District II
811 South First, Artesia, NM 88210

District III
1000 Rio Brazos Rd., Aztec, NM 87410

District IV
2040 South Pacheco, Santa Fe, NM 87505

State of New Mexico
Energy, Minerals & Natural Resources Department

OIL CONSERVATION DIVISION
2040 South Pacheco
Santa Fe, NM 87505

Form C-101

Revised October 18, 1994

Instructions on back

Submit to Appropriate District Office

State Lease - 6 Copies

Fee Lease - 5 Copies

☐ AMENDED REPORT

APPLICATION FOR PERMIT TO DRILL, RE-ENTER, DEEPEN, PLUGBACK, OR ADD A ZONE

Operator Name and Address BTA OIL PRODUCERS 104 SOUTH PECOS MIDLAND, T X 79701		OGRID Number 003002
		API Number 30 - 025-31209
Property Code 002314	Property Name Gem, 8705 JV-P	Well No. 4

Surface Location

UL or lot no.	Section	Township	Range	Lot Idn	Feet from the	North/South line	Feet from the	East/West Line	County
N	2	20-S	33-E		510	South	1980	West	Lea

Proposed Bottom Hole Location If Different From Surface

UL or lot no.	Section	Township	Range	Lot Idn	Feet from the	North/South line	Feet from the	East/West Line	County
Proposed Pool 1					Proposed Pool 2				
Teas (Delaware) Pool Code 96797									

Work Type Code P	Well Type Code O	Cable/Rotary	Lease Type Code S	Ground Level Elevation 3580
Multiple No	Proposed Depth 10297	Formation Delaware	Contractor	Spud Date 04-21-91

Proposed Casing and Cement Program

Hole Size	Casing Size	Casing weight/foot	Setting Depth	Sacks of Cement	Estimated TOC
26	20	106.5 & 133	1370	2100	Surface
17-1/2	13-3/8"	68	3130	2200	Surface
12-1/4"	8-5/8"	32	5550	1700	TOC @ 4160'
7-7/8"	5-1/2	17	10293	1500	Surface

Describe the proposed program. If this application is to DEEPEN or PLUG BACK give the data on the present productive zone and proposed new productive zone. Describe the blowout prevention program, if any. Use additional sheets if necessary.

- MIRU - POH w/ production equipment
- PU RBP for 5-1/2" 17# csg on tubing, RIH, set RBP @ +/-7000'. Spot 2 sx sand on RBP.
- Load hole w/ 2% KCL wtr. Pressure test RBP to 1000 psi, Spot 200 gals of 10% acetic acid @ 6590'. POH w/ tbg.
- RU & Perf Delaware. RIH w/ tbg. & packer. Pressure test tbg to 8000 psi. Set pkr @ +/- 6370' Pressure test Pkr to 1000 psi.
- Breakdown perms w/ pressure & displace acid.
- Swab to evaluate.

Permit Expires 1 Year From Approval Date

Date Unless Entry Unsuccessful

Plugback

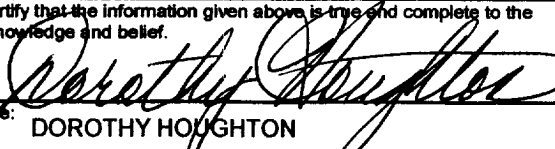
I hereby certify that the information given above is true and complete to the best of my knowledge and belief.		OIL CONSERVATION DIVISION	
Signature: 	Approved By:	ORIGINAL SIGNED BY	
Printed name: DOROTHY HOUGHTON	Title:	GARY WINK	
Title: REGULATORY ADMINISTRATOR	Approval Date: NOV 10 1999	Expiration Date:	
Date: 11-05-99	Phone: 915/682-3753	Conditions of Approval: Attached: <input type="checkbox"/>	

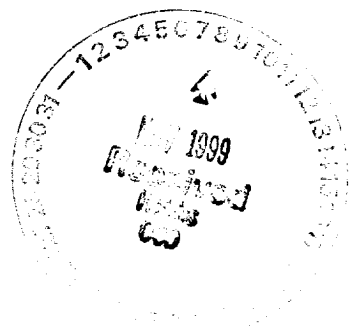

OIL CONSERVATION DIVISION

P.O. Box 2088

Santa Fe, New Mexico 87504-2088

DISTRICT I

P.O. Box 1980, Hobbs, NM 88240

DISTRICT II

P.O. Drawer DD, Artesia, NM 88210

DISTRICT III

1000 Rio Brazos Rd., Aztec, NM 87410

WELL LOCATION AND ACREAGE DEDICATION PLAT

All Distances must be from the outer boundaries of the section

Operator BTA OIL PRODUCERS			Lease 8705 JV-P GEM		Well No 4
Unit Letter "N"	Section 2	Township -20-S	Range -33-E	County LEA	NMPM
Actual Footage Location of Well: 510 feet from the SOUTH line and 1980 feet from the WEST line					
Ground level Elev. 3580	Producing Formation Delaware		Pool TEAS	Dedicated Acreage: 40 Acres	

1. Outline the acreage dedicated to the subject well by colored pencil or hatchure marks on the plat below.
2. If more than one lease is dedicated to the well, outline each and identify the ownership thereof (both as to working interest and royalty).
3. If more than one lease of different ownership is dedicated to the well, have the interest of all owners been consolidated by communitization, unitization, force-pooling, etc?
☐ Yes ☐ No If answer is "yes" type of consolidation _____
If answer is "no" list the owners and tract descriptions which have actually been consolidated. (Use reverse side of this form if necessary).
No allowable will be assigned to the well until all interests have been consolidated (by communitization, unitization, forced-pooling, or otherwise) or until a non-standard unit, eliminating such interest, has been approved by the Division.

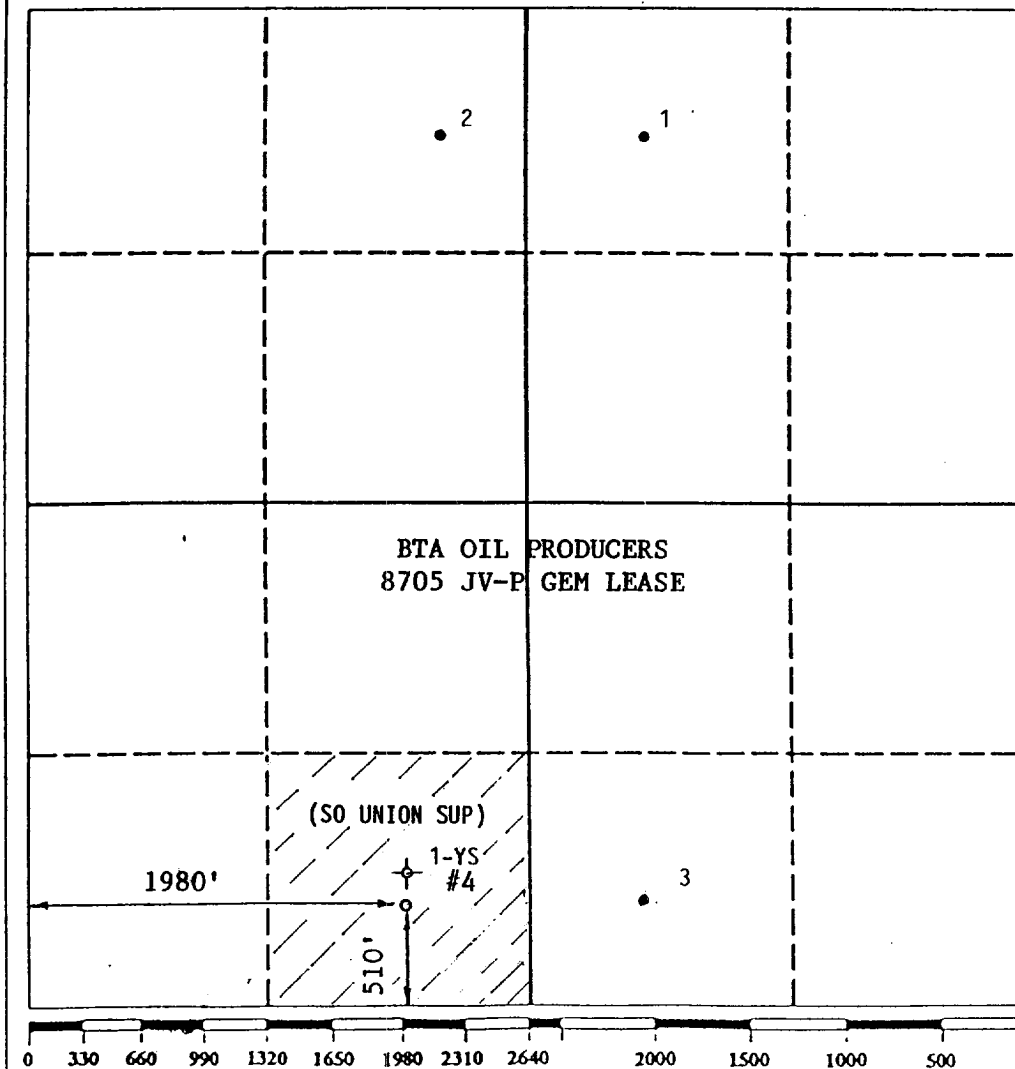

OPERATOR CERTIFICATION

I hereby certify that the information contained herein is true and complete to the best of my knowledge and belief.

Signature

Printed Name

DOROTHE HOUGHTON

Position

Regulatory Administrator

Company

BTA OIL PRODUCERS

Date

11-05-99

SURVEYOR CERTIFICATION

I hereby certify that the well location shown on this plat was plotted from field notes of actual surveys made by me or under my supervision, and that the same is true and correct to the best of my knowledge and belief.

Date Surveyed

MARCH 25, 1991

Signature & Seal of
Professional Surveyor

MAX A. SCHUMANN, JR.

Certificate No.

1510

