

Title 18 U.S.C. Section 1001, makes it a crime for any person knowingly and willfully to make to any department or agency of the United States any false, fictitious or fraudulent statements or representations as to any matter within its jurisdiction.

Submit to Appropriate
District Office
State Lease - 4 copies
Fee Lease - 3 copies

State of New Mexico
Energy, Minerals and Natural Resources Department

Form C-102
Revised 1-1-89

OIL CONSERVATION DIVISION

P.O. Box 2088

Santa Fe, New Mexico 87504-2088

DISTRICT I
P.O. Box 1898, Hobbs, NM 88240

DISTRICT II
P.O. Drawer DD, Artesia, NM 88210

DISTRICT III
1000 Rio Grande Rd., Aztec, NM 87410

WELL LOCATION AND ACREAGE DEDICATION PLAT

All Distances must be from the outer boundaries of the section

Operator NEARBURG PRODUCING CO.			Lease LEO 30 FED. COM.		Well No. 1
Unit Letter J	Section 30	Township 19 SOUTH	Range 36 EAST	County LEA	
Actual Footage Location of Well: 1980 feet from the SOUTH line and 1650 feet from the EAST line					
Ground level Elev. 3672.3	Producing Formation Morrow	Pool Osudo Morrow North		Dedicated Acreage 640.00 631.16 Acres	

- Outline the acreage dedicated to the subject well by colored pencil or hatchure marks on the plat below.
- If more than one lease is dedicated to the well, outline each and identify the ownership thereof (both as to working interest and royalty).
- If more than one lease of different ownership is dedicated to the well, have the interest of all owners been consolidated by communitization, unitization, force-pooling, etc?
☒ Yes ☐ No If answer is "yes" type of consolidation **Communitization**
If answer is "no" list the owners and tract descriptions which have actually been consolidated. (Use reverse side of this form if necessary.)
No allowance will be assigned to the well until all interests have been consolidated (by communitization, unitization, force-pooling, or otherwise) or until a non-standard unit, eliminating such interest, has been approved by the Division.

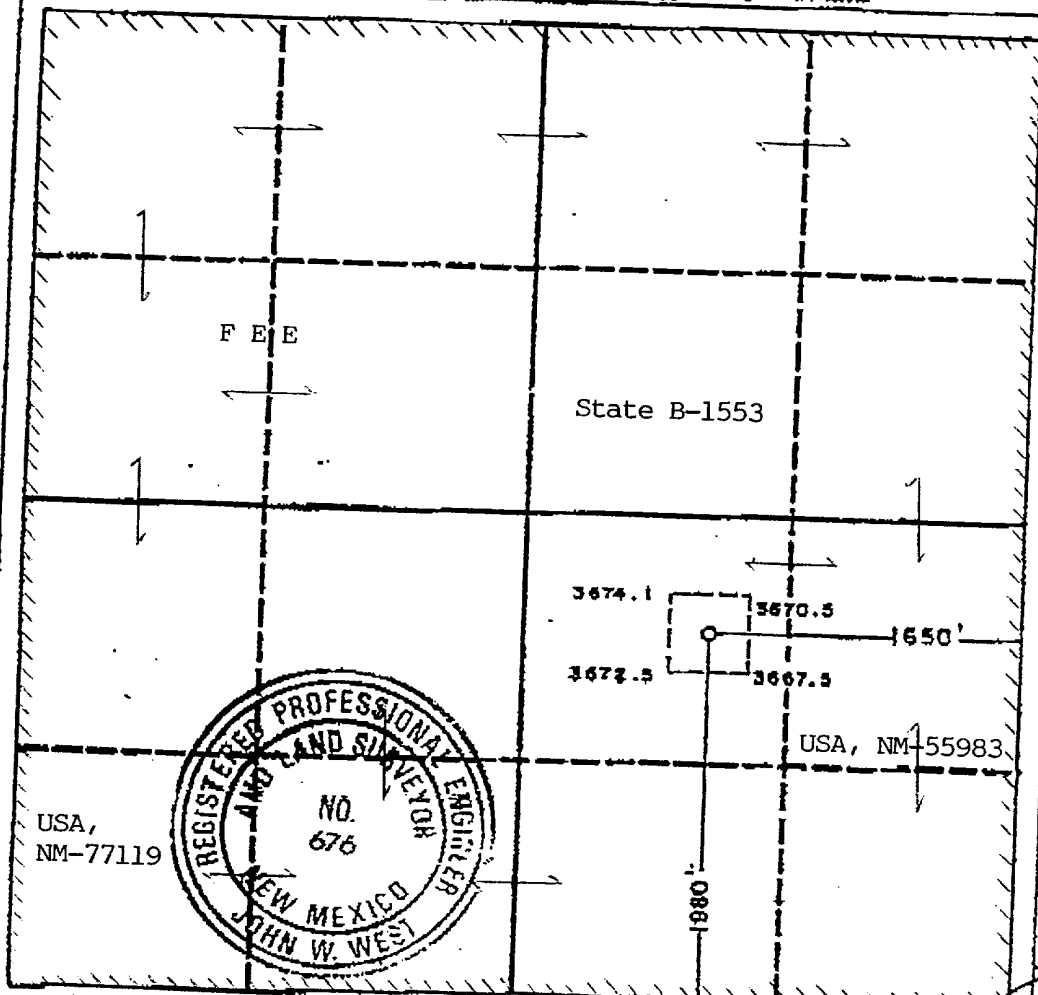

OPERATOR CERTIFICATION

I hereby certify that the information contained herein is true and complete to the best of my knowledge and belief.

Signature *Kathie Craft*
Printed Name **Kathie Craft**
Position **Land Administrator**
Company **Nearburg Producing Co.**
Date **July 3, 1991**

SURVEYOR CERTIFICATION

I hereby certify that the well location shown on this plat was plotted from field notes, actual surveys made by me or under my supervision, and that the same is true as correct to the best of my knowledge as belief.

Date Surveyed **6-27-91**
Signature & Seal of Professional Surveyor
John W. West
CAPTIONED NO. **JOHN W. WEST, 67**
RONALD J. ECKSON, 327

SUPPLEMENTAL DRILLING DATA

NEARBURG PRODUCING COMPANY
LEO 30 FEDERAL COM WELL NO. 1
1,980' FSL & 1,650' FEL OF SECTION 30-T19S-R36E
LEA COUNTY, NEW MEXICO

1. SURFACE FORMATION:

Unconsolidated Fill.

2. ESTIMATED TOPS OF GEOLOGIC MARKERS:

Queen.....	4,560'	Wolfcamp.....	10,940'
San Andres.....	5,100'	Morrow.....	11,800'
Delaware Sand.....	6,040'	Total Depth.....	12,500'
Bone Spring.....	7,240'		

3. ANTICIPATED POSSIBLE HYDROCARBON BEARING ZONES:

Bone Spring.....	7,240'
Wolfcamp.....	10,940'
Morrow.....	11,800'

4. CASING AND CEMENTING PROGRAM:

<u>Casing Size</u>	<u>Setting Depth</u> <u>From To</u>	<u>Weight</u>	<u>Grade</u>	<u>Joint</u>
13-3/8"	0' 425'	48#	J-55	ST&C
9-5/8"	0' 5,500'	36# & 40#	J-55 & N-80	ST&C
5-1/2"	0' 12,500'	17# & 20#	N-80	LT&C

Equivalent or adequate grades and weights of casing may be substituted at time casing is run, depending on availability.

13-3/8" casing will be cemented with 500 sx or volume necessary to circulate.

9-5/8" casing will be cemented with 2,000 sx or volume necessary to tie back into 13-3/8".

5-1/2" production casing will be cemented with approximately 850 sx of Class "H" 50/50 POZ.

JUL 31 1991

CLERK
RECORDS OFFICE