

Submit to Appropriate
District Office
State Lease - 6 copies
Fee Lease - 5 copies

State of New Mexico
Energy, Minerals and Natural Resources Department

Form C-101
Revised 1-1-89

OIL CONSERVATION DIVISION

DISTRICT I
P.O. Box 1980, Hobbs, NM 88240

DISTRICT II
P.O. Drawer DD, Artesia, NM 88210

DISTRICT III
1000 Rio Brazos Rd., Aztec, NM 87410

P.O. Box 2088
Santa Fe, New Mexico 87504-2088

API NO. (assigned by OCD on New Wells)
30 025 31857

5. Indicate Type of Lease
STATE ☐ FEE ☒

6. State Oil & Gas Lease No.

APPLICATION FOR PERMIT TO DRILL, DEEPEN, OR PLUG BACK

1a. Type of Work:

DRILL ☐ RE-ENTER ☐ DEEPEN ☐ PLUG BACK ☒

b. Type of Well:

OIL WELL ☒ GAS WELL ☐ OTHER ☐
SINGLE ZONE ☒ MULTIPLE ZONE ☐

2. Name of Operator

Mitchell Energy Corporation

3. Address of Operator

P.O. Box 4000, The Woodlands, Texas 77387-4000

7. Lease Name or Unit Agreement Name

Scharbauer "4"

8. Well No.

1

9. Pool name or Wildcat

Wildcat

4. Well Location

Unit Letter 0 : 660 Feet From The south Line and 1980 Feet From The east Line

Section 4 Township 20S Range 33E NMPM Lea County

10. Proposed Depth

11,438

11. Formation

Wolfcamp

12. Rotary or C.T.

Rotary

13. Elevations (Show whether DF, RT, GR, etc.)

3556 GR

14. Kind & Status Plug. Bond

Blanket on File

15. Drilling Contractor

16. Approx. Date Work will start

17.

PROPOSED CASING AND CEMENT PROGRAM

SIZE OF HOLE	SIZE OF CASING	WEIGHT PER FOOT	SETTING DEPTH	SACKS OF CEMENT	EST. TOP
26-1/2"	20"	94	500'	950 sx	Surface
17-1/2"	13-3/8"	68	2,950'	2207 sx	Surface
12-1/4"	8-5/8"	32	5,382'	885 sx	Surface
7-7/8"	5-1/2"	17	13,719'	1000 sx + 800 sx thru DV @ 9724'	TOC @ 6630'

Plug back from West Teas (Morrow) Pool to Wildcat (Wolfcamp).

IN ABOVE SPACE DESCRIBE PROPOSED PROGRAM: IF PROPOSAL IS TO DEEPEN OR PLUG BACK, GIVE DATA ON PRESENT PRODUCTIVE ZONE AND PROPOSED NEW PRODUCTIVE ZONE. GIVE BLOWOUT PREVENTER PROGRAM, IF ANY.

I hereby certify that the information above is true and complete to the best of my knowledge and belief.

SIGNATURE George Mullen TITLE Reg. Affairs Specialist DATE 08-17-93

TYPE OR PRINT NAME

TELEPHONE NO.

(This space for State Use)

ORIGINAL SIGNED BY JERRY SEXTON
DISTRICT I SUPERVISOR

APPROVED BY _____ TITLE _____ DATE NOV 23 1993

CONDITIONS OF APPROVAL, IF ANY:

Submit to Appropriate
District Office
State Lease - 4 copies
Fee Lease - 3 copies

State of New Mexico
Energy, Minerals and Natural Resources Department

Form C-102
Revised 1-1-89

OIL CONSERVATION DIVISION

DISTRICT I
P.O. Box 1980, Hobbs, NM 88240

P.O. Box 2088
Santa Fe, New Mexico 87504-2088

DISTRICT II
P.O. Drawer DD, Artesia, NM 88210

DISTRICT III
1000 Rio Brazos Rd., Aztec, NM 87410

WELL LOCATION AND ACREAGE DEDICATION PLAT

All Distances must be from the outer boundaries of the section

Operator Mitchell Energy Corporation			Lease Scharbauer "4"		Well No. 1
Unit Letter 0	Section 4	Township 20S	Range 33E	NMPM	County Lea
Actual Footage Location of Well: 660 feet from the south line and 1980 feet from the east line					
Ground level Elev. 3556	Producing Formation Wolfcamp		Pool Wildcat		Dedicated Acreage: 40 Acres

1. Outline the acreage dedicated to the subject well by colored pencil or hatchure marks on the plat below.
2. If more than one lease is dedicated to the well, outline each and identify the ownership thereof (both as to working interest and royalty).
3. If more than one lease of different ownership is dedicated to the well, have the interest of all owners been consolidated by communitization, unitization, force-pooling, etc.?
☐ Yes ☐ No If answer is "yes" type of consolidation _____
If answer is "no" list the owners and tract descriptions which have actually been consolidated. (Use reverse side of this form if necessary.) _____
No allowable will be assigned to the well until all interests have been consolidated (by communitization, unitization, forced-pooling, or otherwise) or until a non-standard unit, eliminating such interest, has been approved by the Division.

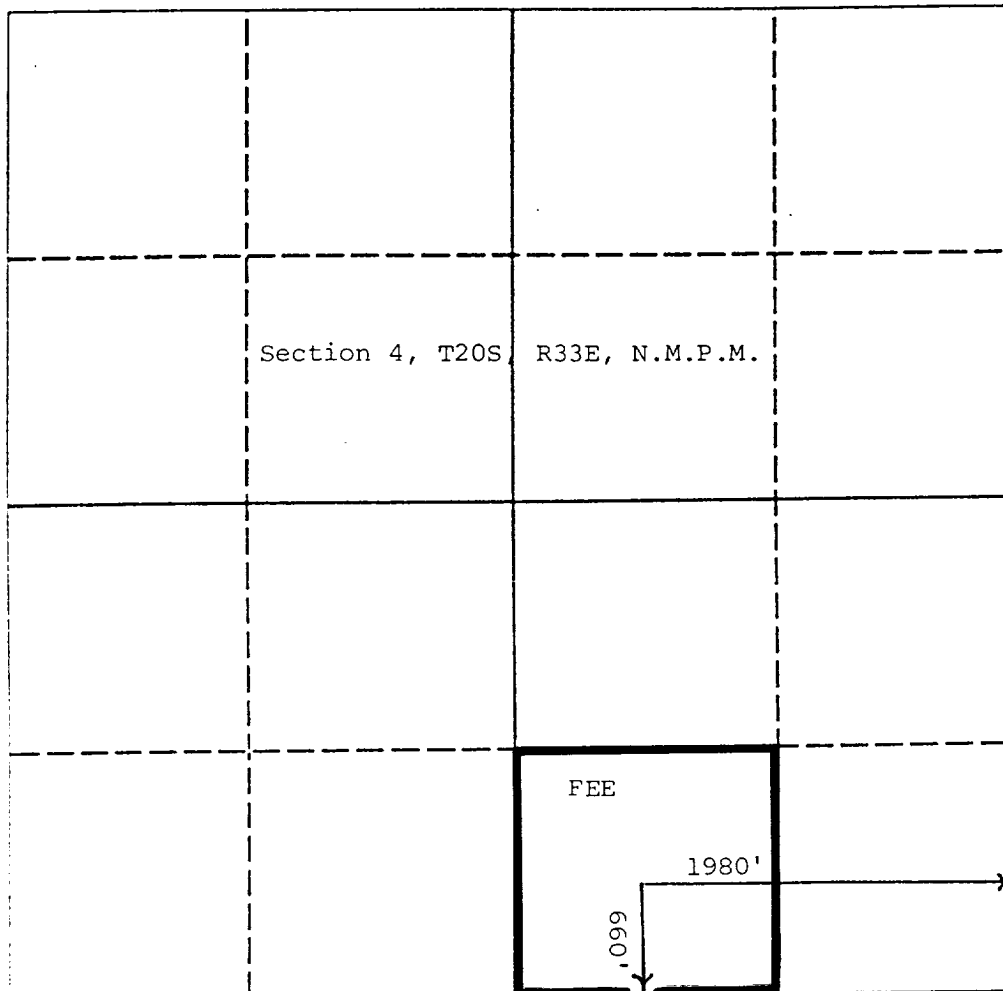

OPERATOR CERTIFICATION

I hereby certify that the information contained herein is true and complete to the best of my knowledge and belief.

Signature
George Mullen
Printed Name
George Mullen
Position
Reg. Affairs Specialist
Company
Mitchell Energy Corp.
Date
August 17, 1993

SURVEYOR CERTIFICATION

I hereby certify that the well location shown on this plat was plotted from field notes of actual surveys made by me or under my supervision, and that the same is true and correct to the best of my knowledge and belief.

Date Surveyed
9/15/92
Signature & Seal of
Professional Surveyor

Certificate No.
6290