

Submit to Appropriate  
District Office  
State Lease - 6 copies  
Fee Lease - 5 copies

State of New Mexico  
Energy, Minerals and Natural Resources Department

Form C-101  
Revised 1-1-89

OIL CONSERVATION DIVISION

P.O. Box 2088  
Santa Fe, New Mexico 87504-2088

DISTRICT I  
P.O. Box 1980, Hobbs, NM 88240

DISTRICT II  
P.O. Drawer DD, Artesia, NM 88210

DISTRICT III  
1000 Rio Brazos Rd., Aztec, NM 87410

API NO. (assigned by OCD on New Wells)

30-025-31933

5. Indicate Type of Lease

STATE ☒

FEE ☐

6. State Oil & Gas Lease No.

E-3290

APPLICATION FOR PERMIT TO DRILL, DEEPEN, OR PLUG BACK

1a. Type of Work:

DRILL ☒

RE-ENTER ☐

DEEPEN ☐

PLUG BACK ☐

b. Type of Well:

OIL  
WELL ☒

GAS  
WELL ☐

OTHER ☐

SINGLE  
ZONE ☒

MULTIPLE  
ZONE ☐

7. Lease Name or Unit Agreement Name

Mexico "U"

2. Name of Operator

Xeric Oil & Gas Company

8. Well No.

4

3. Address of Operator

P.O. Box 51311, Midland, TX 79710

9. Pool name or Wildcat

Hobbs (G-SA)

4. Well Location

Unit Letter B : 990 Feet From The North Line and 1650 Feet From The East Line

Section 8 Township 19-S Range 38-E NM:PM Lea County

10. Proposed Depth

4120'

11. Formation

Grayburg

12. Rotary or C.T.

rotary

13. Elevations (Show whether DF, RT, GR, etc.)

3600.7' GL

14. Kind & Status Plug. Boon

blanket-current

15. Drilling Contractor

CapStar Drilling

16. Approx. Date Work will start

April 1, 1993

17.

PROPOSED CASING AND CEMENT PROGRAM

| SIZE OF HOLE | SIZE OF CASING | WEIGHT PER FOOT | SETTING DEPTH | SACKS OF CEMENT | EST. TOP |
|--------------|----------------|-----------------|---------------|-----------------|----------|
| 12 1/4       | 8 5/8          | 24 lb           | 400'          | 290             | circ.    |
| 7 7/8        | 5 1/2          | 15.5 lb         | 4300'         | 1000            | circ.    |

Proposal:

- Drill to 4120' with rotary
- Set 400' of used 8 5/8 surface casing (23 lb) with enough sacks to circulate
- Set 4120' of used 5 1/2 casing (15.5 lb) with enough sacks to circulate

IN ABOVE SPACE DESCRIBE PROPOSED PROGRAM: IF PROPOSAL IS TO DEEPEN OR PLUG BACK, GIVE DATA ON PRESENT PRODUCTIVE ZONE AND PROPOSED NEW PRODUCTIVE ZONE. GIVE BLOWOUT PREVENTER PROGRAM, IF ANY.

I hereby certify that the information above is true and complete to the best of my knowledge and belief

SIGNATURE

TITLE

Owner

DATE

3-11-93

(915)

TYPE OR PRINT NAME

Randall L. Capps

TELEPHONE NO 683-3171

(This space for State Use)

ORIGINAL SIGNED BY JERRY SEXTON

APPROVED BY

TITLE

DATE

APR 01 1993

CONDITIONS OF APPROVAL, IF ANY:

Permit Expires 6 Months From Approval  
Date to Pass Drilling Underway.

RECEIVED

MAR 26 1993

OCD HOBBS OFFICE



301 BOYD, E  
ALLEN, TEXAS 75002

(214) 727-8367

P. O. BOX 589  
ALLEN, TEXAS 75002

In Texas (800) 442-5224

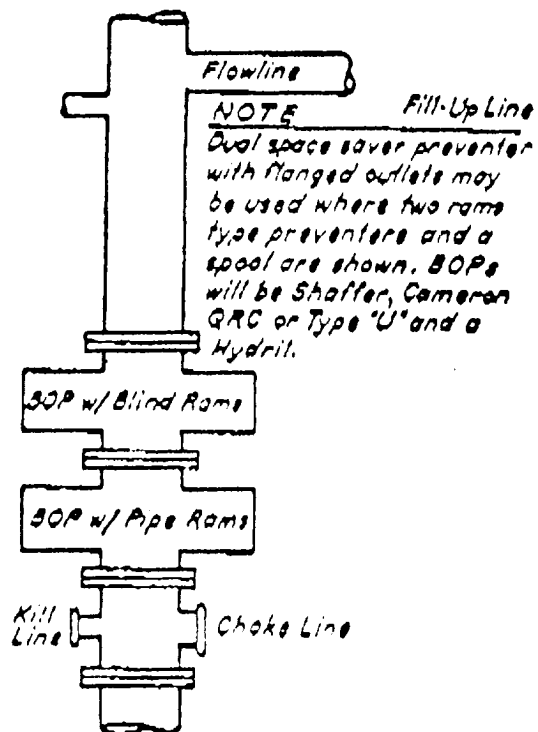

CASE I

BLOWOUT PREVENTER HOOKUP

3000# Working Pressure

## OIL CONSERVATION DIVISION

P.O. Box 2088  
Santa Fe, New Mexico 87504-2088

### DISTRICT I

P.O. Box 1980, Hobbs, NM 88240

### DISTRICT II

P.O. Drawer DD, Artesia, NM 88210

### DISTRICT III

1000 Rio Brazos Rd., Aztec, NM 87410

### WELL LOCATION AND ACREAGE DEDICATION PLAT

All Distances must be from the outer boundaries of the section

|   |  |                             |                            |      |                                       |
|---|--|-----------------------------|----------------------------|------|---------------------------------------|
| Operator<br><b>XERIC OIL &amp; GAS COMPANY</b>  |  |                             | Lease<br><b>MEXICO "U"</b> |      | Well No.<br><b>4</b>                  |
| Unit Letter<br><b>B</b>   | Section<br><b>8</b>                    | Township<br><b>19 SOUTH</b> | Range<br><b>38 EAST</b>    | NMPM | County<br><b>LEA</b>                  |
| Actual Footage Location of Well:<br><b>990</b> feet from the <b>NORTH</b> line and <b>1650</b> feet from the <b>EAST</b> line |  |                             |                            |      |                                       |
| Ground Level Elev.<br><b>3600.7'</b>  | Producing Formation<br><b>Grayburg</b> |                             | Pool<br><b>Hobbs GB/SA</b> |      | Dedicated Acreage:<br><b>40</b> Acres |

- Outline the acreage dedicated to the subject well by colored pencil or hatchure marks on the plat below.
- If more than one lease is dedicated to the well, outline each and identify the ownership thereof (both as to working interest and royalty).
- If more than one lease of different ownership is dedicated to the well, have the interest of all owners been consolidated by communitization, unitization, force-pooling, etc.?  
☐ Yes ☐ No If answer is "yes" type of consolidation \_\_\_\_\_  
If answer is "no" list of owners and tract descriptions which have actually been consolidated. (Use reverse side of this form necessary.)  
No allowable will be assigned to the well unit all interests have been consolidated (by communitization, unitization, forced-pooling, otherwise) or until a non-standard unit, eliminating such interest, has been approved by the Division.

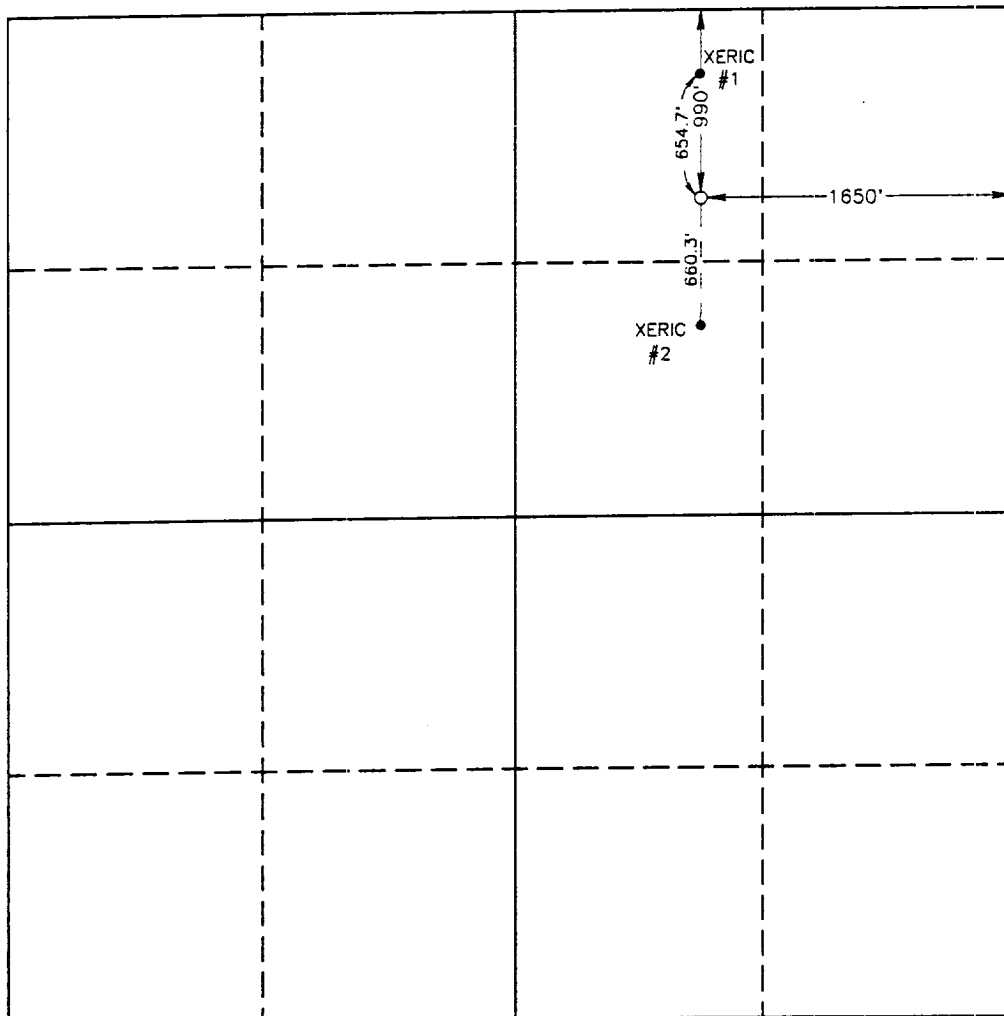

#### OPERATOR CERTIFICATION

I hereby certify that the information contained herein is true and complete to the best of my knowledge and belief.

Signature

Printed Name

Randall L. Capps

Position

Company

XERIC Oil & Gas Co

Date

3-26-93

#### SURVEYOR CERTIFICATION

I hereby certify that the well location shown on this plat was plotted from field notes of actual surveys made by me or under my supervision and that the same is true and correct to the best of my knowledge and belief.

Date Surveyed

MARCH 12, 1993

Signature & Seal of  
Professional Surveyor

Certificate No. JOHN W. WESLEY 676  
RONALD J. BOSON, 3239  
DARYL L. JONES, 7977

93-11-0418

5/11/83

RECEIVED

MAR 24 1993

3CD HOBBS OFFICE