

**OIL CONSERVATION DIVISION**

**DISTRICT I**  
P.O. Box 1980, Hobbs, NM 88240

**DISTRICT II**  
P.O. Drawer DD, Artesia, NM 88210

**DISTRICT III**  
1000 Rio Brazos Rd., Aztec, NM 87410

P.O. Box 2088  
Santa Fe, New Mexico 87504-2088

**WELL LOCATION AND ACREAGE DEDICATION PLAT**

All Distances must be from the outer boundaries of the section

Operator ARMSTRONG ENERGY CORP.			Lease MOBIL LEA STATE		Well No. 3
Unit Letter M	Section 2	Township 20 SOUTH	Range 34 EAST	NMPM	County LEA
Actual Footage Location of Well: 990 feet from the SOUTH line and 870 feet from the WEST line					
Ground Level Elev. 3662.2'	Producing Formation Delaware	Pool Lea Delaware N.E.		Dedicated Acreage: 40 Acres	

1. Outline the acreage dedicated to the subject well by colored pencil or hachure marks on the plat below.
  2. If more than one lease is dedicated to the well, outline each and identify the ownership thereof (both as to working interest and royalty).
  3. If more than one lease of different ownership is dedicated to the well, have the interest of all owners been consolidated by communitization, unitization, force-pooling, etc.?  
☐ Yes ☐ No If answer is "yes" type of consolidation \_\_\_\_\_
- If answer is "no" list of owners and tract descriptions which have actually been consolidated. (Use reverse side of this form necessary.) \_\_\_\_\_
- No allowable will be assigned to the well unit all interests have been consolidated (by communitization, unitization, forced-pooling, otherwise) or until a non-standard unit, eliminating such interest, has been approved by the Division.

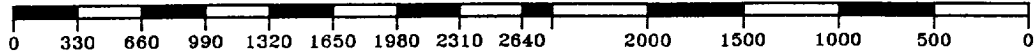
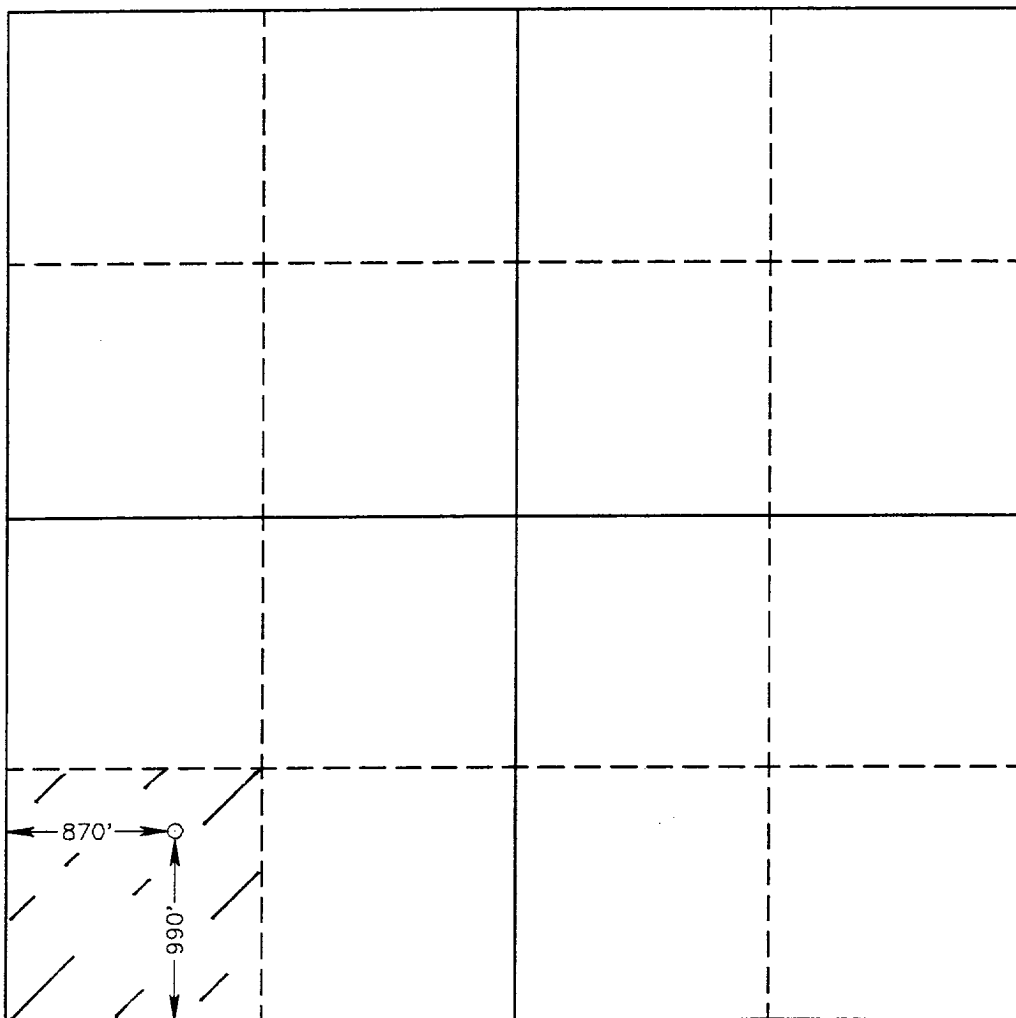

**OPERATOR CERTIFICATION**

I hereby certify the the information contained herein is true and complete to the best of my knowledge and belief.

Signature  
*Thomas K. Scroggin*  
Printed Name  
Thomas K. Scroggin  
Position  
Operations Supervisor  
Company  
Armstrong Energy Corp.  
Date  
June 7, 1993

**SURVEYOR CERTIFICATION**

I hereby certify that the well location shown on this plat was plotted from field notes of actual surveys made by me or under my supervision, and that the same is true and correct to the best of my knowledge and belief.

Date Surveyed  
JUNE 28, 1993  
Signature & Seal of Professional Surveyor  
7977  
Certificate No. JOHN W. WEST, 876  
RONALD J. EIDSON, 3239  
GARY L. JONES, 7977

93-11-1229

RECEIVED

JUL 3 1973

OCB 4751  
1973