

Submit to Appropriate  
District Office  
State Lease - 6 copies  
Fee Lease - 5 copies

State of New Mexico  
Energy, Minerals and Natural Resources Department

Form C-101  
Revised 1-1-89

OIL CONSERVATION DIVISION  
P.O. Box 2088  
Santa Fe, New Mexico 87504-2088

DISTRICT I  
P.O. Box 1980, Hobbs, NM 88240

DISTRICT II  
P.O. Drawer DD, Artesia, NM 88210

DISTRICT III  
1000 Rio Brazos Rd., Aztec, NM 87410

API NO. (assigned by OCD on New Wells) <b>3D-025-32393</b>
5. Indicate Type of Lease STATE <input checked="" type="checkbox"/> FEE <input type="checkbox"/>
6. State Oil & Gas Lease No. <b>A - 1375-39</b>
7. Lease Name or Unit Agreement Name <b>NORTH MONUMENT GRAYBURG SAN ANDRES BLK. 18 Unit <b>&lt;000452&gt;</b></b>
8. Well No. <b>28</b>
9. Pool name or Wildcat <b>&lt;23000&gt;</b> <b>FINICE MONUMENT G/SA</b>

APPLICATION FOR PERMIT TO DRILL, DEEPEN, OR PLUG BACK

1a. Type of Work: DRILL <input checked="" type="checkbox"/> RE-ENTER <input type="checkbox"/> DEEPEN <input type="checkbox"/> PLUG BACK <input type="checkbox"/>		7. Lease Name or Unit Agreement Name	
b. Type of Well: OIL WELL <input checked="" type="checkbox"/> GAS WELL <input type="checkbox"/> OTHER <input type="checkbox"/> SINGLE ZONE <input type="checkbox"/> MULTIPLE ZONE <input type="checkbox"/>		NORTH MONUMENT GRAYBURG SAN ANDRES BLK. 18 Unit <b>&lt;000452&gt;</b>	
2. Name of Operator <b>AMERADA HESS CORPORATION; ATTN: KEN WHITE <b>&lt;000495&gt;</b></b>		8. Well No. <b>28</b>	
3. Address of Operator <b>1201 LOUISIANA, STE 700 HOUSTON, TEXAS 77002</b>		9. Pool name or Wildcat <b>&lt;23000&gt;</b> <b>FINICE MONUMENT G/SA</b>	
4. Well Location Unit Letter <b>G</b> : <b>2,622</b> Feet From The <b>SOUTH <b>N</b></b> Line and <b>1,338</b> Feet From The <b>WEST</b> Line			
Section <b>2</b> Township <b>20S</b> Range <b>36E</b> NMPM LEA County			

10. Proposed Depth <b>4,080'</b>		11. Formation <b>GRAYBURG SAN ANDRES</b>		12. Rotary or C.T. <b>ROTARY</b>	
13. Elevations (Show whether DF, RT, GR, etc.) <b>3,582'</b>		14. Kind & Status Plug, Bond <b>BLANKET CURRENT</b>		15. Drilling Contractor <b>MC GEE</b>	
				16. Approx. Date Work will start <b>JANUARY 20, 1994</b>	

17. PROPOSED CASING AND CEMENT PROGRAM					
SIZE OF HOLE	SIZE OF CASING	WEIGHT PER FOOT	SETTING DEPTH	SACKS OF CEMENT	EST. TOP
12-1/4"	9-5/8"	36	400'	150	SURFACE
8-3/4"	7"	20	3,830'	700	SURFACE

DRILL 12-1/4" HOLE TO 400' AND SET 400' OF 36#- 9-5/8" SURF. CSG. CEMENT WITH 150 SX 65/85 POZ & CIRCULATE TO SURFACE.

DRILL 8-3/4" HOLE TO 3,830' AND SET 3,830' 20# 7" PRODUCTION CSG. CEMENT CSG. WITH 750 SX CLASS "C" & CIRCULATE TO SURFACE.

OPEN HOLE COMPLETION FROM 3,830' TO TD 4,080'.

Approval for drilling ONLY--cannot produce until Non-Standard Location is approved.

IN ABOVE SPACE DESCRIBE PROPOSED PROGRAM: IF PROPOSAL IS TO DEEPEN OR PLUG BACK, GIVE DATA ON PRESENT PRODUCTIVE ZONE AND PROPOSED NEW PRODUCTIVE ZONE. GIVE BLOWOUT PREVENTER PROGRAM, IF ANY.

I hereby certify that the information above is true and complete to the best of my knowledge and belief.

SIGNATURE *Ken White* TITLE SUPERVISOR, DRLG. ADMIN. SVS DATE 1-17-94  
(713)  
TELEPHONE NO. 752-5445

TYPE OR PRINT NAME KEN WHITE

(This space for State Use)

ORIGINAL SIGNED BY JERRY SEXTON  
DISTRICT I SUPERVISOR

APPROVED BY \_\_\_\_\_

TITLE \_\_\_\_\_

DATE

JAN 20 1994

CONDITIONS OF APPROVAL, IF ANY:

Permit Expires 6 Months From Approval  
Date Unless Drilling Underway.

Submit to Appropriate  
District Office  
State Lease - 4 copies  
Fee Lease - 3 copies

State of New Mexico  
Energy, Minerals and Natural Resources Department

Form C-102  
Revised 1-1-89

OIL CONSERVATION DIVISION

P.O. Box 2088  
Santa Fe, New Mexico 87504-2088

DISTRICT I  
P.O. Box 1980, Hobbs, NM 88240

DISTRICT II  
P.O. Drawer DD, Artesia, NM 88210

DISTRICT III  
1000 Rio Brazos Rd., Aztec, NM 87410

WELL LOCATION AND ACREAGE DEDICATION PLAT

All Distances must be from the outer boundaries of the section

Operator AMARADA HESS CORPORATION		Lease Replacement Well for AHC NMGSAU #1828		Well No. NMGSAU #1828
Unit Letter G	Section 2	Township 20 South	Range 36 East	County Lea
Actual Footage Location of Well: 1338 feet from the West line and 2622 feet from the South line				
Ground level Elev. 3582.2	Producing Formation GRAYBURG SAN ANDRES	Pool EUNICE MONUMENT G/SA	Dedicated Acreage: 40 Acres	

- Outline the acreage dedicated to the subject well by colored pencil or hatchure marks on the plat below.
- If more than one lease is dedicated to the well, outline each and identify the ownership thereof (both as to working interest and royalty).
- If more than one lease of different ownership is dedicated to the well, have the interest of all owners been consolidated by communitization, unitization, force-pooling, etc.?  
☐ Yes ☐ No If answer is "yes" type of consolidation UNITIZED ORDER #R-9494  
If answer is "no" list the owners and tract descriptions which have actually been consolidated. (Use reverse side of this form if necessary.)  
No allowable will be assigned to the well until all interests have been consolidated (by communitization, unitization, forced-pooling, or otherwise) or until a non-standard unit, eliminating such interest, has been approved by the Division.

OPERATOR CERTIFICATION

I hereby certify that the information contained herein is true and complete to the best of my knowledge and belief.

Signature  
*Ken White*  
Printed Name  
KEN WHITE  
Position  
SUPVSR DRLG. SVS  
Company  
AMERADA HESS CORP.  
Date  
01-17-94

SURVEYOR CERTIFICATION

I hereby certify that the well location shown on this plat was plotted from field notes of actual surveys made by me or under my supervision, and that the same is true and correct to the best of my knowledge and belief.

Date Surveyed  
1/6/94  
Signature & Seal of  
Professional Surveyor

*Neal D. King*  
Certificate No.  
6541

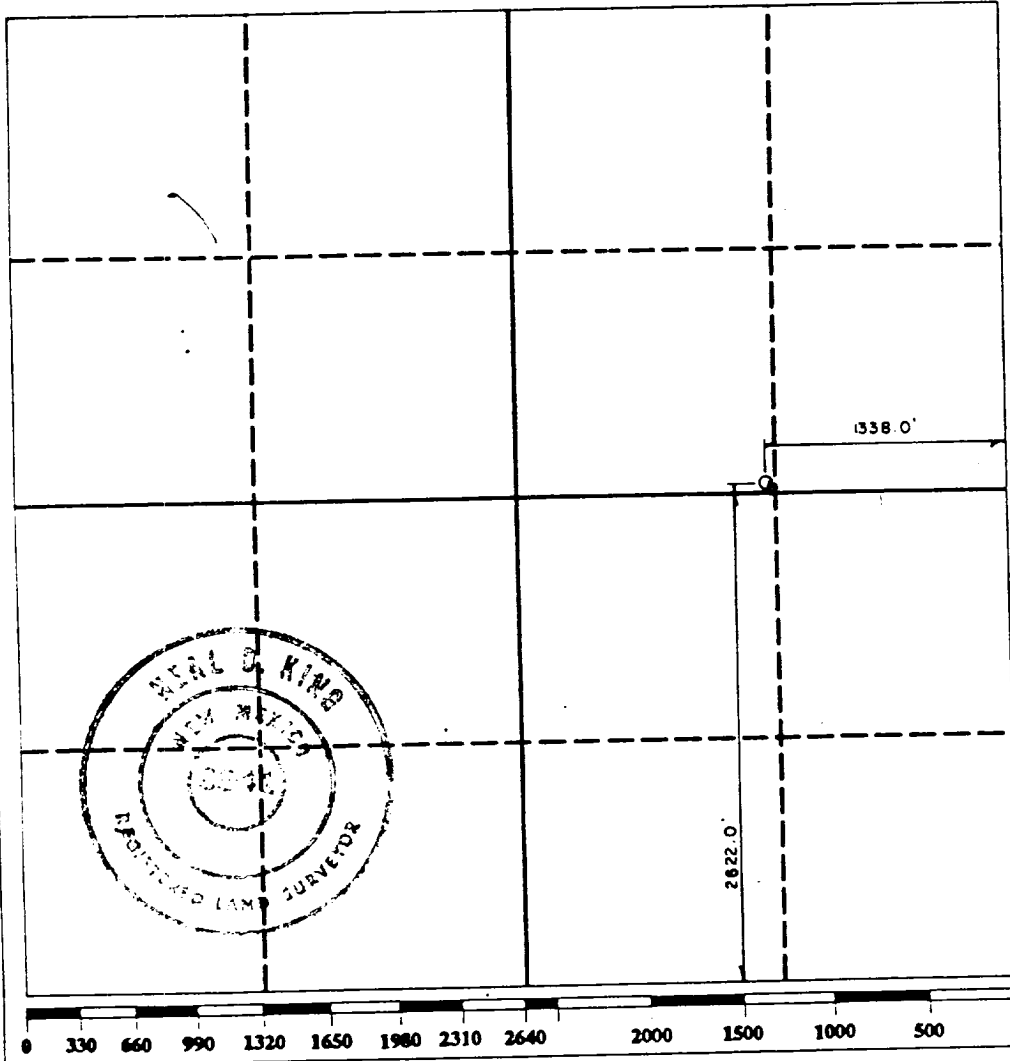

See Amended Plat

# B.O.P. STACK

3000# - 5000#

