

SECTION 19, TOWNSHIP 19 SOUTH, RANGE 37 EAST, N.M.P.M.  
LEA COUNTY, NEW MEXICO

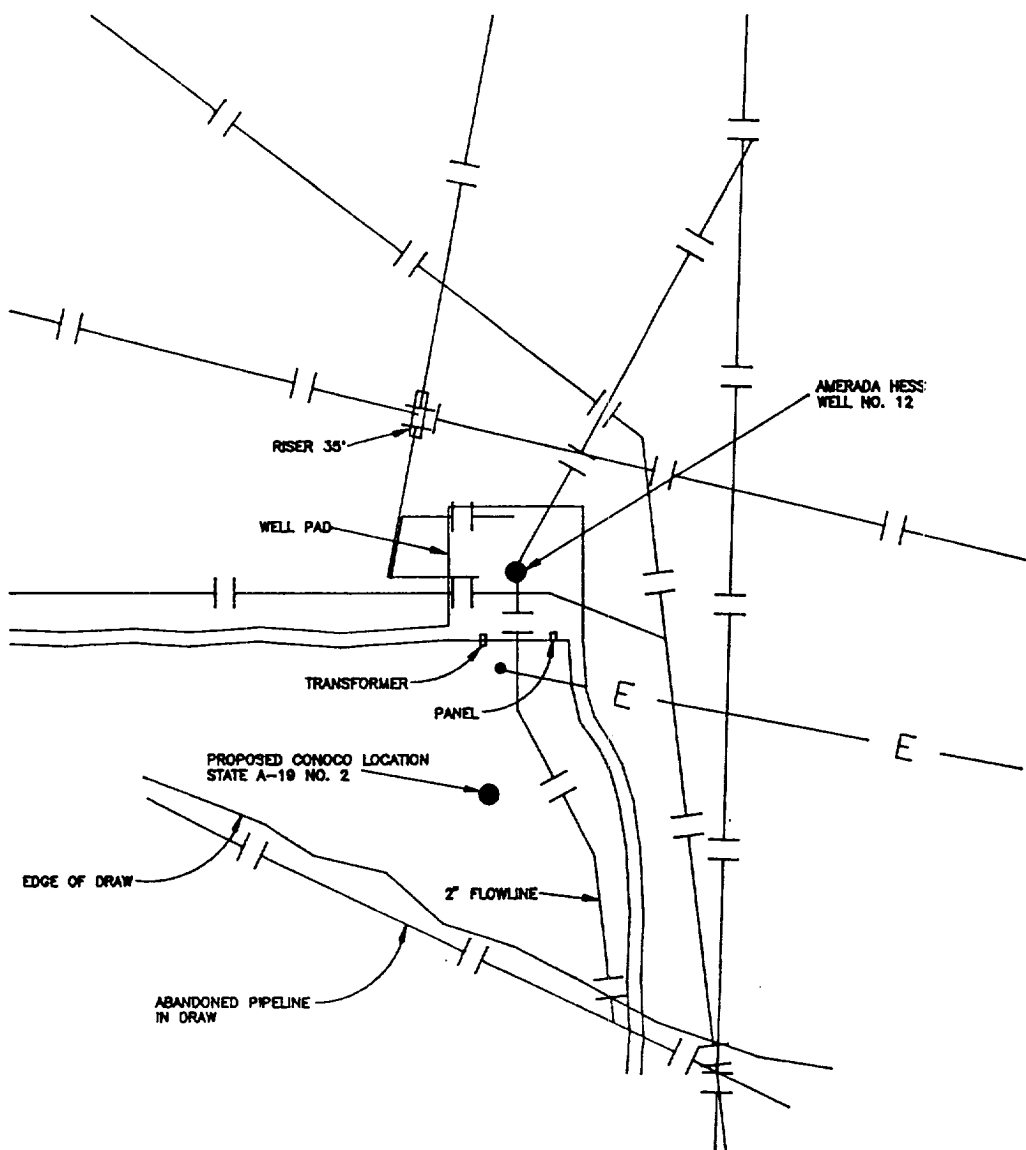

LEGEND

BURIED PIPELINE ————  
ELECTRIC LINE ABOVE GROUND —E—E—

I hereby certify that this plat was prepared from an actual survey made on the ground and meets or exceeds all requirements for land surveys as specified by the state of New Mexico.

*Earl Foote*



Earl Foote  
Registered Professional Surveyor  
New Mexico Certificate No. 8278

CONOCO, INC.

Obstructions around or near Proposed Conoco Well  
Location State A-19 No. 2 in Section 19, T-19-S, R-37-E,  
N.M.P.M. Lea County, New Mexico

WEST TEXAS CONSULTANTS, INC.

ENGINEERS-PLANNERS-SURVEYORS

MIDLAND, TEXAS

Survey Date: 8-16-94	Date: 8-23-94	Scale: 1" = 200'
WTC No. 43815	Drawn By: R.S.	Sheet 1 of 1

EXHIBIT C