

DISTRICT I
P.O. Box 1980, Hobbs, NM 88241-1980
DISTRICT II
P.O. Box Drawer DD, Artesia, NM 88211-0719
DISTRICT III
1000 Rio Brazos Rd., Aztec, NM 87410
DISTRICT IV
P.O. Box 2088, Santa Fe, NM 87504-2088

State of New Mexico
Energy, Minerals and Natural Resources Department

OIL CONSERVATION DIVISION

P.O. Box 2088
Santa Fe, New Mexico 87504-2088

Form C-101
Revised February 10, 1994
Instructions on back
Submit to Appropriate District Office
State Lease - 6 Copies
Fee Lease - 5 Copies
☒ AMENDED REPORT

APPLICATION FOR PERMIT TO DRILL, RE-ENTER, DEEPEN, PLUGBACK, OR ADD A ZONE

| | | | | |
|--|--|--|--|---|
| ¹ Operator Name and Address TEXACO EXPLORATION & PRODUCTION INC. 205 E. Bender, HOBBS, NM 88240 | | Permit Expires 1 Year From Approval Date Unless Drilling Underway | | ² OGRID Number 022351 |
| ⁴ Property Code 010885 | | ⁵ Property Name ANDERSON, T. | | ³ API Number 30 025 33296 |
| ⁶ Well No. 5 | | | | |

| ⁷ Surface Location | | | | | | | | | |
|-------------------------------|---------|----------|-------|---------|---------------|------------------|---------------|----------------|--------|
| Ul or lot no. | Section | Township | Range | Lot.Idn | Feet From The | North/South Line | Feet From The | East/West Line | County |
| I | 8 | 20S | 37E | | 1650' | SOUTH | 430' | EAST | LEA |

| ⁸ Proposed Bottom Hole Location If Different From Surface | | | | | | | | | |
|--|---------|----------|-------|---------|-------------------------------|------------------|---------------|----------------|--------|
| Ul or lot no. | Section | Township | Range | Lot.Idn | Feet From The | North/South Line | Feet From The | East/West Line | County |
| ⁹ Proposed Pool 1 MONUMENT PADDOCK | | | | | ¹⁰ Proposed Pool 2 | | | | |

| | | | | |
|-----------------------------------|----------------------------------|------------------------------------|-------------------------------------|--|
| ¹¹ Work Type Code P | ¹² WellType Code O | ¹³ Rotary or C.T. R | ¹⁴ Lease Type Code S | ¹⁵ Ground Level Elevation 3543' GL |
| ¹⁶ Multiple No | ¹⁷ Proposed Depth | ¹⁸ Formation PADDOCK | ¹⁹ Contractor Unknown | ²⁰ Spud Date 12/30/98 |

| ²¹ Proposed Casing and Cement Program | | | | | |
|--|----------------|-----------------|---------------|-----------------|----------|
| SIZE OF HOLE | SIZE OF CASING | WEIGHT PER FOOT | SETTING DEPTH | SACKS OF CEMENT | EST. TOP |
| 11" | 8 5/8 | 24# | 1150' | 500 sx | |
| 7 7/8" | 7 7/8" | 15.5 & 17# | 5850' | 1650 sx | |
| | | | | | |
| | | | | | |
| | | | | | |

²² Describe the proposed program. If this application is to DEEPEN or PLUG BACK give the data on the present productive zone and proposed new productive zone. Describe the blowout prevention program, if any. Use additional sheets if necessary.

TEXACO INTENDS TO SET A CIBP ABOVE THE BLINEBRY PERFS, AND COMMINGLE PADDOCK & BLINEBRY ZONES.
THE INTENDED PROCEDURE IS AS FOLLOWS:

1. MIRU. TOH W/RDS & PMP. INSTL BOP. TIH W/BIT & CSG SCRAPER TO 5850'.
2. SET CIBP ABOVE BLINEBRY PERFS @ 5510'. RU FULL LUBRICATOR W/PACKOFF. TIH W/CSG GUN & PERF 5142-5230'.
3. TIH W/TRTNG PKR ON TBG. TEST TBG ABOVE SLIPS TO 5000 PSI. PSA 5000'. OPEN BYPASS & SPOT ACID TO PKR. ACIDIZE PERFS W/1800 GALS 15% NEFE HCL. FLOW OR SWAB BACK LOAD.
4. REL PKR & TOH W/TBG & PKR & TIH W/PMP EQPT & PLACE WELL ON TEST.
5. OBTAIN DHC PERMIT TO COMMINGLE BLINEBRY W/PADDOCK AFTER PROD RATES STABILIZE FROM THE PADDOCK.
6. MIRU PU & PULL PROD EQPT. TIH W/BIT, DC'S & TBG. DRILL UP CIBP. PSH JUNK TO 5833'. TIH W/TRTNG PKR & SET @ 5500'. SI 2 HR. FLOW BACK LOAD. REL PKR & TOH W/TBG & PKR. TIH W/PMPNG EQPT & PLACE WELL ON TEST.

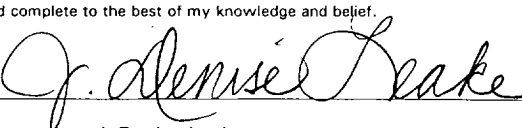
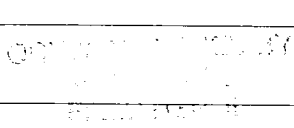
| | | | |
|--|--------------------|--|------------------|
| ²³ I hereby certify that the rules and regulations of the Oil Conservation Division have been complied with and that the information given above is true and complete to the best of my knowledge and belief. | | OIL CONSERVATION DIVISION | |
| Signature  | | Approved By:  | |
| Printed Name J. Denise Leake | | Title: | |
| Title Engineering Assistant | | Approval Date DEC 29 1998 | Expiration Date: |
| Date 12/22/98 | Telephone 397-0405 | Conditions of Approval: Attached <input type="checkbox"/> | |

DISTRICT I

P.O. Box 1980, Hobbs, NM 88241-1980

DISTRICT II

P.O. Box Drawer DD, Artesia, NM 88211-0719

DISTRICT III

1000 Rio Brazos Rd., Aztec, NM 87410

DISTRICT IV

P.O. Box 2088, Santa Fe, NM 87504-2088

State of New Mexico

Energy, Minerals and Natural Resources Department

OIL CONSERVATION DIVISION

P.O. Box 2088

Santa Fe, New Mexico 87504-2088

Form C-102

Revised February 10, 1994

Instructions on back

Submit to Appropriate District Office

State Lease - 4 Copies

Fee Lease - 3 Copies

☐ AMENDED REPORT

WELL LOCATION AND ACREAGE DEDICATION PLAT

| | | |
|---|--|--|
| ¹ API Number 30 025 33296 | ² Pool Code 47080 | ³ Pool Name MONUMENT PADDOCK |
| ⁴ Property Code 010885 | ⁵ Property Name ANDERSON, T. | ⁶ Well No. 5 |
| ⁷ OGRID Number 022351 | ⁸ Operator Name TEXACO EXPLORATION & PRODUCTION INC. | ⁹ Elevation 3543' GL |

¹⁰ Surface Location

| Ul or lot no. | Section | Township | Range | Lot.Idn | Feet From The | North/South Line | Feet From The | East/West Line | County |
|---------------|---------|----------|-------|---------|---------------|------------------|---------------|----------------|--------|
| I | 8 | 20S | 37E | | 1650' | SOUTH | 430' | EAST | LEA |

¹¹ Bottom Hole Location If Different From Surface

| Ul or lot no. | Section | Township | Range | Lot.Idn | Feet From The | North/South Line | Feet From The | East/West Line | County |
|---------------|---------|----------|-------|---------|---------------|------------------|---------------|----------------|--------|
|---------------|---------|----------|-------|---------|---------------|------------------|---------------|----------------|--------|

| | | | |
|-------------------------------------|-------------------------------------|----------------------------------|-------------------------|
| ¹² Dedicated Acres 40 | ¹³ Joint or Infill No | ¹⁴ Consolidation Code | ¹⁵ Order No. |
|-------------------------------------|-------------------------------------|----------------------------------|-------------------------|

NO ALLOWABLE WILL BE ASSIGNED TO THIS COMPLETION UNTIL ALL INTERESTS HAVE BEEN CONSOLIDATED
OR A NON-STANDARD UNIT HAS BEEN APPROVED BY THE DIVISION

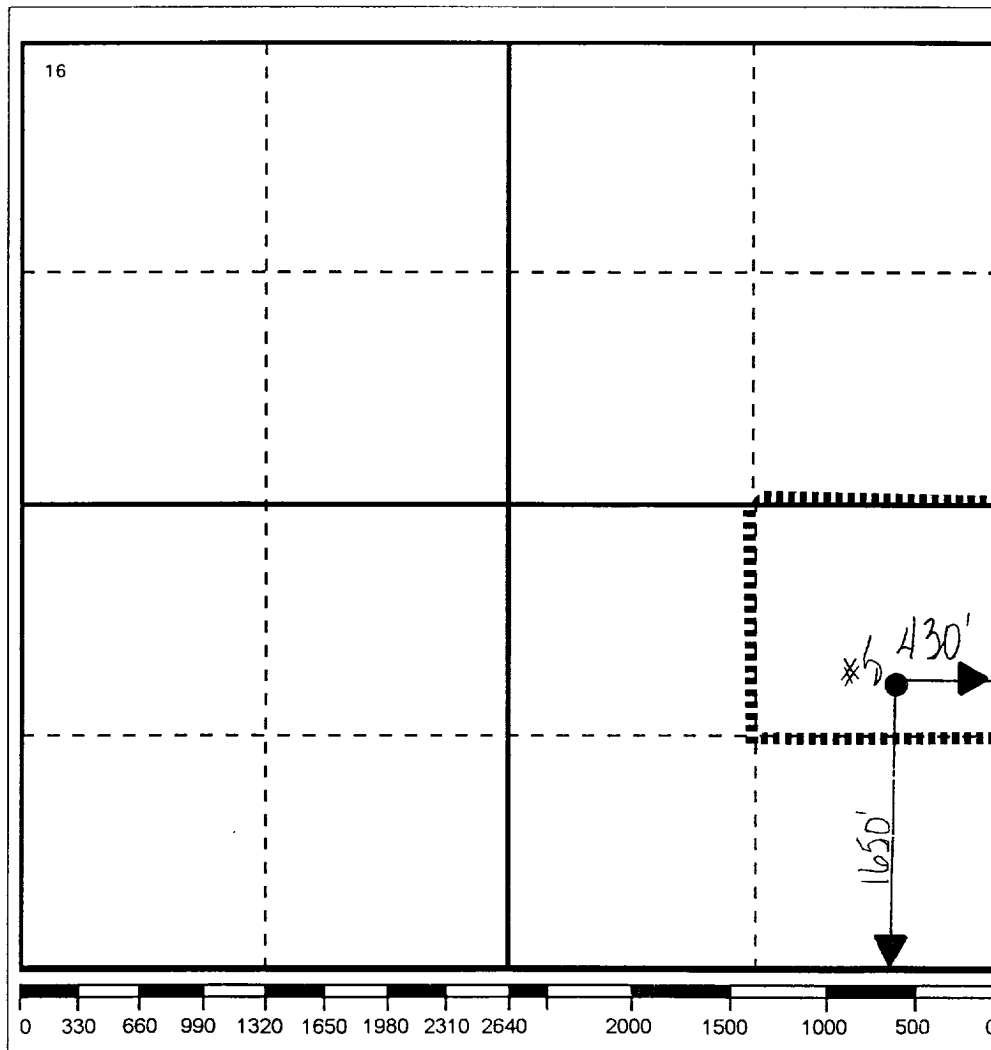

17 OPERATOR CERTIFICATION

I hereby certify that the information contained herein is true and complete to the best of my knowledge and belief

Signature

J. Denise Leake

Printed Name

J. Denise Leake

Position

Engineering Assistant

Date

12/22/98

18 SURVEYOR CERTIFICATION

I hereby certify that the well location shown on this plat was plotted from field notes of actual surveys made by me or under my supervision, and that the same is true and correct to the best of my knowledge and belief.

Date Surveyed

Signature & Seal of
Professional Surveyor

Certificate No.