

170665

DISTRICT I
P. O. Box 1980, Hobbs, NM 88240

DISTRICT II
P. O. Drawer DD, Artesia, NM 88210

DISTRICT III
1000 Rio Brazos Rd., Aztec, NM 87410

DISTRICT IV
P. O. Box 2088, Santa Fe, NM 87504-2088

State of New Mexico
Energy, Minerals and Natural Resources Department

OIL CONSERVATION DIVISION
PO Box 2088
Santa Fe, NM 87504-2088

Form C-102
Revised February 10, 1994

Instructions on back

Submit to Appropriate District Office

State Lease-4 copies
Fee Lease-3 copies

WELL LOCATION AND ACREAGE DEDICATION PLAT

☐ AMENDED REPORT

¹ API Number 30-025-33306		² Pool Code 46990		³ Pool Name Monument, Blinebry, Paddock	
⁴ Property Code 11059		⁵ Property Name J. R. Phillips			
⁶ GRID No. 22351		⁷ Operator Name TEXACO EXPLORATION & PRODUCTION, INC.			
				⁸ Well Number 13	⁹ Elevation 3567'

¹⁰ Surface Location									
UL or lot no. E	Section 6	Township 20-S	Range 37-E	Lot Idn	Feet from the 1700'	North/South line North	Feet from the 940'	East/West line West	County Lea

¹¹ Bottom Hole Location If Different From Surface									
UL or lot no. -D	Section 6	Township 20-S	Range 37-E	Lot Idn	Feet from the 330'	North/South line North	Feet from the 330'	East/West line West	County Lea

¹² Dedicated Acres 80	¹³ Joint or Infill	¹⁴ Consolidation Code	¹⁵ Order No.
-------------------------------------	-------------------------------	----------------------------------	-------------------------

NO ALLOWABLE WILL BE ASSIGNED TO THIS COMPLETION UNTIL ALL INTERESTS HAVE BEEN CONSOLIDATED
OR A NON-STANDARD UNIT HAS BEEN APPROVED BY THE DIVISION.

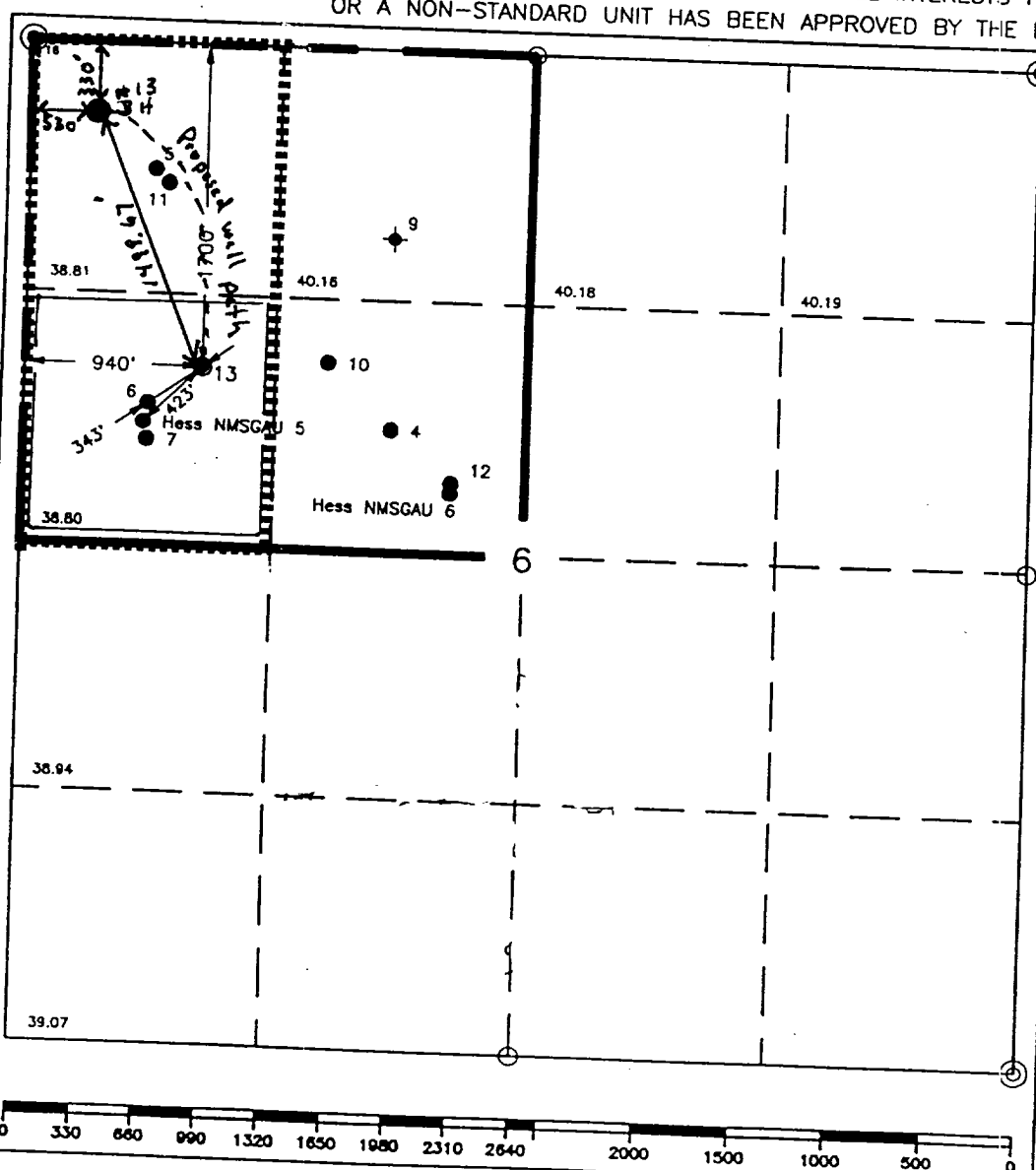

¹⁶ OPERATOR CERTIFICATION	
I hereby certify that the information contained herein is true and complete to the best of my knowledge and belief.	
Signature	<i>Paula S. Ives</i>
Printed Name	Paula S. Ives
Position	Engineer's Assistant
Company	Texaco Expl. & Prod. Inc.
Date	December 8, 1997

¹⁷ SURVEYOR CERTIFICATION	
I hereby certify that the well location shown on this plat was plotted from field notes of actual surveys made by me or under my supervision, and that the same is true and correct to the best of my knowledge and belief.	
Date Surveyed	February 22, 1996
Signature & Seal of Professional Surveyor	<i>John S. Piper</i>
Certificate No.	7254 John S. Piper
Sheet	