

N.M. OIL COM. COM  
P.O. BOX 1900  
HOBBS, NEW MEXICO  
DEPARTMENT OF  
BUREAU OF LAND

OPER. OGRID NO. 21602  
PROPERTY NO. 18738  
POOL CODE 82160  
EFF. DATE 3/19/96  
API NO. 30-025-3334

Form approved.  
Budget Bureau No. 1004-0136  
Expires: December 31, 1991

**APPLICATION FOR PERM**

1a. TYPE OF WORK

DRILL ☒

DEEPEN ☐

b. TYPE OF WELL

OIL WELL ☐

GAS WELL ☒

OTHER ☐

2. NAME OF OPERATOR

Stevens & Tull, Inc.

915/699-1410

3. ADDRESS AND TELEPHONE NO.

P. O. Box 11005

Midland, TX 79702

4. LOCATION OF WELL (Report location clearly and in accordance with any State requirements.)

At surface

1650' FNL & 1650' FWL

At proposed prod. zone

Same

14. DISTANCE IN MILES AND DIRECTION FROM NEAREST TOWN OR POST OFFICE\*

22.5 SW of Hobbs, NM

15. DISTANCE FROM PROPOSED\*

LOCATION TO NEAREST  
PROPERTY OR LEASE LINE, FT.  
(Also to nearest drig. unit line, if any)

330'

18. DISTANCE FROM PROPOSED LOCATION\*  
TO NEAREST WELL, DRILLING, COMPLETED,  
OR APPLIED FOR, ON THIS LEASE, FT.

N/A

16. NO. OF ACRES IN LEASE

1360

19. PROPOSED DEPTH

11,400'

17. NO. OF ACRES ASSIGNED  
TO THIS WELL

Com.  
Farmout- 440 (640)

20. ROTARY OR CABLE TOOLS

Rotary

21. ELEVATIONS (Show whether DF, RT, GR, etc.)

3602' GL

22. APPROX. DATE WORK WILL START\*

February 21, 1996

23.

PROPOSED CASING AND CEMENTING PROGRAM

Lea County Controlled Water Basin

SIZE OF HOLE	GRADE SIZE OF CASING	WEIGHT PER FOOT	SETTING DEPTH	QUANTITY OF CEMENT
17 1/2"	13 3/8" K-55	54.5#	1,365'	Circ. 1120 sx "C"
12 1/4"	9 5/8" K-55	36 & 40# N-80	5,505'	Circ. 1730 sx "C"
8 3/4"	7" S-95	26.0#	10,800'	Tieback w/1045 sx "C"
6 1/2"	4 1/2" N-80	11.6#	11,400'	Tieback w/165 sx "H"

Mud Program:

	Mud Wt.	Vis.	W/L Control
0' - 1,365': Fresh water Gel spud mud:	8.6- 9.3 ppg	32 - 34	No W/L control.
1,365' - 5,505': Brinewater:	10.0-10.1 ppg	28 - 30	No W/L control.
5,505' - 10,000': Fresh water:	8.4- 8.5 ppg	28 - 29	No W/L control.
10,000' - 10,800': Brinewater:	9.2- 9.5 ppg	28 - 34	W/L cont. 10-12cc.
10,800' - 11,400': Brinewater:	9.8-12.0 ppg	32 - 48	W/L cont. <6-8 cc.

BOP Program:

A 3000 psi wp 12" Shaffer LWS BOP and Annular will be installed on the 13 3/8" casing, to be used to a depth 5,505 feet. A 5000 psi wp 11" Schaffer "LWS" BOP, will be installed on the 9 5/8" casing. Casing and BOP will be tested before drilling out and will be tested daily.

Approval Subject to  
General Requirements and  
Special Stipulations  
Attached

Gas not dedicated.

IN ABOVE SPACE DESCRIBE PROPOSED PROGRAM: If proposal is to deepen, give data on present productive zone and proposed new productive zone. If proposal is to drill or deepen directionally, give pertinent data on subsurface locations and measured and true vertical depths. Give blowout preventer program, if any.

24.

Agent for:

SIGNED William R. Smith TITLE Stevens & Tull, Inc. DATE Jan 30, 1996

(This space for Federal or State office use)

PERMIT NO. \_\_\_\_\_

APPROVAL DATE \_\_\_\_\_

Application approval does not warrant or certify that the applicant holds legal or equitable title to those rights in the subject lease which would entitle the applicant to conduct operations thereon.

CONDITIONS OF APPROVAL, IF ANY:

ASSISTANT AREA MANAGER

APPROVED BY /s/ Yolanda Vega TITLE \_\_\_\_\_ DATE 3-11-96

\*See Instructions On Reverse Side



DISTRICT I  
P.O. Box 1980, Hobbs, NM 88241-1980

State of New Mexico  
Energy, Minerals and Natural Resources Department

Form C-102  
Revised February 10, 1994  
Submit to Appropriate District Office  
State Lease - 4 Copies  
Fee Lease - 3 Copies

DISTRICT II  
P.O. Drawer DD, Artesia, NM 88211-0719

DISTRICT III  
000 Rio Brazos Rd., Aztec, NM 87410

DISTRICT IV  
P.O. Box 2088, Santa Fe, N.M. 87504-2088

## OIL CONSERVATION DIVISION

P.O. Box 2088  
Santa Fe, New Mexico 87504-2088

☐ AMENDED REPORT

### WELL LOCATION AND ACREAGE DEDICATION PLAT

API Number 30 025-33346	Pool Code 82160	Pool Name OSUDO Asudo Morrow, North
Property Code 18738	Property Name OSUDO "21" FEDERAL COM	Well Number 1
OGRID No. 21602	Operator Name STEVENS & TULL	Elevation 3602

#### Surface Location

UL or lot No.	Section	Township	Range	Lot Idn	Feet from the	North/South line	Feet from the	East/West line	County
F	21	20 S	36 E		1650	NORTH	1650	WEST	LEA

#### Bottom Hole Location If Different From Surface

UL or lot No.	Section	Township	Range	Lot Idn	Feet from the	North/South line	Feet from the	East/West line	County

Dedicated Acres 640	Joint or Infill	Consolidation Code	Order No.
------------------------	-----------------	--------------------	-----------

NO ALLOWABLE WILL BE ASSIGNED TO THIS COMPLETION UNTIL ALL INTERESTS HAVE BEEN CONSOLIDATED  
OR A NON-STANDARD UNIT HAS BEEN APPROVED BY THE DIVISION

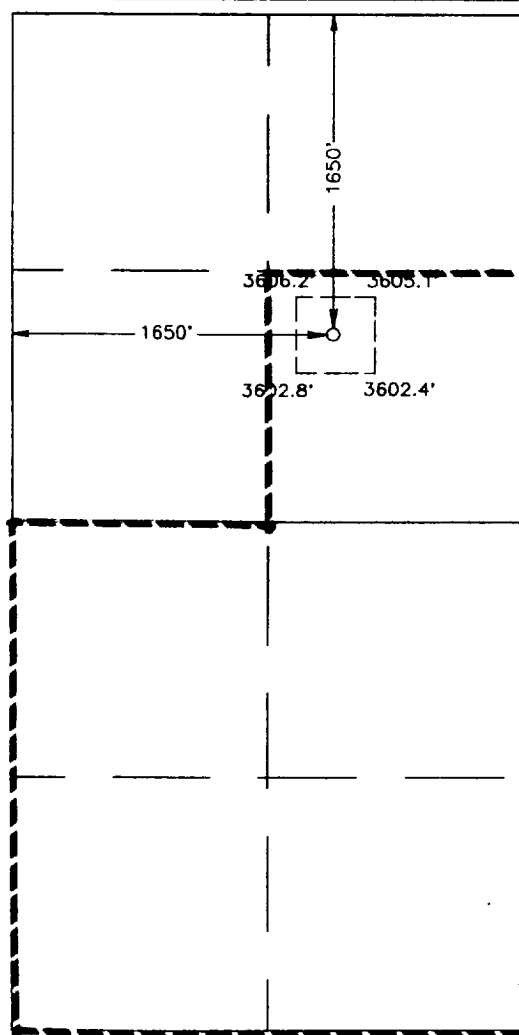
	<p>NM-18264 Warrior, Inc. Etal</p> <p>NM-89873 Conoco, etal</p>	<h4>OPERATOR CERTIFICATION</h4> <p>I hereby certify the the information contained herein is true and complete to the best of my knowledge and belief.</p> <p><u>George R. Smith</u> Signature</p> <p>George R. Smith, agent for: Printed Name</p> <p>Stevens &amp; Tull, Inc. Title</p> <p>January 30, 1996 Date</p> <h4>SURVEYOR CERTIFICATION</h4> <p>I hereby certify that the well location shown on this plat was plotted from field notes of actual surveys made by me or under my supervision, and that the same is true and correct to the best of my belief.</p> <p>JANUARY 18, 1996 Date Surveyed</p> <p>Signature: J. Eidson Professional Surveyor NEW MEXICO 1-29-96 P.O. Num. 96-0078</p> <p>Cert. No. 676 J. EIDSON 12641</p>
---	---	---



# APPLICATION FOR DRILLING

STEVENS & TULL, INC.  
Asudo "21" Federal Com., Well No. 1  
1650' FNL & 1650 FWL, Sec. 21-T20S-R36E  
Lea County, New Mexico  
Lease No.: NM-89873  
(Development Well)

In conjunction with Form 3160-3, Application for Permit to Drill subject well, Stevens & Tull, Inc. submits the following items of pertinent information in accordance with BLM requirements:

1. The geologic surface formation is recent Permian with quaternary alluvium and other surficial deposits.
2. The estimated tops of geologic markers are as follows:

Anhydrite	1725'	Wolfcamp	9.800'
Base/Salt	3250'	Strawn	10.452'
Delaware	5510'	Atoka	10.650'
Top Bone Spring	6920'	Morrow	11.050'
1st B. Spring Sand	8020'	T.D.	11.400'
2nd B. Spring Sand	8655'		
3. The estimated depths at which water, oil or gas formations are anticipated to be encountered:

Water: Surface water between 100' - 350'.  
Oil: Possible in the Delaware and Bone Spring.  
Gas: Possible in Atoka and Morrow.
4. Proposed Casing Program: See Form 3160-3 and page 2.
5. Proposed Control Equipment: See Form 3160-3 and Exhibit "E".
6. Mud Program: See Form 3160-3.
7. Auxiliary Equipment: Blowout Preventer, gas detector, Kelly cock, pit level monitor, flow sensors and stabbing valve.
8. Testing, Logging, and Coring Program:

Drill Stem Tests: Possible in the Devonian.  
Logging: Gamma Ray: CNL-LDT, DLL-MFL  
Coring: None planned.

Surf. Csg. to T.D.  
Below 8 5/8" to T.D.
9. No abnormal pressures or temperatures are anticipated. In the event abnormal pressures are encountered the proposed mud program will be modified to increase the mud weight. Estimated BHP = 4560 psi (Evc. Hole), Temp. = 182°.
- 9a. H<sub>2</sub>S: None expected, based on wells drilled in the area.
10. Anticipated starting date: February 20, 1996.  
Anticipated completion of drilling operations: Approximately 8 weeks.

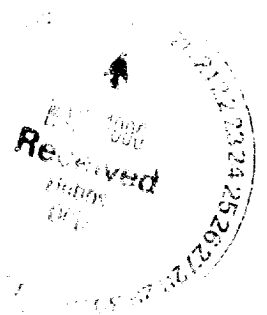

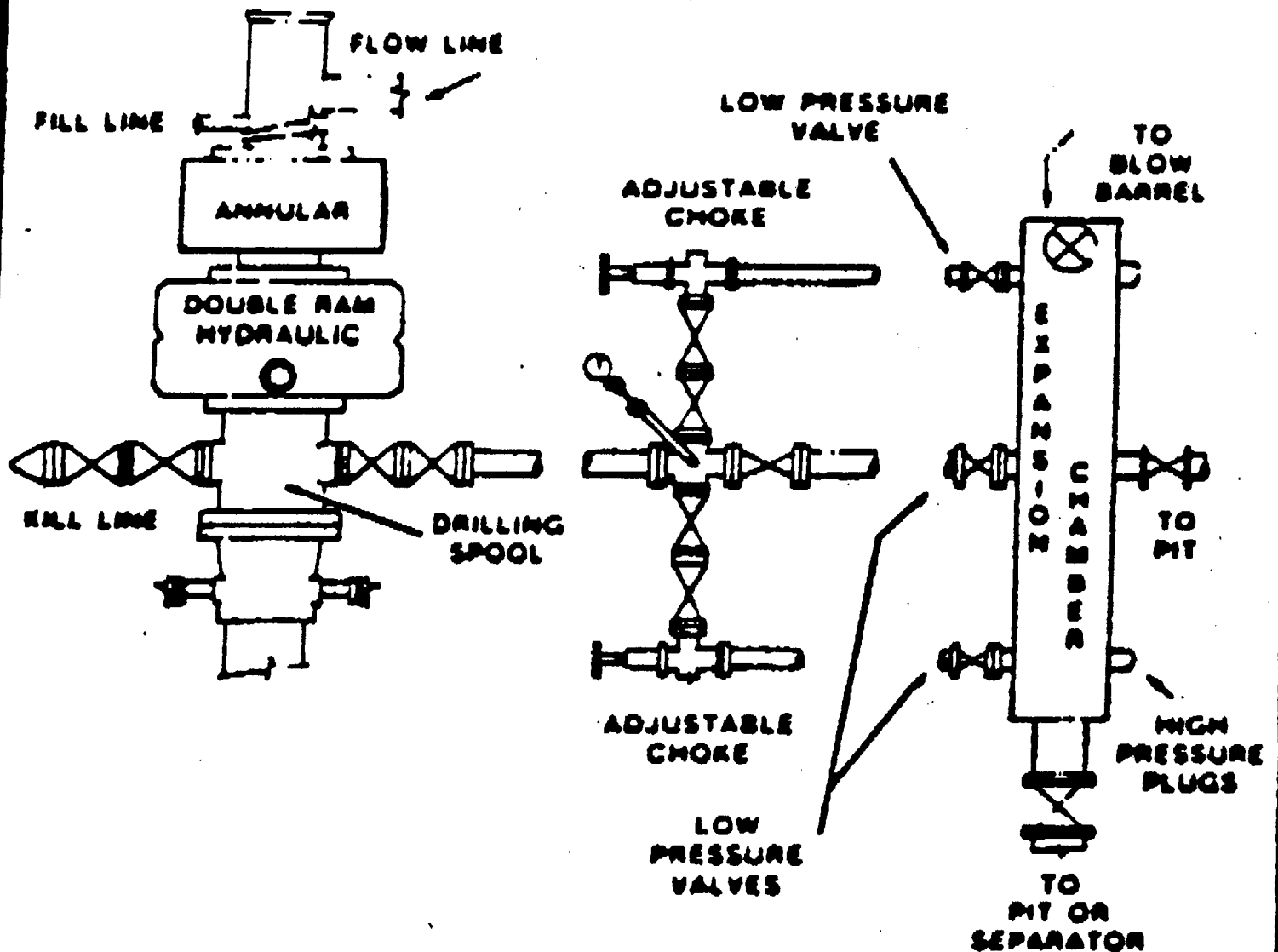

## Standard Blowout Preventer Stack

EXHIBIT "E"  
 STEVENS & TULL, INC.  
 Asudo "21" Federal Com., Well No. 1  
 BOP Specifications

6/21/97  
J73

