



Forward to Halls OCD

RECEIVED
DEC 11 1996
10 52

December 4, 1996

State of New Mexico
Energy, Minerals & Natural Resources Department
Oil Conservation Division
2040 S. Pacheco
Santa Fe, New Mexico 87505

Attention: Mr. William J. Lemay, Division Director

RE: Application for Permit to Drill, APD;

Stevens & Tull, Inc.
Conoco State #2
990' FNL & 990' FWL
Sec. 16, T-20-S, R-33-E, NMPM
Lea County, New Mexico
Salt Lake Project

Dear Mr. Lemay:

Mississippi Potash Corporation has been contacted by Stevens & Tull, Inc., an oil and gas producing company, regarding an application for permit to drill the above referenced oil well.

It is hereby noted that this drilling location is within the Known Potash Area (KPA), as designated by OCD Order R-111-P.

Under the provisions set forth in Division Order R-111-P and in the spirit of cooperation between our two industries, Mississippi Potash Corporation, in conjunction with New Mexico Potash and National Potash, offer no objections to the drilling location proposed by Stevens & Tull, Inc. referenced above.

Due to the proximity of our mining operations and future plans to recover potash reserves in this area, strict observance of the casing requirements as outlined in Division Order R-111-P is mandatory. Please contact me if you have any additional questions.

Sincerely,

Mel Pyeatt
Mine Operations Manager

copies: File
Mr. Jerry A. Weant, Landman, Stevens & Tull, Inc.

P.O. Box 101 • 1996 Potash Mines Road • Carlsbad, New Mexico 88220
Phone (505) 887-5591 • FAX (505) 887-0705



STEVENS & TULL, INC.

P. O. Box 11005

MIDLAND, TEXAS 79702

915/699-1410

November 19, 1996

Mississippi Potash, Inc.
P.O. Box 101
Carlsbad, N.M. 88220

IMC Global Operations, Inc.
P.O. Box 71
Carlsbad, N.M. 88221

New Mexico Potash Corporation
P.O. Box 610
Hobbs, New Mexico 88240

Re: Application to Drill
Conoco State #2,
990' FN & WL Sec. 16,
T-20-S, R-33-E, N.M.P.M.,
Lea County, New Mexico
Salt Lake Prospect

Gentlemen:

Please find enclosed a copy of the Application to Drill the captioned well as per Order No. R-111-P of the New Mexico Oil Conservation Division. The subject well will be drilled to a proposed depth of 3600 feet, and it shall be drilled in compliance with Order No. R-10432 and R-10432-A, copies of which have been previously submitted to you.

Should you have any questions regarding this matter, please contact our office or the NMOCD office.

Yours very truly,



Jerry A. Weant, CPL
Landman

cc: New Mexico Oil Conservation Division
P.O. Box 1980
Hobbs, New Mexico 88241

f:\lt\potash.jaw



District I
PO Box 1980, Hobbs, NM 88241-1980
District II
PO Drawer DD, Artesia, NM 88211-0719
District III
1000 Rio Brazos Rd., Aztec, NM 87410
District IV
PO Box 2088, Santa Fe, NM 87504-2088

State of New Mexico
Energy, Minerals & Natural Resources Department

OIL CONSERVATION DIVISION
PO Box 2088
Santa Fe, NM 87504-2088

RECEIVED FEB 28 1994

Form C-101
Revised February 10, 1994
Instructions on back
Submit to Appropriate District Office
State Lease - 6 Copies
Fee Lease - 5 Copies

☐ AMENDED REPORT

APPLICATION FOR PERMIT TO DRILL, RE-ENTER, DEEPEN, PLUGBACK, OR ADD A ZONE

Operator Name and Address: Stevens & Tull, Inc. P.O. Box 11005 Midland, TX 79702		COPY	OGRID Number 021602
			API Number 30 - 0
Property Code 18376	Property Name Conoco State		Well No. 2

7 Surface Location

UL or lot no.	Section	Township	Range	Lot Ida	Feet from the	North/South Line	Feet from the	East/West Line	County
D	16	20S	33E		990	North	990	West	Lea

8 Proposed Bottom Hole Location If Different From Surface

UL or lot no.	Section	Township	Range	Lot Ida	Feet from the	North/South Line	Feet from the	East/West Line	County
D	16	20S	33E		990	North	990	West	Lea

Proposed Pool 1 West Teas Y-SR	Proposed Pool 2
-----------------------------------	-----------------

Work Type Code N	Well Type Code O	Cable/Rotary R	Lease Type Code S	Ground Level Elevation 3562
Multiple No	Proposed Depth 3600	Formation Seven Rivers	Contractor Unknown	Spud Date 12/30/96

21 Proposed Casing and Cement Program

Hole Size	Casing Size	Casing weight/foot	Casing Depth	Sacks of Cement	Estimated TOC
12 1/4	8 5/8	24	1100	625	Surface
7 7/8	5 1/2	15.50	3600	600	Surface

Describe the proposed program. If this application is to DEEPEN or PLUG BACK give the data on the present productive zone and proposed new productive zone. Describe the blowout prevention program, if any. Use additional sheets if necessary.

1. Drill 12 1/4" hole to 1100'.
2. Cement 8 5/8" - 24# casing at 1100' - circulate cement to surface. Let cement stand 12 hours under pressure plus 12 hours during NU.
3. Drill 7 7/8" hole to TD of 3600'.
4. Cement 5 1/2" - 15.50# casing at 3600' with 610 sx class "c" cement and circulate cement to surface.

I hereby certify that the information given above is true and complete to the best of my knowledge and belief.

Signature: *Michael G. Mooney*
Printed name: Michael G. Mooney

Title: Consulting Engineer

Date: 11/19/96

Phone: 915/699-1410

OIL CONSERVATION DIVISION

Approved by:

Title:

Approval Date:

Expiration Date:

Conditions of Approval:

Attached ☐

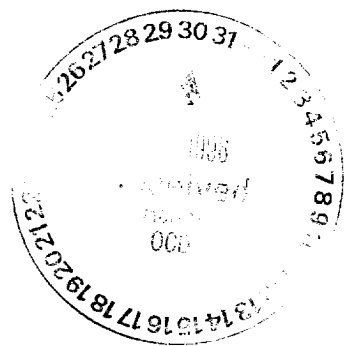

DISTRICT I
P.O. Box 1800, Hobbs, NM 88240

DISTRICT II
P.O. Drawer DD, Artesia, NM 88210

DISTRICT III
1000 Rio Bratos Rd., Aztec, NM 87410

State of New Mexico
Energy, Minerals and Natural Resources Department

Form C-102
Revised February 10, 1994
Instruction on back
Submit to Appropriate District Office
State Lease - 4 Copies
Fee Lease - 3 Copies

OIL CONSERVATION DIVISION

P.O. Box 2088
Santa Fe, New Mexico 87504-2088

☐ AMENDED REPORT

WELL LOCATION AND ACREAGE DEDICATION PLAT

API Number	Pool Code 59110	Pool Name West Teas Y-SR
Property Code 18376	Property Name Conoco State	Well Number 2
OGRID No. 021602	Operator Name Stevens & Tull, Inc.	Elevation 3533'

Surface Location

UL or lot No	Section	Township	Range	Lot Idn	Feet from the	North/South line	Feet from the	East/West line	County
D	16	20 S	33 E		990	North	990	West	Lea

Bottom Hole Location If Different From Surface

UL or lot No.	Section	Township	Range	Lot Idn	Feet from the	North/South line	Feet from the	East/West line	County
D	16	20S	33E		990	North	990	West	Lea

Dedicated Acres 40	Joint or Infill I	Consolidation Code	Order No.
-----------------------	----------------------	--------------------	-----------

NO ALLOWABLE WILL BE ASSIGNED TO THIS COMPLETION UNTIL ALL INTERESTS HAVE BEEN CONSOLIDATED
OR A NON-STANDARD UNIT HAS BEEN APPROVED BY THE DIVISION

	<p>OPERATOR CERTIFICATION</p> <p>I hereby certify the the information contained herein is true and complete to the best of my knowledge and belief.</p> <p><i>Michael G. Mooney</i> Signature /Michael G. Mooney Printed Name Consulting Engineer Title 11/19/96 Date</p>	
	<p>SURVEYOR CERTIFICATION</p> <p>I hereby certify that the well location shown on this plat was plotted from field notes of actual surveys made by me or under my supervision, and that the same is true and correct to the best of my belief.</p> <p>November 13, 1996 Date Surveyed Signature & Seal of Professional Surveyor <i>Gary L. Jones</i> W.O. No. 6493a Certificate No. Gary L. Jones 7977</p>	
	<p>BASIN SURVEYS</p>	

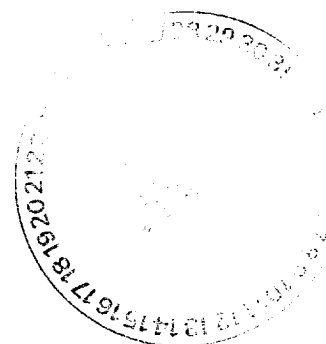

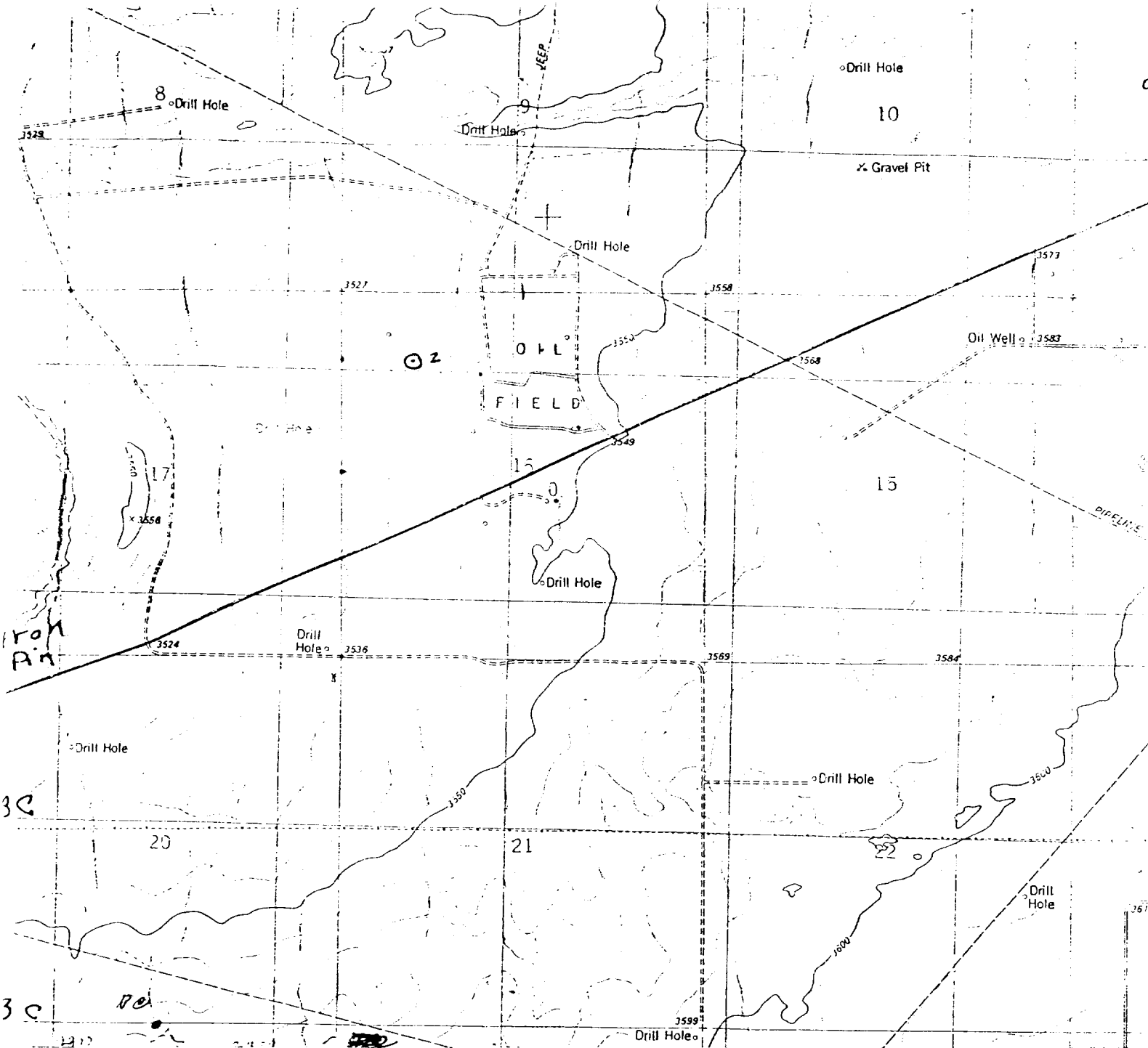

STEVENS & TULL INC.
CONOCO STATE #2
990' FNL & 990' FWL
Sec. 16, T-20-S, R-33-E,
Lea County, New Mexico.



SCALE: 1" = 2000'

BASIN SURVEYS

P.O. BOX 1786--HOBBS, NEW MEXICO



W.O. Number: 6493	Drawn By: S.C. Nichols	Survey Date: 11-13-96	Sheet 1 of 1 Sheets
-------------------	------------------------	-----------------------	---------------------

