





October 9, 1997

Chevron U.S.A. Production Company
P.O. Box 1150
Midland, TX 79702

Administrative Application For Unorthodox
Oil Well Location
Chevron USA Production Co.
Monument "12" State #14
1200' FNL and 1350' FWL
Section 12, T-19-S, R-36-E
North Monument Abo Pool
Lea County, New Mexico

State of New Mexico
Energy, Minerals & Natural Resources Dept.
Oil Conservation Division
2040 South Pacheco
Santa Fe, New Mexico 87504

Via Overnight Mail

Attn.: Mr. William J. LeMay -- Director

Gentlemen:

Chevron U.S.A. respectfully requests your approval of this administrative application for the subject Unorthodox Oil Well Location in the North Monument Abo Pool.

Chevron proposes to drill the Monument "12" State #14 (12 #14) at a non-standard location within the Chevron operated Monument Working Interest Unit. The target for the 12 #14 is a shelf margin Abo carbonate build-up that is defined with wells and 3D seismic. The attached map shows the interpreted north to northeast orientation of this carbonate build-up. The build-up is narrow and based on seismic, the location of the 12 #14 is the lowest risk location in unit letter C of section 12.

Because the proposed location is within the Chevron operated Monument Working Interest Unit, no correlative rights will be violated as ownership does not vary within the unit. Also, since the location is in the interior of the unit and the North Monument Abo Pool is developed on 40-acre spacing, the location will not encroach on any parties outside the unit.

In addition to the Abo Build-Up Map, a Form C-102 plat original, a Form C-102 plat showing offset wells, and a list of working interest owners within the unit is attached. If you have any questions or require any further information concerning this application, please contact me at (915) 687-7114.

Sincerely,

Dave Rittersbacher

Dave Rittersbacher
Geologist - New Mexico Area

djr
Attachments

cc: NMOCD -- Hobbs, NM
Phillips Petroleum Co.
Leede Operating Co.
Amerada Hess Co. } **Certified Mail**

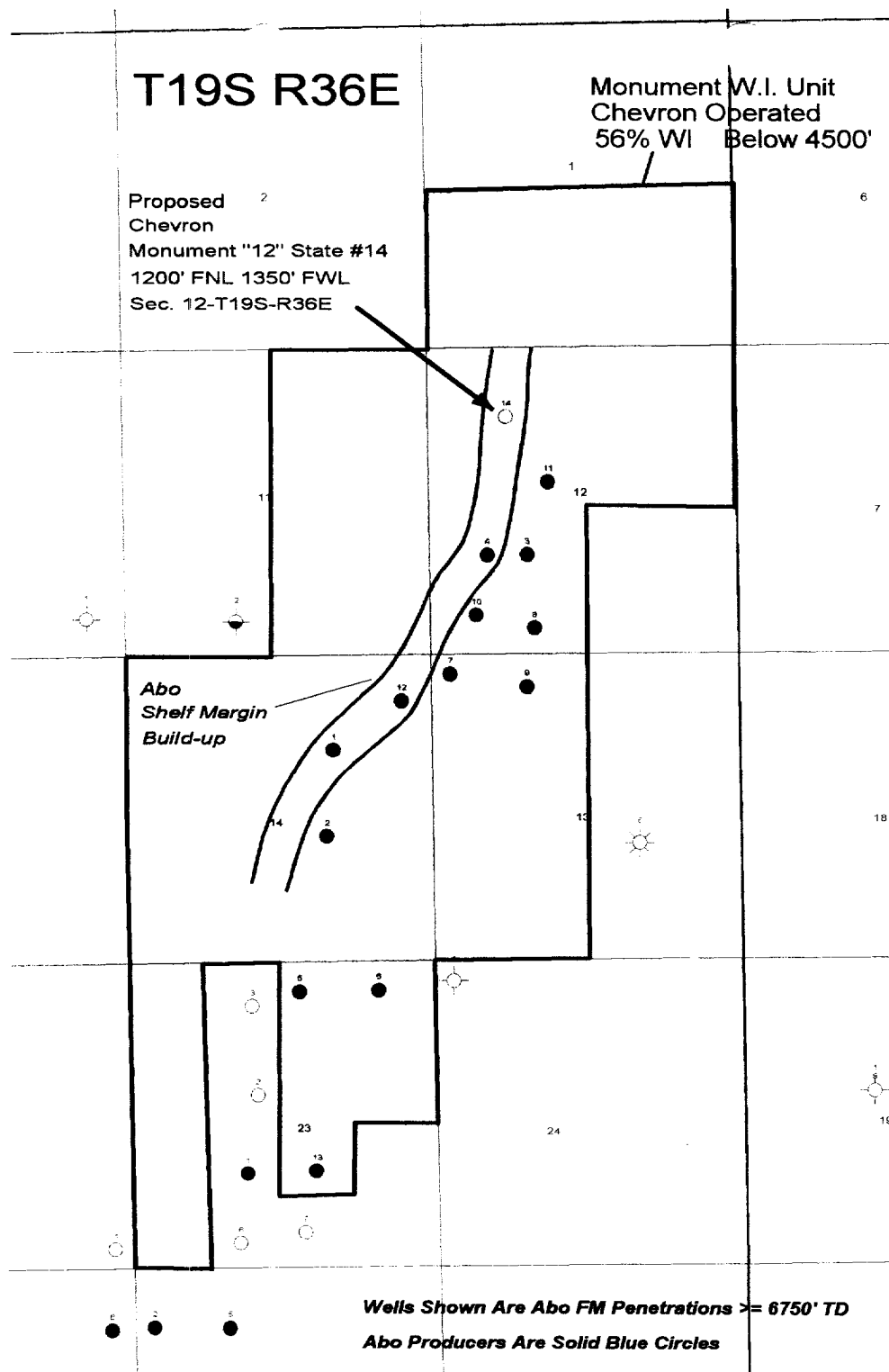

Chevron USA		
Monument Working Interest Unit Proposed Monument "12" State #14 Non-Standard Location		
Dave Rittersbacher		10/9/97
	Scale 1:36000.	

DISTRICT I
P.O. Box 1988, Hobbs, NM 88241-1988

State of New Mexico
Energy, Minerals and Natural Resources Department

Form C-102
Revised February 10, 1994
Submit to Appropriate District Office
State Lease - 4 Copies
Fee Lease - 3 Copies

DISTRICT II
P.O. Drawer DD, Artesia, NM 88211-0719

DISTRICT III
1000 Rio Brazos Rd., Aztec, NM 87410

OIL CONSERVATION DIVISION

P.O. Box 2088
Santa Fe, New Mexico 87504-2088

DISTRICT IV
P.O. Box 2088, Santa Fe, NM 87504-2088

☐ AMENDED REPORT

WELL LOCATION AND ACREAGE DEDICATION PLAT

API Number	Pool Code	Pool Name
Property Code	Property Name MONUMENT "12" STATE	Well Number 14
OGRID No.	Operator Name CHEVRON U.S.A. PRODUCTION COMPANY	Elevation 3741

Surface Location

UL or lot No.	Section	Township	Range	Lot Idn	Feet from the	North/South line	Feet from the	East/West line	County
C	12	19 S	36 E		1200	NORTH	1350	WEST	LEA

Bottom Hole Location If Different From Surface

UL or lot No.	Section	Township	Range	Lot Idn	Feet from the	North/South line	Feet from the	East/West line	County
Dedicated Acres	Joint or Infill	Consolidation Code	Order No.						

NO ALLOWABLE WILL BE ASSIGNED TO THIS COMPLETION UNTIL ALL INTERESTS HAVE BEEN CONSOLIDATED
OR A NON-STANDARD UNIT HAS BEEN APPROVED BY THE DIVISION

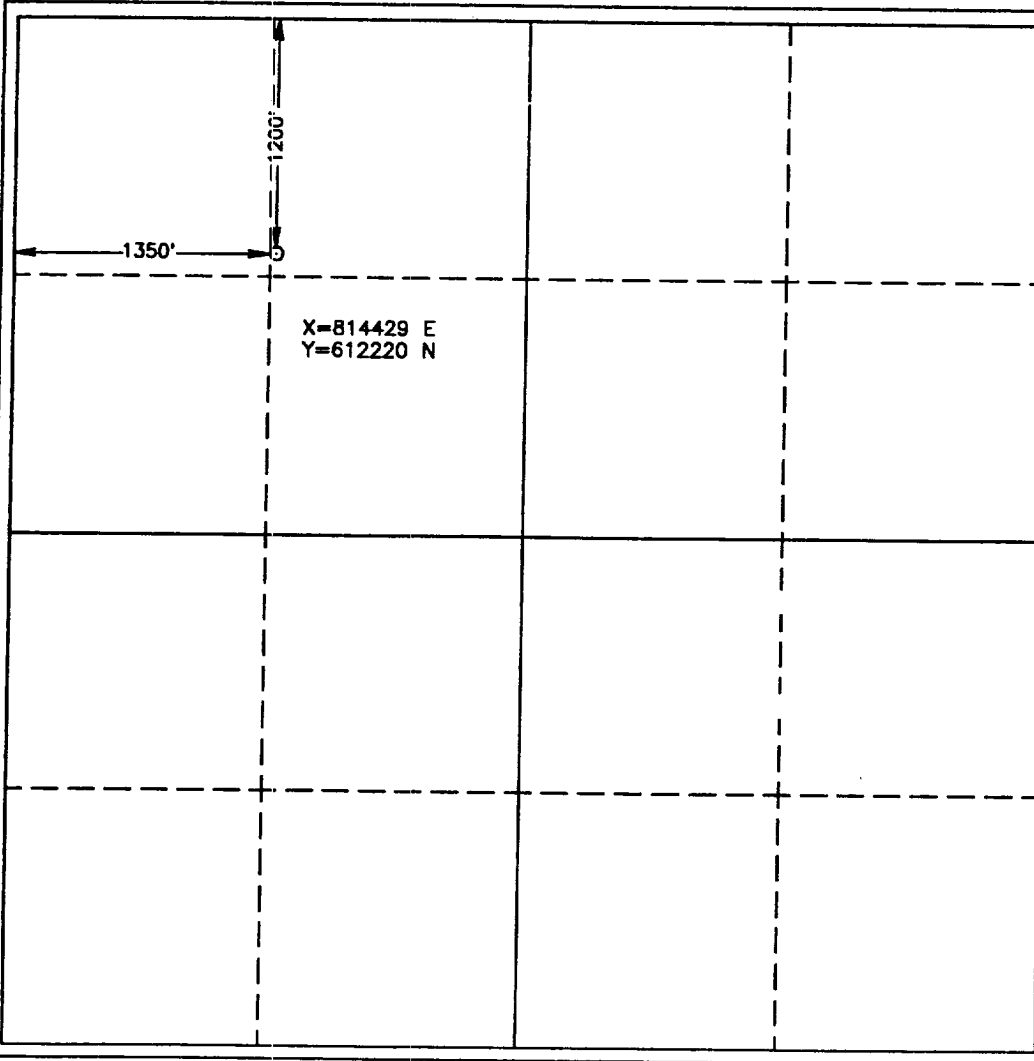
	<p>OPERATOR CERTIFICATION</p> <p>I hereby certify the the information contained herein is true and complete to the best of my knowledge and belief.</p> <p>Signature _____</p> <p>Printed Name _____</p> <p>Title _____</p> <p>Date _____</p> <p>SURVEYOR CERTIFICATION</p> <p>I hereby certify that the well location shown on this plat was plotted from field notes of actual surveys made by me or under my supervision, and that the same is true and correct to the best of my belief.</p> <p>OCTOBER 3, 1997</p> <p>Date Surveyed _____ JLP</p> <p>Signature & Seal of Professional Surveyor _____</p> <p>W.O. Num. 97-115619</p> <p>Certificate No. RONALD J. EDSON, 3239 GARY G. EIDSON, 12641</p>
---	---

DISTRICT I
P.O. Box 1988, Hobbs, NM 88241-1988

State of New Mexico
Energy, Minerals and Natural Resources Depart

Form C-102
Revised February 10, 1984
Submit to Appropriate District Office
State Lease - 4 Copies
Fee Lease - 3 Copies

DISTRICT II
P.O. Denver DD, Artesia, NM 88211-0719

DISTRICT III
1000 Rio Brazos Rd., Artesia, NM 87410

OIL CONSERVATION DIVISION
P.O. Box 2088
Santa Fe, New Mexico 87504-2088

DISTRICT IV
P.O. Box 2088, Santa Fe, NM 87504-2088

☐ AMENDED REPORT

WELL LOCATION AND ACREAGE DEDICATION PLAT

API Number	Pool Code	Pool Name
Property Code	Property Name MONUMENT "12" STATE	Well Number 14
OGRID No.	Operator Name CHEVRON U.S.A. PRODUCTION COMPANY	Elevation 3741

Surface Location

UL or lot No.	Section	Township	Range	Lot Idn	Feet from the	North/South line	Feet from the	East/West line	County
C	12	19 S	36 E		1200	NORTH	1350	WEST	LEA

Bottom Hole Location If Different From Surface

UL or lot No.	Section	Township	Range	Lot Idn	Feet from the	North/South line	Feet from the	East/West line	County
Dedicated Acres	Joint or Infill	Consolidation Code	Order No.						

NO ALLOWABLE WILL BE ASSIGNED TO THIS COMPLETION UNTIL ALL INTERESTS HAVE BEEN CONSOLIDATED
OR A NON-STANDARD UNIT HAS BEEN APPROVED BY THE DIVISION

	<p>OPERATOR CERTIFICATION</p> <p>I hereby certify the the information contained herein is true and complete to the best of my knowledge and belief.</p> <p><u>Dave Rittersbacher</u> Signature</p> <p><u>Dave Rittersbacher</u> Printed Name</p> <p><u>Geologist</u> Title</p> <p><u>10/9/97</u> Date</p> <p>SURVEYOR CERTIFICATION</p> <p>I hereby certify that the well location shown on this plat was plotted from field notes of actual surveys made by me or under my supervision, and that the same is true and correct to the best of my belief.</p> <p>OCTOBER 3, 1997</p> <p>Date Surveyed Signature & Seal of Professional Surveyor <u>G. EIDSON</u> NEW MEXICO Professional Surveyor 10-3-97 W.C. Num. 97-115-619 Certificate No. RONALD EIDSON, 3239 PROFESSIONAL SURVEYOR EIDSON, 12641</p>
--	---

Working Interest Owners
Monument Working Interest Unit
Lea Co., NM

Chevron USA
P.O. Box 1150
Midland, TX 79702
Attn: Dave Rittersbacher

Leede Operating Company
2100 Plaza Tower One
6400 S. Fiddler's Green Circle
Englewood, CO. 80111
Attn: Rusty Brusenhan

Amerada Hess Corporation
500 Dallas Street
Houston, TX 77002
Attn: W.S. Lehman

Phillips Petroleum Co.
4001 Penbrook
Odessa, TX 79762
Attn: Marianne McEwin